

K:\DEV_CD\096895001 - Lot 6, Parker, & Pine\CD\096895001_CD_UT.dwg, Newstrom, M. The document contains the concepts and designs presented here, as an intended user of the document, you shall be without liability to KIMLEY-HORN AND ASSOCIATES, INC.

The Town of Parker review constitutes general compliance with the Town's Standards and approved variances, subject to these plans being stamped, signed, and dated by the professional engineer of record. Review by the Town does not constitute approval of the plan design or accuracy and correctness of engineering calculations. Errors in the design or calculations remain the responsibility of the registered professional engineer whose stamp and signature are affixed to this document.

This review does not constitute approval of any private on-site improvements which may be shown. Construction cannot commence until all required drainage/traffic report(s), final development plan(s), special review(s), grading permit, and/or other permits are complete, approved and on file with the Town of Parker.

Town of Parker, Director of Engineering
Date: 01/19/2022

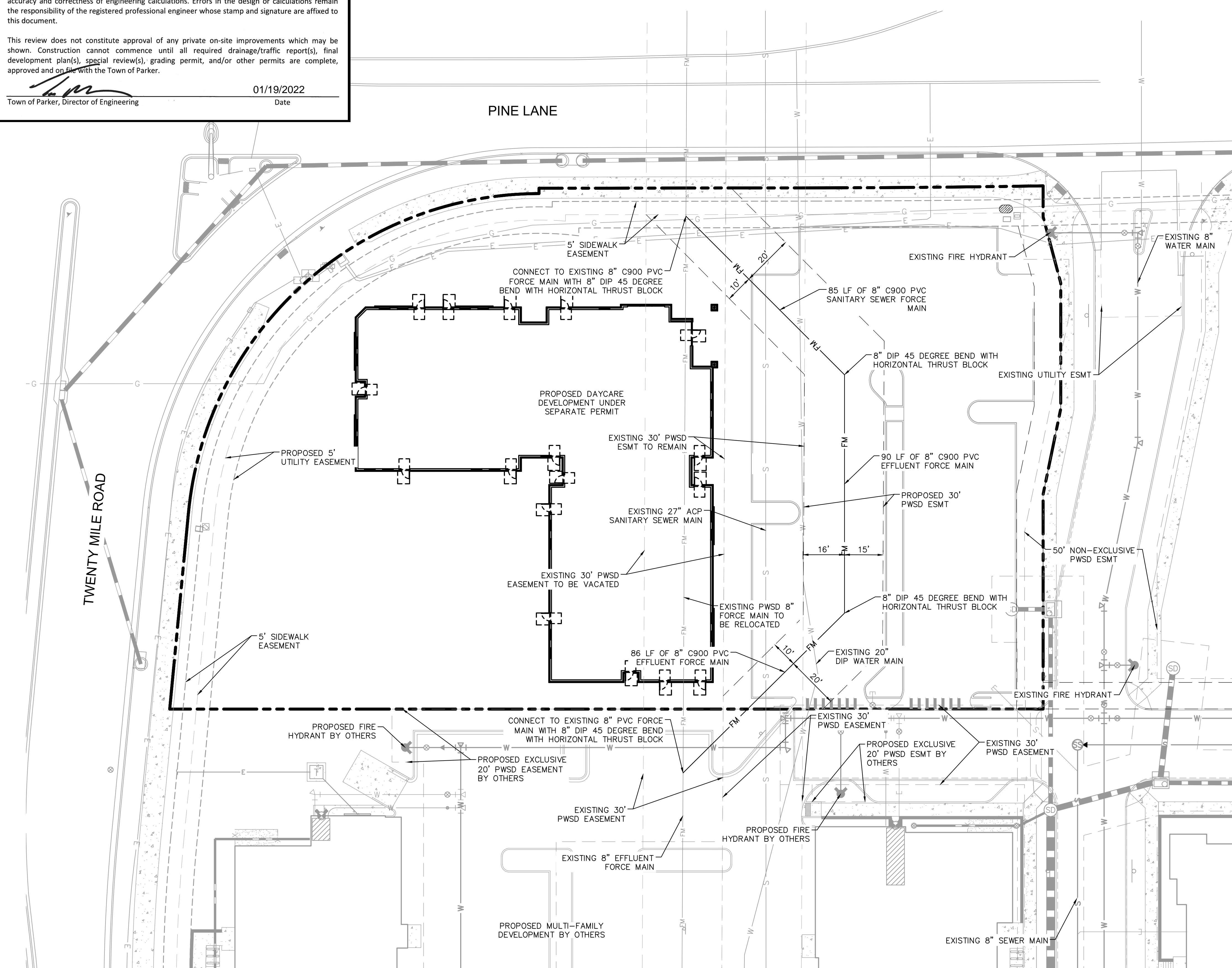

UTILITY LEGEND	
	EXISTING PROPERTY LINE
	EXISTING EASEMENT
	PROPOSED EASEMENT
	PROPOSED SANITARY SEWER FORCE MAIN
	EXISTING STORM DRAINAGE LINE
	EXISTING GAS LINE
	EXISTING WATER LINE
	EXISTING SANITARY SEWER LINE
	EXISTING ELECTRIC LINE
	EXISTING SANITARY SEWER MANHOLE

- NOTES:**
1. DUE TO IMPACT TO PWS D TREATMENT PLANT, GC SHALL SCHEDULE/COORDINATE ALL EFFLUENT FORCE MAIN CONSTRUCTION WITH PWS D INSPECTOR, AND PROVIDE PWS D INSPECTOR AN UP TO DATE PROJECT SCHEDULE AT ALL TIMES.
 2. EXISTING EFFLUENT LINE MUST BE PROTECTED FROM ALL CONSTRUCTION ACTIVITY.
 3. ALL WORK WITHIN THE PWS D EASEMENT MUST BE COORDINATED WITH PWS D INSPECTOR.
 4. NEW EFFLUENT FORCE MAIN SHALL BE CONSTRUCTED AND TESTED PRIOR TO CONNECTING TO EXISTING EFFLUENT FORCE MAIN.
 5. ALL FITTINGS SHALL BE RESTRAINED DIP WITH POLY WRAP AND PROTECTO 401 LINING. USE EBAA IRON SERIES PV 2000 FOR DIP TO PVC RESTRAINT.
 6. LINED CONTAINMENT POND REQUIRED TO DRAIN EFFLUENT FORCE MAIN. POND TO BE PUMPED INTO ADJACENT SANITARY SEWER MANHOLE.

APPROVED
Oct 25 2021
PARKER WATER AND SANITATION DISTRICT

ALL FIRE HYDRANTS SHALL BE INSTALLED ACCORDING TO WATER UTILITY STANDARDS. THE NUMBER AND LOCATIONS OF THE FIRE HYDRANTS AS SHOWN ON THE OVERALL UTILITY PLAN ARE CORRECT AS SPECIFIED BY THE TOWN OF PARKER, COMMUNITY DEVELOPMENT DEPARTMENT.

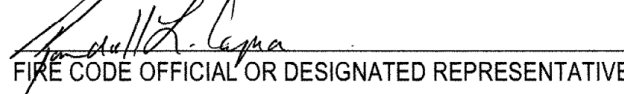
FIRE CODE OFFICIAL OR DESIGNATED REPRESENTATIVE
DATE: 01/19/2022
(NOTE - UNDERGROUND FIRE LINE (UFL) SUBMITTAL DOCUMENTS MUST MEET THE REQUIREMENT OF NFPA 24 WHEN SUBMITTING FOR REVIEW.)

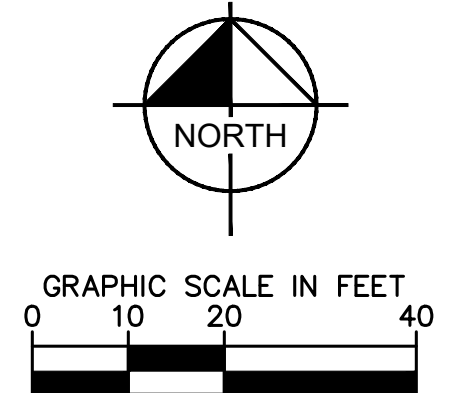

NO.	REVISION	BY	DATE	APPR

Kimley»Horn
2021 KIMLEY-HORN AND ASSOCIATES, INC.
4582 South Ulster Street, Suite 1500
Denver, Colorado 80237, (303) 728-2300

DESIGNED BY: MCN
DRAWN BY: NMH
CHECKED BY: DLS
DATE: 09/13/2021

LOT 6 PARKER AND PINE FILING 1
PARKER, CO
EVERBROOK ACADEMY CONSTRUCTION DOCUMENTS
UTILITY PLAN

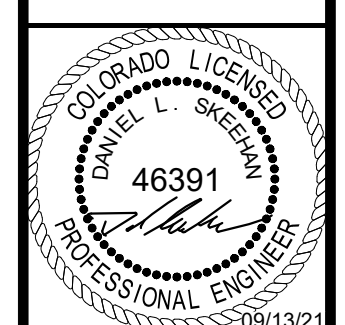

PROJECT NO.
096895001
DRAWING NAME
096895001CD_UT

W1.2

K:\DEV_CAD\096895001 - Lot 6, Parker Water & Sanitation District\096895001_CD_UT_PP.dwg New! - 10/21/2021 10:00 AM
 THIS DOCUMENT CONTAINS THE CONCEPTS AND DESIGN PRESENTED HEREIN, AS AN INSTRUMENT OF SERVICE TO THE CLIENT ONLY FOR THE SPECIFIC PROJECT AND CLIENT FOR WHICH IT WAS PREPARED. REUSE OF AND IMPROPER RELEASE OF THIS DOCUMENT WITHOUT WRITTEN AUTHORIZATION AND ADAPTATION BY KIMLEY-HORN AND ASSOCIATES, INC. SHALL BE WITHOUT LIABILITY TO KIMLEY-HORN AND ASSOCIATES, INC.

APPROVED
 Oct 25 2021
**PARKER WATER AND
 SANITATION DISTRICT**

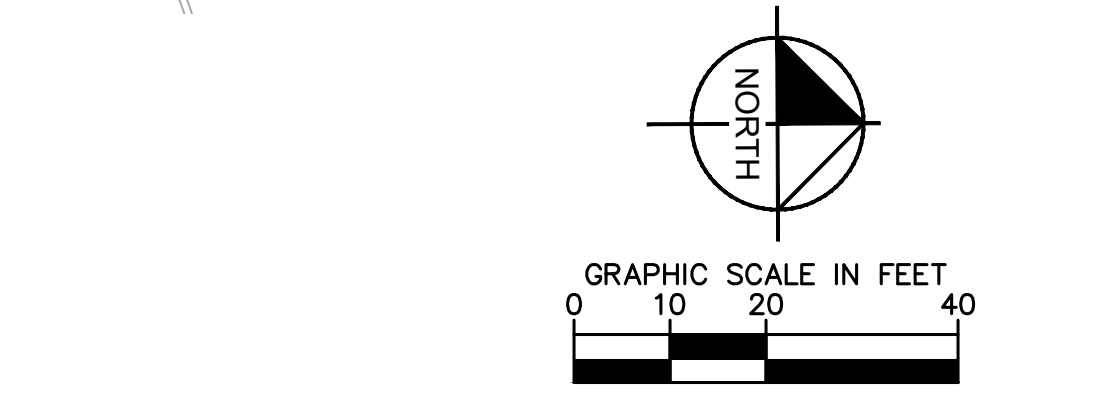
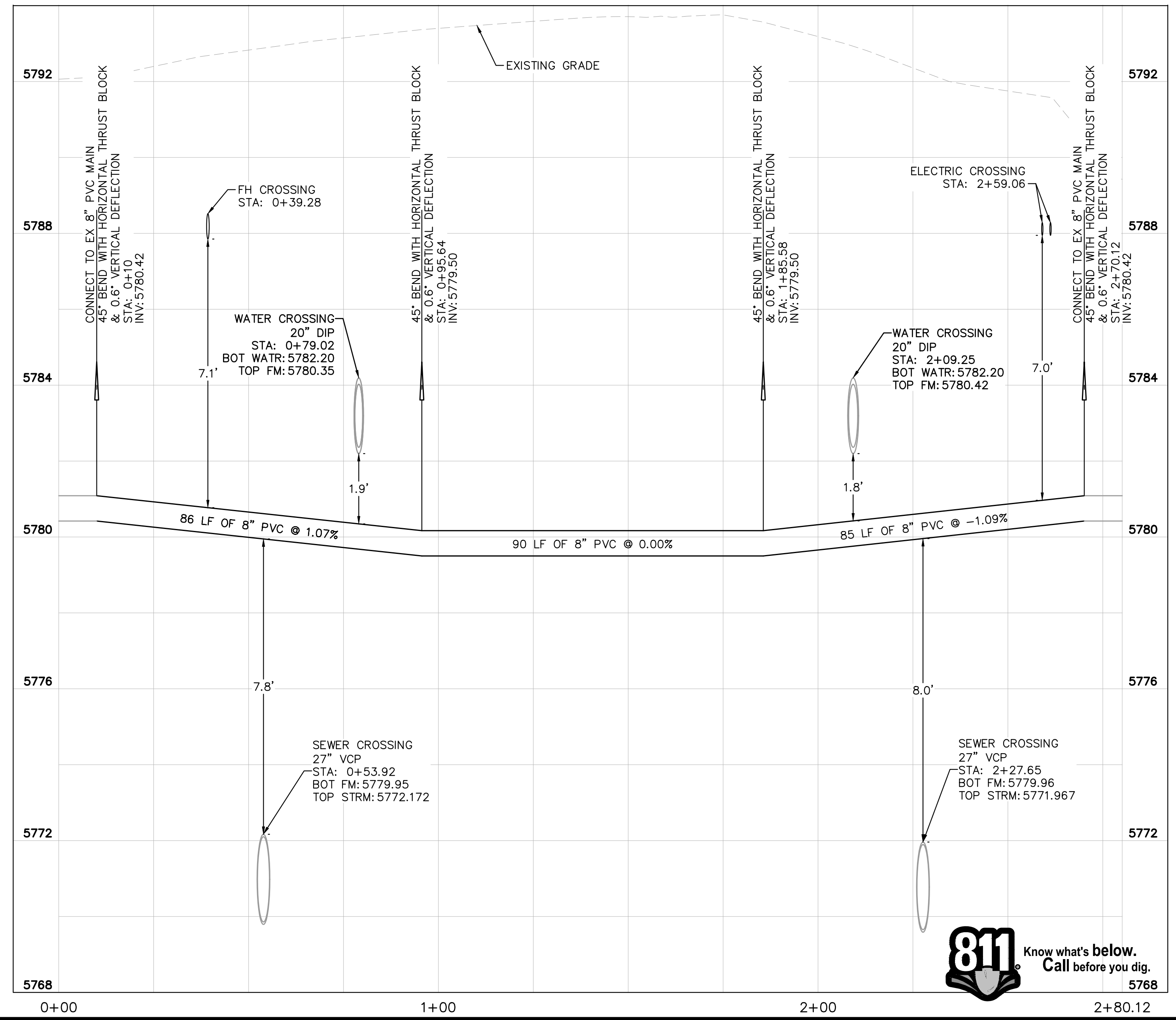
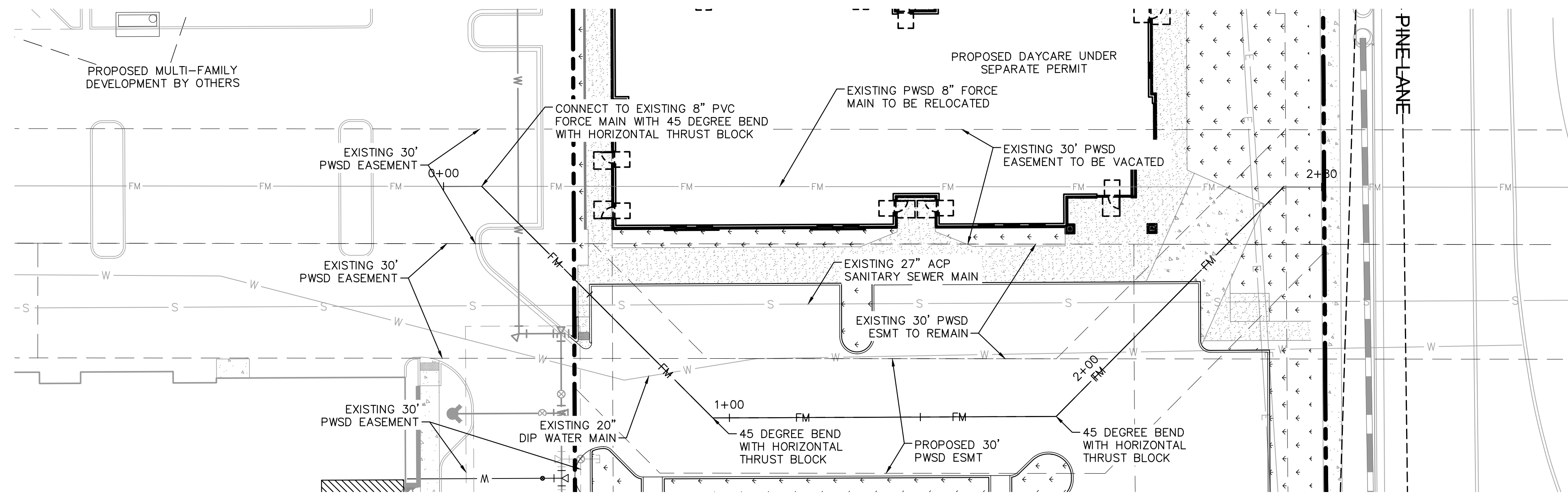

UTILITY LEGEND

	EXISTING PROPERTY LINE
	EXISTING EASEMENT
	PROPOSED EASEMENT
	PROPOSED SANITARY SEWER FORCE MAIN
	EXISTING STORM DRAINAGE LINE
	EXISTING GAS LINE
	EXISTING WATER LINE
	EXISTING SANITARY SEWER LINE
	EXISTING ELECTRIC LINE
	EXISTING SANITARY SEWER MANHOLE

NOTES:
 1. CONTRACTOR TO FIELD VERIFY SIZE, INVERT, AND LOCATION OF ALL EXISTING UTILITIES.

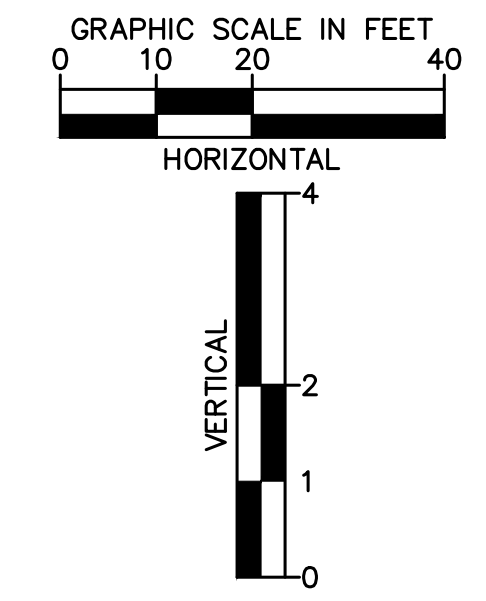

NO.	REVISION	BY	DATE	APPR

Kimley»Horn

2021 KIMLEY-HORN AND ASSOCIATES, INC.
 4582 South Ulster Street, Suite 1500
 Denver, Colorado 80237 (303) 728-2300

DESIGNED BY: MCN
 DRAWN BY: NMH
 CHECKED BY: DLS
 DATE: 09/13/2021

LOT 6 PARKER AND PINE FILING 1
 PARKER, CO
EVERBROOK ACADEMY CONSTRUCTION DOCUMENTS
PLAN & PROFILE

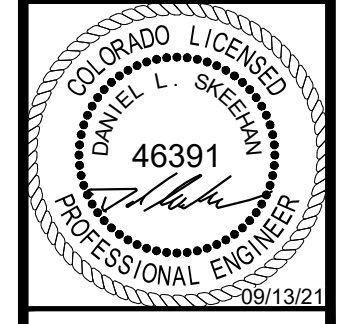

PROJECT NO.
096895001

DRAWING NAME
096895001CD_UT_PP

W1.3

