

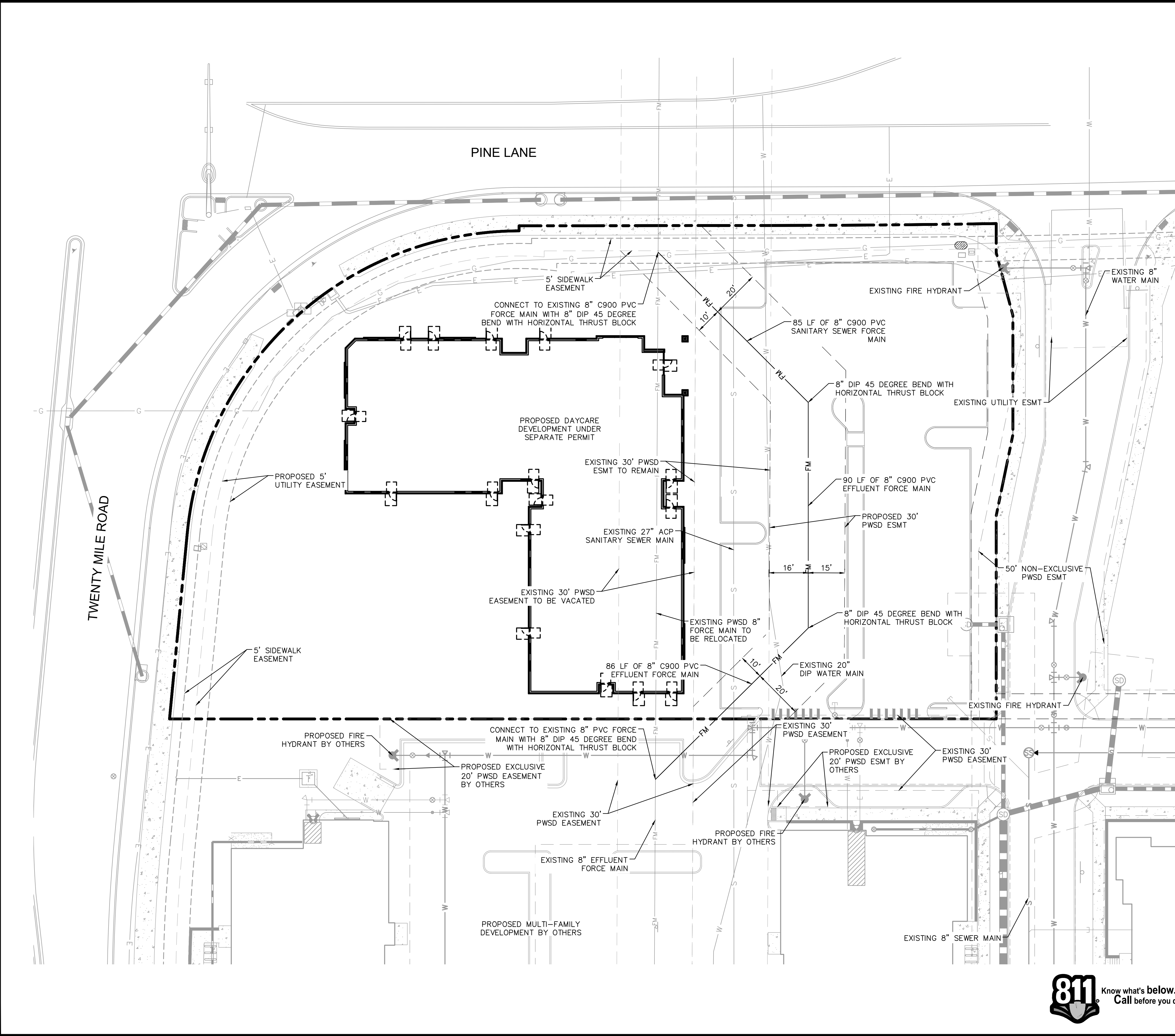



K:\DEV\_CAD\096895001 - Lot 6, Parker & Pine\CD\096895001\_CD\_UT.dwg, Newstrom, M. The document contains information that is confidential and proprietary to Kimley-Horn and Associates, Inc. and is intended for the use of the recipient only. No part of this document may be reproduced, stored in a retrieval system, or transmitted, in any form or by any means, without the prior written permission of Kimley-Horn and Associates, Inc. All rights reserved.



**UTILITY LEGEND**

---	EXISTING PROPERTY LINE
- - - -	EXISTING EASEMENT
- · - · -	PROPOSED EASEMENT
FM	PROPOSED SANITARY SEWER FORCE MAIN
---	EXISTING STORM DRAINAGE LINE
G	EXISTING GAS LINE
W	EXISTING WATER LINE
S	EXISTING SANITARY SEWER LINE
E	EXISTING ELECTRIC LINE
○	EXISTING SANITARY SEWER MANHOLE

- NOTES:**
1. DUE TO IMPACT TO PWSO TREATMENT PLANT, GC SHALL SCHEDULE/COORDINATE ALL EFFLUENT FORCE MAIN CONSTRUCTION WITH PWSO INSPECTOR, AND PROVIDE PWSO INSPECTOR AN UP TO DATE PROJECT SCHEDULE AT ALL TIMES.
  2. EXISTING EFFLUENT LINE MUST BE PROTECTED FROM ALL CONSTRUCTION ACTIVITY.
  3. ALL WORK WITHIN THE PWSO EASEMENT MUST BE COORDINATED WITH PWSO INSPECTOR.
  4. NEW EFFLUENT FORCE MAIN SHALL BE CONSTRUCTED AND TESTED PRIOR TO CONNECTING TO EXISTING EFFLUENT FORCE MAIN.
  5. ALL FITTINGS SHALL BE RESTRAINED DIP WITH POLY WRAP AND PROTECTO 401 LINING. USE EBAA IRON SERIES PV 2000 FOR DIP TO PVC RESTRAINT.
  6. LINED CONTAINMENT POND REQUIRED TO DRAIN EFFLUENT FORCE MAIN. POND TO BE PUMPED INTO ADJACENT SANITARY SEWER MANHOLE.

**APPROVED**  
**Oct 25 2021**  
**PARKER WATER AND**  
**SANITATION DISTRICT**

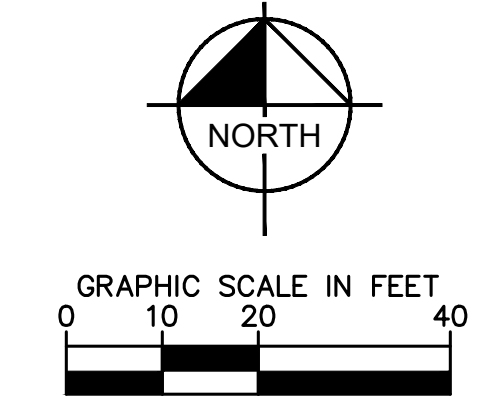

NO.	REVISION	BY	DATE	APPR

**Kimley»Horn**

2021 KIMLEY-HORN AND ASSOCIATES, INC.  
 4582 South Ulster Street, Suite 1500  
 Denver, Colorado 80237, (303) 728-2300

DESIGNED BY: MCN  
 DRAWN BY: NMH  
 CHECKED BY: DLS  
 DATE: 09/13/2021

**LOT 6 PARKER AND PINE FILING 1**  
 PARKER, CO  
 EVERBROOK ACADEMY CONSTRUCTION DOCUMENTS  
 UTILITY PLAN

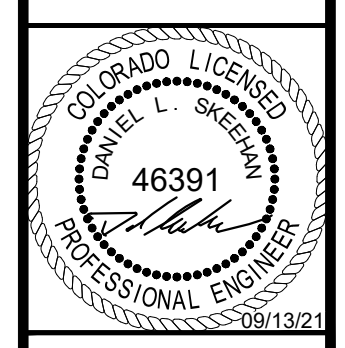

PROJECT NO.  
096895001

DRAWING NAME  
096895001CD\_UT

W1.2

K:\DEV\_CAD\096895001 - Lot 6, Parker, CO\096895001\_CD\_UT\_PP.dwg New/revs, May 2021  
 THIS DOCUMENT CONTAINS THE CONCEPTS AND DESIGN PRESENTED HEREIN, AS AN INSTRUMENT OF SERVICE, FOR THE EXCLUSIVE USE OF THE CLIENT ONLY. IT IS THE PROPERTY OF KIMLEY-HORN AND ASSOCIATES, INC. AND SHALL BE WITHOUT LIABILITY TO KIMLEY-HORN AND ASSOCIATES, INC. IF REPRODUCED OR TRANSMITTED IN ANY FORM OR BY ANY MEANS, WITHOUT THE WRITTEN AUTHORIZATION AND ADAPTATION BY KIMLEY-HORN AND ASSOCIATES, INC.

**APPROVED**  
 Oct 25 2021  
 PARKER WATER AND  
 SANITATION DISTRICT

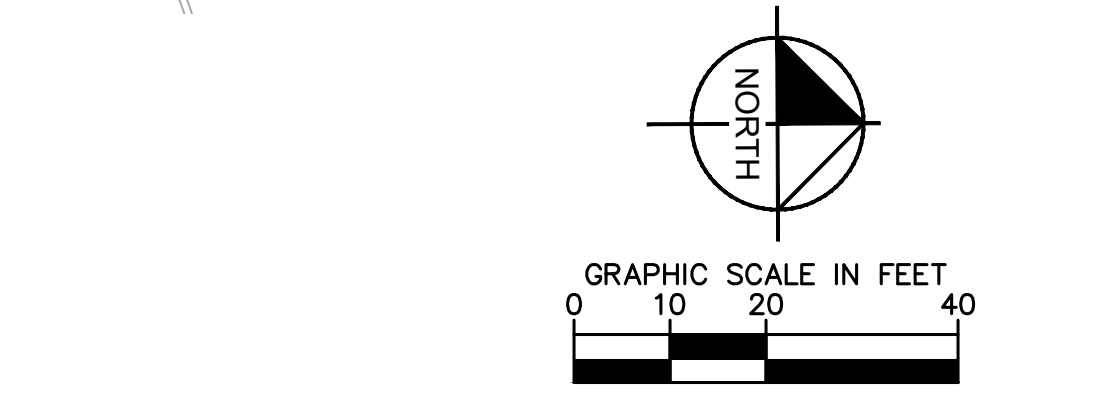
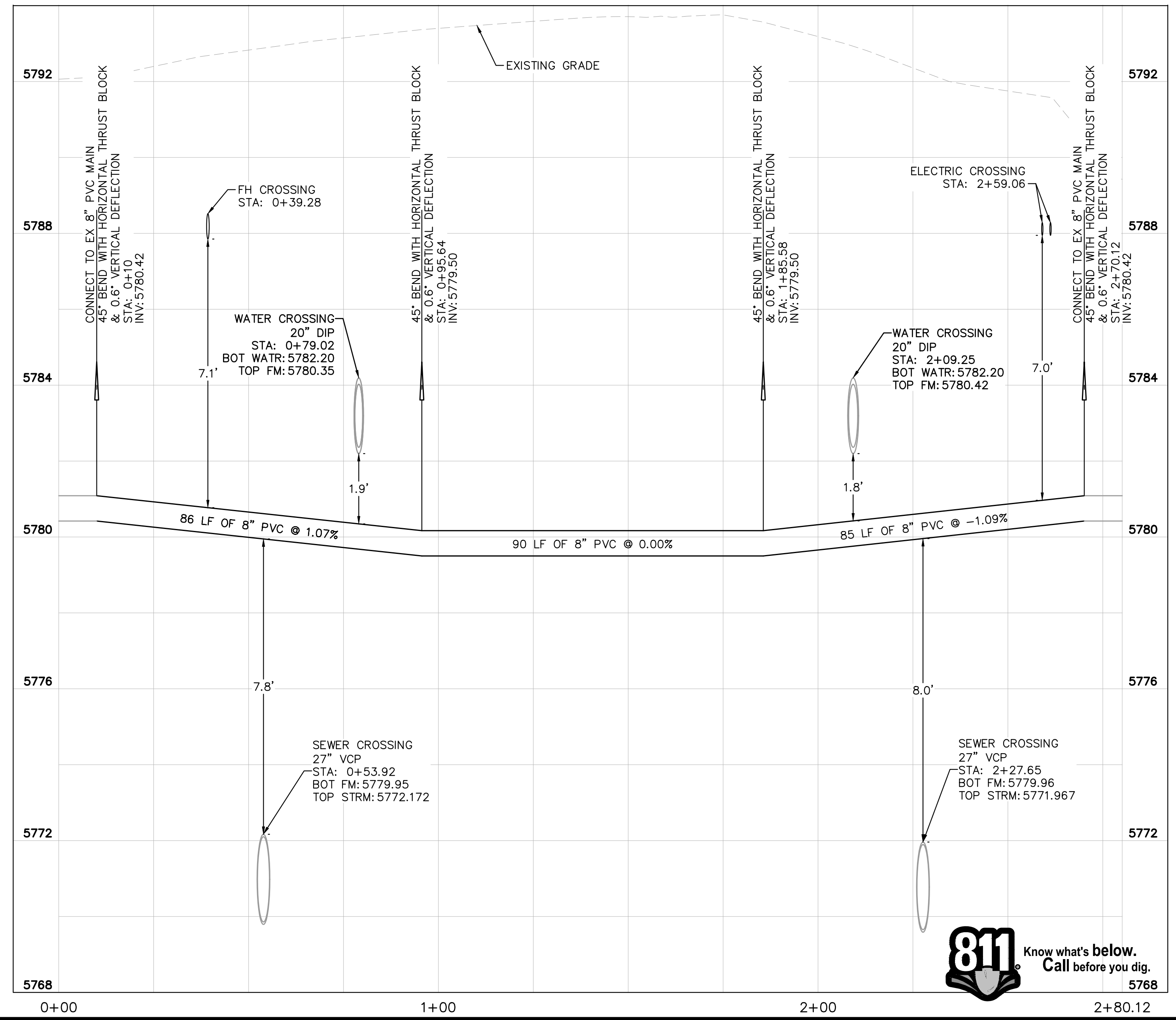
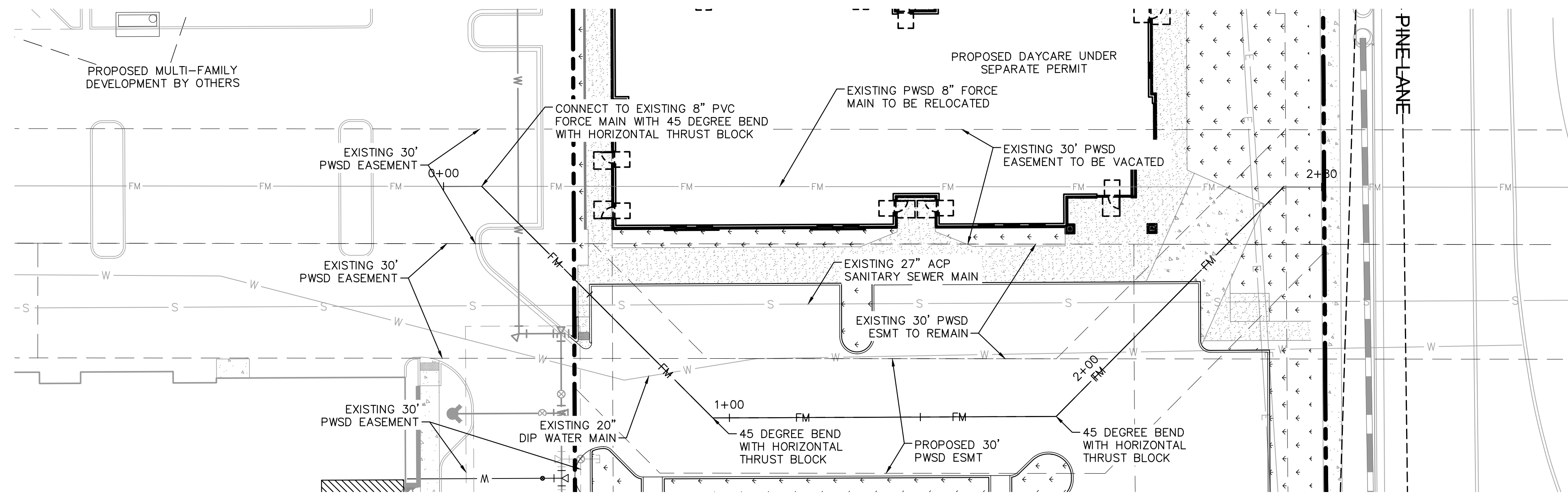

**UTILITY LEGEND**

	EXISTING PROPERTY LINE
	EXISTING EASEMENT
	PROPOSED EASEMENT
	PROPOSED SANITARY SEWER FORCE MAIN
	EXISTING STORM DRAINAGE LINE
	EXISTING GAS LINE
	EXISTING WATER LINE
	EXISTING SANITARY SEWER LINE
	EXISTING ELECTRIC LINE
	EXISTING SANITARY SEWER MANHOLE

**NOTES:**  
 1. CONTRACTOR TO FIELD VERIFY SIZE, INVERT, AND LOCATION OF ALL EXISTING UTILITIES.

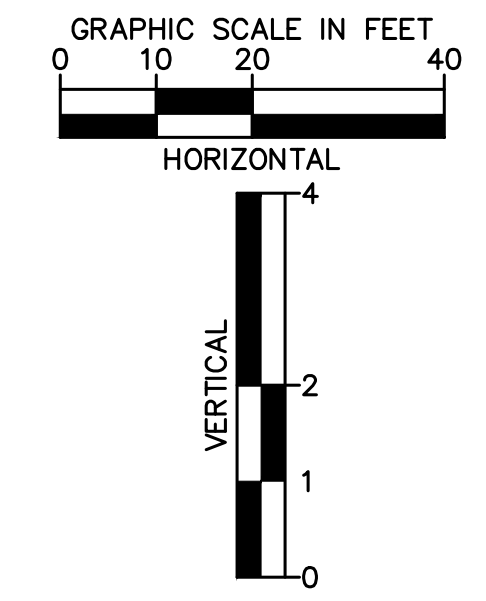

NO.	REVISION	BY	DATE	APPR

**Kimley»Horn**  
 2021 KIMLEY-HORN AND ASSOCIATES, INC.  
 4582 South Ulster Street, Suite 1500  
 Denver, Colorado 80237 (303) 728-2300

DESIGNED BY: MCN  
 DRAWN BY: NMH  
 CHECKED BY: DLS  
 DATE: 09/13/2021

**LOT 6 PARKER AND PINE FILING 1**  
 PARKER, CO  
 EVERBROOK ACADEMY CONSTRUCTION DOCUMENTS  
 PLAN & PROFILE

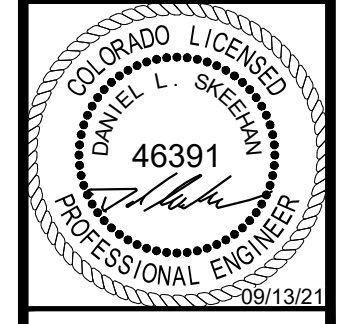

PROJECT NO.  
 096895001

DRAWING NAME  
 096895001CD\_UT\_PP

**W1.3**

