

 $N 89^{\circ}29'26'' E \quad 1022.09'$   
 NW COR. SEC. 15,  
 T.6 S., R.66W.  
 6TH P.M.

LINCOLN AVENUE

EX. 15' UTILITY ESMT.

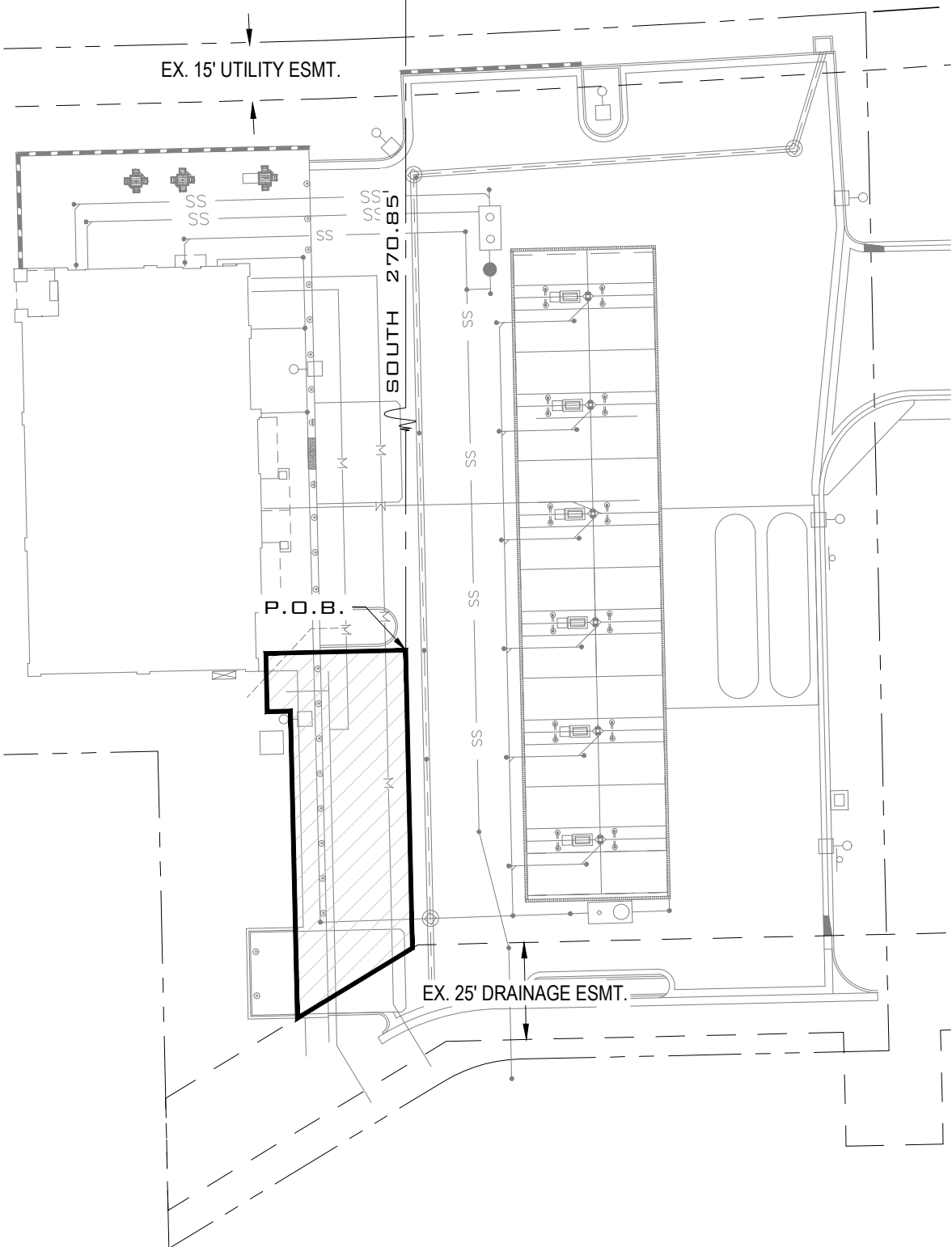

P.O.B.

SOUTH 270.85'

EX. 25' DRAINAGE ESMT.

DATE:	1/10/2023
JOB NO.:	11746-PH126
DRAWN BY:	B.E.A.
SCALE:	1"=640'
DWG:	SURVEY-EXHIBIT
DATE	
REVISIONS	

**ROSENBERG**  
 A S S O C I A T E S  
 CIVIL ENGINEERS • LAND SURVEYORS



352 EAST RIVERSIDE  
 DRIVE, SUITE A-2  
 ST. GEORGE, UTAH  
 84790  
 435.673.8586  
 WWW.RACIVIL.COM

# EXHIBIT MAP



SHEET  
**1**  
 OF 1 SHEETS