

PLANT LEGEND

| | | | |
|--|--------------------------|--|---------------------|
| | WFR 50'x20'-25' | | GSG 3'x4' |
| | CSP 60'x35' | | MSM 3'x4' |
| | BSP 30'x10' | | MMO 5'x6' |
| | PON 40'x25' | | OGH 3'x4'-5' |
| | MEJ 10'x5' | | MRE 1.5'x2' |
| | SPA 15'x5' | | SEJ 8'x6' |
| | WBL 20'x5' | | BLR 6'x6' |
| | CSM 25'x15' | | DSP 2'x2' |
| | IMP 35'x25' | | LPP 2'x3' |
| | SHA 50'x35' | | NFS 3'x3' |
| | BOA 70' x 50' | | FQS 3'x3' |
| | TEX 50' x 40' | | MKL 5'x5' |
| | ROA 50'x30' | | CPL 15'x8' |
| | EOA 50'x40' | | CSU 8'x6' |
| | RL 40'x25' | | KSV 6' x 6' |
| | AMC 6' Clump-115 20'x15' | | DAC 6'x4' |
| | ALG 20'x10' | | KNP 3'x3' |
| | GRT 30'x25' | | KNR 3'x3' |
| | FRF 20'x20' | | CFM 24-36'x24' |
| | TCG 20'x20' | | GBG 14'-24'x12'-24' |
| | BSL 3'x4' | | ELA 12'-18'x12'-18' |
| | BSG 4'x6' | | GRD 30'x24' |
| | EGG 3'x5' | | SMN 18'x18' |
| | AND 18'x6' | | |
| | ARM 4'x4' | | |
| | BCJ 10'x6' | | |
| | BJJ 12'x6' | | |
| | HUJ 18'x6' | | |
| | OGJ 3'x4' | | |
| | RBA 4'x5' | | |
| | CPB 2'x3' | | |
| | BBU 5'x5' | | |
| | BMS 3'x3' | | |
| | RTD 8' x 8' | | |
| | CTT 1'x3' | | |
| | CRK 2'x3.5' | | |
| | DBB 5'x4' | | |
| | RSA 4'x3' | | |
| | GFP 3'x4' | | |
| | GDP 3' x 3' | | |
| | PBS 1.5'x3' | | |

- Perennials To Be Included In MSA Mixed Annuals/Perennials Areas:
- YAM Yellow Moonshine/Pink/Yellow 20'x21'
 - HSU Hysop Sunset 24'-36'x18'-30'
 - REV Red Valerian 24'x24'
 - COM Gopceps Moorbees 18'-24'x12'-18'
 - LEA Little Blue 3'-6'x24'
 - AVG Blue Avena Grass 2'x2'
 - PMS Maiden Grass, Purple/Flame 3'-4'x18'-24'
 - RSG Red Switch Grass 3'-4'x24'-30'
 - LLG Little Bluestem 3'-4'x2'

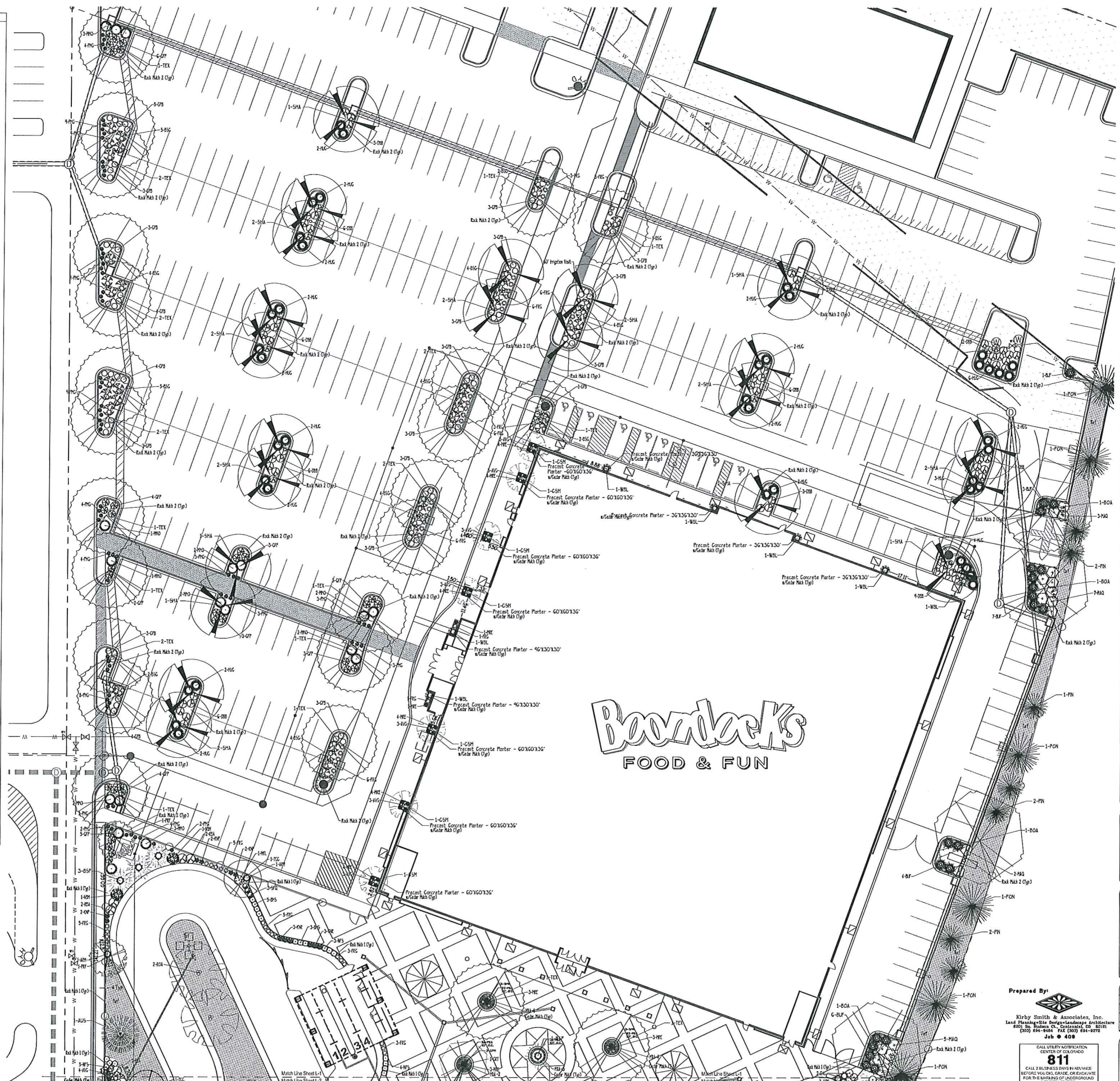
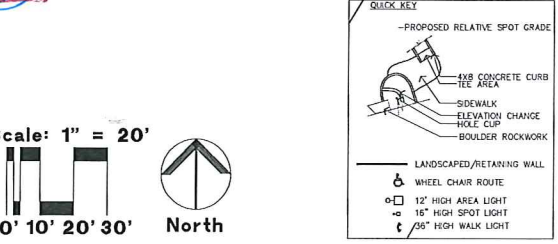

APPROVED
DATE: 08.12.2015
PLANNER: [Signature]

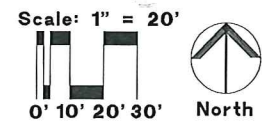

REVISIONS

| DESCRIPTION | DATE |
|----------------------|---------|
| OWNER CHANGES | 2/16/15 |
| SITE SUBMITTAL | 3/11/15 |
| TOWN & CC REVISIONS | 8/7/15 |
| REG. BOARD REVISIONS | 8/21/15 |
| REG. BOARD APPROVAL | 8/31/15 |

OWNER:
SELECT DEVELOPMENT & CONTRACTING, LLC
860 EAST FRANKLIN ROAD, MERIDIAN, ID 83642

PROJECT:
Boondocks
CROWN POINT DEVELOPMENT
CROWN PARKER, CO

COPYRIGHT 2015

Peter H. Rockwell, Architect
Architecture • Planning
595 S. Americana Boulevard • Boise, Idaho 83702
(208) 345-0566 (208) 345-1718 Fax (208) 387-0889
office@pbrise.com

SITE PLAN LANDSCAPE PLAN (NORTH)

SHEET DATA
DRAWN BY: KJS
CHECKED BY: KJS
SCALE: 1" = 20'
DATE: 3/11/15
PROJECT: 14001
SHEET NUMBER: **L-1**

Prepared By:
811
Kirby Smith & Associates, Inc.
Lead Underwriter/Service Provider
800 5th Avenue, Suite 200, Boise, ID 83725
(208) 345-0566 FAX (208) 345-0572
Job # 408

CALL UTILITY NOTIFICATION CENTER OF IDAHO
BEFORE YOU DIG, GRADE, OR EXCAVATE
FOR THE MARKING OF UNDERGROUND UTILITIES.

PLANT LEGEND

| | |
|--|--|
| CCF G-8 White Fr 50'x20'-25' | CSP G' Colorado Spruce 60'x35' |
| B5F 8' Bakeri Spruce 30'x10' | FN G' Pion Pine 25' X 15' |
| AUS G' Austrian Pine 50'x20' | PN G' Ponderosa Pine 40'x25' |
| MEI 5-7 Gal. Medora Juniper 10'x5' | SPA 5-7 Gal. Spartan Juniper 15'x5' |
| WBL 10 Gal. Wichita Blue Juniper 20'x5' | CSM Crimson Sentry Maple 25'x15' |
| IMP Imperial Locust 35'x25' | SHA Shearwater Honeylocust 50'x35' |
| BOA 25' Gal. Burr Oak 70' X 50' | TEX Texas Rd Oak 50' X 40' |
| ROA Northern Red Oak 50'x30' | EOA English Oak 30'x40' |
| RLJ Redwood Linden 40'x25' | CMC Amur Maple G' Clump-515 20'x15' |
| ALG Thistle Alder 20'x10' | GRT Golden Tree 30'x25' |
| FRF Fraxino Crab 20'x20' | TGG Thunderchild Crab 20'x20' |
| BSL Scotch Lena Broom 3'x4' | BSG Spanish Gold Broom 4'x6' |
| EGG Eonymus Emerald Gaeety 3'x5' | AND Andora Juniper 18'x6' |
| ARM Armstrong Juniper 4'x4' | BCH Blue Chip Juniper 10'x6' |
| BUF Buffalo Juniper 12'x6' | HUG Hughes Juniper 18'x6' |
| OLD Old Gold Juniper 3'x4' | RBA Red Barberry 4'x5' |
| CPB Crimson Pinyon Barberry 2'x3' | SBE Butterfly Bush 5'x5' |
| SHS Blue Host Spruce 3'x3' | RTD Redwing Dogwood 8' X 8' |
| CIT Tom Thumb Cotoneaster 1'x3' | CDI Cotoneaster, Shrub 6'x4' |
| CRD Rock Cotoneaster 2'x3.5' | DBD Dwarf Burning Bush 5'x4' |
| RSA Russian Sage 4'x3' | GFP Goldfinger Potentilla 3'x4' |
| GDP Gold Drop Potentilla 3' X 3' | FBS Pease Bittes Sand Cherry 1.5'x6' |
| YAH Yellow Moonshine/Pink/Yellow 20'x21' | HSU Hyssop Sunset 24"-36"X15"-30" |
| REV Red Valerian 24"x24" | COM Gopepp's Moonbeam 18"-24"x12"-18" |
| CPM Cornflower Magnus 24"-36"x24" | GAL Gallardia Burgundy 14"-24"x12"-24" |
| ELA English Lavender 12"-18"x12"-18" | RGD Goldstrum Rudbeckia 30"x24" |
| SHN Solvia May Night 18'x18' | |

Perennials To Be Included in MIA Mixed Areas/Perennials Areas:
 YAH Yellow Moonshine/Pink/Yellow 20'x21'
 HSU Hyssop Sunset 24"-36"X15"-30"
 REV Red Valerian 24"x24"
 COM Gopepp's Moonbeam 18"-24"x12"-18"

Ornamental Grasses:
 FRG Feather Reed Grass 5'-6"x24"
 AVG Blue Avens Grass 2'x2'
 PMG Maiden Grass, Purple/Flame 3'-4"x18"-24"
 RSG Red Switch Grass 3'-4"x24"-30"
 LBG Little Bluestem 3'-4'x2'

Materials:
 Precast Concrete Planters
 Irrigated Turf (Revelle) - Texas Hybrid mix
 Water Features, Fountains & Falls
 MIA Mixed Areas/Perennials

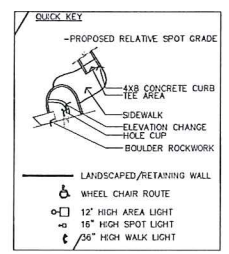
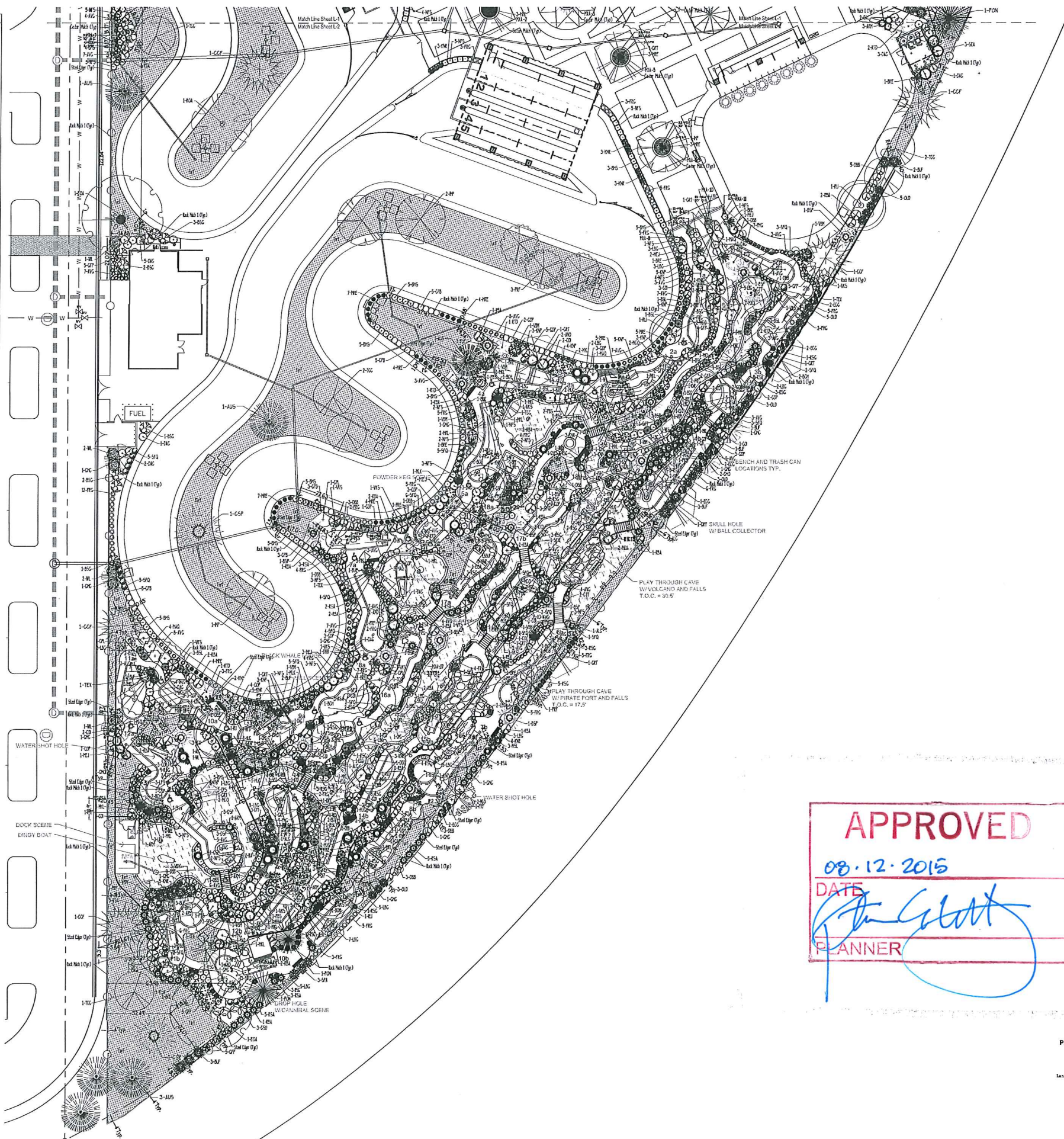

APPROVED
 08.12.2015
 DATE

 PLANNER

REVISIONS

| DESCRIPTION | DATE |
|-----------------------|---------|
| OWNER CHANGES | 2/16/11 |
| SPR. REVISIONS | 3/1/11 |
| TOWN & ACC. REVISIONS | 5/1/11 |
| REG. REVISIONS | 5/21/11 |
| REG. REVISIONS | 8/11/11 |

OWNER
SELECT DEVELOPMENT & CONTRACTING, LLC
 660 EAST FRANKLIN ROAD, MERIDIAN, ID 83662

PROJECT
Boonacks
 JOINT DEVELOPMENT
 PARKER, CO

COPYRIGHT
 2015

Peter H. Rockwell, Architect
 Architecture • Planning
 595 S Americana Boulevard Boise, Idaho 83702
 (208) 345-0566 (208) 345-1718 Fax (208) 387-0889
 office@pbr Boise.com

SITE PLAN
 LANDSCAPE PLAN
 (SOUTH)

SHEET DATA

| | |
|---------------|----------|
| DRAWN BY: | KJS |
| CHECKED BY: | KJS |
| SCALE: | 1" = 20' |
| DATE: | 3/11/15 |
| PROJECT #: | 14001 |
| SHEET NUMBER: | |

Prepared By:

 Kirby Smith & Associates, Inc.
 Lead Landscape Architect
 800 W. Hudson St., Colorado Springs, CO 80901
 (303) 441-8844 FAX (303) 441-8822
 Job # 408

CALL UTILITY NOTIFICATION CENTER OF COLORADO
811
 CALL 24 HOURS IN ADVANCE BEFORE YOU DIG, GRUZE, OR EXCAVATE FOR THE MARKING OF UNDERGROUND MEMBER UTILITIES.

L-2

Boondocks Site Calculations

| Parker, CO | | Crown Point Center | | |
|-------------------------------|----------------------|---------------------|----------------------------|-----|
| Parking | 126,496.00 sf | 2.90 acre(s) | 32.1% of total site | 10% |
| Landscape Islands | 12,674.00 sf | 10% of parking lot | | |
| Total Parking Area | 126,496.00 sf | 2.90 acre(s) | 32.1% of total site | |
| 'Green' Space | 77,467.00 sf | 1.78 acre(s) | 19.7% of total site | 15% |
| Landscape w/o Parking Islands | 64,793.00 sf | 1.49 acre(s) | 16.5% of total site | |
| Hardscape | 27,571.00 sf | 0.63 acre(s) | 7.0% of total site | |
| Entry Plaza | 3,987.00 sf | | | |
| Rear Patio | 23,584.00 sf | | | |
| Total Landscape Area | 105,038.00 sf | 2.41 acre(s) | 26.7% of total site | |
| Main Building | 60,480.00 sf | 1.39 acre(s) | 15.4% of total site | |
| Maintenance Building | 1,950.00 sf | | | |
| Pump House | 248.00 sf | | | |
| Total Building Area | 62,678.00 sf | 1.44 acre(s) | 15.9% of total site | |
| Attractions | 65,142.00 sf | 1.50 acre(s) | 16.5% of total site | |
| Bumper Boats Pond | 8,671.00 sf | | | |
| Go Cart Tracks | 56,471.00 sf | 1.30 acre(s) | 14.3% of total site | |
| Back of House circulation | 34,340.00 sf | 0.79 acre(s) | 8.7% of total site | |
| Total Attraction Area | 99,482.00 sf | 2.28 acre(s) | 25.3% of total site | |
| Total Site | 393,695.60 sf | 9.04 acre(s) | | |

Plant Material Areas (Entire Site)

| Site Area Description | Size/Sq. Ft. |
|--|-----------------------|
| Turf Areas - Reveille Texas hybrid bluegrass (Irrigated) | 27,131 Sq. Ft. |
| Planting Areas (Irrigated) | 31,696 Sq. Ft. |
| Total Landscape Area | 58,827 Sq. Ft. |

Parking Area Landscape Island Summary

| Area/Sq. Ft. | Trees | | | | Notes |
|----------------|----------------------|-----------|--------|---------|-------|
| | Deciduous/Ornamental | Evergreen | Shrubs | Grasses | |
| 12,674 Sq. Ft. | 48 | 1 | 293 | 99 | |

Overall Site Landscape Area Summary (Excluding Parking Lot Islands)

| Area/Sq. Ft. | Trees | | | | Notes |
|----------------|----------------------|-----------|--------|---------|--|
| | Deciduous/Ornamental | Evergreen | Shrubs | Grasses | |
| 64,793 Sq. Ft. | 93 | 76 | 1232 | 636 | Evergreen Trees = 45% Deciduous Trees = 55% |

Grand Total Overall Site Area Summary (Not Covered By Bldg. & Req. Pkg.)

| Area/Sq. Ft. | Trees | | | | Notes |
|-----------------|----------------------|-----------|--------|---------|--|
| | Deciduous/Ornamental | Evergreen | Shrubs | Grasses | |
| 204,520 Sq. Ft. | 141 | 77 | 1525 | 735 | At 1 Tree & 5 Shrubs/1500 sf = 136 Trees & 681 Shrubs Required Evergreen Trees = 35% |

| Landscape Area | High Water TURF (6,000sf = 1 SFE) | Low Water Native Grass and Spray Shrubs & Perennials (10,000sf = 1 SFE) | Drip Irrigated area (20,000sf = 1 SFE) | Sub-Total of Non-Irrigated area (calculated) Areas | PWSD one SFE per 6000 | SFE Requirement (Sub-Total Calculation divided by 6000 = requirement) |
|----------------|-----------------------------------|---|--|--|-----------------------|---|
| | Area #1 | 27,131 sf x 1 = 27,131 | 2088 sf x .6 = 1253 | 23,330 sf x .3 = 6,999 | 6280 sf x 0 = 0 | 35,382 sf |
| | | | | | | 5.90 SFE's = 2" Tap Required |

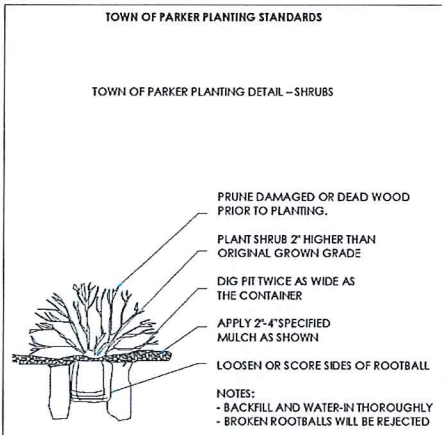
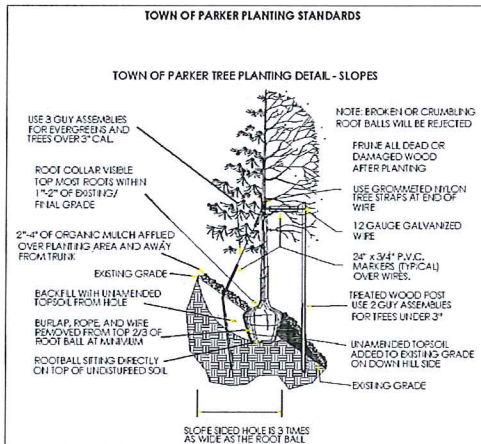
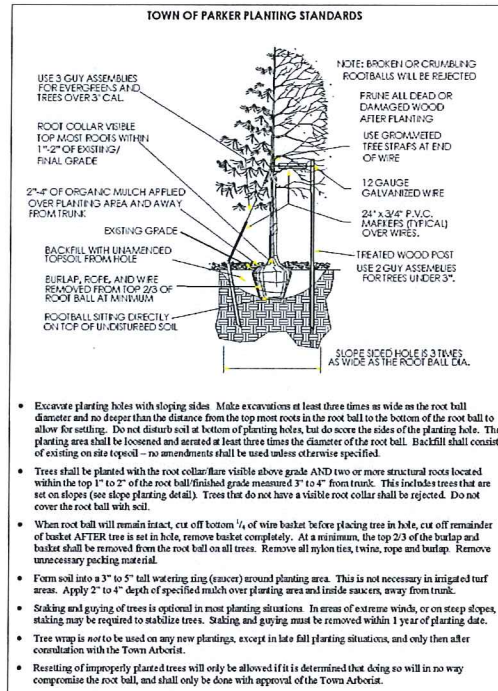

NOTES:

- All work shall conform to local Town Codes, and contractor shall be responsible for obtaining all necessary permits. Contractor shall verify location of all existing underground utilities, lines, and structures prior to excavation or trenching. Damage to these utilities shall be repaired by the contractor at no cost to the owner or the landscape architect.
- No substantial change from the approved landscape plan may occur without prior review of the Parker Water and Sanitation District, which may require additional irrigation taps for changes due to more water intensive landscaping.
- All plants shall meet or exceed the plant quality and species standards of the American Standard for Nursery Stock ANSI Z60.1-2004, as amended. Selected plant materials shall be healthy and shall be nursery-grown and adapted to the local area.
- Unless otherwise indicated on the plan, all trees shall be located at least 4 ft. from the parking lot curb or edge of a parking island.
- All shrub beds and turf areas shall receive the following soil amendments per 1000 s.f.: 3 CY "Supreme Organics" compost (50% cow manure, 50% wood fines, supplied by Jensen Sales, Inc., Denver) or equivalent, plus 15 lbs of 20-10-5 commercial fertilizer. Rotate to a minimum depth of 6".
- Plant backfill mix shall be: 1/3 "Supreme Organics", or approved equal 2/3 on site soil
- All annual and perennial beds, and freestanding planters areas will be mulched with shredded Cascade cedar, or other acceptable shredded cedar mulch, to a depth of 3". With no weed barrier.
- All trees in turf grass areas must have tree rings mulched with shredded Cascade cedar, or other acceptable shredded cedar mulch, to a depth of 3", over DuPont "Typar" weed barrier, or approved equal.
- Shrub beds near mini-golf course and race track areas to be mulched with 1-1/2" Mountain Granite or Bluestone to a depth of 3", over DuPont "Typar" weed barrier, or approved equal.
- All parking lot island and parking lot perimeter areas to be mulched with 1-1/2" Tan (Western) River Rock to a depth of 3", over DuPont "Typar" weed barrier, or approved equal.
- Steel edger to be rolled top, 14 gage X 4" deep, green painted Dura-edge edger, or approved equal.
- All landscaped areas and plant materials shall be watered by automatic underground systems. The irrigation system will provide full coverage to all turf and plant material areas. Turf areas to be spray irrigated, and shrubs and trees to be drip irrigated.
- Landscaped areas and plant materials shown on these plans indicate those proposed to be installed. However, alternative plant materials may be installed during final construction, if done in compliance with the Town approved plant lists.
- The Owner, his successors and assigns, shall be responsible for installation, maintenance and replacement of all landscaping materials shown or indicated on the approved Site Plan or Landscape Plan on file in the Planning Department. Landscaping will be installed as delineated on the plan, and in conjunction with any development phasing.

PLANT & MATERIALS SCHEDULE

| QTY. | ITEM | COMMON NAME | SCIENTIFIC NAME | SIZE | Comments |
|-----------------------------------|------|--|--|--------------|-------------------------|
| DECIDUOUS SHADE TREES | | | | | |
| 4 | IMP | Imperial Honeylocust | Gleditsia triacanthos 'Imperial' | 2" Cal | B&B |
| 20 | SHI | Shademaster Honeylocust | Gleditsia triacanthos 'Shademaster' | 2" Cal | B&B |
| 6 | RLI | Redmond Linden | Tilia americana 'Redmond' | 2" Cal | B&B |
| 7 | CSM | Crimson Sentry Maple | Acer platanoides 'Crimson Sentry' | 2" Cal | B&B |
| 4 | BOA | Bur Oak | Quercus macrocarpa | 2" Cal | B&B |
| 4 | EOA | English Oak | Quercus robur | 2" Cal | B&B |
| 3 | ROA | Northern Red Oak | Quercus rubra | 2" Cal | B&B |
| 28 | TEX | Texas Red Oak | Quercus buckleyi | 2" Cal | B&B |
| EVERGREEN TREES | | | | | |
| 5 | CCF | Concolor Fir/White Fir | Abies concolor | 6" Ht | B&B |
| 7 | AUS | Austrian Pine | Pinus nigra | 6" Ht | B&B |
| 7 | PIN | Pinon Pine | Pinus edulis | 6" Ht | B&B |
| 20 | PON | Ponderosa Pine | Pinus ponderosa | 6" Ht | B&B |
| 1 | BSP | Baker Spruce | Picea pungens 'Baker' | 6" Ht | B&B |
| 2 | CSP | Colorado Blue Spruce | Picea pungens | 6" Ht | B&B |
| 15 | MEJ | Medora Juniper | Juniperus scopulorum 'Medora' | 7 Gal. | 4" Min. Ht. |
| 5 | SPA | Spartan Juniper | Juniperus chinensis 'Spartan' | 7 Gal. | 4" Min. Ht. |
| 7 | WBL | Wichita Blue Juniper | Juniperus scopulorum 'Wichita Blue' | 7 Gal. | 4" Min. Ht. |
| DECID. ORNAMENTAL TREES | | | | | |
| 14 | PRF | Prunella Crab | Malus spp. 'Prunella' | 1.75" Cal | B&B |
| 6 | ALC | Thunderchild Crab | Malus x 'Thunderchild' | 1.75" Cal | B&B |
| 11 | TCC | Thunderchild Crab | Malus x 'Thunderchild' | 1.75" Cal | B&B |
| 12 | GRT | Goldenrain Tree | Koeleruteria paniculata | 1.75" Cal | B&B |
| 18 | GAC | Ginnala Hilly | Acer ginnala | 6-8" Clump | B&B |
| DECIDUOUS SHRUBS | | | | | |
| 64 | CPB | Crimson Pygmy Barberry | Berberis thunbergii 'Aurropurea Nana' | 5 Gal. | 15" Min. Ht. |
| 51 | RBA | Red Barberry | Berberis thunbergii 'Aurropurea' | 5 Gal. | 18" Min. Ht. |
| 106 | DBB | Dwarf Burning Bush | Euroyymus alata 'Compacta' | 5 Gal. | 18" mul. established |
| 26 | BRE | Butterfly Bush | Buddleia davidii | 5 Gal. | 24" mul. established |
| 39 | DAC | Dwarf American Cranberry | Viburnum trilobum 'Compactum' | 5 Gal. | 18" mul. established |
| 13 | RTD | Red Twig Dogwood | Cornus sericea 'Ratay' | 5 Gal. | 24" mul. established |
| 3 | CPL | Common Purple Lilac | Syringa vulgaris | 5 Gal. | 18-24" mul. established |
| 39 | MKL | Miss Kim Lilac | Syringa patula 'Miss Kim' | 5 Gal. | 18-24" mul. established |
| 63 | GDP | Gold Drop Potentilla | Potentilla fruticosa 'Gold Drop' | 5 Gal. | 18-24" mul. established |
| 11 | GFP | Goldfinger Potentilla | Potentilla fruticosa 'Goldfinger' | 5 Gal. | 24" mul. established |
| 75 | RSA | Russian Sage | Perovskia atriplicifolia | 5 Gal. | 24" mul. established |
| 6 | PBS | Panama Buttes Sand Cherry | Prunus besseyi 'Panama Buttes' | 5 Gal. | 18" mul. established |
| 9 | DSP | Daphne Spirea | Spiraea japonica var. alpina | 5 Gal. | 18" mul. established |
| 97 | SFQ | Fairy Queen Spirea | Spiraea trilobata 'Fairy Queen' | 5 Gal. | 24" mul. established |
| 111 | NFS | Neon Flash Spirea | Spiraea japonica 'Neon Flash' | 5 Gal. | 24" mul. established |
| 28 | LPS | Lime Fire Spirea | Spiraea japonica 'Lime Fire' | 5 Gal. | 18" mul. established |
| 16 | VBM | Blue Muffin Viburnum | Viburnum dentatum 'Christom' | 5 Gal. | 24-30" mul. established |
| 23 | VKS | Korean Spice Viburnum | Viburnum carlesii | 5 Gal. | 24" mul. established |
| 10 | CSJ | Staghorn Sumac | Rhus typhina 'Lancinata' | 5 Gal. | 24" mul. established |
| 61 | KNP | Knockout Pink Rose | Rosa 'RADCON' | 2 to 5 Gal. | 24" mul. established |
| 55 | KNR | Knockout Red Rose | Rosa 'RADRAZ' | 2 to 5 Gal. | 24" mul. established |
| BROADLEAF EVERGREEN SHRUBS | | | | | |
| 26 | BSL | Broom Scotch Lantana | Cydonia oblonga 'Lantana' | 5 Gal. | 20-24" Min. Ht. |
| 66 | BSG | Broom Spanish Gold | Cydonia purpur Spanish Gold' | 5 Gal. | 20-24" Min. Ht. |
| 11 | CTT | Tom Thumb Cotoneaster | Cotoneaster apiculata 'Tom Thumb' | 5 Gal. | 18" Min. Spread |
| 27 | COJ | Shrub Cotoneaster | Cotoneaster divaricata | 5 Gal. | 20-24" Min. Ht. |
| 4 | CHO | Rock Cotoneaster | Cotoneaster horizontalis | 5 Gal. | 18" Min. Spread |
| 18 | EOG | Canada Gold Euonymus | Euonymus alata 'Canada Gold' | 5 Gal. | 18-20" Min. Ht. |
| 32 | MAQ | Mahonia Oregon Grape | Mahonia aquifolium 'Kings Ransom' | 5 Gal. | 20" Min. Ht. |
| 17 | MEQ | Compact Mahonia Oregon Grape | Mahonia aquifolium 'Compacta' | 5 Gal. | 20" Min. Ht. |
| 65 | MRE | Creeping Oregon Grape | Mahonia repens | 1 Gal. | 12" Min. Ht. |
| EVERGREEN SHRUBS | | | | | |
| 9 | AND | Andora Juniper | Juniperus horizontalis 'Youngblow' | 5 Gal. | 18" Min. Spread |
| 16 | ARM | Armstrong Juniper | Juniperus chinensis 'Armstrong' | 5 Gal. | 18" Min. Spread |
| 13 | BCH | Blue Chip Juniper | Juniperus horizontalis 'Blue Chip' | 5 Gal. | 18" Min. Spread |
| 45 | BLF | Buffalo Juniper | Juniperus sibirica 'Buffalo' | 5 Gal. | 18" Min. Spread |
| 62 | HSE | Hughes Juniper | Juniperus horizontalis 'Hughes' | 5 Gal. | 18" Min. Spread |
| 3 | SEA | Sea Green Juniper | Juniperus x media 'Sea Green' | 5 Gal. | 18" Min. Spread |
| 19 | OLD | Old Gold/Gold Coast Juniper | Juniperus x media 'Old Gold' | 5 Gal. | 18" Min. Spread |
| 10 | WL | Wilson Blue Rug Juniper | Juniperus horizontalis 'Wilson' | 5 Gal. | 18" Min. Spread |
| 19 | MMO | Mugo Pine, Mops | Pinus mugo 'Mops' | 3 Gal. | 24" Min. Ht. |
| 7 | MSL | Mugo Pine, Slowmound | Pinus mugo 'Slowmound' | 3 Gal. | 12" Min. Ht. |
| 9 | GSP | Globe Blue Spruce | Picea pungens 'Globose' | 3 Gal. | 18" Min. Ht. |
| ORNAMENTAL GRASSES | | | | | |
| 192 | AVG | Blue Avena Oat Grass | Helictotrichon sempervirens | 1 Gal. | 12" Min. Spread |
| 217 | FRG | Feather Reed Grass | Calamagrostis acutiflora 'Karl Foerster' | 1 Gal. | 24-30" oc. |
| 118 | LBS | Lute Bluestem | Schizanthium scopulorum 'Blues' | 1 Gal. | 18-24" oc. |
| 121 | PMG | Maiden Grass, Purple/Flame | Miscanthus sinensis 'Purpureuscent' | 1 Gal. | 18-24" oc. |
| 67 | RCG | Red Switch Grass | Panicum virgatum 'Shenandoah' | 1 Gal. | 24-30" oc. |
| ANNUALS | | | | | |
| 750 | MXA | Mixed Annuals / Perennials / Winter Panties - 80% Annuals | | 2" - 6" pots | 10' oc. |
| 50 | MXA | Mixed Annuals / Perennials / Winter Panties - 20% Perennials | | 1 Gal. | 20' oc. |



REVISIONS

| DESCRIPTION | DATE |
|-----------------------|---------|
| OWNER CHANGES | 2/16/15 |
| SITE SUBMITTAL | 3/11/15 |
| FORM & COORDINATION | 5/7/15 |
| REG. ISLAND SUBMITTAL | 5/21/15 |
| REG. ISLANDS APPROVED | 8/11/15 |

SEARCH DEVELOPMENT & CONTRACTING, LLC

860 EAST FRANKLIN ROAD, MERIDIAN, ID 83642

Boondocks

Team Growth

CROWN POINT DEVELOPMENT PARKER, CO

COPYRIGHT 2015

Peter H. Rockwell, Architect

Architect • Planning • Interior Design

595 S. American Blvd. • Boise, Idaho 83702

(208) 345-0566 • (208) 345-1718 • Fax: (208) 387-0689

office@peterhrockwell.com

SITE PLAN LANDSCAPE PLAN (PLANT LIST NOTES & DETAILS)

SHEET DATA

DRAWN BY: KJS
CHECKED BY: KJS
SCALE: 1" = 20'
DATE: 3/11/15
PROJECT # 14001
SHEET NUMBER

Prepared By: Kirby Smith & Associates, Inc.

1111 S. Bascom St. • Suite 200 • San Jose, CA 95128
(408) 938-9441 • (408) 938-9272
Job # 408

CALL UTILITY NOTIFICATION CENTER OF COLORADO

811

CALL 800-488-8847 BEFORE YOU DIG, GRADE, OR EXCAVATE FOR THE SAFETY OF YOUR PROJECT AND NEIGHBORHOOD UTILITIES.

L-3