



DIMENSIONS							
8 Pole 2 Level Sky Trail® Discovery with (1) 60° Sky Rail®							
# of Elements	Capacity	Imperial (ft/in)			Metric (m)		
		Length	Width	Area	Length	Width	Area
28	40	67' 8"	57' 5"	3886 ft <sup>2</sup>	20.63m	17.51m	361m <sup>2</sup>
<b>Distance Between Columns</b>		20' 0"			6.10m		
<b>Total Sky Rail® Length</b>		67' 5"			20.55m		
<b>Clearance Under Course</b>		9' 0"			2.74m		
<b>Platform Heights</b>		12' 0" / 24' 0"			3.66m / 7.32m		
<b>Top of Steel Height</b>		38' 0"			11.59m		
<b>Features</b>		Sky Rail® Popular Elements: - Rolling Log - Roller Rail					

Customizations:

- Column hand holes - See column details
- Sun shade over takeoff platform

COLORS APPROVED

Platforms: Iron Horse	Horizontals: Green Gone Wild	Verticals: Mandarin	Plumber: Cedar	Slingline: Brown	Rope: Tan	Pad: Royal Blue	Sun Shades: Aquatic Blue
--------------------------	---------------------------------	------------------------	-------------------	---------------------	--------------	--------------------	-----------------------------

FINAL COLOR SCHEME

Notes:  
 Additional design work may be required  
 Final course design subject to change per engineering  
 Product pictured may contain custom components  
 Colors shown may vary from delivered product. Physical samples available upon request  
 Field verify all dimensions, heights and clearances prior to engineering

LEGAL DESCRIPTION:

LOT 4A, CROWN POINT FILING #1  
 LOCATED IN A PORTION OF THE SW 1/4 OF SECTION 3,  
 T6S, R66W, 6TH P.M., COUNTY OF DOUGLAS, STATE OF COLORADO

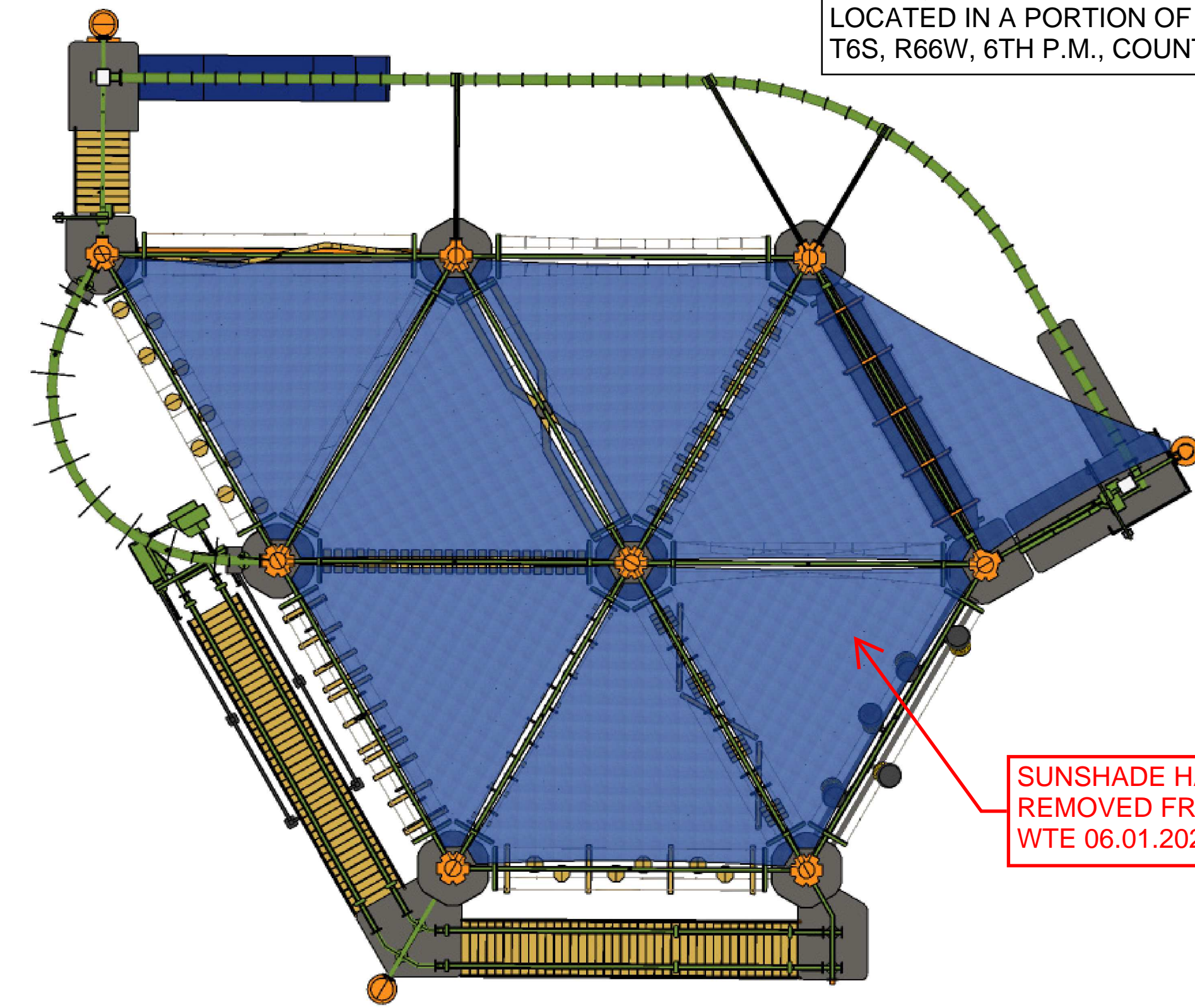

PLAN

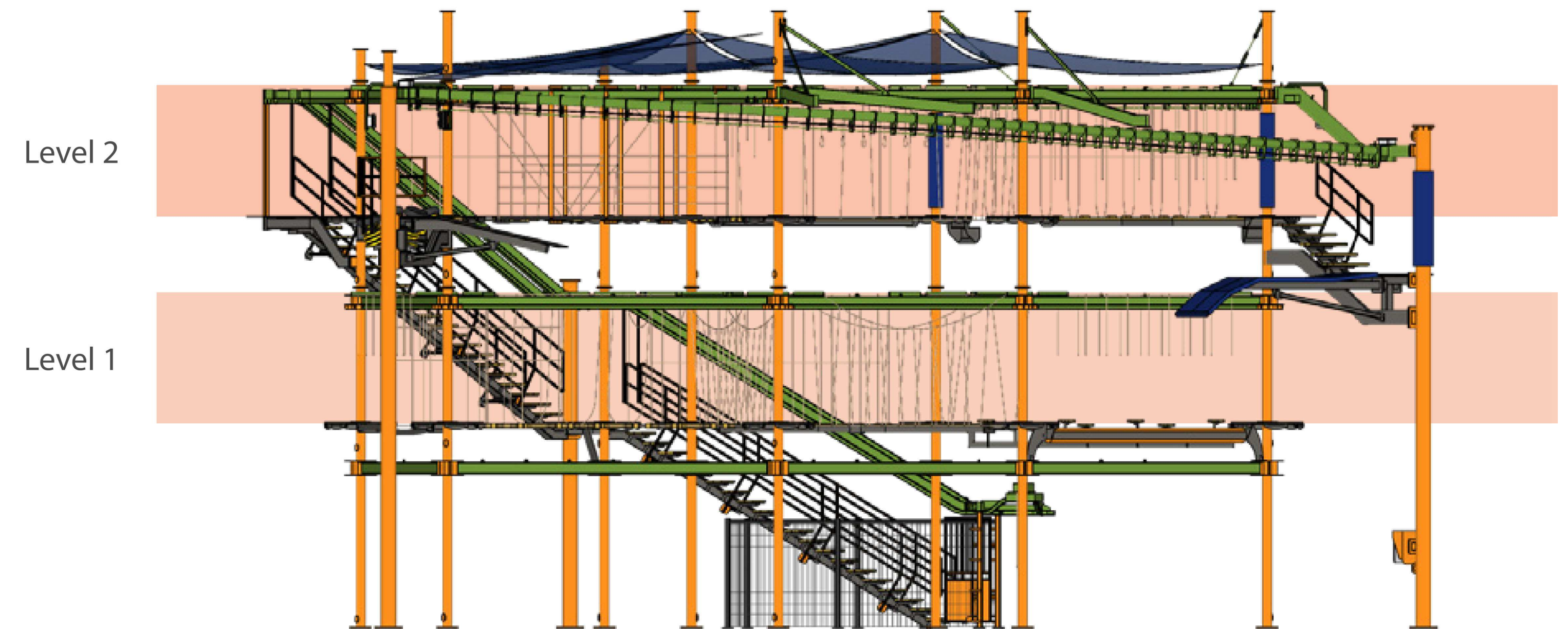

ELEVATION

R5.01\_Boondocks Food and Fun - Parker.skp

October 26, 2021

This drawing contains a confidential proprietary design that cannot be reproduced or divulged, in whole or in part, without written authorization from RCI Adventure Products. All design, manufacturing, reproduction, use, sale, or other rights regarding this design are expressly reserved. The information in this drawing may contain patents pending.

