

LAND OF SUSHI

CROWN POINT FILING NO.1 LOT 4E

LOCATED IN THE SOUTHWEST QUARTER OF SECTION 3, TOWNSHIP 6 SOUTH, RANGE 66 WEST OF THE 6TH PRINCIPAL MERIDIAN, CITY OF PARKER, COUNTY OF DOUGLAS, STATE OF COLORADO

SITE PLAN DOCUMENTS

NOVEMBER 2024

PLANTING NOTES

- GENERAL**
- ALL WORK SHALL CONFORM TO ALL APPLICABLE STATE AND LOCAL CODES, STANDARDS, AND SPECIFICATIONS.
 - LANDSCAPE DESIGN IS DIAGRAMMATIC IN NATURE. THE CONTRACTOR SHALL BE RESPONSIBLE FOR HIS OWN TAKEOFFS AND QUANTITY CALCULATIONS. IN THE EVENT OF A DISCREPANCY BETWEEN THE PLAN AND THE LANDSCAPE LEGEND, THE PLANT QUANTITY AS SHOWN ON THE PLAN SHALL TAKE PRECEDENCE AND NOTIFY THE LANDSCAPE ARCHITECT OF THESE DISCREPANCIES. MINOR ADJUSTMENTS TO THE LANDSCAPE MATERIAL AND LOCATIONS MAY BE PROPOSED FOR CITY CONSIDERATION AT THE CONSTRUCTION DOCUMENT STAGE TO RESPOND TO MARKET AND FIELD CONDITIONS. HOWEVER, THERE SHALL BE NO REDUCTION IN THE NUMBER AND SIZE OF MATERIALS.
 - CONTRACTOR SHALL MAKE HIMSELF AWARE OF THE LOCATIONS OF EXISTING AND PROPOSED UTILITIES, AND SHALL BE RESPONSIBLE FOR ANY DAMAGE TO THE UTILITIES AND/OR ANY INJURY TO ANY PERSON. THIS DRAWING IS PART OF A COMPLETE SET OF CONTRACT DOCUMENTS. UNDER NO CIRCUMSTANCES SHOULD THIS PLAN BE USED FOR CONSTRUCTION PURPOSES WITHOUT EXAMINING ACTUAL LOCATIONS OF UTILITIES ON SITE AND REVIEW ALL RELATED PLANS AND DOCUMENTS.
 - ALL UTILITY EASEMENTS SHALL REMAIN UNOBSTRUCTED AND FULLY ACCESSIBLE ALONG THEIR ENTIRE LENGTH FOR MAINTENANCE EQUIPMENT.
 - THE CONTRACTOR SHALL TAKE EXTREME CARE NOT TO DAMAGE ANY EXISTING PLANTS INDICATED AS "TO REMAIN". ANY SUCH PLANTS DAMAGED BY THE CONTRACTOR SHALL BE REPLACED WITH THE SAME SPECIES, SIZE, AND QUANTITY AT THE CONTRACTOR'S OWN EXPENSE, AND AS ACCEPTABLE TO THE OWNER. REFER TO THE TREE PROTECTION NOTES ON THE PLANS (AS APPLICABLE).
 - LANDSCAPE CONTRACTOR SHALL EXAMINE THE SITE CONDITIONS UNDER WHICH THE WORK IS TO BE PERFORMED AND NOTIFY THE GENERAL CONTRACTOR IN WRITING OF UNSATISFACTORY CONDITIONS. IF SITE CONDITIONS OR PLANT AVAILABILITY REQUIRE CHANGES TO THE PLAN, THEN AN APPROVAL WILL BE OBTAINED FROM THE CITY. DO NOT PROCEED UNTIL CONDITIONS HAVE BEEN CORRECTED.
 - ALL CONSTRUCTION DEBRIS AND MATERIAL SHALL BE REMOVED AND CLEANED OUT PRIOR TO INSTALLATION OF TOPSOIL, TREES, SHRUBS, AND TURF.
 - FOR ALL INFORMATION ON SURFACE MATERIAL OF WALKS, DRIVES, AND PARKING LOTS, SEE THE SITE PLAN. SEE PHOTOMETRIC PLAN FOR FREE STANDING LIGHTING INFORMATION.
 - THE LANDSCAPE CONTRACTOR SHALL NOTIFY THE LANDSCAPE ARCHITECT ONE WEEK PRIOR TO BEGINNING CONSTRUCTION.
 - WINTER WATERING SHALL BE AT THE EXPENSE OF THE CONTRACTOR UNTIL SUCH TIME AS FINAL ACCEPTANCE IS RECEIVED.
 - ALL LANDSCAPE CONSTRUCTION PRACTICES, WORKMANSHIP, AND ETHICS SHALL, BE IN ACCORDANCE WITH INDUSTRY STANDARDS SET FORTH IN THE CONTRACTORS HANDBOOK PUBLISHED BY THE COLORADO LANDSCAPE CONTRACTORS ASSOCIATION.
 - LANDSCAPE AND IRRIGATION WORK SHALL BE COMPLETED PRIOR TO THE ISSUANCE OF THE FINAL CERTIFICATE OF OCCUPANCY.
- FINISH GRADING AND SOIL PREPARATION**
- CONTRACTOR SHALL CONSTRUCT AND MAINTAIN FINISH GRADES AS RECOMMENDED BY THE GEOTECHNICAL REPORT. ALL LANDSCAPE AREAS SHALL HAVE POSITIVE DRAINAGE AWAY FROM STRUCTURES AT THE MINIMUM SLOPE SPECIFIED IN THE REPORT, AND AREAS OF POTENTIAL PONDING SHALL BE REGRADED TO BLEND IN WITH THE SURROUNDING GRADES AND ELIMINATE PONDING POTENTIAL. SHOULD ANY CONFLICTS AND/OR DISCREPANCIES ARISE BETWEEN THE GEOTECHNICAL REPORT, THE GRADING PLANS, THESE NOTES, AND ACTUAL CONDITIONS, THE CONTRACTOR SHALL IMMEDIATELY BRING SUCH ITEMS TO THE ATTENTION OF THE LANDSCAPE ARCHITECT AND OWNER.
 - AFTER FINISH GRADES HAVE BEEN ESTABLISHED, IT IS RECOMMENDED THAT THE CONTRACTOR SHALL HAVE SOIL SAMPLES TESTED BY AN ESTABLISHED SOIL TESTING LABORATORY FOR THE FOLLOWING: GENERAL SOIL FERTILITY, PH, ORGANIC MATTER CONTENT, SALT (EC), LIME, SODIUM ADSORPTION RATIO (SAR) AND BORON CONTENT. EACH SAMPLE SUBMITTED SHALL CONTAIN NO LESS THAN ONE QUART OF SOIL. CONTRACTOR SHALL ALSO SUBMIT THE PROJECT'S PLANT LIST TO THE LABORATORY ALONG WITH THE SOIL SAMPLES. THE SOIL REPORT PRODUCED BY THE LABORATORY SHALL CONTAIN RECOMMENDATIONS FOR THE FOLLOWING (AS APPROPRIATE): GENERAL SOIL PREPARATION AND BACKFILL MIXES, PRE-PLANT FERTILIZER APPLICATIONS, AND ANY OTHER SOIL RELATED ISSUES. THE REPORT SHALL ALSO PROVIDE A FERTILIZER PROGRAM FOR THE ESTABLISHMENT PERIOD AND FOR LONG-TERM MAINTENANCE.
 - THE CONTRACTOR SHALL RECOMMEND INSTALLATION OF SOIL AMENDMENTS AND FERTILIZERS PER THE SOILS REPORT FOR THE OWNER/OWNER'S REPRESENTATIVE CONSIDERATION.
 - AT A MINIMUM, ALL TOPSOIL SHALL BE AMENDED WITH NITROGEN STABILIZED ORGANIC AMENDMENT COMPOST AT A RATE OF 5.0 CUBIC YARDS AND AMMONIUM PHOSPHATE 16-20-0 AT A RATE OF 15 POUNDS PER THOUSAND SQUARE FEET OF LANDSCAPE AREA. COMPOST SHALL BE MECHANICALLY INTEGRATED INTO THE TOP 6" OF SOIL BY MEANS OF ROTOTILLING AFTER CROSS-RIPPING. GROUND COVER & PERENNIAL BED AREAS SHALL BE AMENDED AT A RATE OF 8 CUBIC FEET PER THOUSAND SQUARE FEET OF NITROGEN STABILIZED ORGANIC AMENDMENT AND 10 LBS. OF 12-12-12 FERTILIZER PER CU. YD., ROTOTILLED TO A DEPTH OF 8". NO MANURE OR ANIMAL-BASED PRODUCTS SHALL BE USED FOR ORGANIC AMENDMENTS.
- PLANTING**
- ALL DECIDUOUS TREES SHALL HAVE FULL, WELL-SHAPED HEADS/ALL EVERGREENS SHALL BE UNSHARED AND FULL TO THE GROUND; UNLESS OTHERWISE SPECIFIED. TREES WITH CENTRAL LEADERS WILL NOT BE ACCEPTED IF LEADER IS DAMAGED OR REMOVED. PRUNE ALL DAMAGED TWIGS AFTER PLANTING.
 - ALL PLANTS WITHIN A SPECIES SHALL HAVE SIMILAR SIZE, AND SHALL BE OF A FORM TYPICAL FOR THE SPECIES. ANY PLANT DEEMED UNACCEPTABLE BY THE LANDSCAPE ARCHITECT SHALL BE IMMEDIATELY REMOVED FROM THE SITE AND SHALL BE REPLACED WITH AN ACCEPTABLE PLANT OF LIKE TYPE AND SIZE AT THE CONTRACTOR'S OWN EXPENSE. ANY PLANTS APPEARING TO BE UNHEALTHY, EVEN IF DETERMINED TO STILL BE ALIVE, SHALL NOT BE ACCEPTED. THE LANDSCAPE ARCHITECT SHALL BE THE SOLE JUDGE AS TO THE ACCEPTABILITY OF PLANT MATERIAL.
 - ALL TREES SHALL BE GUYED AND WOOD STAKED AS PER DETAILS. NO "T-STAKES" SHALL BE USED FOR TREES.
 - ALL PLANT MATERIALS SHALL BE TRUE TO TYPE, SIZE, SPECIES, QUALITY, AND FREE OF INJURY, BROKEN ROOT BALLS, PESTS, AND DISEASES, AS WELL AS CONFORM TO THE MINIMUM REQUIREMENTS DESCRIBED IN THE "AMERICAN STANDARD FOR NURSERY STOCK". FOLLOW GREENCO TREE PLANTING RECOMMENDATIONS FOR MINIMUM QUALITY REQUIREMENTS FOR TREES.
 - ALL TREE AND SHRUB BED LOCATIONS ARE TO BE STAKED OUT ON SITE FOR APPROVAL BY THE LANDSCAPE ARCHITECT PRIOR TO INSTALLATION.
 - ALL TREES PLANTED ADJACENT TO PUBLIC AND/OR PEDESTRIAN WALKWAYS SHALL BE PRUNED CLEAR OF ALL BRANCHES BETWEEN GROUND AND A HEIGHT OF EIGHT (8) FEET FOR THAT PORTION OF THE PLAN LOCATED OVER THE SIDEWALK AND/OR ROAD.
 - ALL PLANT MATERIAL SHALL NOT BE PLANTED PRIOR TO INSTALLATION OF TOPSOIL.
 - ALL PLANT BEDS SHALL BE CONTAINED WITH STEEL EDGER. STEEL EDGER IS NOT REQUIRED ALONG CURBS, WALKS OR BUILDING FOUNDATIONS. ALL EDGING SHALL OVERLAP AT JOINTS A MINIMUM OF 6-INCHES, AND SHALL BE FASTENED WITH A MINIMUM OF 4 PINS PER EACH 10 FOOT SECTION. THE TOP OF ALL EDGING MATERIAL SHALL BE A ROLLED TOP AND 1/2 INCH ABOVE THE FINISHED GRADE OF ADJACENT LAWN OR MULCH AREAS. COLOR: GREEN.
 - THE DEVELOPER, HIS SUCCESSOR, OR ASSIGNEE SHALL BE RESPONSIBLE FOR ESTABLISHING AND CONTINUING A REGULAR PROGRAM OF MAINTENANCE FOR ALL LANDSCAPED AREAS. SEE LANDSCAPE GUARANTEE AND MAINTENANCE NOTE.
 - A 3-FOOT CLEAR SPACE SHALL BE MAINTAINED AROUND THE CIRCUMFERENCE OF ALL FIRE HYDRANTS.
 - LANDSCAPE CONTRACTOR TO SUBMIT SAMPLES OF MISCELLANEOUS LANDSCAPING MATERIALS TO THE LANDSCAPE ARCHITECTS AND OWNER'S REPRESENTATIVE FOR APPROVAL PRIOR TO INSTALLATION, IE; MULCH, EDGER, LANDSCAPE FABRIC, ETC.
- MULCHING**
- AFTER ALL PLANTING IS COMPLETE, THE CONTRACTOR SHALL INSTALL A MINIMUM 4" THICK LAYER OF MULCH AS SPECIFIED IN THE PLANTING LEGEND. INSTALL A 4" THICK RING OF DOUBLE SHREDDED CEDAR BARK MULCH AROUND ALL PLANT MATERIAL IN ROCK MULCH BEDS WHERE LANDSCAPING IS SHOWN ON THE PLANS. WOOD MULCH RING SIZE SHALL BE THE CONTAINER SIZE OF THE SHRUBS, PERENNIALS, AND ORNAMENTAL GRASSES. TREE RING SIZE SHALL BE GREEN INDUSTRIES OF COLORADO INDUSTRY STANDARD WIDTH.
 - ALL MULCH SHALL BE HARVESTED IN A SUSTAINABLE MANNER FROM A LOCAL SOURCE.
 - INSTALL DEMITT PRO-5 WEED BARRIER FABRIC UNDER ALL ROCK MULCH SHRUB BEDS SPECIFIED ON THE PLANS ONLY. NO LANDSCAPE FABRIC SHALL BE USED IN WOOD MULCH AREAS. NO PLASTIC WEED BARRIERS SHALL BE SPECIFIED.
 - ABSOLUTELY NO EXPOSED GROUND SHALL BE LEFT SHOWING ANYWHERE ON THE PROJECT AFTER MULCH HAS BEEN INSTALLED.
 - ALL PLANTING AREAS WITH LESS THAN A 4:1 GRADIENT SHALL RECEIVE A LAYER OF MULCH, TYPE AND DEPTH PER PLANS. SUBMIT 1 CUBIC FOOT SAMPLE OF MULCH (ONE SAMPLE PER TYPE) TO LANDSCAPE ARCHITECT FOR APPROVAL PRIOR TO INSTALLATION. THE MULCH SHALL BE SPREAD EVENLY THROUGHOUT ALL PLANTING AREAS EXCEPT SLOPES 4:1 OR STEEPER, OR AS OTHERWISE DENOTED ON THE PLAN. ABSOLUTELY NO EXPOSED GROUND SHALL REMAIN IN AREAS TO RECEIVE MULCH AFTER MULCH HAS BEEN INSTALLED.
 - ALL PLANTING AREAS ON SLOPES OVER 4:1 SHALL RECEIVE COCONUT FIBER EROSION CONTROL NETTING FROM ROLLS. NETTING SHALL BE 6CT-12S, AS MANUFACTURED BY NORTH AMERICAN GREEN (OR EQUAL). INSTALL AND STAKE PER MANUFACTURER'S SPECIFICATIONS. SEE ALSO THE CIVIL ENGINEER'S EROSION CONTROL PLAN.

IRRIGATION CONCEPT

- AN AUTOMATIC IRRIGATION SYSTEM SHALL BE INSTALLED AND OPERATIONAL BY THE TIME OF FINAL INSPECTION. THE ENTIRE IRRIGATION SYSTEM SHALL BE INSTALLED BY A QUALIFIED IRRIGATION CONTRACTOR.
- THE IRRIGATION SYSTEM WILL HAVE APPROPRIATE BACKFLOW PREVENTION DEVICES INSTALLED TO PREVENT CONTAMINATION OF THE WATER SOURCE IF APPLICABLE.
- ALL NON-TURF/SEED PLANTED AREAS WILL BE DRIP IRRIGATED. TURF SOO/SEED SHALL RECEIVE POP-UP SPRAY IRRIGATION FOR HEAD TO HEAD COVERAGE.
- ALL PLANTS SHARING SIMILAR HYDROZONE CHARACTERISTICS SHALL BE PLACED ON A VALVE DEDICATED TO PROVIDE THE NECESSARY WATER REQUIREMENTS SPECIFIC TO THAT HYDROZONE.
- THE IRRIGATION SYSTEM SHALL BE DESIGNED AND INSTALLED, TO THE MAXIMUM EXTENT POSSIBLE, TO CONSERVE WATER BY USING THE FOLLOWING DEVICES AND SYSTEMS: MATCHED PRECIPITATION RATE TECHNOLOGY ON ROTOR AND SPRAY HEADS (WHEREVER POSSIBLE), RAIN SENSORS, AND SMART MULTI-PROGRAM COMPUTERIZED IRRIGATION CONTROLLERS FEATURING SENSORY INPUT CAPABILITIES.

LANDSCAPE GUARANTEE AND MAINTENANCE

- THE LANDSCAPE CONTRACTOR SHALL GUARANTEE ALL TREES, SHRUBS, PERENNIALS, SOO, SEEDS AREAS, AND IRRIGATION SYSTEMS FOR A PERIOD OF ONE YEAR FROM THE DATE OF THE OWNER'S ACCEPTANCE. THE CONTRACTOR SHALL REPLACE, AT HIS OWN EXPENSE, ANY PLANTS WHICH DIE IN THAT TIME, OR REPAIR ANY PORTIONS OF THE IRRIGATION SYSTEM WHICH OPERATE IMPROPERLY.
- THE LANDSCAPE CONTRACTOR SHALL MAINTAIN THE LANDSCAPE IN A NEAT, CLEAN, AND HEALTHY CONDITION FOR A PERIOD OF 90 DAYS. THIS SHALL INCLUDE PROPER PRUNING, MOWING AND AERATION OF LAWNS, WEEDING, REPLACEMENT OF MULCH, REMOVAL OF LITTER, AND THE APPROPRIATE WATERING OF ALL PLANTINGS. IRRIGATION SHALL BE MAINTAINED IN PROPER WORKING ORDER, WITH SCHEDULING ADJUSTMENTS BY SEASON AND TO MAXIMIZE WATER CONSERVATION. IF SITE OPENS DURING WINTER, TO AVOID FREEZE DAMAGE ON PLANTINGS, THE 90 DAYS SHOULD BEGIN AFTER ACCEPTANCE OF THE WORK.
- DURING THE LANDSCAPE MAINTENANCE PERIOD, THE LANDSCAPE CONTRACTOR SHALL MAINTAIN POSITIVE DRAINAGE AWAY FROM STRUCTURES IN ALL LANDSCAPE AREAS AT THE MINIMUM SLOPE SPECIFIED IN THE GEOTECHNICAL REPORT. LANDSCAPE AREAS WHICH SETTLE AND CREATE THE POTENTIAL FOR PONDING SHALL BE REPAIRED TO ELIMINATE PONDING POTENTIAL AND BLEND IN WITH THE SURROUNDING GRADES. SHOULD ANY CONFLICTS AND/OR DISCREPANCIES ARISE BETWEEN THE GEOTECHNICAL REPORT, THE GRADING PLANS, THESE NOTES, AND ACTUAL CONDITIONS, THE CONTRACTOR SHALL IMMEDIATELY BRING SUCH ITEMS TO THE ATTENTION OF THE LANDSCAPE ARCHITECT AND OWNER.

LANDSCAPE REQUIREMENTS

CODE SECTION	CATEGORY	FORMULA	CALCULATION	REQUIRED	PROVIDED
13.06.070 (L)(2)	MIN. SITE LANDSCAPING STANDARDS	COMMERCIAL - MIN. 15%	TOTAL AREA 47,044 SF X 0.15	7,056 SF	11,761 SF
13.06.070 (L)(2)	MIN. SITE LANDSCAPING STANDARDS	LIVING MATERIALS - MIN. 75% OF LANDSCAPE AREA	LANDSCAPE AREA 11,761 SF X 0.75	8,820 SF	8,945 SF
13.06.070 (L)(5)	MIN. SITE LANDSCAPING STANDARDS	1 TREE / 1500 SF LANDSCAPE AREA	11,761 SF / 1500	8 TREES	8 TREES
13.06.070 (L)(5)	MIN. SITE LANDSCAPING STANDARDS	5 SHRUBS / 1500 SF LANDSCAPE AREA	(11,761 SF / 1500) X 5	40 SHRUBS	40 SHRUBS
13.06.070 (L)(5)(6)	MIN. SITE LANDSCAPING STANDARDS	MIN. 25% MAX. 50% EVERGREEN	8 TREES X 0.25	2 TREES	2 SPRUCE TREES
13.06.070 (M)	STREETSCAPE LANDSCAPING COTTONWOOD DRIVE	TREES NO GREATER THAN 40 FT APART	240 LF / 40	6 TREES	6 TREES *
13.06.070 (O)(5)	PARKING LOT PERIMETER	EAST - PARKING LOT BUFFER SCREEN	ADJACENT TO SIMILAR USE	8 FT	8 FT+ - 31 SHRUBS
13.06.070 (O)(5)	PARKING LOT PERIMETER	NORTH - PARKING LOT BUFFER SCREEN	ADJACENT TO SIMILAR USE	8 FT	8 FT+ - 53 SHRUBS & 21 GRASSES
13.06.070 (O)(5)	PARKING LOT PERIMETER	WEST - PARKING LOT BUFFER SCREEN	ADJACENT TO SIMILAR USE	8 FT	8 FT+ - 191 PERENNIALS
13.06.070 (O)(6)	PARKING LOT PERIMETER	SOUTH - PARKING LOT TO PARKING LOT BUFFER SCREEN	ADJACENT TO PARKING LOT	8 FT	8 FT - 20 SHRUBS & 36 GRASSES
13.06.070 (P)(2)	INTERNAL PARKING LOT LANDSCAPING	10% OF PARKING ALLOCATED TO LANDSCAPE ISLANDS	3,888 SF X 0.10	388 SF	600 SF
13.06.070 (P)(4)	INTERNAL PARKING LOT LANDSCAPING	1 TREE / 162 SF LANDSCAPE ISLAND	600 SF / 162	4 TREES	4 TREES
13.06.070 (P)(4)	INTERNAL PARKING LOT LANDSCAPING	5 SHRUBS / 162 SF LANDSCAPE ISLAND (1 SHRUB/ADJ. 15 SF)	(600 SF / 162) X 5	19 SHRUBS	19 SHRUBS

* UNABLE TO MEET SPACING REQUIREMENT DUE TO EXISTING EASEMENTS & UTILITIES

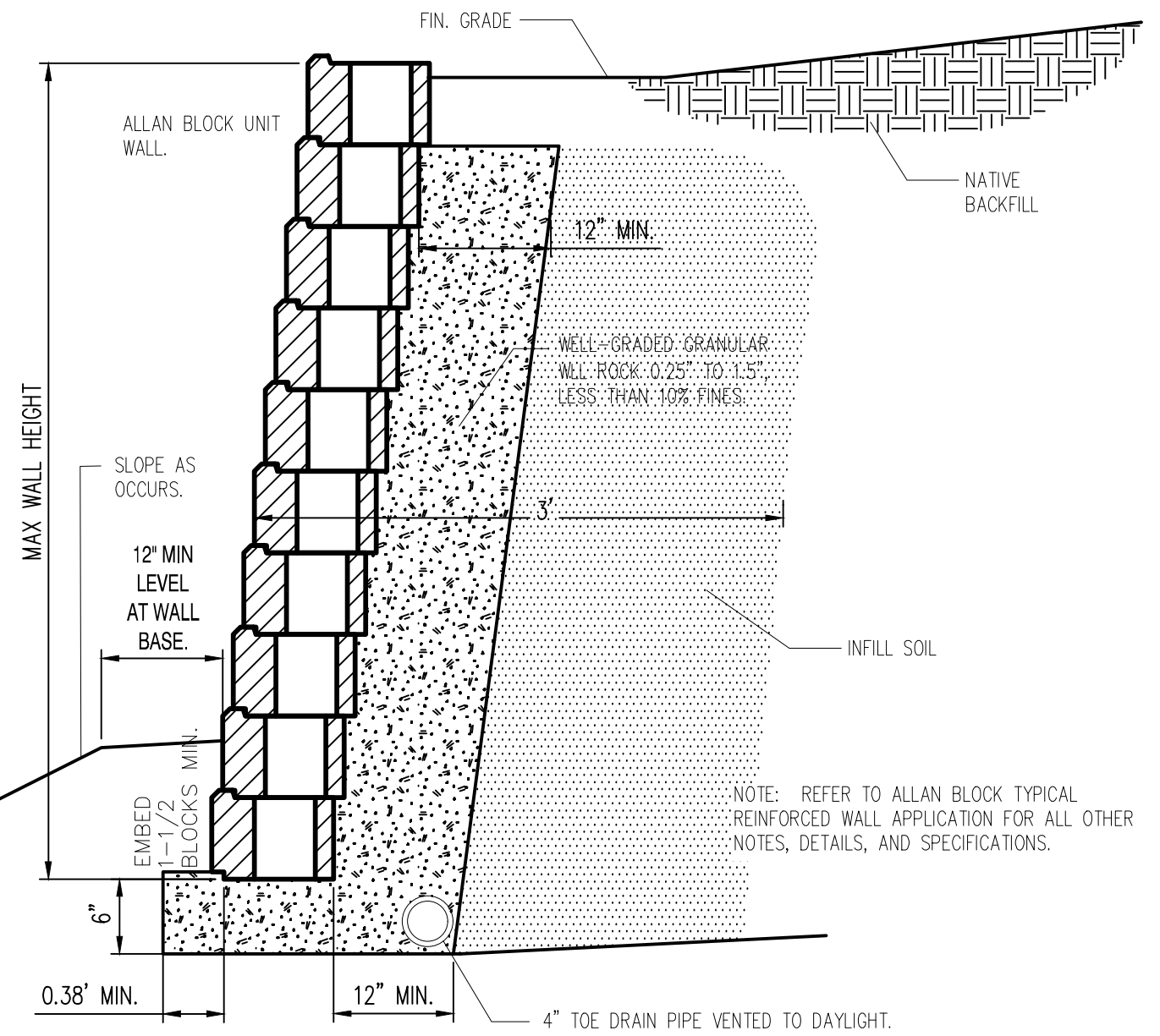

3 ALLEN BLOCK CHIMNEY WALL N.T.S.

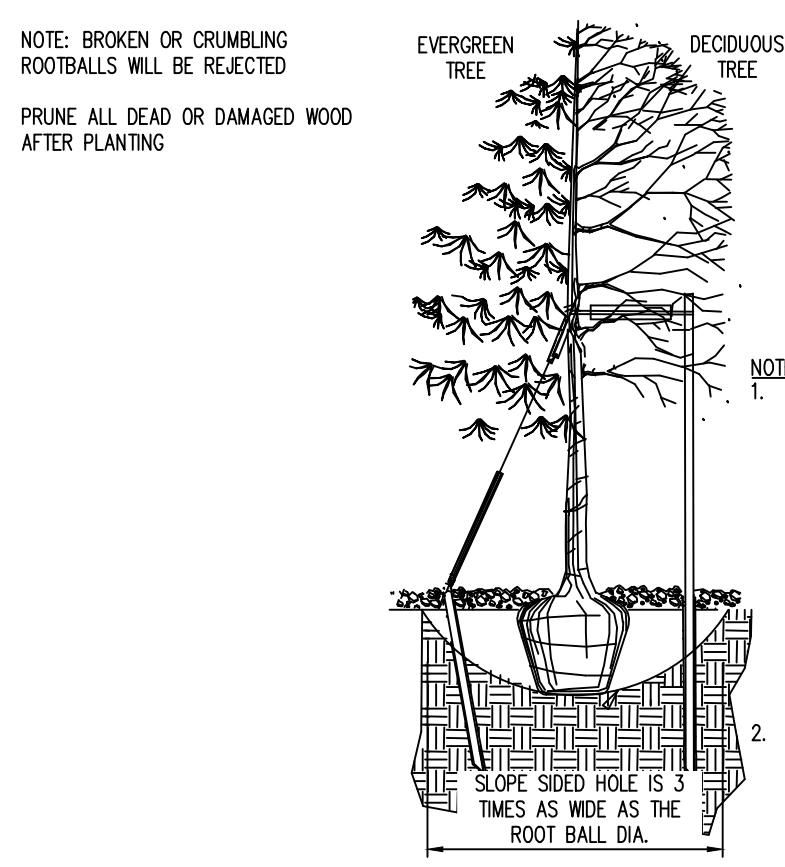

- NOTE: BROKEN OR CRUMBLING ROOTBALLS WILL BE REJECTED
PRUNE ALL DEAD OR DAMAGED WOOD AFTER PLANTING
- EVERGREEN TREE
DECIDUOUS TREE
- NOTES:
- EXCAVATE PLANTING HOLES WITH SLOPING SIDES. MAKE EXCAVATIONS AT LEAST THREE TIMES AS WIDE AS THE ROOT BALL DIAMETER AND NO DEEPER THAN THE DISTANCE FROM THE TOP MOST ROOTS IN THE ROOT BALL TO THE BOTTOM OF THE ROOT BALL TO ALLOW FOR SETTLING. DO NOT DISTURB SOIL AT BOTTOM OF PLANTING HOLES, BUT DO SCORE THE SIDES OF THE PLANTING HOLE. THE PLANTING AREA SHALL BE LOOSENEED AND AERATED AT LEAST THREE TIMES THE DIAMETER OF THE ROOT BALL. BACKFILL SHALL CONSIST OF EXISTING ON SITE TOPSOIL - NO AMENDMENTS SHALL BE USED UNLESS OTHERWISE SPECIFIED.
 - TREES SHALL BE PLANTED WITH THE ROOT COLLAR/FLARE VISIBLE ABOVE GRADE AND TWO OR MORE STRUCTURAL ROOTS LOCATED WITHIN THE TOP 1" TO 2" OF THE ROOT BALL/FINISHED GRADE MEASURED 3" TO 4" FROM TRUNK. THIS INCLUDES TREES THAT ARE SET ON SLOPES (SEE SLOPE PLANTING DETAIL). TREES THAT DO NOT HAVE A VISIBLE ROOT COLLAR SHALL BE REJECTED. DO NOT COVER THE ROOT BALL WITH SOIL.
 - WHEN ROOT BALL WILL REMAIN INTACT, CUT OFF BOTTOM 1/4 OF WIRE BASKET BEFORE PLACING TREE IN HOLE, CUT OFF REMAINDER OF BASKET AFTER TREE IS SET IN HOLE, REMOVE BASKET COMPLETELY. AT A MINIMUM, THE TOP 2/3 OF THE BURLAP AND BASKET SHALL BE REMOVED FROM THE ROOT BALL ON ALL TREES. REMOVE ALL NYLON TIES, TWINE, ROPE AND BURLAP. REMOVE UNNECESSARY PACKING MATERIAL.
4. FORM SOIL INTO A 3" TO 5" TALL WATERING RING (SAUCER) AROUND PLANTING AREA. THIS IS NOT NECESSARY IN IRRIGATED TURF AREAS. APPLY 2" TO 4" DEPTH OF SPECIFIED MULCH OVER PLANTING AREA AND INSIDE SAUCERS, AWAY FROM TRUNK.
5. STAKING AND GUYING OF TREES IS OPTIONAL IN MOST PLANTING SITUATIONS. IN AREAS OF EXTREME WINDS, OR ON STEEP SLOPES, STAKING MAY BE REQUIRED TO STABILIZE TREES. STAKING AND GUYING MUST BE REMOVED WITHIN 1 YEAR OF PLANTING DATE.
6. TREE WRAP IS NOT TO BE USED ON ANY NEW PLANTINGS, EXCEPT IN LATE FALL PLANTING SITUATIONS, AND ONLY THEN AFTER CONSULTATION WITH THE TOWN ARBORIST.
7. RESETTING OF IMPROPERLY PLANTED TREES WILL ONLY BE ALLOWED IF IT IS DETERMINED THAT DOING SO WILL IN NO WAY COMPROMISE THE ROOT BALL, AND SHALL ONLY BE DONE WITH APPROVAL OF THE TOWN ARBORIST.

1 TOWN OF PARKER TREE PLANTING N.T.S.

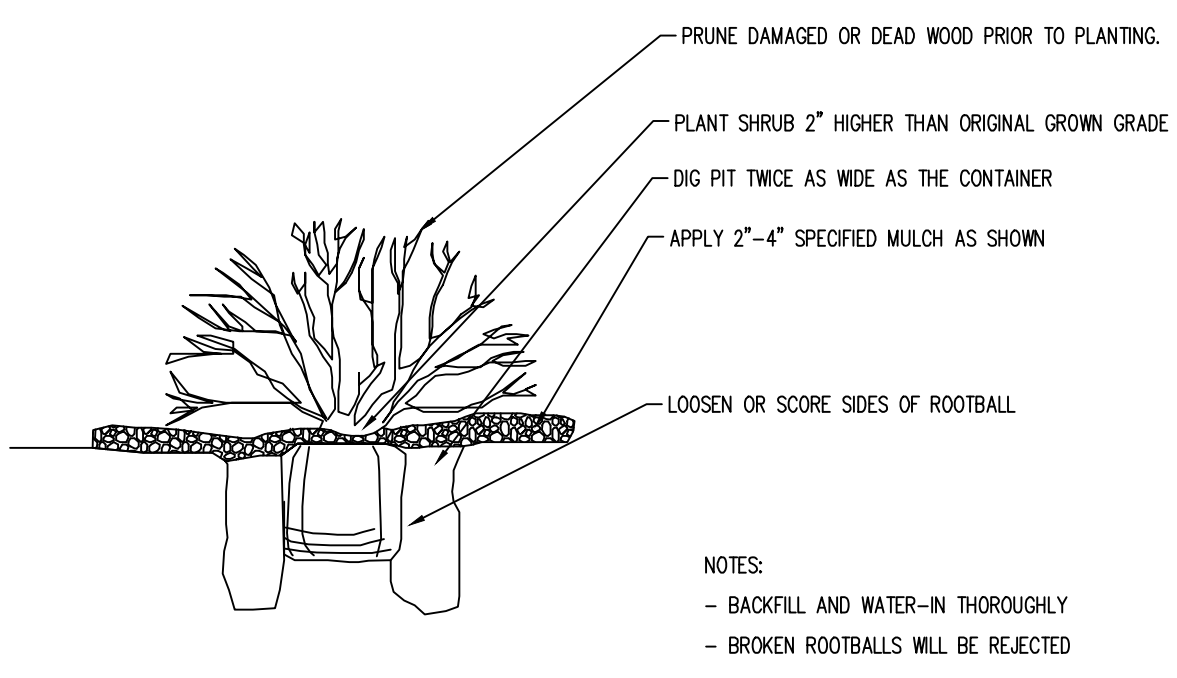

2 TOWN OF PARKER SHRUB PLANTING STANDARD N.T.S.



INSTALL PER MANUFACTURER'S SPECIFICATIONS
WAUSAU TILE MF2204 FLAT STEEL BENCH BLACK POWDER COAT OR APPROVED EQUAL FINISH MATERIALS/PRODUCT PER OWNER.

4 WAUSAU TILE STEEL BENCH OR APPROVED EQUAL N.T.S.

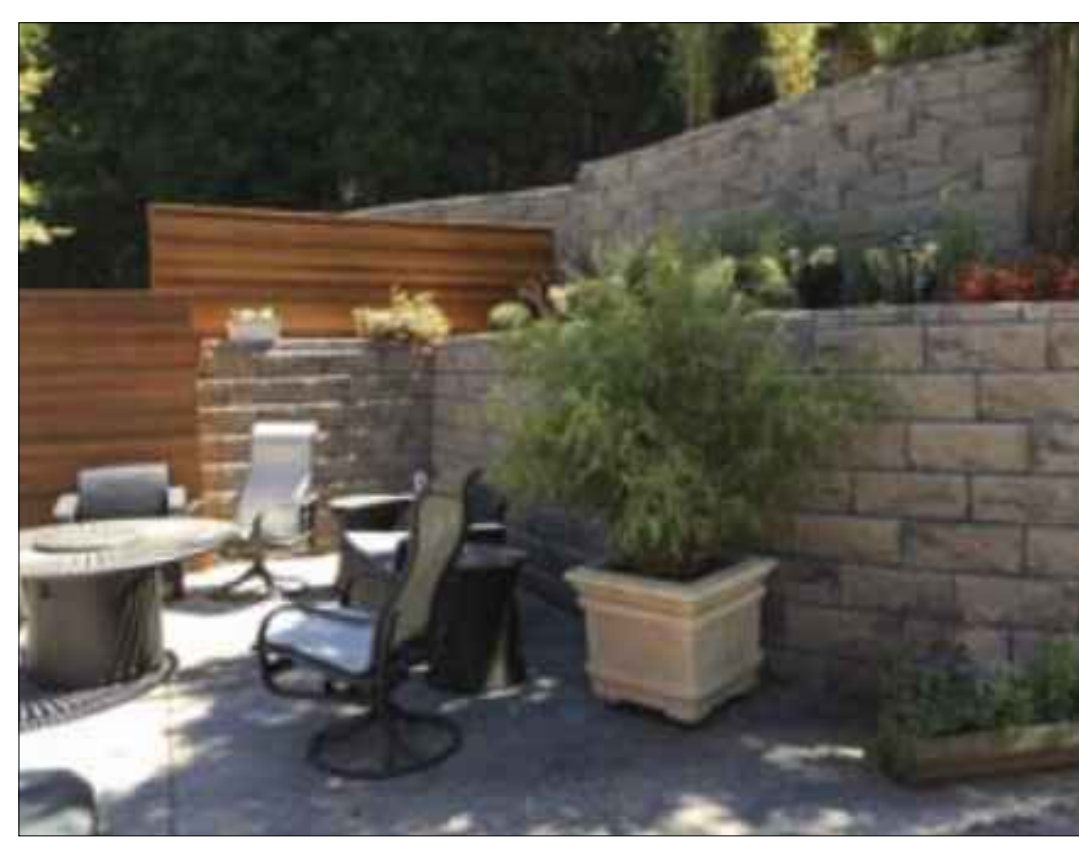

PRODUCT: THE AB ASHLAR COLLECTION
DESCRIPTION: THREE COARSE PATTERN
COLOR: TAN

5 ALLAN BLOCK AB ASHLAR COLLECTION N.T.S.

Galloway
5500 Greenwood Plaza Blvd., Suite 200
Greenwood Village, CO 80111
303.770.8884
GallowayUS.com

COPYRIGHT
THESE PLANS ARE AN INSTRUMENT OF SERVICE AND ARE THE PROPERTY OF GALLOWAY, AND MAY NOT BE DUPLICATED, DISCLOSED, OR REPRODUCED WITHOUT THE WRITTEN CONSENT OF GALLOWAY. COPYRIGHTS AND INFRINGEMENTS WILL BE ENFORCED AND PROSECUTED.



LAND OF SUSHI
CROWN POINT FILING NO. 1
AMD 20, LOT 4E
18704 COTTONWOOD DR.
PARKER, COLORADO 80138

#	Date	Issue / Description	Init.
1	8/30/24	4TH SUBMITTAL	EDN
2			
3			
4			
5			
6			
7			
8			
9			
10			
11			
12			
13			
14			
15			
16			
17			
18			
19			
20			
21			
22			
23			
24			
25			
26			
27			
28			
29			
30			
31			
32			
33			
34			
35			
36			
37			
38			
39			
40			
41			
42			
43			
44			
45			
46			
47			
48			
49			
50			

Project No: LOS000001
Drawn By: BH
Checked By: JR
Date: 11/27/2024

LANDSCAPE NOTES & DETAILS

L0.0

FILE:///C:/Users/landof/OneDrive/Desktop/Drawings/AllanBlock/00101_L0.0_Landscape Notes & Details.dwg - 2:00:10 PM - 2/21/2024

