

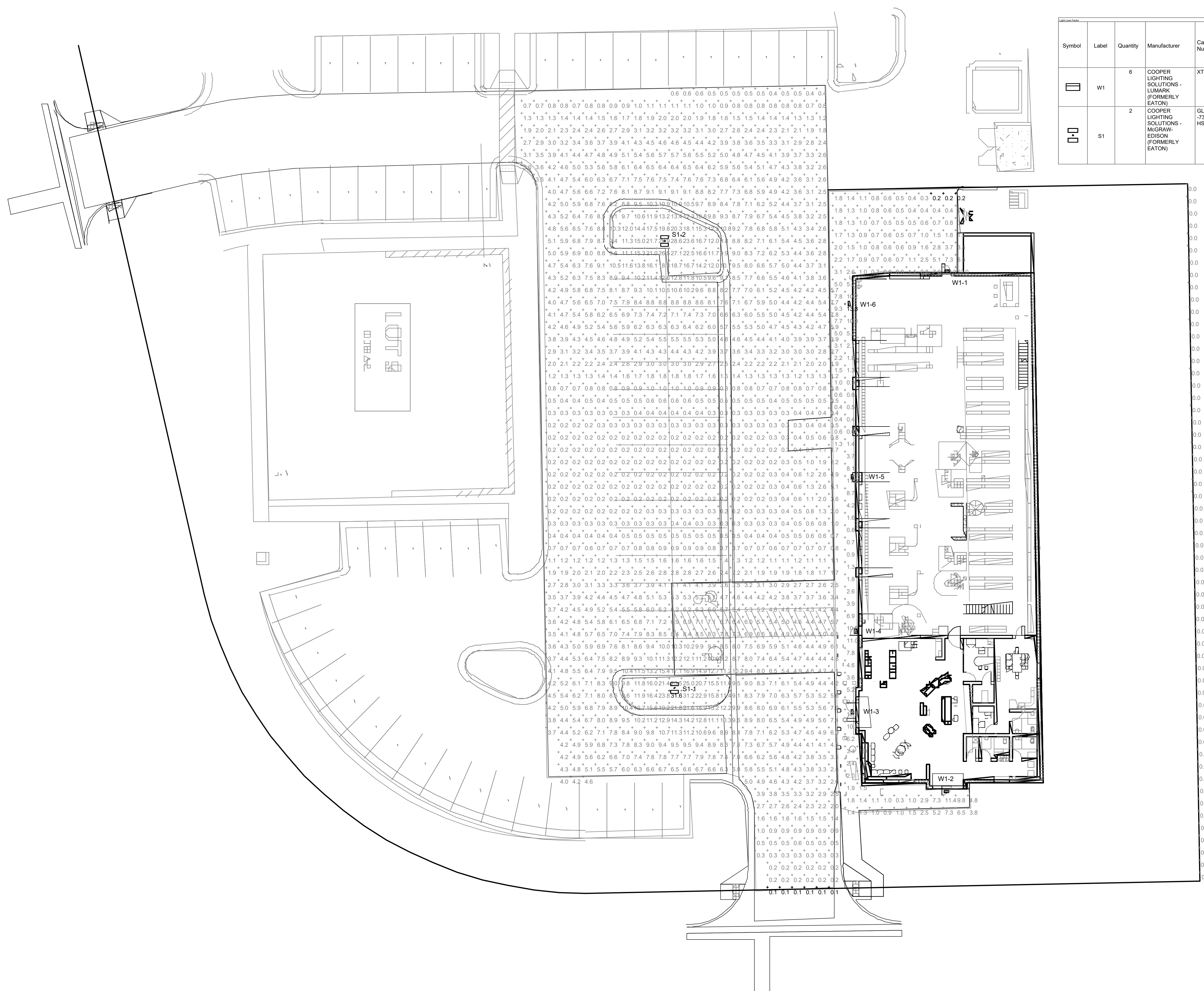

Symbol	Label	Quantity	Manufacturer	Catalog Number	Description	Lumens Per Lamp	Light Loss Factor	Wattage
	W1	6	COOPER LIGHTING SOLUTIONS - LUMARK (FORMERLY EATON)	XTOR3B	CROSSTOUR 26W WALL MOUNT LED	2750	0.85	25.5
	S1	2	COOPER LIGHTING SOLUTIONS - MCGRAW-EDISON (FORMERLY EATON)	GLEON-SA0A-730-U-SL3-HSS	GALLEON AREA AND ROADWAY LUMINAIRE (10) 70 CRI, 3000K, 615mA LIGHTS SQUARES WITH 16 LEDS EACH AND TYPE III SPILL LIGHT ELIMINATOR OPTICS WITH HOUSE SIDE SHIELD	224	0.85	646



1 SITE PHOTOMETRIC PLAN
E001

0 10 20 40
SCALE: 1" = 20'
NORTH

NOT FOR CONSTRUCTION - PRELIMINARY DESIGN

CHAMBERS & HESS RD., PARKER, CO
6-BAY LINEAR STORE

LES SCHWAB TIRE CENTER - PARKER, CO

© 2023 | ALL RIGHTS RESERVED
SITE PLAN
07.05.2023
DRAWN BY | FAULKNER
CHECKED BY | MORANVILLE
REVISIONS

SITE PHOTOMETRICS
E001



McGraw-Edison

GLEON Galleon

Area / Site Luminaire

Product Features



Product Certifications



Connected Systems

- WaveLinx
- Enlighted

Interactive Menu

- Ordering Information page 2
- Mounting Details page 3
- Optical Distributions page 4
- Product Specifications page 4
- Energy and Performance Data page 4
- Control Options page 9

Quick Facts

- Lumen packages range from 4,200 - 80,800 (34W - 640W)
- Efficacy up to 156 lumens per watt
- Options to meet Buy American and other domestic preference requirements

Dimensional Details

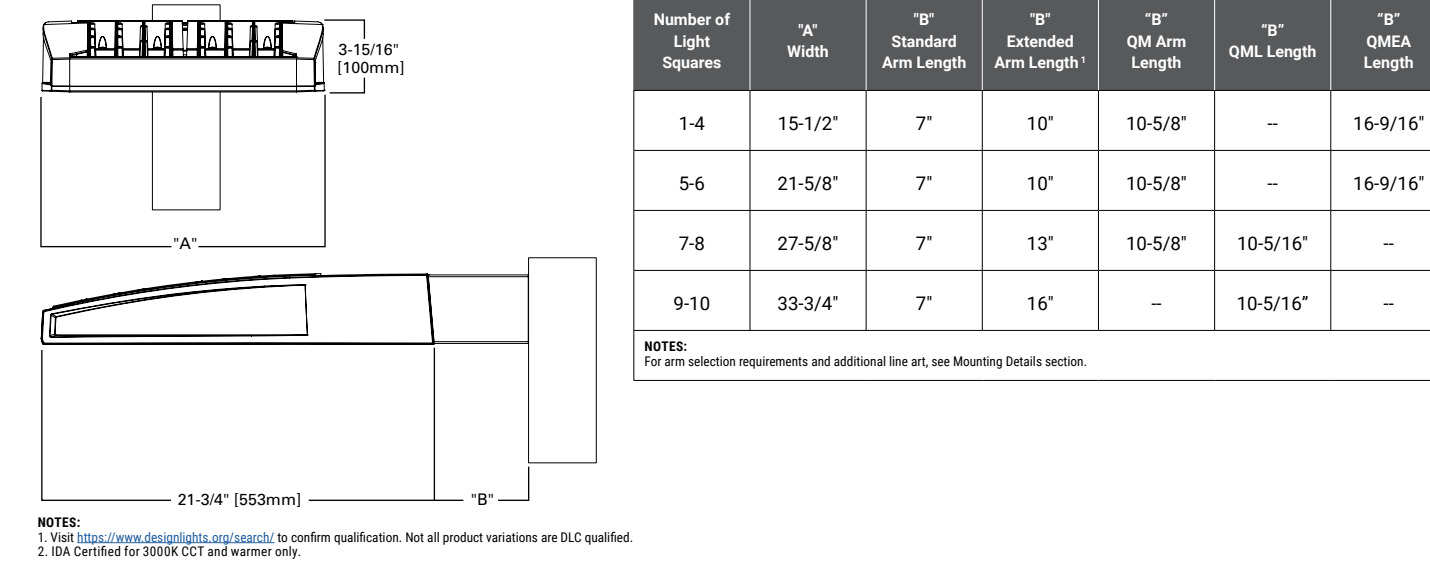

McGraw-Edison

GLEON Galleon

Ordering Information
SAMPLE NUMBER: GLEON-SA4C-740-U-T4FT-GM

Product Family ¹⁾	Light Engine Configuration	Drive Current	Color Temperature	Voltage	Distribution	Mounting	Finish
GLON-01000	SA4-1 Square	8.4000A	722-TICR, 2200K	0-120/277V	T2-Type II	Blank Arm for Round or Square Pole	AP-White
GLON-02000	SA4-GLEON-02000	8.4000A	722-TICR, 2200K	0-120/277V	T2-Type II	Blank Arm for Round or Square Pole	AP-White
GLON-03000	SA4-3 Squares	8.4000A	722-TICR, 2200K	0-120/277V	T2-Type II	Blank Arm for Round or Square Pole	AP-White
GLON-04000	SA4-4 Squares	8.4000A	722-TICR, 2200K	0-120/277V	T2-Type II	Blank Arm for Round or Square Pole	AP-White
GLON-05000	SA4-5 Squares	8.4000A	722-TICR, 2200K	0-120/277V	T2-Type II	Blank Arm for Round or Square Pole	AP-White
GLON-06000	SA4-6 Squares	8.4000A	722-TICR, 2200K	0-120/277V	T2-Type II	Blank Arm for Round or Square Pole	AP-White
GLON-07000	SA4-7 Squares	8.4000A	722-TICR, 2200K	0-120/277V	T2-Type II	Blank Arm for Round or Square Pole	AP-White
GLON-08000	SA4-8 Squares	8.4000A	722-TICR, 2200K	0-120/277V	T2-Type II	Blank Arm for Round or Square Pole	AP-White
GLON-09000	SA4-9 Squares	8.4000A	722-TICR, 2200K	0-120/277V	T2-Type II	Blank Arm for Round or Square Pole	AP-White
GLON-10000	SA4-10 Squares	8.4000A	722-TICR, 2200K	0-120/277V	T2-Type II	Blank Arm for Round or Square Pole	AP-White

NOTES:
1. Customer is responsible for engineering analysis to confirm pole and fixture compatibility for all applications. Refer to www.dsglights.com for additional product information.
2. Designlights Consortium[®] Qualified. Refer to www.designlights.org for details.
3. General information only. For more information, refer to the product literature.
4. Not available with this fixture.
5. Not available with this fixture.
6. Not available with this fixture.
7. Not available with this fixture.
8. Not available with this fixture.
9. Not available with this fixture.
10. Not available with this fixture.
11. Not available with this fixture.
12. Not available with this fixture.
13. Not available with this fixture.
14. Not available with this fixture.
15. Not available with this fixture.
16. Not available with this fixture.
17. Not available with this fixture.
18. Not available with this fixture.
19. Not available with this fixture.
20. Not available with this fixture.
21. Not available with this fixture.
22. Not available with this fixture.
23. Not available with this fixture.
24. Not available with this fixture.
25. Not available with this fixture.
26. Not available with this fixture.
27. Not available with this fixture.
28. Not available with this fixture.
29. Not available with this fixture.
30. Not available with this fixture.
31. Not available with this fixture.
32. Not available with this fixture.
33. Not available with this fixture.
34. Not available with this fixture.
35. Not available with this fixture.
36. Not available with this fixture.
37. Not available with this fixture.
38. Not available with this fixture.
39. Not available with this fixture.
40. Not available with this fixture.
41. Not available with this fixture.
42. Not available with this fixture.
43. Not available with this fixture.
44. Not available with this fixture.
45. Not available with this fixture.
46. Not available with this fixture.
47. Not available with this fixture.
48. Not available with this fixture.
49. Not available with this fixture.
50. Not available with this fixture.
51. Not available with this fixture.
52. Not available with this fixture.
53. Not available with this fixture.
54. Not available with this fixture.
55. Not available with this fixture.
56. Not available with this fixture.
57. Not available with this fixture.
58. Not available with this fixture.
59. Not available with this fixture.
60. Not available with this fixture.
61. Not available with this fixture.
62. Not available with this fixture.
63. Not available with this fixture.
64. Not available with this fixture.
65. Not available with this fixture.
66. Not available with this fixture.
67. Not available with this fixture.
68. Not available with this fixture.
69. Not available with this fixture.
70. Not available with this fixture.
71. Not available with this fixture.
72. Not available with this fixture.
73. Not available with this fixture.
74. Not available with this fixture.
75. Not available with this fixture.
76. Not available with this fixture.
77. Not available with this fixture.
78. Not available with this fixture.
79. Not available with this fixture.
80. Not available with this fixture.
81. Not available with this fixture.
82. Not available with this fixture.
83. Not available with this fixture.
84. Not available with this fixture.
85. Not available with this fixture.
86. Not available with this fixture.
87. Not available with this fixture.
88. Not available with this fixture.
89. Not available with this fixture.
90. Not available with this fixture.
91. Not available with this fixture.
92. Not available with this fixture.
93. Not available with this fixture.
94. Not available with this fixture.
95. Not available with this fixture.
96. Not available with this fixture.
97. Not available with this fixture.
98. Not available with this fixture.
99. Not available with this fixture.
100. Not available with this fixture.



DESCRIPTION

The patented Lumark Crosstour[®] LED Wall Pack Series of luminaires provides an architectural style with super bright, energy efficient LEDs. The low profile, rugged die-cast aluminum construction, universal back box, stainless steel hardware along with a sealed and gasketed optical compartment make the Crosstour impervious to contaminants. The Crosstour wall luminaire is ideal for wall/surface, inverted mount for fugacious illumination, post/bollard, site lighting, floodlight and low level pathway illumination including stairs. Typical applications include building entrances, multi-use facilities, apartment buildings, institutions, schools, stairways and loading docks test.

SPECIFICATION FEATURES

Construction
Slim, low-profile LED design with rugged one-piece, die-cast aluminum hinged removable door and back box. Matching housing styles incorporate both a small and medium design. The small housing is available in 12W, 18W and 26W. The medium housing is available in the 36W model. Patented secure lock hinge feature allows for safe and easy tool-less electrical connections with the supplied push-in connectors. Back box includes three half-inch, NPT threaded conduit entry points. The universal back box supports both the small and medium forms and mounts to standard 3/12" to 4" round and octagonal, 4" square, single gang and masonry junction boxes. Key hole gasket allows for adaptation to junction box or wall. External fin design extracts heat from the fixture surface. One-piece silicone gasket seals door and back box. Minimum 5" wide pole for site lighting application. Not recommended for car wash applications.

Optical
Silicone sealed optical LED chamber incorporates a custom engineered mirrored anodized reflector providing high-efficiency illumination. Optical assembly includes impact-resistant tempered glass and meets IESNA requirements for full cutoff compliance. Available in seven lumen packages; 5000K, 4000K and 3000K CCT.

Electrical
LED driver is mounted to the die-cast housing for optimal heat sinking. LED thermal management system incorporates both conduction and natural convection to transfer heat rapidly away from the LED source. 12W, 18W, 26W and 36W series operate in -40°C to 40°C [-40°F to 104°F]. High ambient 50°C models available. Crosstour luminaires maintain greater than 89% of initial light output after 72,000 hours of operation. Three half-inch NPT threaded conduit entry points allow for thru-branch wiring. Back box is an authorized applications.

Catalog #	Type
WTOR1B	Small Door, 12W
WTOR2B	Small Door, 18W
WTOR3B	Small Door, 26W
WTOR4B	Medium Door, 36W
WTOR5B	Medium Door, 36W
WTOR6B	Medium Door, 36W
WTOR7B	Medium Door, 36W
WTOR8B	Medium Door, 36W
WTOR9B	Medium Door, 36W
WTOR10B	Medium Door, 36W

Lumark



XTOR CROSSTOUR LED

APPLICATIONS:
WALL / BOLLARD
POST / BOLLARD
LOW LEVEL
FLOODLIGHT
INVERTED
SITE LIGHTING

DIMENSIONS

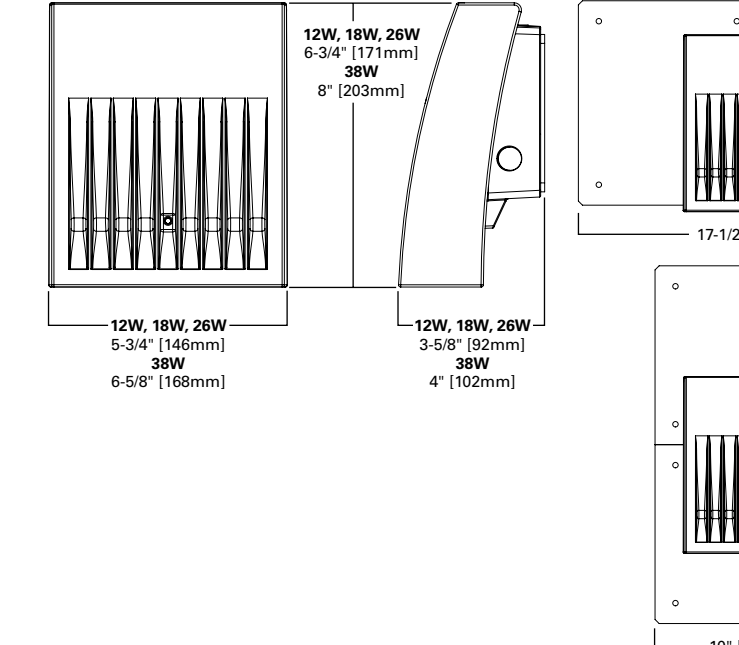

ESCUTCHEON PLATES

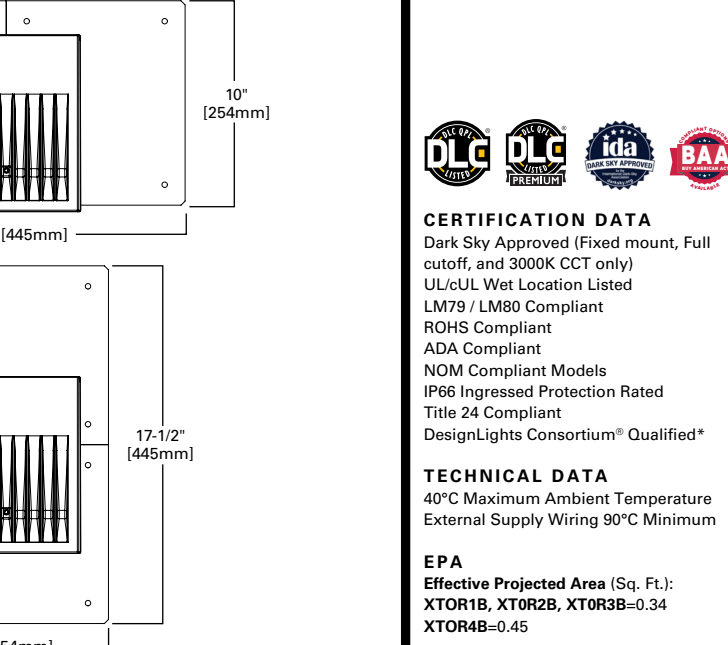

CERTIFICATION DATA
Dark Sky Approved (Fixed mount, Full cutoff, and 3000K CCT only)
UL-ULC Wet Location Listed
LM79 / LM80 Compliant
RHDS Compliant
ADA Compliant
NIM Compliant Models
IP66 Ingress Protection Rated
Title 24 Compliant
Designlights Consortium[®] Qualified²

TECHNICAL DATA
40°C Maximum Ambient Temperature
External Supply Wiring 30°C Minimum
EPA Effective Projected Area (Sq. Ft.):
XTOR1B, XTOR2B, XTOR3B=3.4
XTOR4B=0.45

SHIPPING DATA:
Approximate Net Weight:
3.7 - 5.25 lbs. (1.7 - 2.4 kg.)



POWER AND LUMENS BY FIXTURE MODEL

LED Information	XTOR1B	XTOR1B-W	XTOR1B-Y	XTOR2B	XTOR2B-W	XTOR2B-Y	XTOR3B	XTOR3B-W	XTOR3B-Y	XTOR4B	XTOR4B-W	XTOR4B-Y
Delivered Lumens (Wall Mount)	1,418	1,896	1,327	2,135	2,103	1,999	2,761	2,710	2,576	4,268	4,295	3,965
Delivered Lumens (W/O Flood Accessory Kit ¹)	1,005	950	940	1,495	1,472	1,399	2,099	2,068	1,965	3,121	3,121	2,895
B.U.G. Rating ²	B1-U0-G0	B1-U0-G0	B1-U0-G0	B1-U0-G0	B1-U0-G0	B1-U0-G0	B1-U0-G0	B1-U0-G0	B1-U0-G0	B2-U0-G0	B2-U0-G0	B2-U0-G0
CRI (Kelvin)	5,000	4,000	3,000	5,000	4,000	3,000	5,000	4,000	3,000	5,000	4,000	3,000
Color Rendering Index	70	70	70	70	70	70	70	70	70	70	70	70
Power Consumption (Watts)	12W	12W	12W	18W	18W	18W	26W	26W	26W	36W	36W	36W

NOTES: 1. Includes shield and venter. 2. B.U.G. Rating does not apply to floodlighting.

LUMEN MAINTENANCE

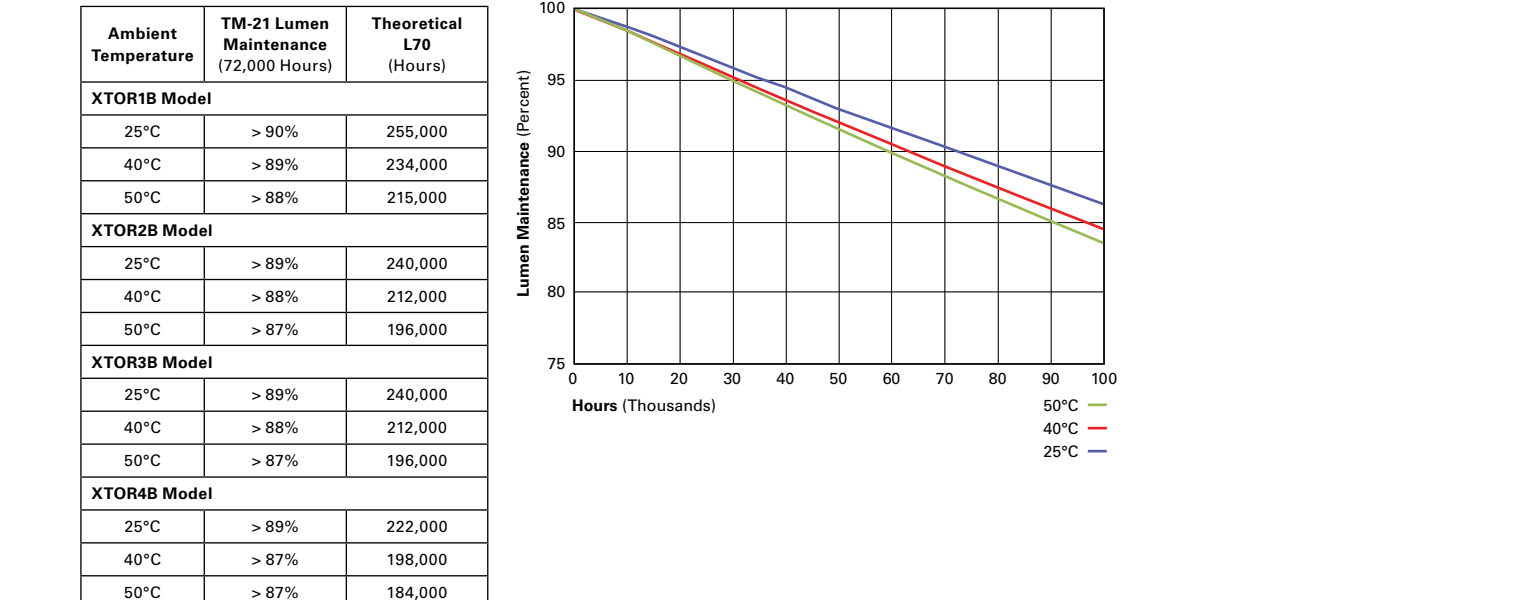

CURRENT DRAW

Voltage	Model Series		
	XTOR1B	XTOR2B	XTOR4B
120V	0.163A	0.15A	0.22A
208V	0.060A	0.08A	0.13A
240V	0.053A	0.08A	0.11A
277V	0.048A	0.07A	0.10A
347V	0.039A	0.06A	0.092A



ORDERING INFORMATION

Sample Number: XTOR2B-W-T4FT-PC1	LED Kelvin Color	Housing Color	Options (Add as Suffix)	Accessories (Order Separately) ³⁾
WTOR1B=Small Door, 12W	12W-Neutral White	Black	PC1=Photocell 120V ¹⁾	WGXTOR=Wire Guard ¹⁾
XTOR2B=Small Door, 18W	18W-Neutral White	Black	PC2=Photocell 208-277V ¹⁾	XTORFLD-KNC=Knuckle Floodlight Kit ⁴⁾
XTOR3B=Small Door, 26W	26W-Neutral White	Black	HA=347V ¹⁾	XTORFLD-TRE=Trunnion Floodlight Kit ⁴⁾
XTOR4B=Medium Door, 36W	36W-Neutral White	Black	HA=347V High Ambient ¹⁾	XTORFLD-KNC-WT=Knuckle Floodlight Kit, Summit White ⁴⁾
XTOR5B=Medium Door, 36W	36W-Neutral White	Black		XTORFLD-TRE-WT=Trunnion Floodlight Kit, Summit White ⁴⁾
XTOR6B=Medium Door, 36W	36W-Neutral White	Black		EWXTOR=Escutcheon Wall Plate, Carbon Bronze
XTOR7B=Medium Door, 36W	36W-Neutral White	Black		FWXTOR=Escutcheon Wall Plate, Summit White

NOTES:
1. Designlights Consortium[®] Qualified and classified for both DLC Standard and DLC Premium, refer to www.designlights.org for details.
2. Photocell as factory installed.
3. Only PC2 for 347V models.
4. This branch wiring not available with HA option or with 347V. XTOR2B not available with HA and 347V / 100V combination.
5. Wire guard for wall/surface mount. Not for use with floodlight kit accessory.
6. Floodlight kit accessory supplied with knuckle (KNC) or trunnion (TRE) base, small and large tripod visors and small and large impact shields.
7. Only product configurations with these designated prefixes are built to be compliant with the Buy American Act of 1933 (BAA) or Trade Agreements Act of 1979 (TAA), respectively. Please refer to DOMESTIC PREFERENCES website for more information. Components shipped separately may be separately analyzed under domestic preference requirements.
8. Accessories sold separately will be separately analyzed under domestic preference requirements. Consult factory for further information.

STOCK ORDERING INFORMATION

Domestic Preferences	12W Series	18W Series	26W Series	36W Series
[Blank]=Standard	XTOR1B=12W, 5000K, Carbon Bronze	XTOR2B=18W, 5000K, Carbon Bronze	XTOR3B=26W, 5000K, Carbon Bronze	XTOR4B=36W, 5000K, Carbon Bronze
BAA=Buy American Act Compliant	XTOR1B-WT=12W, 5000K, Summit White	XTOR2B-W=18W, 5000K, Carbon Bronze	XTOR3B-W=26W, 5000K, Carbon Bronze	XTOR4B-W=36W, 5000K, Carbon Bronze
TAA=Trade Agreements Act Compliant	XTOR1B-PC1=12W, 5000K, 120V FC, Carbon Bronze	XTOR2B-WT=18W, 5000K, Summit White	XTOR3B-WT=26W, 5000K, Summit White	XTOR4B-WT=36W, 5000K, Summit White
	XTOR1B-W=12W, 4000K, Carbon Bronze	XTOR2B-PC1=18W, 5000K, 120V FC, Carbon Bronze	XTOR3B-PC1=26W, 5000K, 120V FC, Carbon Bronze	XTOR4B-PC1=36W, 5000K, 120V FC, Carbon Bronze
		XTOR2B-W-PC1=18W, 4000K, 120V FC, Carbon Bronze	XTOR3B-W-PC1=26W, 4000K, 120V FC, Carbon Bronze	XTOR4B-W-PC1=36W, 4000K, 120V FC, Carbon Bronze
		XTOR2B-347V=18W, 5000K, Carbon Bronze, 347V	XTOR3B-347V=26W, 5000K, Carbon Bronze, 347V	XTOR4B-347V=36W, 5000K, Carbon Bronze, 347V
		XTOR2B-WT-PC1=18W, 5000K, 120V FC, Summit White	XTOR3B-PC2=26W, 5000K, 120V FC, Summit White	

NOTES:
1. Only product configurations with these designated prefixes are built to be compliant with the Buy American Act of 1933 (BAA) or Trade Agreements Act of 1979 (TAA), respectively. Please refer to DOMESTIC PREFERENCES website for more information. Components shipped separately may be separately analyzed under domestic preference requirements.

