

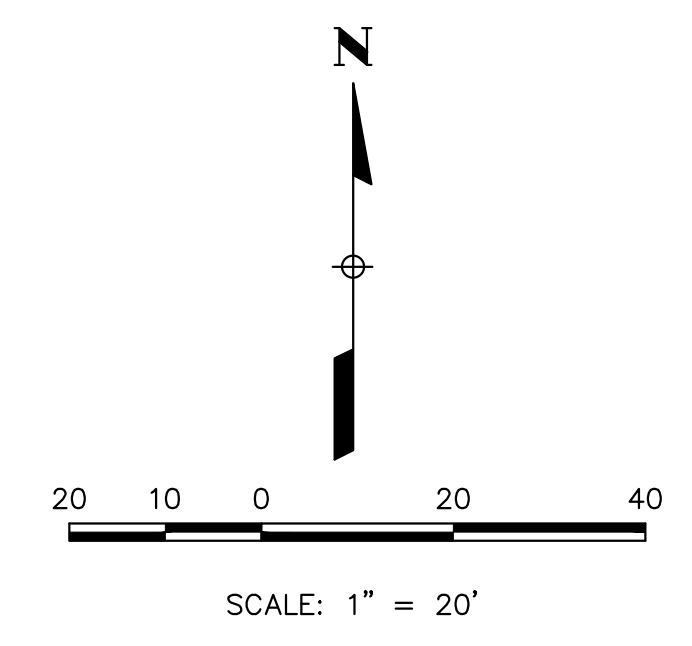

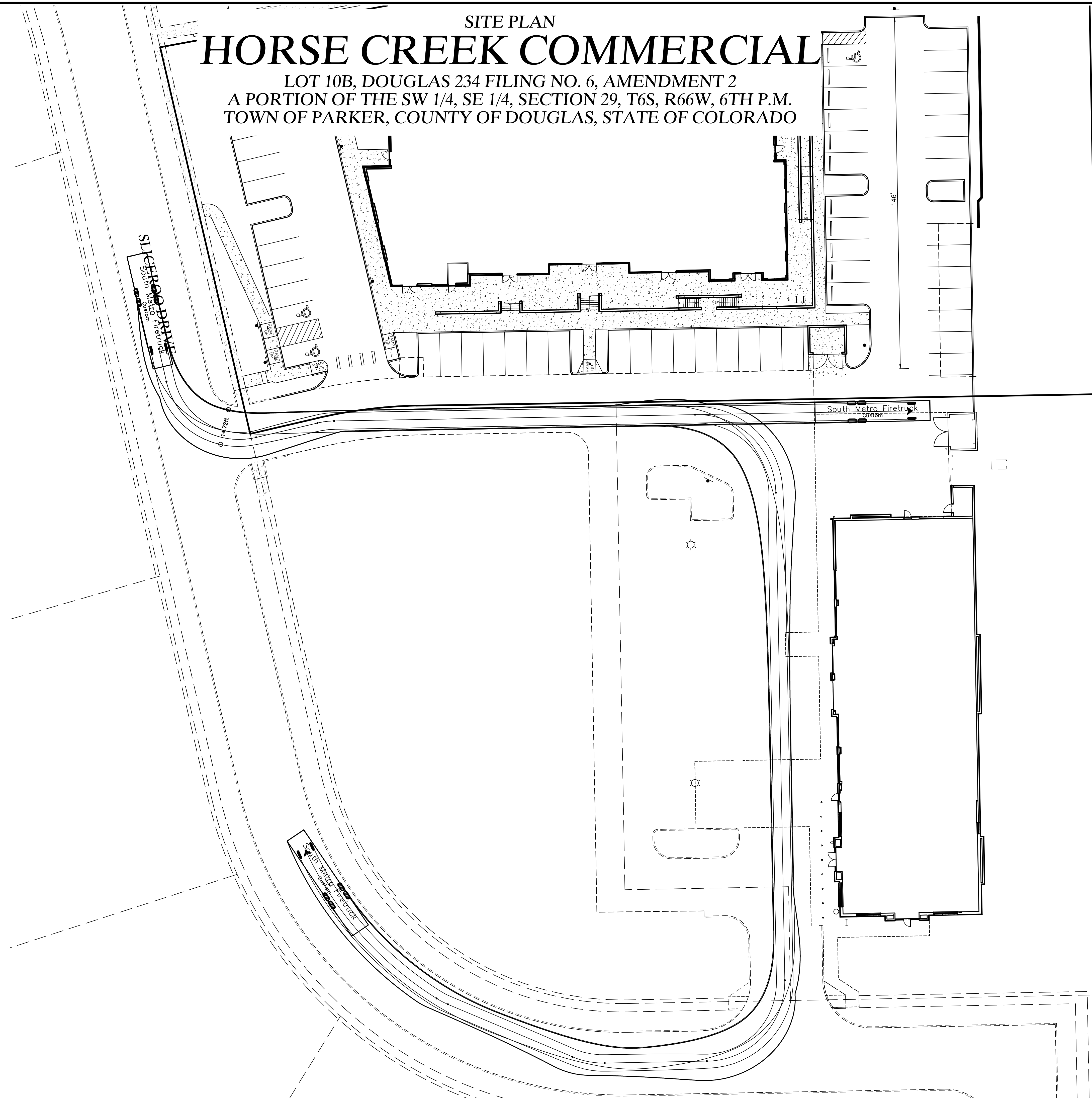

SITE PLAN
HORSE CREEK COMMERCIAL

LOT 10B, DOUGLAS 234 FILING NO. 6, AMENDMENT 2
 A PORTION OF THE SW 1/4, SE 1/4, SECTION 29, T6S, R66W, 6TH P.M.
 TOWN OF PARKER, COUNTY OF DOUGLAS, STATE OF COLORADO

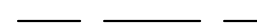
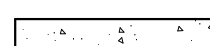

LEGEND

	PROPERTY LINE
	EXISTING CURB & GUTTER
	PROPOSED CURB & GUTTER
	EXISTING RIGHT-OF-WAY
	CONCRETE PAVEMENT

FIRETRUCK ACCESS PLAN
 DOUGAS 234 FILING NO. 6, AMD. 2
 JOB NO. 24020
 DATE: OCTOBER 3, 2025
 SHEET C6



**Vermilion
Peak
Engineering**
 Civil Engineering & Land Surveying
 1745 Shea Center Drive, 4th Floor
 Highlands Ranch, CO 80129
 720-402-6070 / vermillionpeak.com