

ZONING CODE

| | |
|-----------------------------|------------------------------|
| ZONING CLASSIFICATION: | MIXED-USE COMMUNITY |
| PROPERTY AREA: | 43,516 SF (0.999 AC) |
| PROPOSED BUILDING AREA: | 8,000 SF |
| PROPOSED PARKING PAVEMENT: | 12,900 SF |
| PROPOSED SIDEWALK PAVEMENT: | 2,250 SF |
| SPACES REQUIRED: | 1 SP. PER 300 SF GFA |
| SPACES PROVIDED: | 9' x 20' AT BUILDING |
| H.C. SPACES PROVIDED: | 9' x 18' ALL OTHER LOCATIONS |
| | 27 |
| | 2 |

KEY NOTES

- PROTECT EXISTING IMPROVEMENTS IN PLACE.
- CONCRETE PAVING (STANDARD DUTY) AT PARKING AREAS. REFER TO DETAIL 2/C2.2
- CONCRETE PAVING (HEAVY DUTY) AT DRIVE AREAS, DRIVE APRONS, FIRE LANES, AND REFUSE AREA. REFER TO DETAIL 1/C2.2
- INSTALL CONCRETE SIDEWALK OR DOOR LANDING PER DETAIL 5/C2.2. REFER TO STRUCTURAL DRAWINGS FOR LAYOUT ADJACENT TO BUILDING PERIMETER.
- INSTALL ACCESSIBLE PARKING SYMBOL PAVEMENT STRIPING PER DETAIL 6/C2.2.
- INSTALL STEEL BOLLARD PER DETAIL 7/C2.2. PROVIDE (2) AT REFUSE CONTAINER AREA, (2) AT SECTIONAL OVERHEAD FREIGHT DOOR AND PROVIDE (9) AT FRONT ENTRY. REFER TO STRUCTURAL DRAWINGS FOR BOLLARDS ADJACENT TO BUILDING PERIMETER.
- INSTALL ACCESSIBLE PARKING SIGN PER DETAIL 8/C2.2.
- ACCESSIBLE PARKING SPACE WITH ACCESS AISLE (ADA COMPLIANT) TO SLOPE 2% MAXIMUM IN ALL DIRECTIONS. PROVIDE PAVEMENT MARKINGS TO MATCH STRIPING COLOR UNLESS OTHERWISE REQUIRED TO COMPLY WITH GOVERNING ACCESSIBILITY REGULATIONS.
- INSTALL CONCRETE BUMPER BLOCK (8" W X 5" H X 6'-0" L) ANCHORED TO PAVING WITH (2) 1"-6" LONG #4 REBAR.
- REFUSE ENCLOSURE. REFER TO 1/C2.3.
- PARKING LOT LIGHTING SHOWN FOR REFERENCE ONLY. REFER TO SHEET US1 FOR MORE DETAIL.
- INSTALL 4" WIDE PAVEMENT STRIPING AS SHOWN USING HIGHWAY MARKING PAINT - YELLOW (2 COATS).
- SITE SIGN SHOWN FOR REFERENCE ONLY. REFER TO SHEET SG1.1 FOR CONSTRUCTION TYPE AND LOCATION. SIGN IS OWNER FURNISHED AND INSTALLED (REFER TO SCOPE OF WORK SCHEDULE). REFER TO SHEET US1 FOR ADDITIONAL REQUIREMENTS.
- LIMITS OF NEW PAVING. MATCH EXISTING PAVEMENT TRANSITION ELEVATIONS. AT TRANSITIONS OF NEW CONCRETE TO EXISTING CONCRETE PAVEMENT, EPOXY DOWEL 6" MINIMUM INTO EXISTING WITH #4 X 1'-6" SMOOTH DOWELS MATCHING NEW PAVEMENT REINFORCEMENT SPACING. PROVIDE SEALANT AT JOINTS.
- 1.5" WIDE, 2" DEEP GRADE SX ASPHALT MILL & OVERLAY PER GEOTECHNICAL RECOMMENDATIONS.
- TRANSITION TO 0" CURB OVER DISTANCE AS SHOWN.
- 5' TRANSITION FROM 6" WIDE CURB TO 1' WIDE CURB.
- 2' CURB CUT PER DETAIL 9/C2.2.
- TRANSITION TO EXISTING 6" CURB AND GUTTER.
- REFER TO SHEET C3.1 FOR STORM AND UTILITY IMPROVEMENT DETAILS.
- INSTALL 5' X 2' CONCRETE SPLASH PAD RECESSED 2" MIN. FROM PARKING ACCESS AISLE PAVEMENT. REFER TO GRADING PLAN FOR ELEVATIONS.
- INSTALL SIDEWALK RAMP RAILING PER DETAIL 14/C2.2.
- 5' X 5' CLEAR SPACE AT RAMP CHANGE IN DIRECTION.
- INSTALL 1.5" WIDE, 4" THICK CONCRETE STRIP ATTACHED TO PARKING STALL BACK OF CURB.
- INSTALL INVERTED U BIKE RACK. SEE DETAIL 11/C2.2.
- INSTALL TRANSFORMER PAD PER CORE ELECTRIC STANDARDS.
- INSTALL PARKING LOT SCREENING WALL. REFER TO STRUCTURAL FOR MORE DETAIL.

GENERAL NOTES

- REFER TO PROJECT MANUAL FOR ADDITIONAL REQUIREMENTS. ALL ON SITE CONCRETE TO BE 4,500 PSI.
- SITE DIMENSIONS TO FACE OF CONCRETE FOUNDATION, SIDEWALK, CURB GUTTER LINE, PROPERTY LINE, OR CENTER LINE OF STRIPING UNLESS OTHERWISE NOTED.
- COORDINATE WORK WITH OTHER SITE RELATED DEVELOPMENT DRAWINGS.
- REFER TO STRUCTURAL DRAWINGS FOR BUILDING DIMENSIONS AND LAYOUT OF SIDEWALKS ADJACENT TO BUILDING PERIMETER.
- PRIOR TO INSTALLATION, CONTRACTOR TO VERIFY LOCATIONS OF LIGHT POLES, LANDSCAPING, AND UTILITIES DO NOT CONFLICT WITH SITE SIGN LOCATION SHOWN. IF CONFLICT IS DISCOVERED, CONTRACTOR TO NOTIFY OWNERS REPRESENTATIVE PRIOR TO PROCEEDING WITH THE WORK.

SYMBOLS LEGEND

NOTE: REFER TO SURVEY FOR EXISTING CONDITIONS SYMBOLS LEGEND.

| | |
|--|------------------------------|
| | RIGHT-OF-WAY |
| | O'REILLY PROPERTY LINE |
| | ADJACENT PROPERTY LINE |
| | EXISTING EASEMENT |
| | PROPOSED EASEMENT |
| | BUILDING SETBACK LINE |
| | ROAD CENTERLINE |
| | LIMIT OF DISTURBANCE |
| | PROPOSED SAWCUT |
| | PROPOSED FLOWLINE |
| | PROPOSED SIGN |
| | PROPOSED WHEEL STOP |
| | PROPOSED BOLLARD |
| | PROPOSED FDC |
| | PROPOSED FIRE HYDRANT |
| | PROPOSED GATE VALVE |
| | PROPOSED CLEANOUT |
| | PROPOSED LIGHT POLE |
| | PROPOSED BUILDING FOOTPRINT |
| | PROPOSED LIGHT DUTY CONCRETE |
| | PROPOSED HEAVY DUTY CONCRETE |
| | PROPOSED MILL & OVERLAY |
| | PROPOSED RIPRAP |

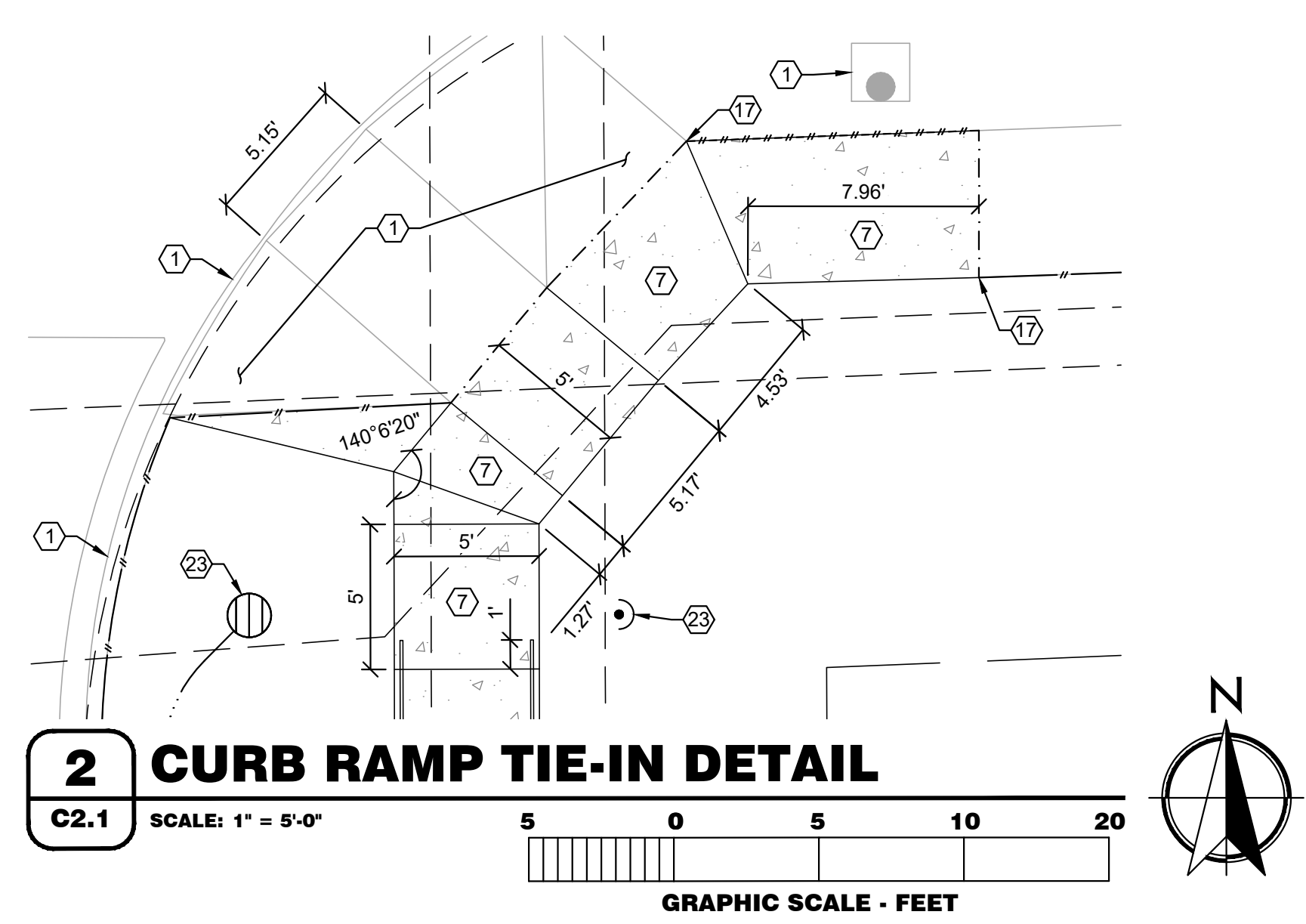

1 SITE DEVELOPMENT PLAN

C2.1 SCALE: 1" = 20'-0"

CAUTION: INFORMATION ON THIS DRAWING CONCERNING TYPE AND LOCATION OF UNDERGROUND AND OTHER UTILITIES IS NOT GUARANTEED TO BE ACCURATE OR ALL INCLUSIVE. THE CONTRACTOR IS RESPONSIBLE FOR MAKING HIS OWN DETERMINATION AS TO THE TYPE AND LOCATION OF UNDERGROUND AND OTHER UTILITIES AS MAY BE NECESSARY TO AVOID DAMAGE THERETO.



BENCHMARK

DOUGLAS COUNTY BENCHMARK 1.060032, EL.=5,903.17 FEET (NAVD88) - 3 1/4" INCH ALUMINUM CAP (DOUGLAS COUNTY GIS SECONDARY CONTROL MONUMENT 1.060032) AT THE SOUTHEAST CORNER OF THE PARKING LOT OF STROH RANCH SOCCER FIELDS, ON THE NORTH SIDE OF STROH RD, EAST OF THE INTERSECTION OF STROH ROAD AND N. MOTSENBOCKER ROAD, CITY OF PARKER, COLORADO.

BASIS OF BEARING

BEARINGS SHOWN HEREON ARE BASED ON THE NORTHERLY LINE OF THE NORTHEAST QUARTER OF SECTION 3, TOWNSHIP 7 SOUTH, RANGE 66 WEST OF THE 6TH P.M., MONUMENTED AS SHOWN ON THIS SURVEY PLAT AS BEARING NORTH 89°33'14" EAST, WITH ALL BEARINGS CONTAINED HEREIN RELATIVE THERETO.

UNAUTHORIZED CHANGES & USES

THE ENGINEER PREPARING THESE PLANS WILL NOT BE RESPONSIBLE FOR, OR LIABLE FOR, UNAUTHORIZED CHANGES TO OR USES OF THESE PLANS. ALL CHANGES OF THESE PLANS MUST BE IN WRITING AND MUST BE APPROVED BY THE PREPARER OF THESE PLANS PRIOR TO CONSTRUCTION. CONSTRUCTION CONTRACTOR AGREES THAT IN ACCORDANCE WITH GENERALLY ACCEPTED CONSTRUCTION PRACTICES, CONSTRUCTION CONTRACTOR WILL BE REQUIRED TO ASSUME SOLE AND COMPLETE RESPONSIBILITY FOR JOB SITE CONDITIONS DURING THE COURSE OF CONSTRUCTION OF THE PROJECT, INCLUDING SAFETY OF ALL PERSONS AND PROPERTY, THAT THIS REQUIREMENT SHALL BE MADE TO APPLY CONTINUOUSLY AND NOT BE LIMITED TO NORMAL WORKING HOURS, AND CONSTRUCTION CONTRACTOR FURTHER AGREES TO DEFEND, INDEMNIFY AND HOLD DESIGN PROFESSIONAL HARMLESS FROM ANY AND ALL LIABILITY, REAL OR ALLEGED, IN CONNECTION WITH THE PERFORMANCE OF WORK ON THIS PROJECT, EXCEPTING LIABILITY ARISING FROM THE SOLE NEGLIGENCE OF DESIGN PROFESSIONAL.

NOTE TO CONTRACTOR

THE EXISTENCE AND LOCATION OF ANY UNDERGROUND UTILITIES, PIPES, AND/OR STRUCTURES SHOWN ON THESE PLANS WERE OBTAINED BY A SEARCH OF AVAILABLE RECORDS. THERE MAY BE EXISTING UTILITIES NOT SHOWN ON THESE PLANS. THE CONTRACTOR SHALL ASCERTAIN THE TRUE VERTICAL AND HORIZONTAL LOCATION OF THOSE UNDERGROUND UTILITIES TO BE USED PRIOR TO CONSTRUCTION AND SHALL BE RESPONSIBLE FOR ANY DAMAGE TO ANY PUBLIC OR PRIVATE UTILITIES, SHOWN OR NOT SHOWN HEREON.

THE TOWN OF PARKER REVIEW CONSTITUTES GENERAL COMPLIANCE WITH THE TOWN'S STANDARDS AND APPROVED VARIANCES. SUBJECT TO THESE PLANS BEING STAMPED, SIGNED AND DATED BY THE PROFESSIONAL ENGINEER OF RECORD, REVIEW BY THE TOWN DOES NOT CONSTITUTE APPROVAL OF THE PLAN DESIGN OR ACCURACY OR CORRECTNESS OF ENGINEERING CALCULATIONS. ERRORS IN THE DESIGN OR CALCULATIONS REMAIN THE RESPONSIBILITY OF THE REGISTERED PROFESSIONAL ENGINEER WHOSE STAMP AND SIGNATURE ARE AFFIXED TO THIS DOCUMENT.

THIS REVIEW DOES NOT CONSTITUTE APPROVAL OF ANY PRIVATE ON-SITE IMPROVEMENTS WHICH MAY BE SHOWN. CONSTRUCTION CANNOT COMMENCE UNTIL ALL REQUIRED DRAINAGE/TRAFFIC REPORT(S), FINAL DEVELOPMENT PLAN(S), SPECIAL REVIEW(S), GRADING PERMIT, AND/OR OTHER PERMITS ARE COMPLETE, APPROVED AND ON FILE WITH THE TOWN OF PARKER.

PREPARED UNDER THE SUPERVISION OF TAIT & ASSOCIATES, INC.

320 North Lincoln Avenue
Loveland, CO 80537
p: 970.613.1447
www.tait.com
ENGINEERING ENVIRONMENTAL BUILDING LAND
CONSTRUCTION SURVEYING LAND
Santa Ana Sacramento Denver
San Luis Obispo Riverside Boise
Dallas
Since 1914

LOT 1 PARKER POINTE SUBDIVISION FILING 1

PROJECT:
NEW O'REILLY AUTO PARTS STORE
STROH RD
PARKER, CO #2
SITE DEVELOPMENT PLAN

TIMOTHY M. GUILLOT
ARCHITECT

1736 East Sunshine, Suite 417
Springfield, Missouri 65804
417.862.0558
Fax: 417.862.3265
e-mail: architect@esterlyschneider.com

CORPORATE OFFICES
233 SOUTH PATTERSON
SPRINGFIELD, MISSOURI 65802
(417) 862-2674 TELEPHONE

| | |
|----------|------------|
| COMM # | 4884 |
| DATE: | 02/14/2025 |
| REVISION | |
| DATE: | |