

N:\PROJECTS\BIRCHWOODS\ENGINEERING\DRAINAGE\STUDIES\DRAINAGE MAPS\OVERALL DRAINAGE MAP.DWG, ASPUNOK, 11/20/16 2:38 PM



DESIGN POINT SUMMARY		
Design Point ID	Q2 (CFS)	Q100 (CFS)
1A	6.07	23.37
1K	12.80	49.37
1B	17.67	65.86
1C	21.14	79.26
1M	8.00	32.24
1G	8.85	60.30
1E	19.87	74.38
1D	22.89	88.93
1H	26.17	100.82
1L	7.54	29.19
1F	11.18	47.67
1N	12.80	52.53
1O	4.95	26.44
1I	4.60	17.31
1J	9.88	44.51

DESIGN POINT SUMMARY		
Design Point ID	Q2 (CFS)	Q100 (CFS)
2C	6.66	25.30
2D	15.56	50.92
2B	4.40	16.85
2A	13.05	77.52
2E	19.36	100.28
2F	25.39	122.07
2G	6.89	26.54
2I	9.91	38.45
2H	40.10	167.48
2J	39.40	197.69
2K	40.61	200.87

DESIGN POINT SUMMARY		
Design Point ID	Q2 (CFS)	Q100 (CFS)
3A	7.20	30.57

DESIGN POINT SUMMARY		
Design Point ID	Q2 (CFS)	Q100 (CFS)
4B	6.52	26.60
4J	12.14	46.67
4G	2.97	12.69
1	14.92	60.55
4A	20.38	85.02
4H	1.22	4.69
4L	2.70	7.58
4F	6.27	22.48
4C	7.12	27.00
4D	9.36	37.09
4E	17.10	63.93
4I	5.03	20.89
2	20.84	79.46
4K	7.86	22.03
3	25.69	92.75

DESIGN POINT SUMMARY		
Design Point ID	Q2 (CFS)	Q100 (CFS)
5A	14.79	66.03
5C	20.35	80.41
5D	4.32	89.78
5E	27.93	92.35
5B	6.61	38.20
5N	13.66	53.43
5K	2.48	14.96
5L	4.67	28.17
5X	23.28	52.01
5F	29.47	72.77
5H	34.77	87.06
5I	4.59	20.55
5J	1.57	6.14
5W	2.46	9.41
5G	8.37	115.73
5M	2.76	16.67
5Y	5.78	24.89

DESIGN POINT SUMMARY		
Design Point ID	Q2 (CFS)	Q100 (CFS)
4	39.56	95.77
5	75.24	282.05
6B	7.34	21.27
6A	19.11	50.52
6	36.89	155.71
6D	9.68	36.24
6C	11.00	47.00
6E	46.21	99.97
6I	44.96	94.56
6G	46.00	163.03
6H	9.75	45.56
6F	13.44	62.63

BASIN SUMMARY			
BASIN ID	AREA (AC)	Q2 (CFS)	Q100 (CFS)
A1	4.86	6.07	23.37
A2	4.37	6.12	23.00
A3	3.23	3.71	14.72
A4	4.07	3.34	16.42
A5	4.10	5.28	20.28
A6	4.96	4.11	20.28
A7	6.37	8.85	33.35
A8	2.86	4.04	15.17
A9	3.44	4.60	17.31
A10	0.72	1.41	4.68
A11	6.12	7.45	28.79
A12	5.96	7.54	29.19
A13	7.08	8.00	32.24
A14	1.43	2.12	8.02
A15	7.15	4.95	26.44
B1	21.00	9.90	65.44
B2	3.13	4.40	16.85
B3	4.92	6.66	25.30
B4	4.03	10.52	30.33
B5	6.38	8.50	31.58
B6	6.38	8.50	31.58
B7	6.76	6.89	26.54
B8	4.93	6.02	23.77
B9	2.81	3.39	13.38
B10	0.65	1.89	5.29
B11	0.84	2.34	6.55
C1	7.47	7.20	30.57
D1	5.94	5.89	26.25
D2	5.33	6.52	26.60
D3	5.67	7.12	27.00
D4	2.91	2.73	11.96
D5	9.10	12.05	42.92
D6	2.57	2.80	11.66
D7	2.58	2.97	12.69
D8	0.85	1.22	4.69
D9	4.62	5.03	20.89
D10	4.80	6.30	24.78
D11	3.29	7.86	22.03
D12	1.13	2.70	7.58
E1	15.28	15.39	66.03
E2	5.27	5.36	20.26
E3	4.77	6.32	23.90
E4	3.14	4.32	16.38
E5	5.49	6.64	26.15
E6	5.54	7.76	29.46
E7	5.53	7.08	26.75
E8	4.73	6.65	24.86
E9	4.84	4.59	20.55
E10	1.29	1.57	6.14
E11	3.99	2.48	14.96
E12	7.51	4.67	28.17
E13	4.45	2.76	16.67
E14	11.27	13.66	53.43
F1	5.16	12.76	36.88
F2	2.99	7.34	21.27
F3	3.60	1.95	13.13
F4	7.36	9.68	36.24
F5	4.58	5.34	21.28
F6	5.46	4.90	22.67
F7	2.98	2.25	11.77
F8	8.58	6.91	34.42
F9	1.28	2.47	7.48
E15	1.95	2.46	9.41
E16	1.57	4.11	11.53
E17	1.55	4.05	11.37

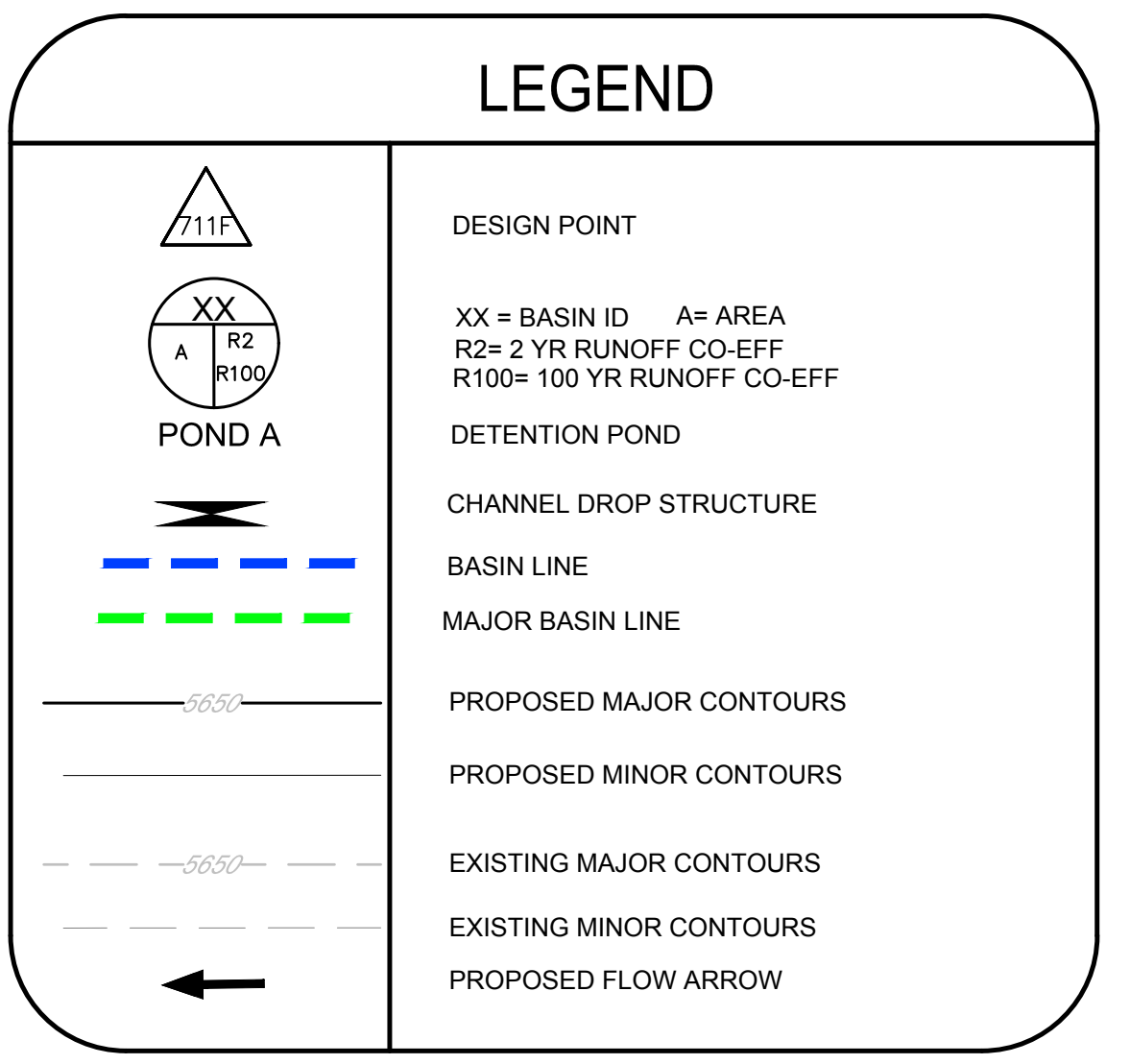
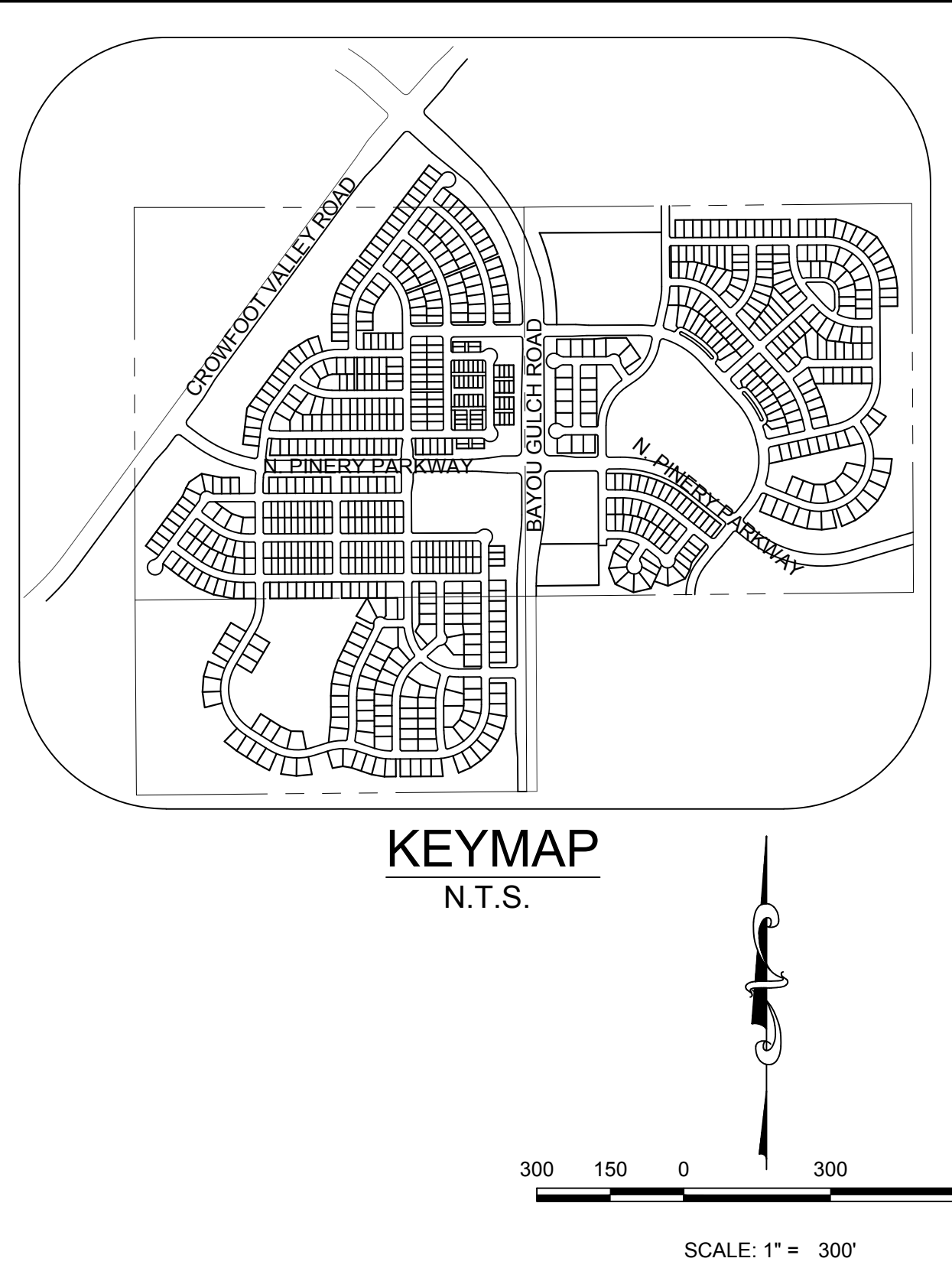

- NOTE:
- THE TOWN OF PARKER REVIEW CONSTITUTES GENERAL COMPLIANCE WITH THE TOWN'S STANDARDS AND APPROVED VARIANCES, SUBJECT TO THESE PLANS BEING STAMPED, SIGNED, AND DATED BY THE PROFESSIONAL ENGINEER OF RECORD. REVIEW BY THE TOWN DOES NOT CONSTITUTE APPROVAL OF THE PLAN DESIGN OR ACCURACY AND CORRECTNESS OF ENGINEERING CALCULATIONS. ERRORS IN THE DESIGN OR CALCULATIONS REMAIN THE RESPONSIBILITY OF THE REGISTERED PROFESSIONAL ENGINEER WHOSE STAMP AND SIGNATURE ARE AFFIXED TO THIS DOCUMENT.
  - POND A & C ARE MAINTAINED BY METRO DISTRICT AND UDFCD.
  - OUTLET STRUCTURE AND OVERFLOW WEIR DETAILS WILL BE PROVIDED WITH FINAL DRAINAGE REPORT.
  - DROP STRUCTURE DETAILS ARE PROVIDED IN CHANNEL PLAN AND PROFILE SHEET.

**BENCHMARK**  
THE DOUGLAS COUNTY CONTROL POINT KNOWN AS 1.069032, BEING A 3-1/4" ALUMINUM CAP, BEING LOCATED IN THE SOUTHWEST QUARTER OF SECTION 33, TOWNSHIP 6 SOUTH, RANGE 66 WEST OF THE SIXTH PRINCIPAL MERIDIAN, HAVING A PUBLISHED ELEVATION OF 1799.2870 METERS (5903.13 FEET) NAVD '88 DATUM.

**BASIS OF BEARINGS:**  
THE EAST LINE OF THE NORTHEAST QUARTER OF SAID SECTION 9 BEING MONUMENTED AT THE NORTHEAST CORNER OF SAID SECTION 9 BY A 3-1/4" ALUMINUM CAP STAMPED LS 23053 AND AT THE EAST QUARTER CORNER OF SAID SECTION 9 BY A 2-1/2" ALUMINUM CAP STAMPED LS 6935 BEING CONSIDERED TO BEAR SOUTH 00°15'06" EAST, 2648.70 FEET.

THE TOWN OF PARKER REVIEW CONSTITUTES GENERAL COMPLIANCE WITH THE TOWN'S STANDARDS AND APPROVED VARIANCES, SUBJECT TO THESE PLANS BEING STAMPED, SIGNED, AND DATED BY THE PROFESSIONAL ENGINEER OF RECORD. REVIEW BY THE TOWN DOES NOT CONSTITUTE APPROVAL OF THE PLAN DESIGN OR ACCURACY AND CORRECTNESS OF ENGINEERING CALCULATIONS. ERRORS IN THE DESIGN OR CALCULATIONS REMAIN THE RESPONSIBILITY OF THE REGISTERED PROFESSIONAL ENGINEER WHOSE STAMP AND SIGNATURE ARE AFFIXED TO THIS DOCUMENT.

THIS REVIEW DOES NOT CONSTITUTE APPROVAL OF ANY PRIVATE ON-SITE IMPROVEMENTS WHICH MAY BE SHOWN. CONSTRUCTION CANNOT COMMENCE UNTIL ALL REQUIRED DRAINAGE TRAFFIC REPORT(S), FINAL DEVELOPMENT PLAN(S), SPECIAL REVIEW(S), GRADING PERMIT, AND/OR OTHER PERMITS ARE COMPLETE, APPROVED, AND ON FILE WITH THE TOWN OF PARKER.

TOWN OF PARKER, PUBLIC WORKS DIRECTOR \_\_\_\_\_ DATE \_\_\_\_\_  
 TOWN OF PARKER, PUBLIC WORKS MANAGER - STORMWATER \_\_\_\_\_ DATE \_\_\_\_\_  
 TOWN OF PARKER, PUBLIC WORKS MANAGER - TRANSPORTATION \_\_\_\_\_ DATE \_\_\_\_\_

PREPARED UNDER THE SUPERVISION OF

10333 E. Dry Creek Rd.  
Suite 410  
Englewood, CO 80150  
Tel: (720) 482-9526  
Fax: (720) 482-9548

**CVL CONSULTANTS**

**ESX MANAGEMENT**  
7353 South Alton Way  
CENTENNIAL, CO 80112

**TRAILS AT CROWFOOT**  
PRELIMINARY CONSTRUCTION DRAWINGS  
OVERALL DRAINAGE MAP

SCALE: AS SHOWN  
DRAWN BY: AYK  
CHECKED BY: JJJ  
DATE: NOVEMBER 2016

FILE NO: 8130283701

SHEET NUMBER: 1

MARK SCHEURER  
COLORADO P.E. 48988

No.	Revisions	Date	Appr.	Date

N:\PROJECTS\BENCHMANS\ENGINEERING\PRELIMINARY\DRAWING\STUDIES\DRAINAGE\MAPS\DRAWING\MAP.DWG, ASUNDK, 11/20/16 2:44 PM

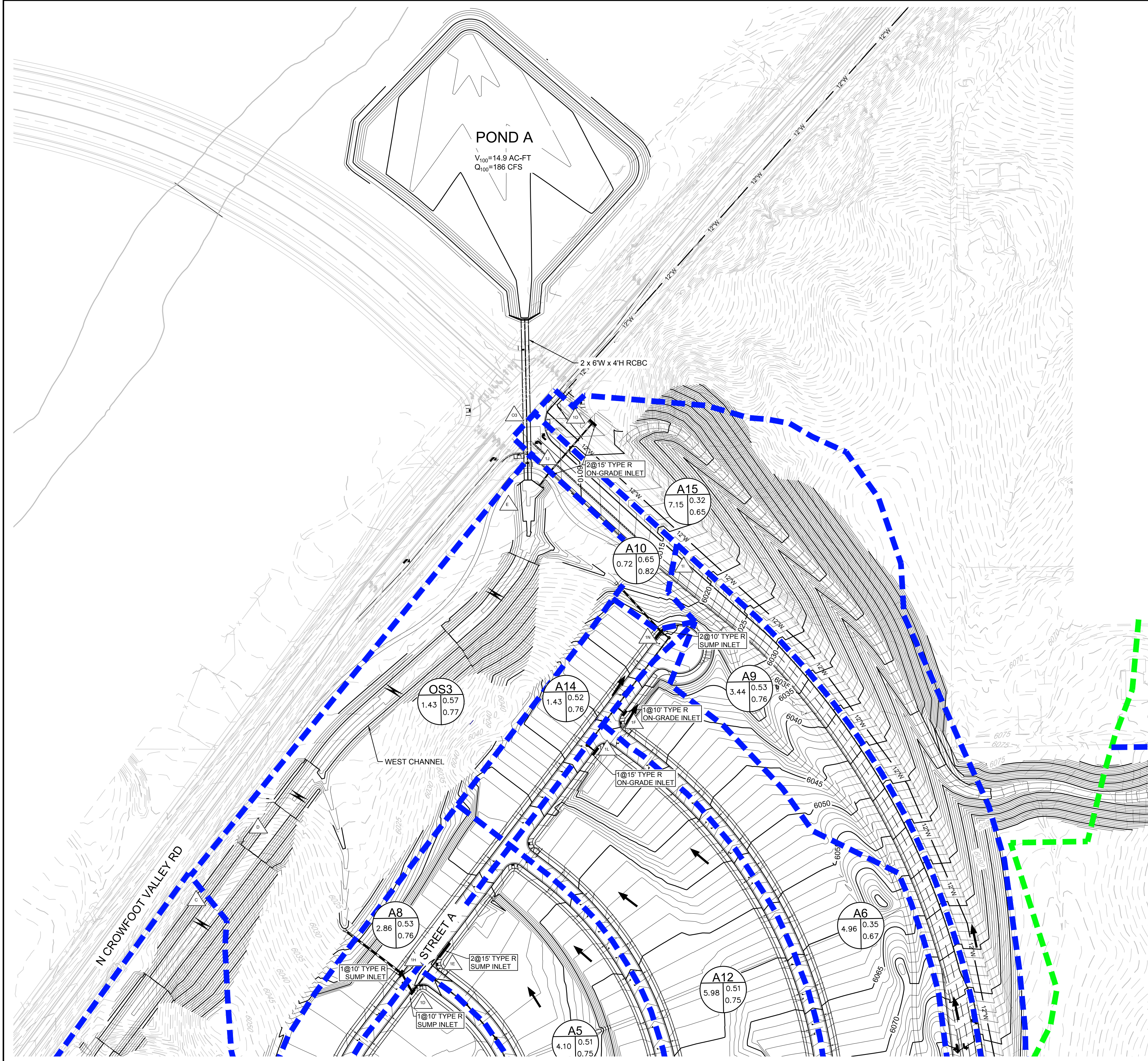

MATCHLINE - SHEET 3

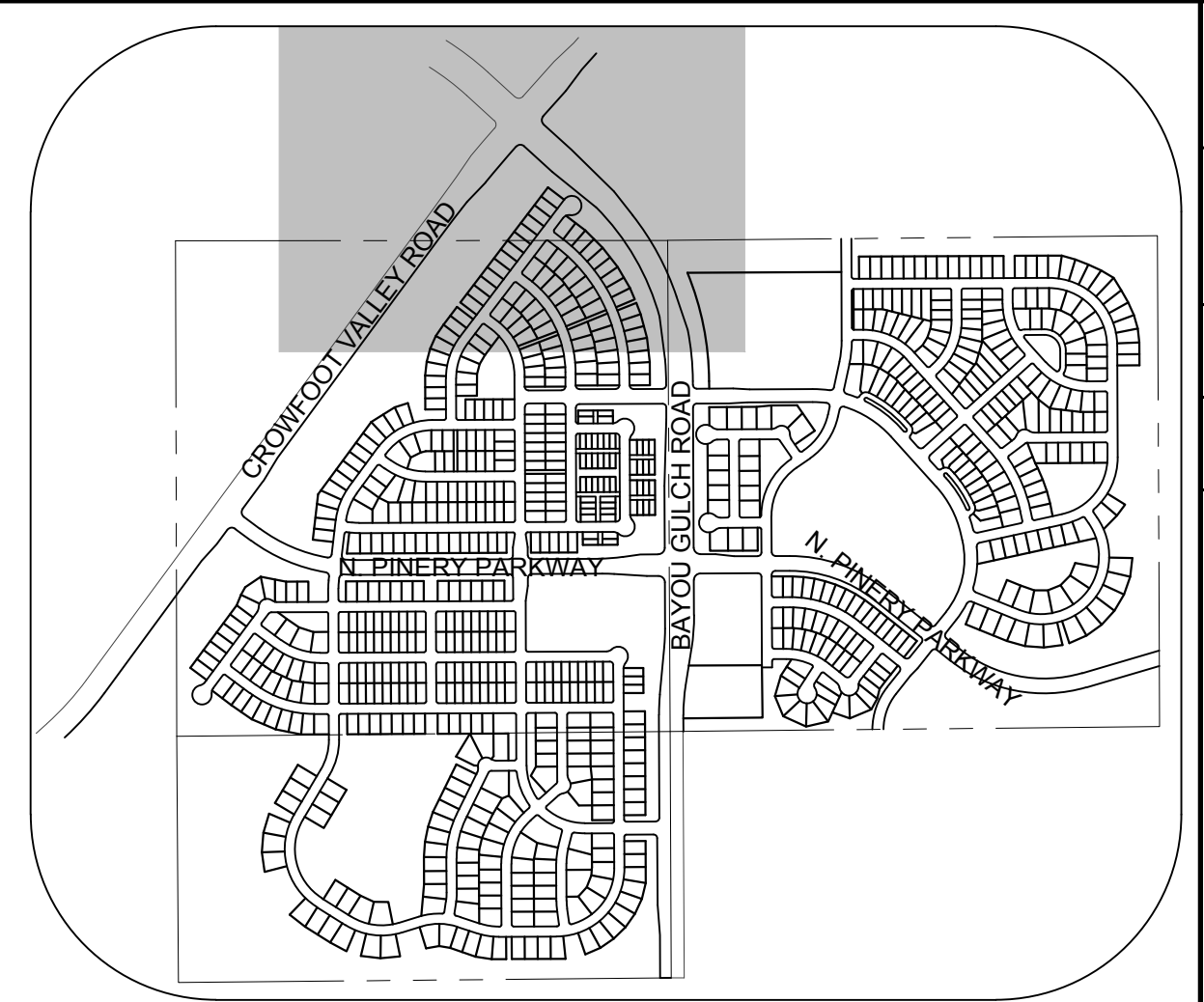
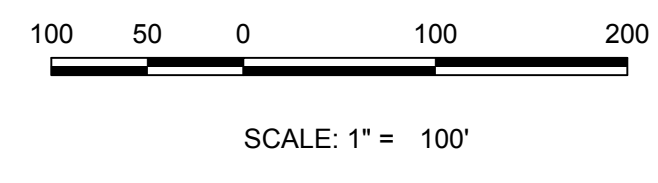

**KEYMAP**  
N.T.S.

DESIGN POINT SUMMARY		
Design Point	Q2 (CFS)	Q100 (CFS)
1A	6.07	23.37
1B	17.67	65.86
1C	21.14	79.26
1M	8.00	32.24
1G	8.85	60.30
1E	19.87	74.38
1D	22.89	88.93
1H	26.17	100.82
1L	7.54	29.19
1F	11.18	47.67
1N	12.80	52.53
1O	4.95	26.44
1I	4.60	17.31
1J	9.88	44.51

BASIN SUMMARY			
BASIN ID	AREA (AC)	Q2 (CFS)	Q100 (CFS)
A1	4.86	6.07	23.37
A2	4.37	6.12	23.00
A3	3.23	3.71	14.72
A4	4.07	3.34	16.42
A5	4.10	5.28	20.28
A6	4.96	4.11	20.28
A7	6.37	8.85	33.35
A8	2.86	4.04	15.17
A9	3.44	4.60	17.31
A10	0.72	1.41	4.68
A11	6.12	7.45	28.79
A12	5.98	7.54	29.19
A13	7.08	8.90	32.24
A14	1.43	2.12	8.02
A15	7.15	4.95	26.44

- NOTE:
1. THE TOWN OF PARKER REVIEW CONSTITUTES GENERAL COMPLIANCE WITH THE TOWN'S STANDARDS AND APPROVED VARIANCES, SUBJECT TO THESE PLANS BEING STAMPED, SIGNED, AND DATED BY THE PROFESSIONAL ENGINEER OF RECORD. REVIEW BY THE TOWN DOES NOT CONSTITUTE APPROVAL OF THE PLAN DESIGN OR ACCURACY AND CORRECTNESS OF ENGINEERING CALCULATIONS. ERRORS IN THE DESIGN OR CALCULATIONS REMAIN THE RESPONSIBILITY OF THE REGISTERED PROFESSIONAL ENGINEER WHOSE STAMP AND SIGNATURE ARE AFFIXED TO THIS DOCUMENT.
  2. POND A & C ARE MAINTAINED BY METRO DISTRICT AND UDFCD.
  3. OUTLET STRUCTURE AND OVERFLOW WEIR DETAILS WILL BE PROVIDED WITH FINAL DRAINAGE REPORT.
  4. DROP STRUCTURE DETAILS ARE PROVIDED IN CHANNEL PLAN AND PROFILE SHEET.

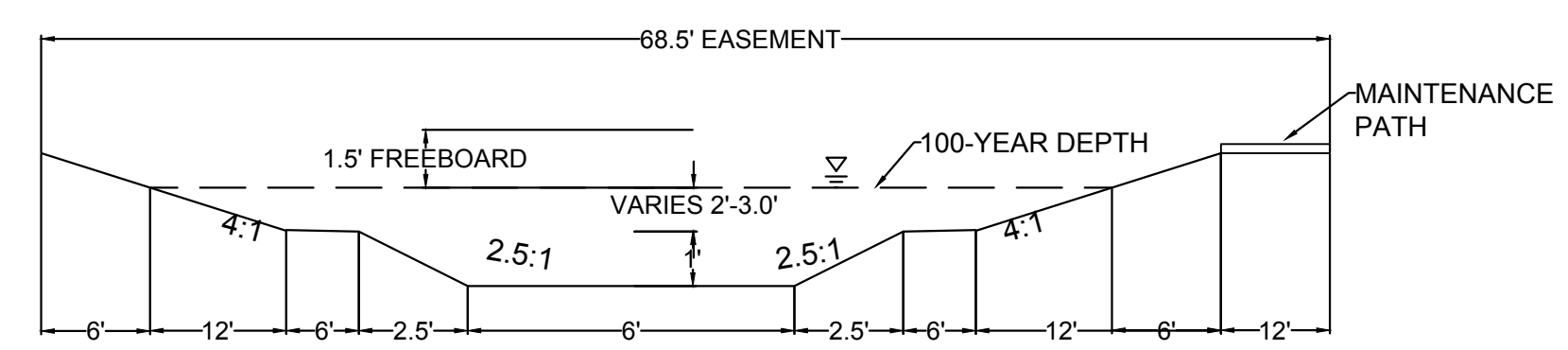
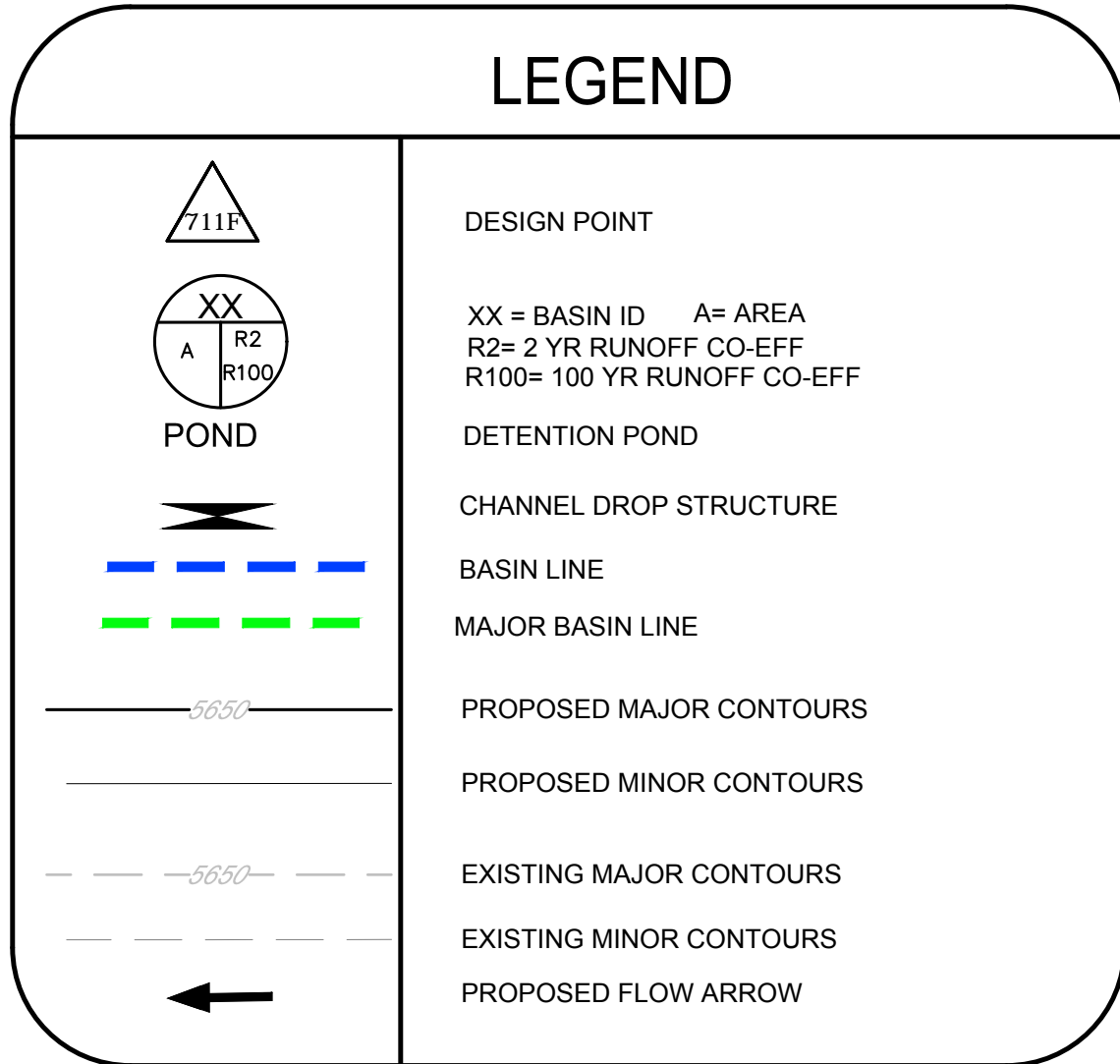

**CHANNEL SECTION**  
NO TO SCALE

**BENCHMARK**  
DOUGLAS COUNTY CONTROL POINT KNOWN AS 1.069032, BEING A 3-1/4" ALUMINUM CAP, BEING LOCATED IN THE SOUTHWEST QUARTER OF SECTION 33, TOWNSHIP 6 SOUTH, RANGE 66 WEST OF THE SIXTH PRINCIPAL MERIDIAN, HAVING A PUBLISHED ELEVATION OF 1799.2870 METERS (5903.13 FEET) NAVD '88 DATUM.

**BASIS OF BEARINGS:**  
THE EAST LINE OF THE NORTHEAST QUARTER OF SAID SECTION 9 BEING MONUMENTED AT THE NORTHEAST CORNER OF SAID SECTION 9 BY A 3-1/4" ALUMINUM CAP STAMPED LS 23053 AND AT THE EAST QUARTER CORNER OF SAID SECTION 9 BY A 2-1/2" ALUMINUM CAP STAMPED LS 6935 BEING CONSIDERED TO BEAR SOUTH 00°15'06" EAST, 2648.70 FEET.

PREPARED UNDER THE SUPERVISION OF

MARK SCHEURER  
COLORADO P.E. 48988

SHEET NUMBER	DRAWN BY: AYK	CHECKED BY: JJ	DATE: NOVEMBER, 2016	SCALE:	AS SHOWN	FILE NO:	8130283701
				TRAILS AT CROWFOOT PRELIMINARY CONSTRUCTION DRAWINGS DRAINAGE MAP	ESX MANAGEMENT 7353 South Alton Way CENTENNIAL, CO 80112	Revisions	No.

10333 E. Dry Creek Rd.  
Suite 410  
Englewood, Colorado 80150  
Tel: (720) 482-9526  
Fax: (720) 482-9548

2



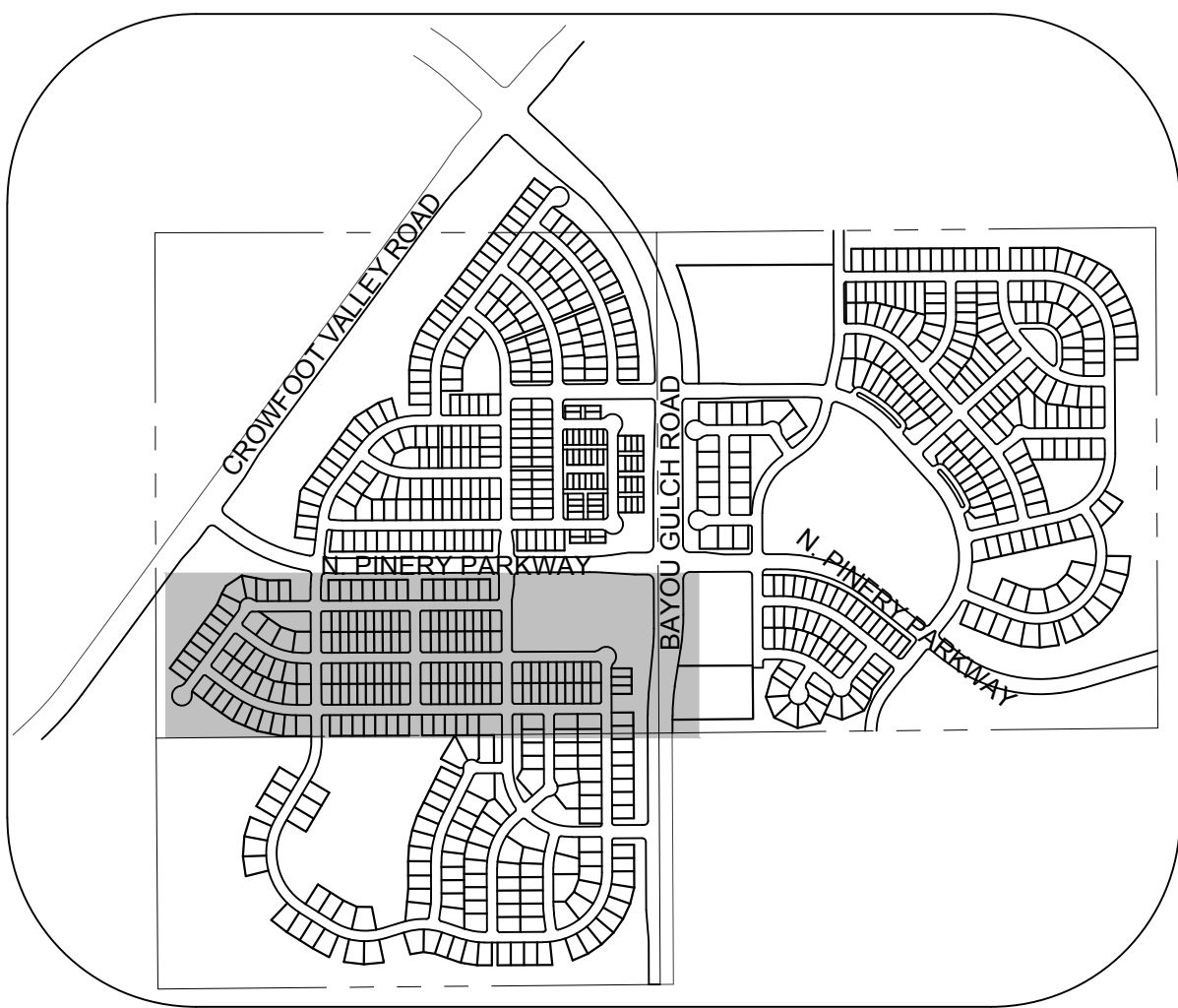

### LEGEND

	DESIGN POINT
	XX = BASIN ID A= AREA R2= 2 YR RUNOFF CO-EFF R100= 100 YR RUNOFF CO-EFF
	POND
	CHANNEL DROP STRUCTURE
	BASIN LINE
	MAJOR BASIN LINE
	PROPOSED MAJOR CONTOURS
	PROPOSED MINOR CONTOURS
	EXISTING MAJOR CONTOURS
	EXISTING MINOR CONTOURS
	PROPOSED FLOW ARROW

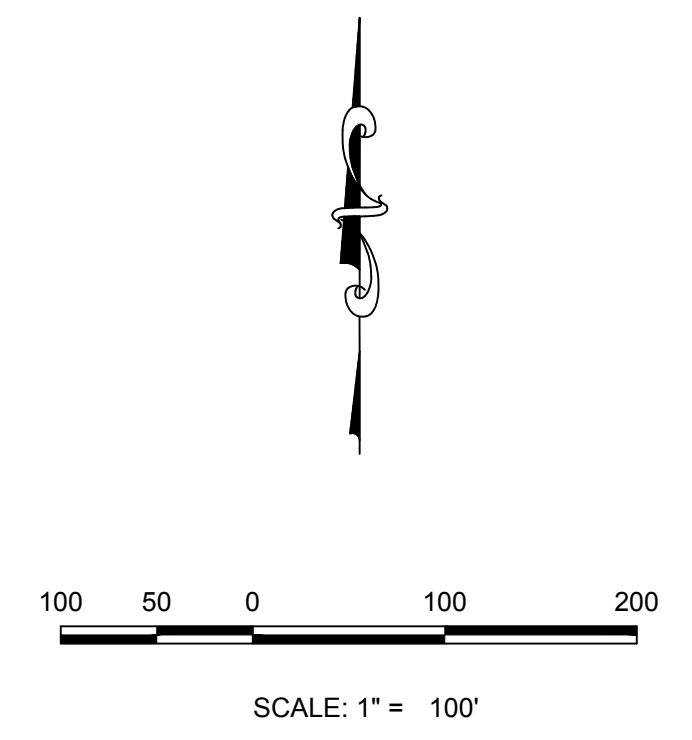
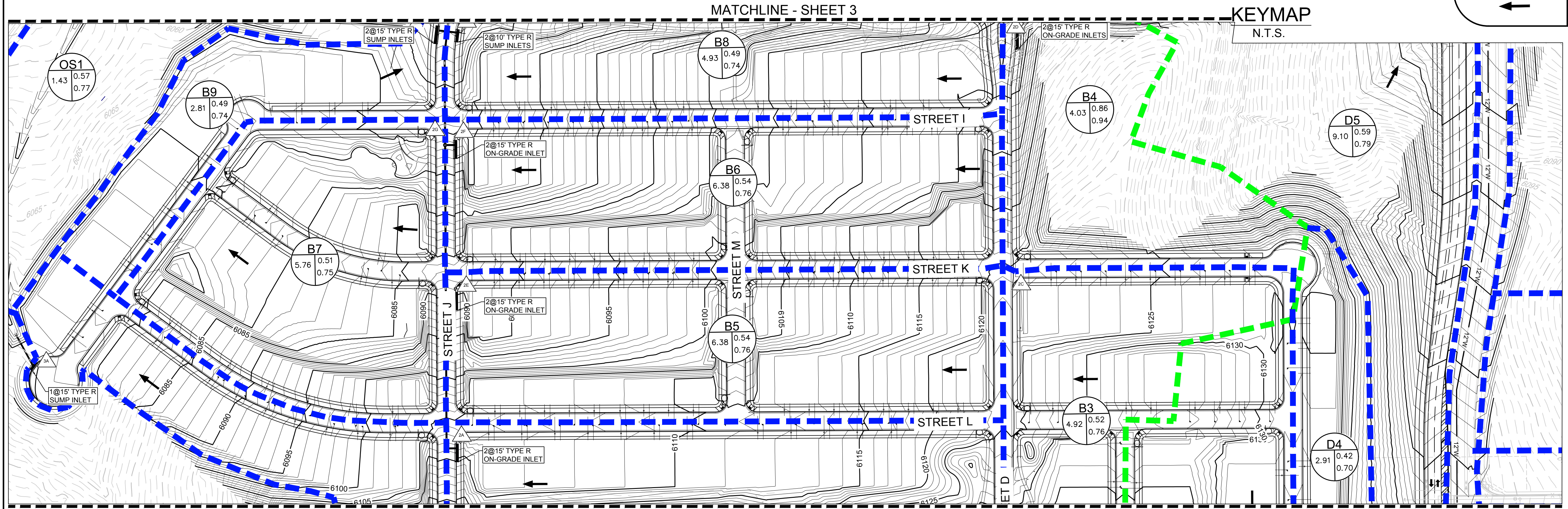

N:\PROJECTS\BENCHMARCH\ENGINEERING\PRELIMINARY DRAINAGE STUDIES\DRAINAGE MAPS\DRAINAGE MAP DWG, AS\FUNCK, 11/20/2016 2:42 PM

BASIN SUMMARY			
BASIN ID	AREA (AC)	Q2 (CFS)	Q100 (CFS)
B1	21.00	9.90	65.44
B2	3.13	4.40	16.85
B3	4.92	6.66	25.30
B4	4.03	10.52	30.33
B5	6.38	8.50	31.58
B6	6.38	8.50	31.58
B7	5.76	6.89	26.54
B8	4.93	6.02	23.77
B9	2.81	3.39	13.38
B10	0.65	1.89	5.29
B11	0.84	2.34	6.55

DESIGN POINT SUMMARY			
Design Point ID	Q2 (CFS)	Q100 (CFS)	
2C	6.66	25.30	
2D	15.56	50.92	
2B	4.40	16.85	
2A	13.05	77.52	
2E	19.36	100.28	
2F	25.39	122.07	
2G	6.89	26.54	
2I	9.91	38.45	
2H	40.10	167.48	
2J	39.40	197.69	
2K	40.61	200.87	

BASIN SUMMARY			
BASIN ID	AREA (AC)	Q2 (CFS)	Q100 (CFS)
C1	7.47	7.20	30.57
D1	5.94	5.89	26.25
D2	5.33	6.52	26.60
D3	5.67	7.12	27.00
D4	2.91	2.73	11.96
D5	9.10	12.05	42.92
D6	2.57	2.80	11.66
D7	2.58	2.97	12.69
D8	0.85	1.22	4.69
D9	4.62	5.03	20.89
D10	4.80	6.30	24.78
D11	3.29	7.86	22.03
D12	1.13	2.70	7.58

DESIGN POINT SUMMARY			
Design Point ID	Q2 (CFS)	Q100 (CFS)	
3A	7.20	30.57	

DESIGN POINT SUMMARY			
Design Point ID	Q2 (CFS)	Q100 (CFS)	
4B	6.52	26.60	
4J	12.14	48.67	
4G	2.97	12.69	
1	14.92	60.55	
4A	20.38	85.02	
4H	1.22	4.69	
4L	2.70	7.58	
4F	6.27	22.48	
4C	7.12	27.00	
4D	9.36	37.09	
4E	17.10	63.93	
4I	5.03	20.89	
2	20.84	79.46	
4K	7.86	22.03	
3	25.69	92.75	

**BENCHMARK**  
THE DOUGLAS COUNTY CONTROL POINT KNOWN AS 1.069032, BEING A 3-1/4" ALUMINUM CAP, BEING LOCATED IN THE SOUTHWEST QUARTER OF SECTION 33, TOWNSHIP 6 SOUTH, RANGE 66 WEST OF THE SIXTH PRINCIPAL MERIDIAN, HAVING A PUBLISHED ELEVATION OF 1799.2870 METERS (5903.13 FEET) NAVD '88 DATUM.

**BASIS OF BEARINGS:**  
THE EAST LINE OF THE NORTHEAST QUARTER OF SAID SECTION 9 BEING MONUMENTED AT THE NORTHEAST CORNER OF SAID SECTION 9 BY A 3-1/4" ALUMINUM CAP STAMPED LS 23053 AND AT THE EAST QUARTER CORNER OF SAID SECTION 9 BY A 1-1/2" ALUMINUM CAP STAMPED LS 6935 BEING CONSIDERED TO BEAR SOUTH 00°15'06" EAST, 2648.70 FEET.

- NOTE:**
1. THE TOWN OF PARKER REVIEW CONSTITUTES GENERAL COMPLIANCE WITH THE TOWN'S STANDARDS AND APPROVED VARIANCES, SUBJECT TO THESE PLANS BEING STAMPED, SIGNED, AND DATED BY THE PROFESSIONAL ENGINEER OF RECORD. REVIEW BY THE TOWN DOES NOT CONSTITUTE APPROVAL OF THE PLAN DESIGN OR ACCURACY AND CORRECTNESS OF ENGINEERING CALCULATIONS. ERRORS IN THE DESIGN OR CALCULATIONS REMAIN THE RESPONSIBILITY OF THE REGISTERED PROFESSIONAL ENGINEER WHOSE STAMP AND SIGNATURE ARE AFFIXED TO THIS DOCUMENT.
  2. POND A & C ARE MAINTAINED BY METRO DISTRICT AND UDFCD.
  3. OUTLET STRUCTURE AND OVERFLOW WEIR DETAILS WILL BE PROVIDED WITH FINAL DRAINAGE REPORT.
  4. DROP STRUCTURE DETAILS ARE PROVIDED IN CHANNEL PLAN AND PROFILE SHEET.

PREPARED UNDER THE SUPERVISION OF

MARK SCHEURER  
COLORADO P.E. 48988

SHEET NUMBER	DRAWN BY: AYK	CHECKED BY: JJ	DATE: NOVEMBER, 2016	SCALE:	AS SHOWN	FILE NO:	8130283701
				4			
TRAILS AT CROWFOOT PRELIMINARY CONSTRUCTION DRAWINGS DRAINAGE MAP				ESX MANAGEMENT 7353 South Alton Way CENTENNIAL, CO 80112			
10333 E. Dry Creek Rd. Suite 410 Englewood, CO 80150 Tel: (720) 482-9526 Fax: (720) 482-9548							
No.	Revisions	Date	Init.	Appr.	Date		

MATCHLINE - SHEET 4

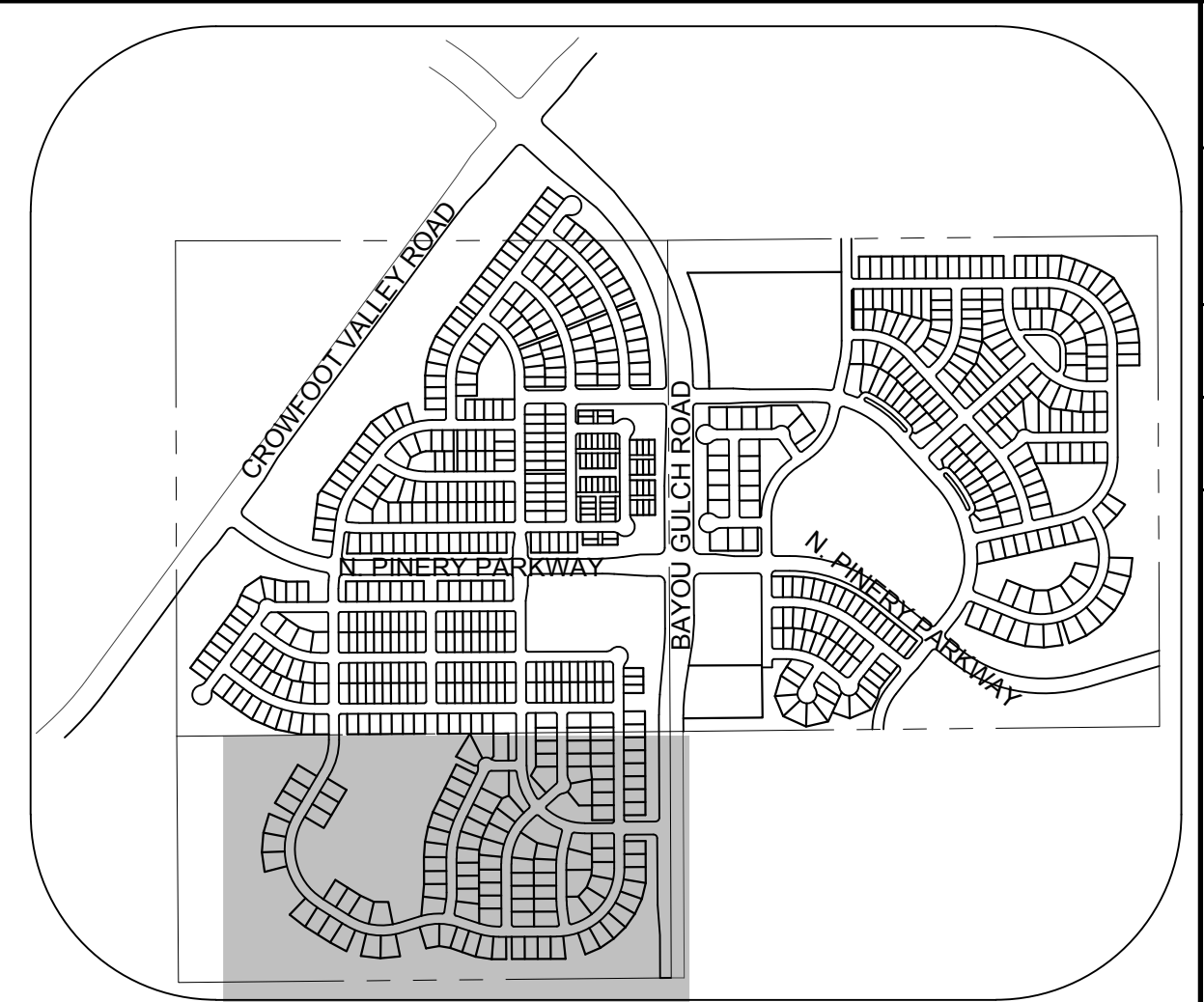
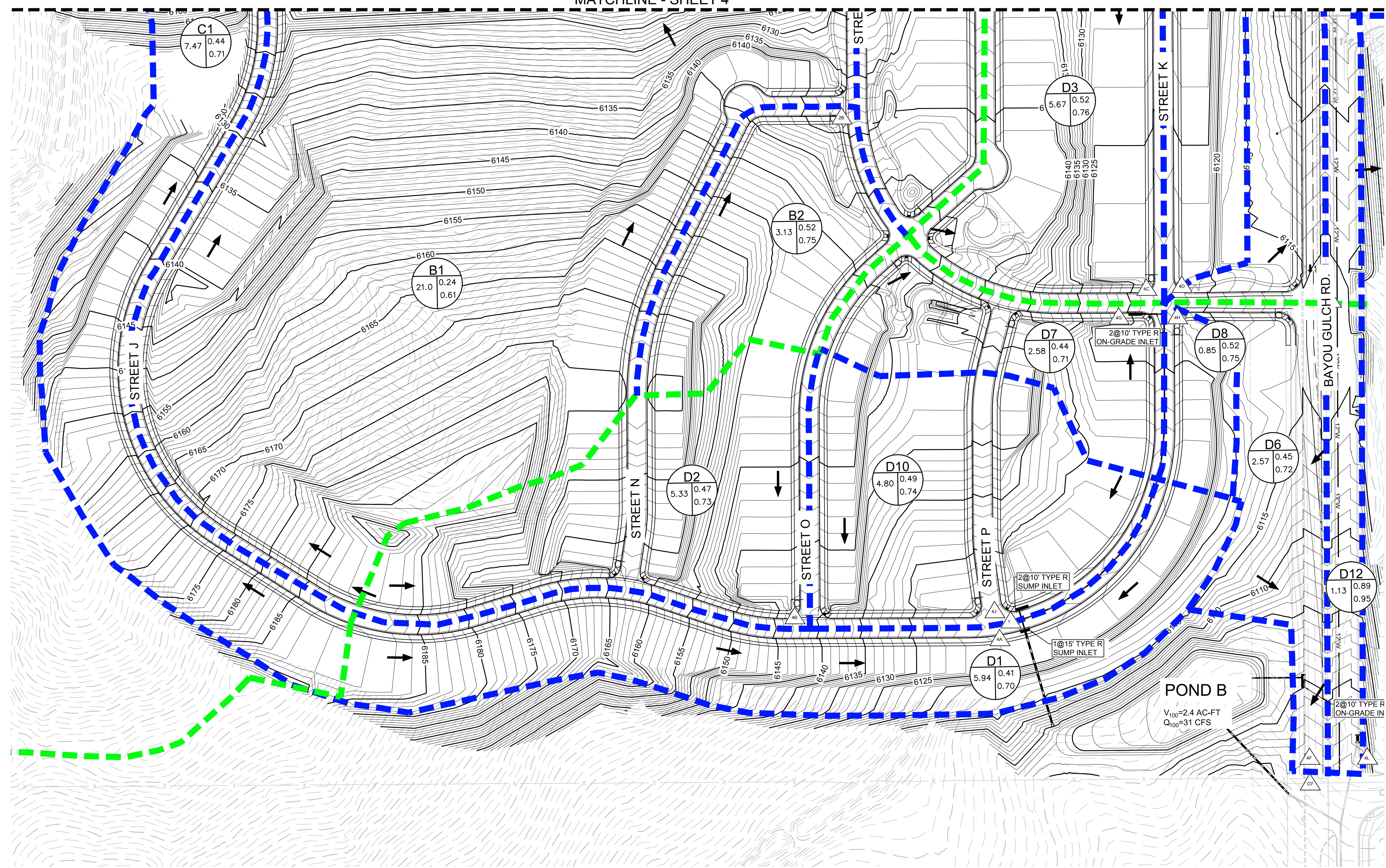

KEYMAP  
N.T.S.

- NOTE:
1. THE TOWN OF PARKER REVIEW CONSTITUTES GENERAL COMPLIANCE WITH THE TOWN'S STANDARDS AND APPROVED VARIANCES, SUBJECT TO THESE PLANS BEING STAMPED, SIGNED, AND DATED BY THE PROFESSIONAL ENGINEER OF RECORD. REVIEW BY THE TOWN DOES NOT CONSTITUTE APPROVAL OF THE PLAN DESIGN OR ACCURACY AND CORRECTNESS OF ENGINEERING CALCULATIONS. ERRORS IN THE DESIGN OR CALCULATIONS REMAIN THE RESPONSIBILITY OF THE REGISTERED PROFESSIONAL ENGINEER WHOSE STAMP AND SIGNATURE ARE AFFIXED TO THIS DOCUMENT.
  2. POND A & C ARE MAINTAINED BY METRO DISTRICT AND UDFCD.
  3. OUTLET STRUCTURE AND OVERFLOW WEIR DETAILS WILL BE PROVIDED WITH FINAL DRAINAGE REPORT.
  4. DROP STRUCTURE DETAILS ARE PROVIDED IN CHANNEL PLAN AND PROFILE SHEET.

### LEGEND

	DESIGN POINT
	XX = BASIN ID    A= AREA R2= 2 YR RUNOFF CO-EFF R100= 100 YR RUNOFF CO-EFF
	DETENTION POND
	CHANNEL DROP STRUCTURE
	BASIN LINE
	MAJOR BASIN LINE
	PROPOSED MAJOR CONTOURS
	PROPOSED MINOR CONTOURS
	EXISTING MAJOR CONTOURS
	EXISTING MINOR CONTOURS
	PROPOSED FLOW ARROW

BASIN SUMMARY			
BASIN ID	AREA (AC)	Q2 (CFS)	Q100 (CFS)
B1	21.00	9.90	65.44
B2	3.13	4.40	16.85
B3	4.92	6.66	25.30
B4	4.03	10.52	30.33
B5	6.38	8.50	31.58
B6	6.38	8.50	31.58
B7	5.76	6.89	26.54
B8	4.93	6.02	23.77
B9	2.81	3.39	13.38
B10	0.65	1.89	5.29
B11	0.84	2.34	6.55

DESIGN POINT SUMMARY			
Design Point ID	Q2 (CFS)	Q100 (CFS)	
2C	6.66	25.30	
2D	15.56	50.92	
2B	4.40	16.85	
2A	13.05	77.52	
2E	19.36	100.28	
2F	25.39	122.07	
2G	6.89	26.54	
2I	9.91	38.45	
2H	40.10	167.48	
2J	39.40	197.69	
2K	40.61	200.87	

DESIGN POINT SUMMARY			
Design Point ID	Q2 (CFS)	Q100 (CFS)	
4B	6.52	26.60	
4J	12.14	48.67	
4G	2.97	12.69	
1	14.92	60.55	
4A	20.38	85.02	
4H	1.22	4.69	
4L	2.70	7.58	
4F	6.27	22.48	
4C	7.12	27.00	
4D	9.36	37.09	
4E	17.10	63.93	
4I	5.03	20.89	
2	20.84	79.46	
4K	7.86	22.03	
3	25.69	92.75	

BASIN SUMMARY			
BASIN ID	AREA (AC)	Q2 (CFS)	Q100 (CFS)
C1	7.47	7.20	30.57
D1	5.94	5.89	26.25
D2	5.33	6.52	26.60
D3	5.67	7.12	27.00
D4	2.91	2.73	11.96
D5	9.10	12.05	42.92
D6	2.57	2.80	11.66
D7	2.58	2.97	12.69
D8	0.85	1.22	4.69
D9	4.62	5.03	20.89
D10	4.80	6.30	24.78
D11	3.29	7.86	22.03
D12	1.13	2.70	7.58

DESIGN POINT SUMMARY			
Design Point ID	Q2 (CFS)	Q100 (CFS)	
3A	7.20	30.57	

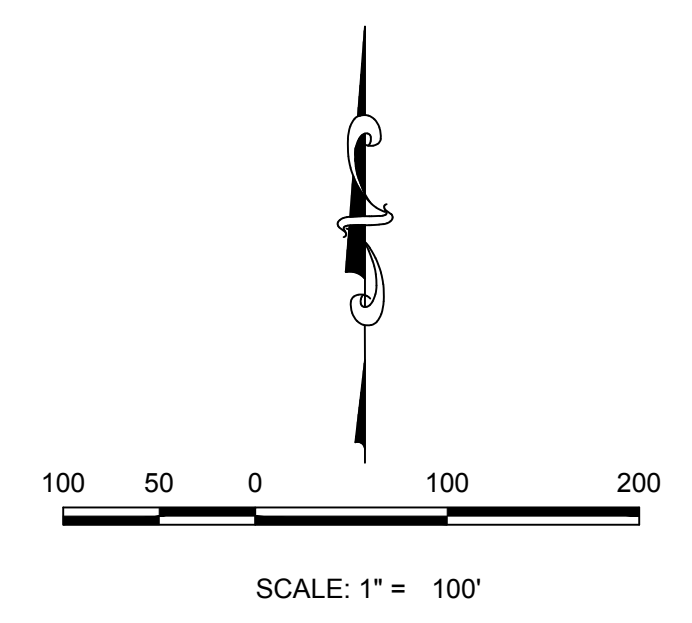

**BENCHMARK**  
THE DOUGLAS COUNTY CONTROL POINT KNOWN AS 1.060032, BEING A 3-1/4" ALUMINUM CAP, BEING LOCATED IN THE SOUTHWEST QUARTER OF SECTION 33, TOWNSHIP 6 SOUTH, RANGE 66 WEST OF THE SIXTH PRINCIPAL MERIDIAN, HAVING A PUBLISHED ELEVATION OF 1799.2870 METERS (5903.13 FEET) NAVD '88 DATUM.

**BASIS OF BEARINGS:**  
THE EAST LINE OF THE NORTHEAST QUARTER OF SAID SECTION 9 BEING MONUMENTED AT THE NORTHEAST CORNER OF SAID SECTION 9 BY A 3-1/4" ALUMINUM CAP STAMPED LS 23053 AND AT THE EAST QUARTER CORNER OF SAID SECTION 9 BY A 2-1/2" ALUMINUM CAP STAMPED LS 6935 BEING CONSIDERED TO BEAR SOUTH 00°15'06" EAST, 2648.70 FEET.

PREPARED UNDER THE SUPERVISION OF

MARK SCHEURER  
COLORADO P.E. 48988

N:\PROJECTS\BENCH\ENGINEERING\DRAINAGE\BENCH\DWG\AS\DWG\_11/20/16 2:42 PM

SHEET NUMBER <b>5</b>	SCALE: AS SHOWN	FILE NO: 8130283701	DATE: NOVEMBER 2016
	DRAWN BY: AYK	CHECKED BY: JU	
TRAILS AT CROWFOOT PRELIMINARY CONSTRUCTION DRAWINGS DRAINAGE MAP			
ESX MANAGEMENT 7353 South Alton Way CENTENNIAL, CO 80112			
No.	Revisions	Date	Appr.

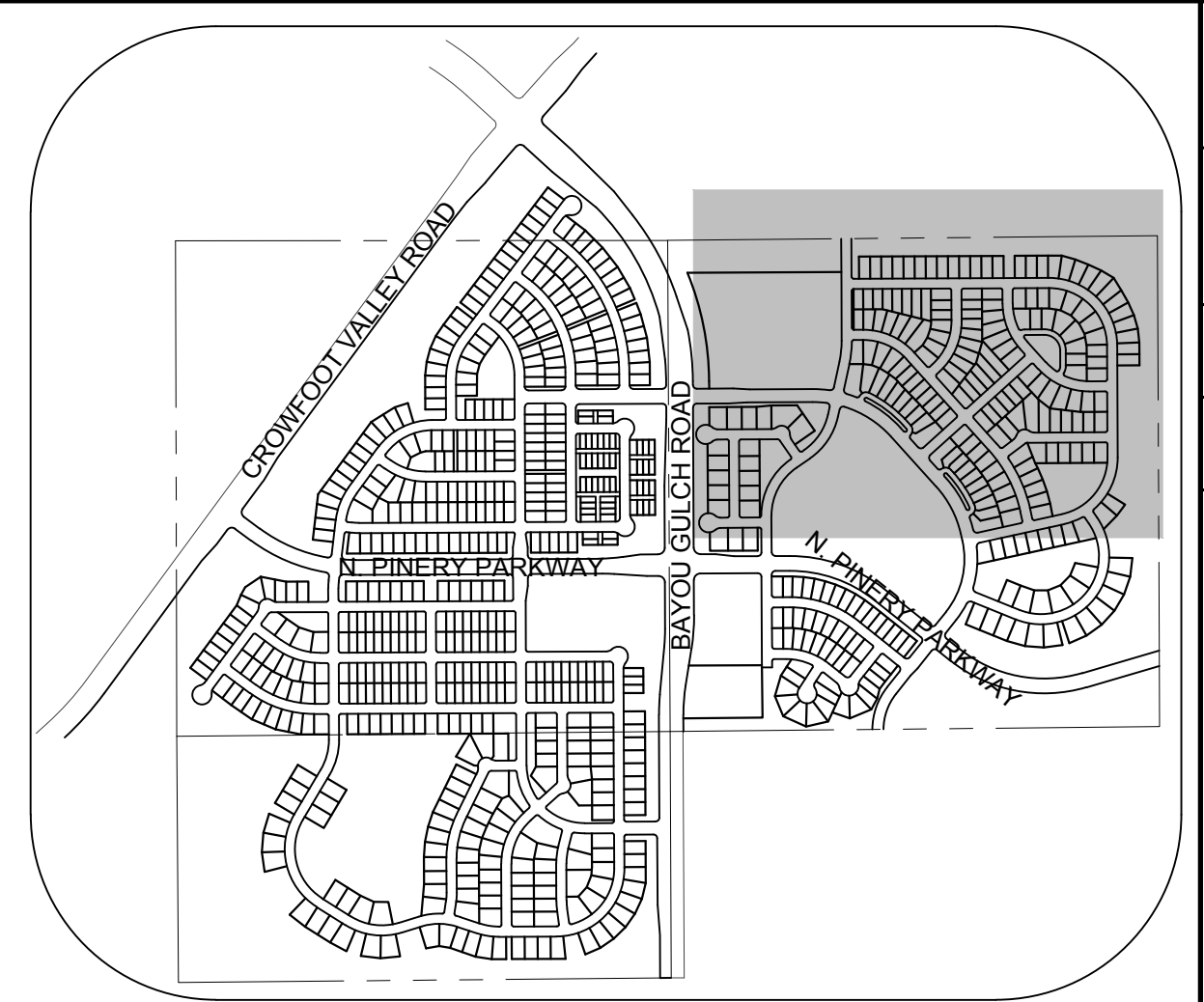
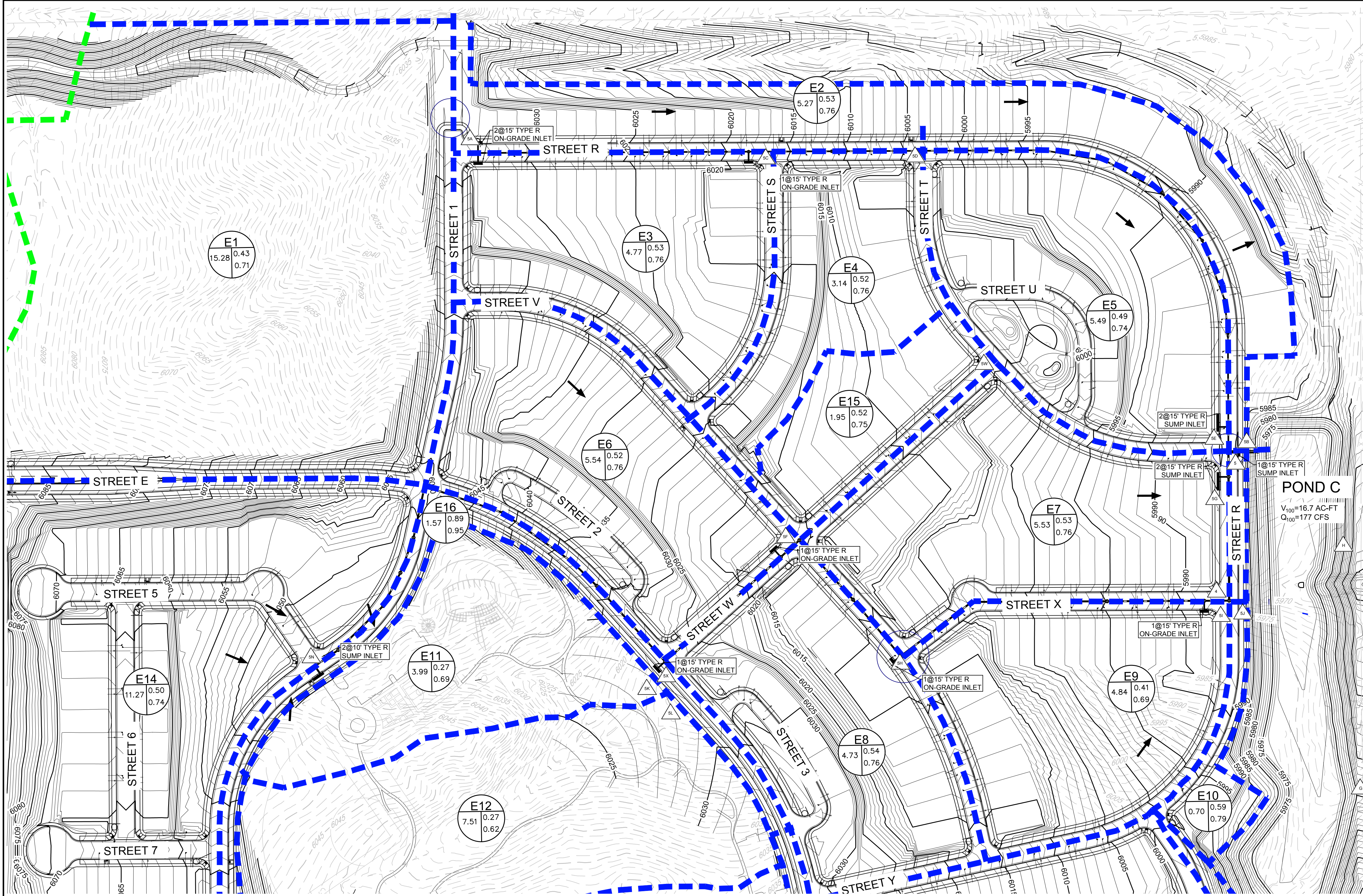

KEYMAP  
N.T.S.

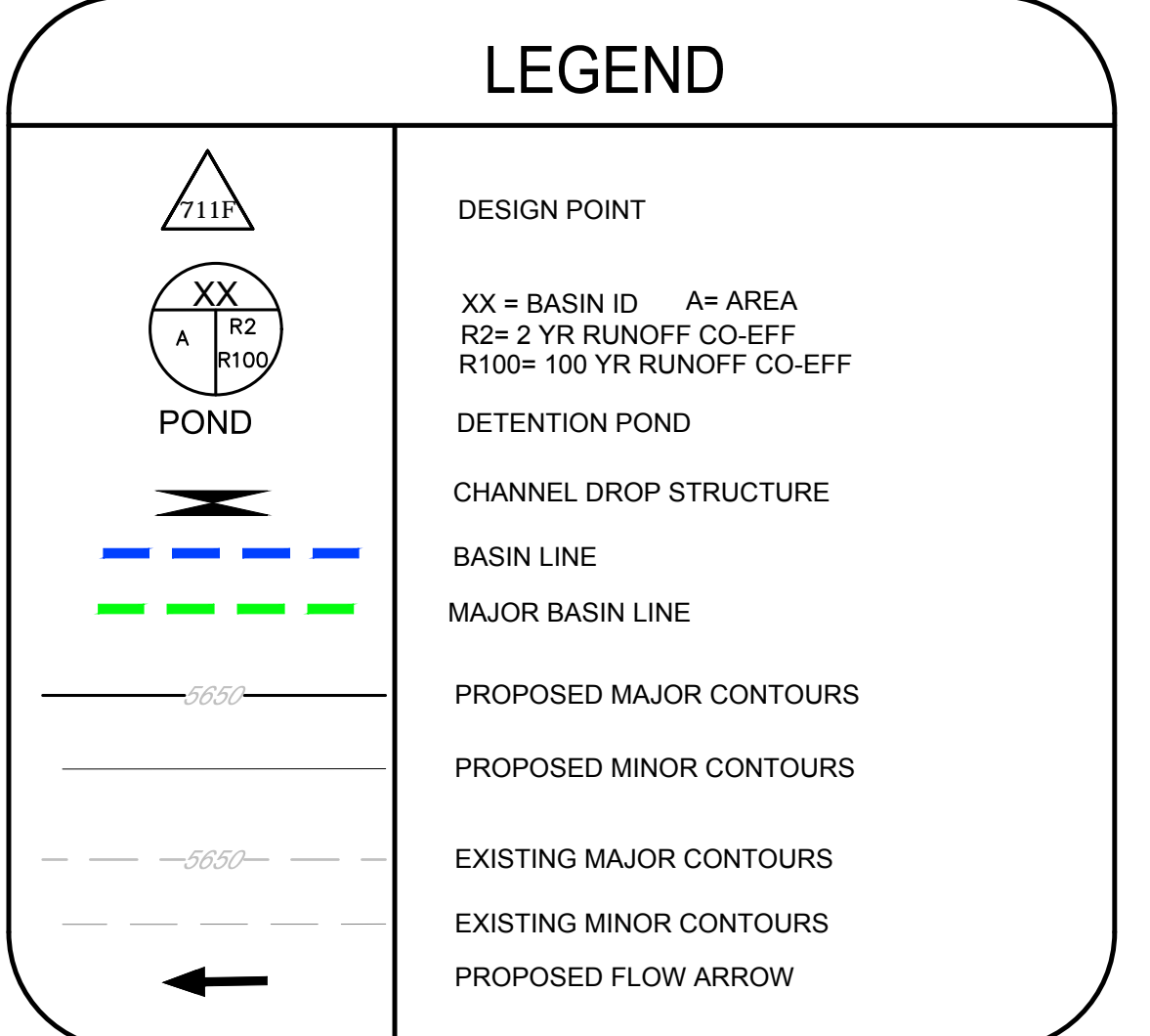
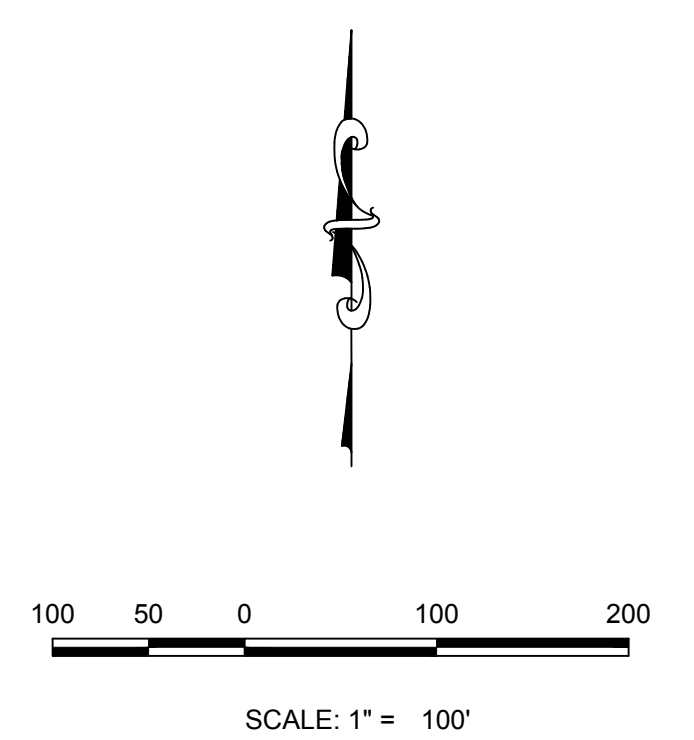

BASIN SUMMARY			
BASIN ID	AREA (AC)	Q2 (CFS)	Q100 (CFS)
E1	15.28	15.39	66.03
E2	5.27	5.36	20.26
E3	4.77	6.32	23.90
E4	3.14	4.32	16.38
E5	5.49	6.64	26.15
E6	5.54	7.76	29.46
E7	5.53	7.08	26.75
E8	4.73	6.65	24.86
E9	4.84	4.59	20.55
E10	1.29	1.57	6.14
E11	3.99	2.48	14.96
E12	7.51	4.67	28.17
E13	4.45	2.76	16.67
E14	11.27	13.66	53.43

DESIGN POINT SUMMARY		
Design Point	Q2 (CFS)	Q100 (CFS)
SA	14.79	66.03
SC	20.35	80.41
SD	4.32	89.78
SE	27.93	92.35
SB	6.61	38.20
SN	13.66	53.43
SK	2.48	14.96
SL	4.67	28.17
SX	23.28	52.01
SF	29.47	72.77
SH	34.77	87.06
SI	4.59	20.55
SJ	1.57	6.14
SW	2.46	9.41
SG	8.37	115.73
SM	2.76	16.67
SY	5.78	24.89

MATCHLINE - SHEET 7

- NOTE:
- THE TOWN OF PARKER REVIEW CONSTITUTES GENERAL COMPLIANCE WITH THE TOWN'S STANDARDS AND APPROVED VARIANCES, SUBJECT TO THESE PLANS BEING STAMPED, SIGNED, AND DATED BY THE PROFESSIONAL ENGINEER OF RECORD. REVIEW BY THE TOWN DOES NOT CONSTITUTE APPROVAL OF THE PLAN DESIGN OR ACCURACY AND CORRECTNESS OF ENGINEERING CALCULATIONS. ERRORS IN THE DESIGN OR CALCULATIONS REMAIN THE RESPONSIBILITY OF THE REGISTERED PROFESSIONAL ENGINEER WHOSE STAMP AND SIGNATURE ARE AFFIXED TO THIS DOCUMENT.
  - POND A & C ARE MAINTAINED BY METRO DISTRICT AND UDFCD.
  - OUTLET STRUCTURE AND OVERFLOW WEIR DETAILS WILL BE PROVIDED WITH FINAL DRAINAGE REPORT.
  - DROP STRUCTURE DETAILS ARE PROVIDED IN CHANNEL PLAN AND PROFILE SHEET.

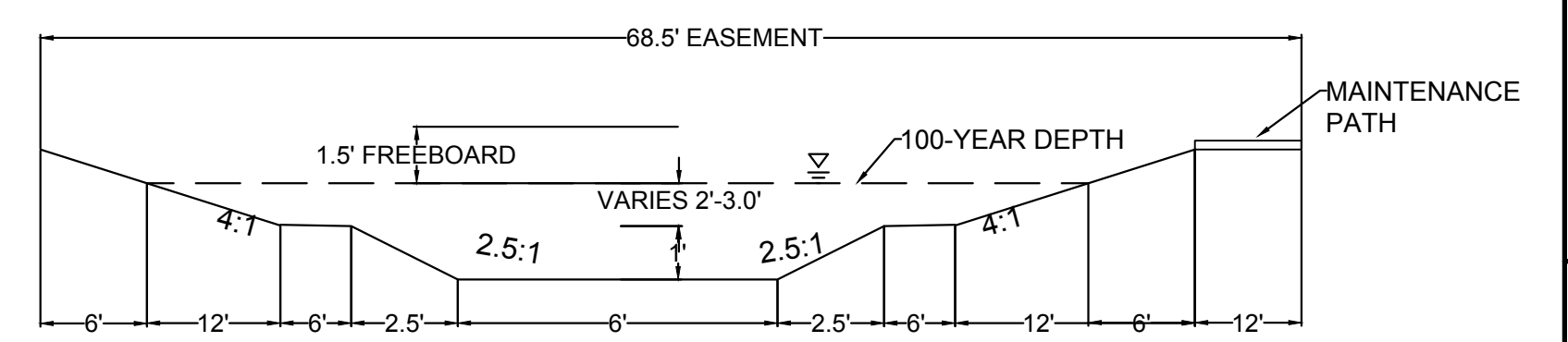

CHANNEL SECTION  
NO TO SCALE

**BENCHMARK**  
DOUGLAS COUNTY CONTROL POINT KNOWN AS 1.069032, BEING A 3-1/4" ALUMINUM CAP, BEING LOCATED IN THE SOUTHWEST QUARTER OF SECTION 33, TOWNSHIP 6 SOUTH, RANGE 66 WEST OF THE SIXTH PRINCIPAL MERIDIAN, HAVING A PUBLISHED ELEVATION OF 1799.2870 METERS (5903.13 FEET) NAVD '88 DATUM.

**BASIS OF BEARINGS:**  
THE EAST LINE OF THE NORTHEAST QUARTER OF SAID SECTION 9 BEING MONUMENTED AT THE NORTHEAST CORNER OF SAID SECTION 9 BY A 3-1/4" ALUMINUM CAP STAMPED LS 23053 AND AT THE EAST QUARTER CORNER OF SAID SECTION 9 BY A 2-1/2" ALUMINUM CAP STAMPED LS 6935 BEING CONSIDERED TO BEAR SOUTH 00°15'06" EAST, 2648.70 FEET.

PREPARED UNDER THE SUPERVISION OF

MARK SCHEURER  
COLORADO P.E. 48988

SHEET NUMBER <b>6</b>	SCALE: AS SHOWN	FILE NO: 8130283701	DATE: NOVEMBER 2016
	DRAWN BY: AYK	CHECKED BY: JJ	
	TRAILS AT CROWFOOT PRELIMINARY CONSTRUCTION DRAWINGS DRAINAGE MAP		
	ES&S MANAGEMENT 7353 South Alton Way CENTENNIAL, CO 80112		

10333 E. Dry Creek Rd.  
Suite 410  
Englewood, Colorado 80150  
Tel: (720) 482-9526  
Fax: (720) 482-9548

**CVL**  
CONSULTANTS

No.	Revisions	Date	Appr.	Date

