

# SUBMITTAL



Submittal number	96.0	Date	01/10/2020
Project	TRAILS AT CROWFOOT F1 & 9	6954 N. CROWFOOT VALLEY RD. PARKER, CO 80134	
Project number	201810		
Spec section			
Subsection		Status	Open
Current action	Submitted	Ball in court	
Topic	TCF F1 Park Furnishings and Accessories		

Submitter	MICHAEL TOMAS SNYDER
Reviewer	
Cc	

Date submitted	01/13/2020	Submission due date	01/13/2020
Released for review		Review due date	01/20/2020
Date returned		Required on site date	
Date closed			

**Notes**

Please see the attached ELCI Transmittal # 4: Park Site Furnishings and Accessories



**Letter of Transmittal**

**To:** Mike Snyder  
Kelley Trucking Inc  
6201 McIntyre St  
Golden, CO 80403  
Ph: (303)279-4150

**Transmittal #: 4**  
**Date:** 1/9/2020  
**Job:** 01-10-19013 Trails at Crowfoot Park

**Subject:** Submittal

- WE ARE SENDING YOU**
- |  |  |
|--|--|
| <input checked="" type="checkbox"/> Attached | <input type="checkbox"/> Under separate cover via the following items: |
| <input type="checkbox"/> Shop drawings       | <input type="checkbox"/> Prints  |
| <input type="checkbox"/> Copy of letter      | <input type="checkbox"/> Change order                                  |
|  | <input type="checkbox"/> Plans   |
|  | <input type="checkbox"/> Specifications                                |
|  | <input type="checkbox"/> Samples                                       |
|  | <input checked="" type="checkbox"/> Submittal                          |

Document Type	Copies	Date	No.	Description
Submittal	1		Site Furnishing-1 Re	Park Site Furnishings and Accessories

**THESE ARE TRANSMITTED as checked below:**

- |  |   |   |
|--|---|---|
| <input checked="" type="checkbox"/> For approval | <input type="checkbox"/> Approved as submitted            | <input type="checkbox"/> Resubmit ___ copies for approval   |
| <input type="checkbox"/> For your use            | <input type="checkbox"/> Approved as noted                | <input type="checkbox"/> Submit ___ copies for distribution |
| <input type="checkbox"/> As requested            | <input type="checkbox"/> Returned for corrections         | <input type="checkbox"/> Return ___ corrected prints        |
| <input type="checkbox"/> For review and comment  | <input type="checkbox"/> Other                            |   |
| <input type="checkbox"/> FOR BIDS DUE            | <input type="checkbox"/> PRINTS RETURNED AFTER LOAN TO US |   |

**Remarks:**

**Copy To:** Con Cockrum (Kelley Trucking Inc), Tim LaPointe (Environmental Landworks Co), Kate LaPointe (Environmental Landworks Co)

**From:** Jordan Salisbury (Environmental Landworks Co)

**Signature:** \_\_\_\_\_



*Submittal*

**Job:** 01-10-19013  
Trails at Crowfoot Park  
6594 N Crowfoot Valley Rd  
Parker, CO 80134

**Spec Section No:** Site Furnishing

**Submittal No:** 1

**Revision No:** 0

**Sent Date:** 1/9/2020

**Spec Section Title:**

**Submittal Title:** Park Site Furnishings and Accessories

**Contractor:**

Environmental Landworks Company

Contractor's Stamp

Kelley Trucking Inc  
Mike Snyder

Architect's Stamp

Engineer's Stamp



## Site Furnishings Product Submittals

**Project:** Trails at Crowfoot Park

**Contract Job #:** 19-013

**Submission #:** 2

**Date:** 1/9/2019

DESCRIPTION	MANUFACTURER	SUPPLIER
<b>PARK SECTION</b>		
RB-28 Bench (Black)	Victor Stanley Inc.	Downs & Associates
Pet Waste Station		
JJB010 Roll Bag Dispenser (Green)	Zero Waste USA	Zero Waste USA
SEN-10G The SENTRY Can (Green)	Zero Waste USA	Zero Waste USA
FRST-8 Picnic Table (Black)	Victor Stanley Inc.	Downs & Associates
LR355D, Diamond Pattern 55 Gal Trash Rec. (Black)	Wabash Valley	TBD
Freesia Bike Rack BFRE-161	Victor Stanley Inc.	Downs & Associates
1140-00 15"x20" Outdoor Grill	Patterson Williams Athletics	TBD
Disc Golf Target Mach 3	TBD	Disc Golf Association
440 SM Drinking Fountain (Green)	Most Dependable Fountains	Most Dependable Fountains

**NOTE: WORK WILL NOT BE PERFORMED WITHOUT APPROVAL**

Submittal Approval:

\_\_\_\_\_

Date:

\_\_\_\_\_





## **SECTION 02870 SITE FURNISHINGS**

### **PART 1 GENERAL**

**Model: RB-28**

#### **1.1 DESCRIPTION**

- A. Section includes information, materials, and options for products manufactured by Victor Stanley, Inc. All specifications are subject to change. Contact manufacturer for details.

#### **1.2 SUBMITTALS**

- A. Specifications Drawing: Detail drawing of product including overall dimensions and options.
- B. Samples: Various component samples available upon request.
- C. Qualifications: Installer must submit evidence of a successful installation history with comparable materials and designs specified.

#### **1.3 DELIVERY, STORAGE, and HANDLING**

- A. Delivery: Deliver products to site in manufacturer's original, unopened containers and packaging. Upon delivery, examine packages immediately to ensure all products are complete and undamaged.
- B. Storage: Store products in a protected, dry area in manufacturer's unopened containers and packaging.
- C. Handling: Protect product's finish from damage during handling and installation.

#### **1.4 COORDINATION**

- A. Coordinate with site work and other appropriate sections of the specifications to maintain proper provisions of the work specified.
- B. All site furnishings shall be laid out in the field and approved prior to installation.

### **PART 2 PRODUCTS**

#### **2.1 MANUFACTURER**

- A. Victor Stanley, Inc.  
P.O. Drawer 330  
Dunkirk, MD 20754 USA  
Toll Free: (800) 368-2573 (USA & Canada)  
Tel: (301) 855-8300 Fax: (410) 257-7579  
E-mail: [sales@victorstanley.com](mailto:sales@victorstanley.com)  
Web site: <http://www.victorstanley.com>

#### **2.2 BENCH**

- A. Type: RB-28 from the Steelsites™ RB Series



## 2.3 MATERIALS

- A. Scrolled steel slats are formed from 1/4" x 1-1/2" (6.35mm x 38.1mm) solid steel bars; steel slats are welded to cross members of 1-5/16" (33.34mm) tubular steel; 3/8" x 1" (9.53mm x 25.4mm) solid steel support bars; 1/2" x 2" (12.7mm x 50.8mm) solid steel end units

## 2.4 OPTIONS

- A. Standard lengths: 4ft (1.2 meters), 6ft (1.8 meters), and 8ft (2.4 meters) (custom lengths available)
- B. Armrest(s)
- C. Matching full center leg(s)
- D. Standard colors: VS Bronze, VS Black, VS Green, VS Tavern Square Green, VS Teal, VS Blue, VS Burgundy, VS Red, VS White, VS Gray (custom colors available, including the RAL range, at a small additional cost)

## 2.5 FINISHES

- A. All fabricated metal components are steel shotblasted, etched, phosphatized, preheated, and electrostatically powder-coated with TGIC polyester powder coatings. Products are fully cleaned and pretreated, preheated and coated while hot to fill crevices and build coating film. Coated parts are fully cured to coating manufacturer's specifications. The thickness of the resulting finish coat averages 8-10 mils (200-250 microns).
- B. In high salt abusive climates, hot dip galvanizing before powder coating is available. Hot dip galvanizing will provide greater protection in salty climates but yields a slightly less smooth coating finish. Most fabricated metal components and castings can be hot dip galvanized, lids cannot, please contact manufacturer for details.

## **PART 3 EXECUTION**

### 3.1 INSTALLATION

- A. Clearance for 1/2" (12.7mm) anchor bolts (anchor bolts provided by others).
- B. Mounting: It is not recommended to locate anchor bolts until bench is in place. This Victor Stanley, Inc. product must be permanently affixed to the ground. Consult your local codes for regulations.

### 3.2 PROTECTION

- A. Protect products prior to installation by having them remain in the manufacturer's packaging and container.

# The SENTRY® Can (SEN-10G)



## The SENTRY® Can:

- Rustproof, commercial grade aluminum
- Hinged, non-locking lid
- Ventilated mesh can
- Built-in can clamps securely hold can liner
- Mounting holes fit any standard U-Channel or Square Post
- Hardware to mount to post or pole

## The SENTRY® Can is made of commercial grade aluminum, rustproof, and field tested.

The SENTRY® Can is forged from commercial grade, heavy gauge, electrostatically powder coated, RUSTPROOF aluminum, with built-in bag-retention clamps.

The SENTRY® Can comes with a hinged, non-locking lid to keep out rain, pests and insects and to keep in any odors.

### \*\*IMPORTANT NOTICE\*\*

Don't buy another can made from Steel – it will rust-out in a year or less, especially in high moisture areas. The Sentry Can is worth every penny! Sprinkler systems, snow and rain will quickly soak and 'rust-out' steel cans from our competitors. Purchase the all-aluminum, rustproof SENTRY® Can.

Item #: SEN-10G, SENTRY® Can



## The SENTRY® Can Specs:

- Can Size: 13" W x 25" L
- Capacity: 10 gal
- Weight: 10 lbs



Black



Green

# Roll Bag Dispenser

(JJB010)



## Roll Bag Dispenser:

- 100% Aluminum, rustproof
- Locking dispenser comes with 2-matching keys
- Hardware to mount to a U-Channel or Square Post
- Holds 800 Roll Bags
- Dispenses 3-rolls of standard size bags
- Integrated easy to read large signage – screen-printed for long lasting durability

## Aluminum, rustproof, locking Roll Bag Dispenser holds 800 commercial grade, Standard-Size Roll Bags.

**These Roll Bags** are on a continuous, perforated roll of 200 bags – **Guaranteed** to fit any roll bag dispenser.

Our **Roll Bag Dispenser System** has three openings, which permits simultaneous dispensing of 600 bags. The inner shelf stores 1-backup roll for a total of 800 roll bags, reducing refill intervals.

The **Roll Bags** are black opaque, made so you can't see through!

**Item #: JJB010, Roll Bag Dispenser**

**All Aluminum Construction, Strong, Durable and Rustproof.** Manufactured to endure the hardest elements. Commercial grade aluminum is built to last – will not rust like metal dispensers and will not crack like polyresin or plastic dispensers. Mounts to: U-Channel Post, Square Post, Wall or Fence.

**4-BOX STORAGE = 800 BAGS; SIMULTANEOUSLY DISPENSES 3-ROLLS.**



## Roll Bag Dispenser Specs:

- Size: 15.5" H x 9.25" W x 4" D
- Maximum storage holds 4-boxes of 200 Bags
- Simultaneously dispenses 3-rolls = 600 bags
- Extra storage shelf holds 1-backup box of 200 bags – reducing refill intervals
- Weight: 4 lbs



Black



Green

**SECTION 129300 (02870)  
SITE FURNISHINGS**

**PART 1 GENERAL**

**Model: FRST-6**

**1.1 DESCRIPTION**

- A. Section includes information, materials, and options for products manufactured by Victor Stanley, Inc. All specifications are subject to change. Contact manufacturer for details.

**1.2 SUBMITTALS**

- A. Specifications Drawing: Detail drawing of product including overall dimensions and options.
- B. Samples: Various component samples available upon request.
- C. Qualifications: Installer must submit evidence of a successful installation history with comparable materials and designs specified.

**1.3 DELIVERY, STORAGE, and HANDLING**

- A. Delivery: Deliver products to site in manufacturer's original, unopened containers and packaging. Upon delivery, examine packages immediately to ensure all products are complete and undamaged.
- B. Storage: Store products in a protected, dry area in manufacturer's unopened containers and packaging.
- C. Handling: Protect product's finish from damage during handling and installation.

**1.4 COORDINATION**

- A. Coordinate with site work and other appropriate sections of the specifications to maintain proper provisions of the work specified.
- B. All site furnishings shall be laid out in the field and approved prior to installation.

**PART 2 PRODUCTS**

**2.1 MANUFACTURER**

- A. Victor Stanley, Inc.  
P.O. Drawer 330  
Dunkirk, MD 20754 USA  
Toll Free: (800) 368-2573 (USA & Canada)  
Tel: (301) 855-8300 Fax: (410) 257-7579  
E-mail: [sales@victorstanley.com](mailto:sales@victorstanley.com)  
Web site: <http://www.victorstanley.com>

## 2.2 ALL-STEEL TABLE

- A. Type: Model FRST-6 from the Steelsites™ Series

## 2.3 MATERIALS

- A. Scrolled steel slats are formed from 1/4" x 1-1/2" (6mm x 38mm) solid steel bars; steel slats are welded to cross members of 1-7/8" (48mm) diameter tubular steel; 2-3/8" (60mm) diameter tubular steel legs

## 2.4 OPTIONS

- A. Standard lengths: 6ft (1.8 meters) and 8ft (2.4 meters) (custom lengths available)
- B. Colors: Bronze, Black, Green, Tavern Square Green, Teal, Blue, Burgundy, Red, White, Gray. Available with Optional Metallics: Silver, and Titanium, (custom colors available, including the RAL range).
- C. Seating: FRB-6 all-steel backless benches; all standard FRB-6 lengths available
- D. Mounting: Standard in-ground and surface, available with ADA compliant leg positioning (ADA compliant table/bench combinations: 8' FRST-6 table with (2) 6' FRB-6 benches and 6' FRST-6 table with (2) 4' FRB-6 benches)

## 2.5 FINISHES

- A. All fabricated metal components are steel shotblasted, etched, phosphatized, preheated, and electrostatically powder-coated with TGIC polyester powder coatings. Products are fully cleaned and pretreated, preheated and coated while hot to fill crevices and build coating film. Coated parts are fully cured to coating manufacturer's specifications. The thickness of the resulting finish averages 8-10 mils (200-250 microns).
- B. In high salt abusive climates, hot-dip galvanizing before powder coating is available. Hot-dip galvanizing is performed for Victor Stanley, Inc. by an experienced qualified firm to which products are shipped for galvanizing. Hot-dip galvanizing includes an aggressive pre-treatment and immersion in a tank of charged liquid zinc at or around 860°F (460°C). The resulting surface is resistant to rust but has some unevenness resulting from the bonding of the zinc to the steel surface. As a result, the powder-coating surface finish over that galvanized surface may exhibit bumps, unevenness, and may not be as smooth as Victor Stanley, Inc.'s standard finish; this uneven and inconsistent finish is normal for hot-dip galvanizing. Most fabricated metal components and castings can be hot-dip galvanized, please contact manufacturer for details.

## **PART 3 EXECUTION**

### **3.1 INSTALLATION**

A. **Mounting: Standard in-ground:** It is not recommended to locate footing(s) until table is in place. This Victor Stanley, Inc. product must be permanently affixed in the ground. Consult your local codes for regulations.

**B. Standard surface:** It is not recommended to locate anchor bolts until table is in place. This Victor Stanley, Inc. product must be permanently affixed to the ground. Consult your local codes for regulations. Clearance for 1/2" (13mm) anchor bolts (anchor bolts not provided by Victor Stanley, Inc.).

### **3.2 PROTECTION**

A. Protect products prior to installation by having them remain in the manufacturer's packaging and container.



VICTOR  STANLEY™

*Create a timeless moment.™*

Product may be patented. Visit [VICTORSTANLEY.COM](http://VICTORSTANLEY.COM) for details.

*model no:*

FR400D, FR400P, FR400R,  
LR200D, LR200P, LR200R, LR200S,  
LR300D, LR300P, LR300R, LR300S,  
LR350D, **LR355D**, LR355P,



**WABASH VALLEY**

**TRASH RECEPTACLES/ACCESSORIES**

32 GAL. TAPERED, 22, 32 & 55 GAL. RECEPTACLES,  
32 GAL. FLARE RECEPTACLES

© Wabash Valley Manufacturing, Inc.

*customer service:*

ASSEMBLERS: If you find any parts missing or damaged, or if you're having difficulty assembling your furniture/equipment, call us at:

\* Before calling, have your product model number available.

1-800-253-8619 (Inside U.S.A.)  
260-352-2102 (Outside U.S.A.)  
Monday thru Friday,  
8:00 AM - 4:30 PM Eastern Time  
(EXCEPT HOLIDAYS)

Any correspondence concerning our product should be sent directly to our Customer Service Manager at:

Wabash Valley Manufacturing, Inc.  
505 E. Main Street  
P.O.Box 5  
Silver Lake, IN 46982 U.S.A.  
FAX: 260-352-2160

*maintenance:*

Regular inspection and maintenance of all parts, and fasteners is necessary. Tighten all bolts and nuts. Inspect Tops, Seats, Legs, Braces and Fasteners periodically for wear or vandalism. Replace broken or worn parts immediately or take equipment out of service until repairs are made. Use genuine Wabash Valley replacement parts.

To restore plastisol coating to its luster after prolonged use, wash/rinse/dry and use Armor-All ® or similar quality vinyl protectant.

KEEP THIS ASSEMBLY/SPECIFICATION SHEET FOR FUTURE REFERENCE.

*specifications:*

NOTE: We reserve the right to change specifications without notice.

Heat fused poly-vinyl coating, finished on inner-metal structure, to an approximate 3/16" thickness. Framework assemblies are finished with powder coating; electrostatically applied and oven cured according to powder manufacturer's specifications. Fasteners are stainless steel to resist corrosion.

**TRASH RECEPTACLES:**

Expanded metal receptacles uses 3/4" #9 expanded steel mesh with 5/16" diameter steel rod, joining the ends of the fabricated metals, to form the seam of their diameter. Rib panel is 10 gage and perforated panel is 12 gage sheet metal. A 3/4" diameter steel tube is used to add support at the top and bottom. Tubing on top of the flare tops are replaced with the aluminum cast flare. The bottom is also supported by a 12 gage sheet steel floor.

LR350D receptacle uses 3/4" #9 expanded steel mesh. A 5/16" rod is used to join the end of the fabricated metal to form the seam of its diameter. A 1/2" steel rod is used to add support at the bottom. A 3/4" steel tube is used to add support at the top. The bottom is supported by a 12 gage sheet steel floor.

The liners are constructed of #4 low density polyethylene plastic.

The clips, to support the flat top/dome, each sold separately, are constructed of 1/8" x 3/4" x 1" angle iron.

**LEG PACKAGES:**

Leg packages AU105N, LR100N and LR105N consist of 2 3/8" od x 12 gage structural steel tubing. All leg packages use 14 gage sheet steel for the mounting plate and gussets to add support. The surface mount leg uses 1/4" plate steel for its surface mount plate.

Specifications continued on page 3.

parts identification/product dimensions:

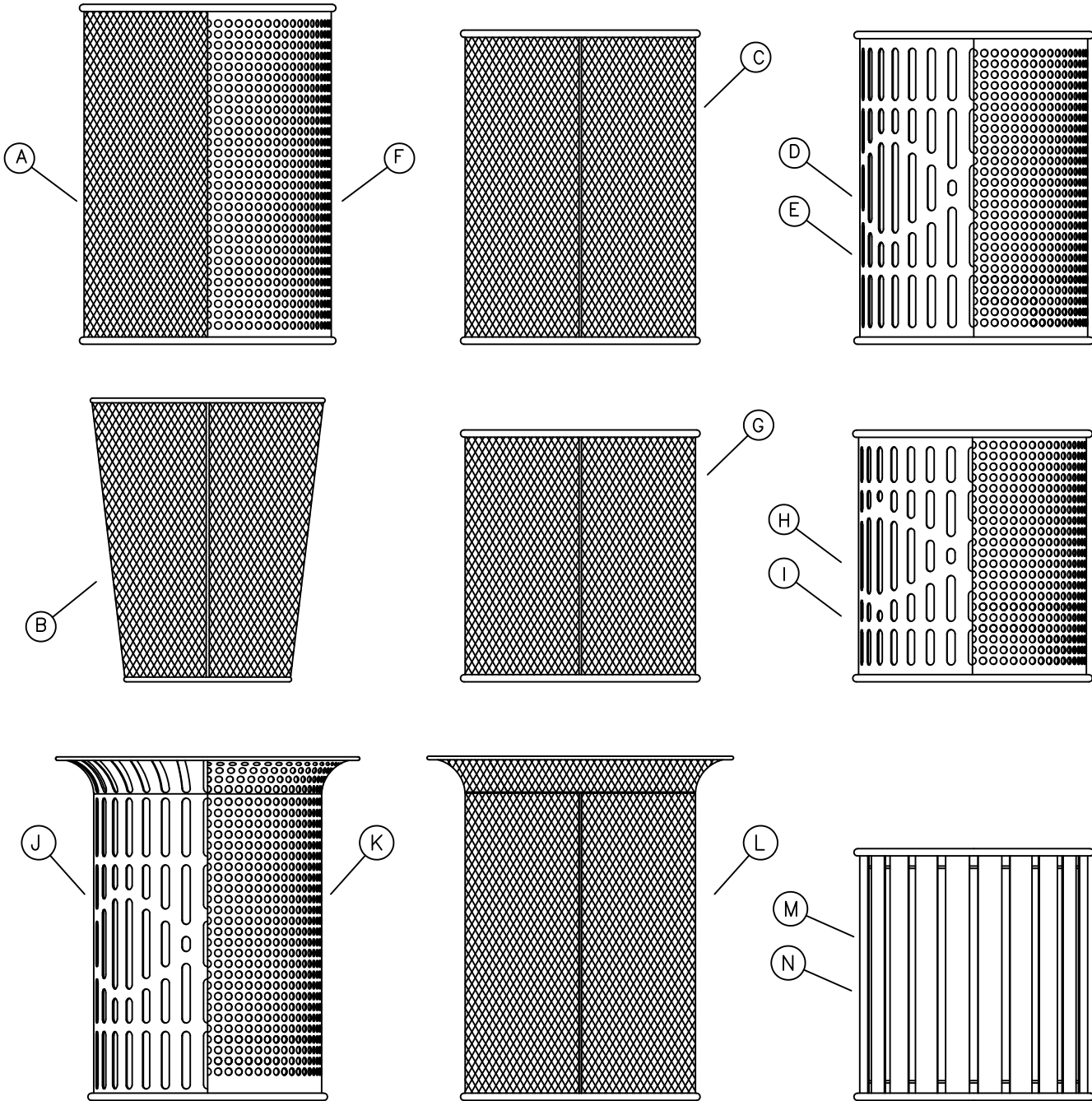

ITEM	PART#	DESCRIPTION
A	9589	55 GAL EXPANDED METAL RECEPTACLE
B	7903	32 GAL EXPANDED METAL TAPERED RECEPTACLE
C	9557	32 GAL EXPANDED METAL RECEPTACLE
D	9559	32 GAL RIB RECEPTACLE
E	9560	32 GAL PERFORATED RECEPTACLE
F	9588	55 GAL PERFORATED RECEPTACLE
G	9580	22 GAL EXPANDED METAL RECEPTACLE
H	9582	22 GAL RIB RECEPTACLE
I	9583	22 GAL PERFORATED RECEPTACLE
J	9563	32 GAL RIB FLARE RECEPTACLE
K	9564	32 GAL PERFORATED FLARE RECEPTACLE
L	9561	32 GAL EXPANDED METAL FLARE RECEPTACLE
M	9596	22 GAL SLAT RECEPTACLE
N	9598	32 GAL SLAT RECEPTACLE
N1	RPL32	32 GAL RECEPTACLE LINER
N2	RPL22	22 GAL RECEPTACLE LINER

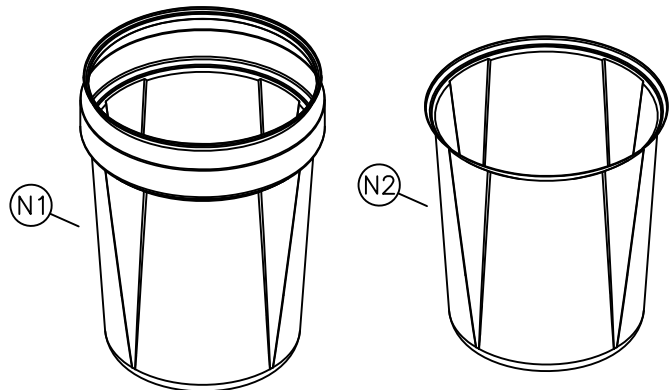

SOLD SEPARATELY

# parts identifaction/product dimensions continued:

## LIDS:

FT100N, FT105N, FT106N, FT110N, and FT115N consist of 18 gage steel. FT100N overall diameter is 22 7/8" and 1 3/4" length skirt with opening of 8" diameter. FT105N overall diameter is 22 7/8" and 1 3/4" length skirt with 8" diameter opening, an upward slant and overall height of 2 3/4". FT106N overall diameter of 22 7/8" and 1 3/4" length of skirt with opening of 5" diameter, an upward slant and overall height of 3". FT110N overall diameter is 22 7/8" and 1 3/4" length skirt with opening of 14" diameter. FT115N overall diameter is 24 7/8" and 1 7/8" length skirt with 14" diameter opening. FT200N overall diameter is 24 1/2" and 2" length skirt with 8" diameter opening.

FT106N is the Recycle Lid listed above with vinyl decal with 1 mil clear overlamine.

DT100N and DT200N consist of 3/16" thick injection molded structural thermo plastic. Dome is 10" high x 18" in diameter. Hole opening is 10" x 7 1/2" with spring loaded swing type door. DT100N base is 22 7/8" in diameter with a skirt length of 1 5/8". DT200N base is 24 5/8" in diameter with a skirt length of 2 5/8"

SB100N, and AB100N consist of FT100N top with solid bonnet or ash tray on it. TB100N consist of FT110N top with tray return made of 14 gage galvaneal. The shelf is 14" deep, 18" wide and is 8" above the flat top. Trim material is flexible embossed vinyl metal core. FT116N and FT117N consists of FT115N flat top with 18 gage solid or ash tray bonnet on it. The upright support brackets consists of 10 gage sheet steel.

AL100N is a cast aluminum ash and trash lid and is 22 7/8" od with a 2" length skirt.

## accessories:

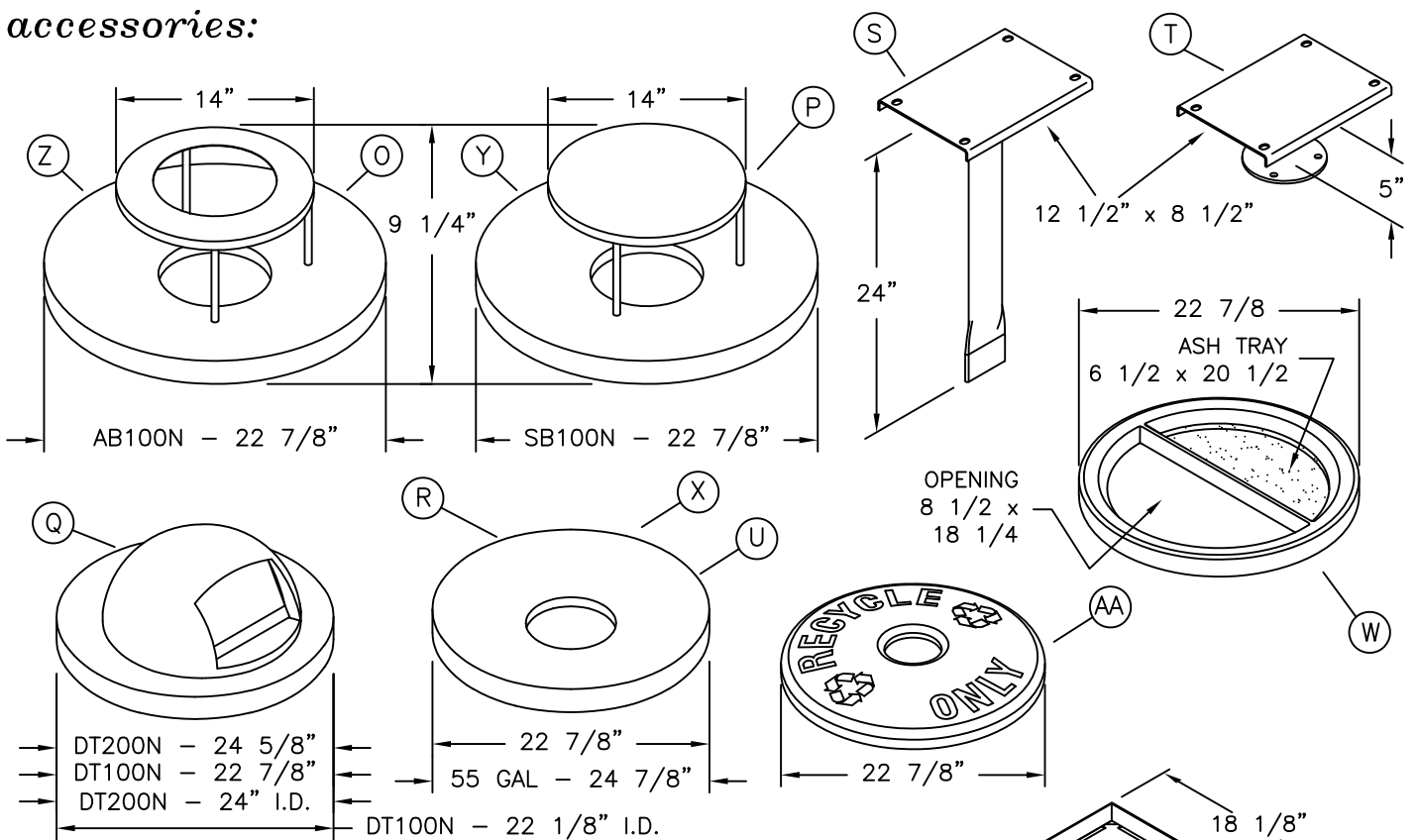

ITEM:	PART#	DESCRIPTION:
O	AB100N	OPEN BONNET WITH DOWNWARD SLANT
P	SB100N	SOLID BONNET WITH DOWNWARD SLANT
Q	DT100N, DT200N	DOME TOP LID
R	FT100N	8" OPENING FLAT TOP - DOWNWARD SLANT
S	LR100N	INGROUND POST
T	LR105N	SURFACE MOUNT POST
U	FT110N, FT115N	14" OPENING FLAT TOP - DOWNWARD SLANT
V	TB100N	TRAY RETURN FLAT TOP
W	AL100N	CAST ASH/TRASH LID
X	FT105N	8" OPENING FLAT TOP - UPWARD SLANT
Y	SB105N	SOLID BONNET WITH UPWARD SLANT
Z	AB105N	OPEN BONNET WITH UPWARD SLANT
AA	FT106N	5" OPENING RECYCLE FLAT TOP - UPWARD SLANT

Not Shown: Ash Tray Insert - Replacement part number: 19064

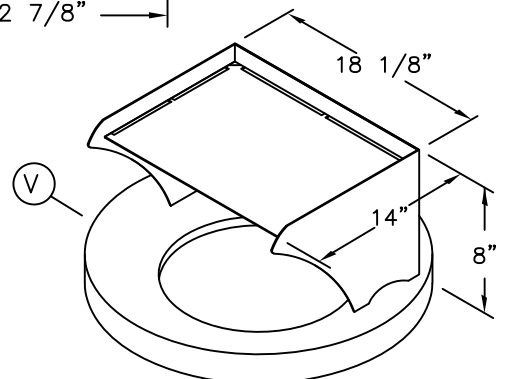

For installation of trim see page 4.

## assembly procedures:

**IMPORTANT:** Assemblers should be reasonably skilled in the assembly of commercial grade/heavy duty fabricated steel equipment.

To ensure proper assembly, it is suggested that you take adequate time to locate and identify each part. To prevent scratching of the finished pieces, we recommend this unit to be assembled on a clean, flat, solid, surface with a drop cloth, allowing plenty of working room. Also please read the instructions and study the sketches very carefully. A little extra time spent before assembly will be well worth it in performing a complete, proper assembly. Please note that all parts have been pre-cut and pre-drilled.

During the assembly process leave all bolts and nuts "finger tight", until the entire unit is completely assembled. This allows room for movement to level or adjust all seats, tops, benches, framework and braces if necessary. After final adjustment and leveling, permanently tighten all nuts, bolts and fasteners.

76

FIG. 1

STEP 1: Place inground post in concrete footer, making sure to keep post perpendicular to the ground, and allowing 5" of clearance between the ground and mounting plate.

STEP 2: After allowing concrete to harden, 48 hours, place the trash receptacle on the mounting plate. Align the holes in the trash receptacle base plate and the holes in the mounting plate of the inground post, see FIG. 1.

STEP 3: Bolt trash receptacle using four (GG) and (II) with two (HH) and one (QQ) per (GG).

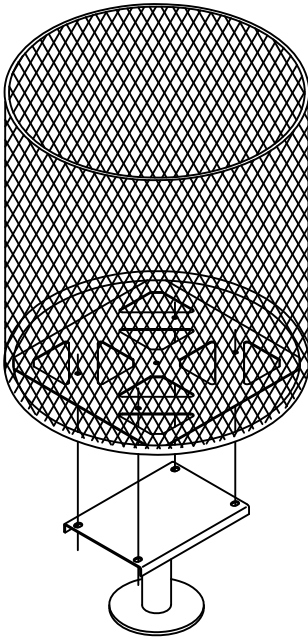

## TRIM INSTALLATION

STEP 1: Using rubber mallet and starting at one end, gently tap (JJ) in place on front edge of tray return shelf.

STEP 2: Using rubber mallet and starting at one end, gently tap (KK) onto front and top edge of vertical support of tray return.

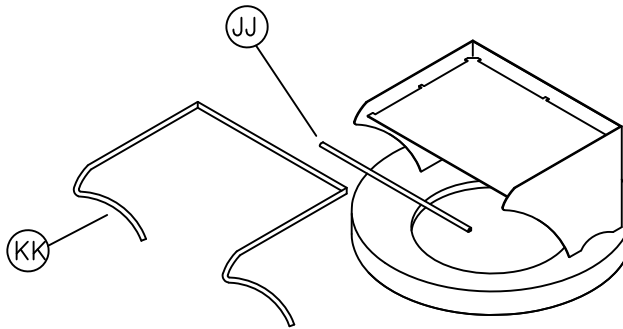

## installation:

**WARNING:** The proper installation for Wabash Valley products may depend upon many factors unique to the site, location, or use of a particular product. Consult with your contractor or other professional to determine your specific installation requirements.

## hardware identification:

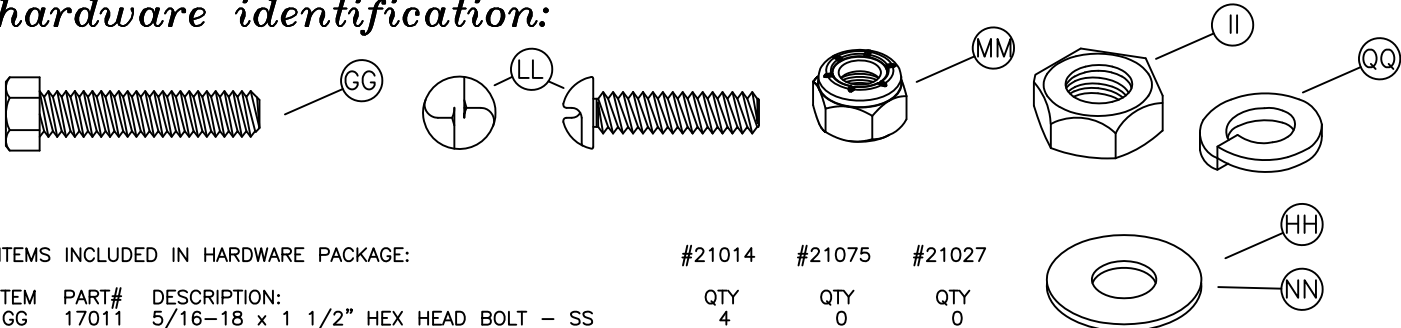

### ITEMS INCLUDED IN HARDWARE PACKAGE:

ITEM	PART#	DESCRIPTION:	#21014	#21075	#21027
GG	17011	5/16-18 x 1 1/2" HEX HEAD BOLT - SS	4	0	0
HH	17028	3/8" FLAT WASHER - SS	8	0	0
II	17032	5/16-18 HEX FINISH NUT - SS	4	0	0
JJ	19045	TRIM x 18" LONG	0	1	0
KK	19045	TRIM x 71 3/4" LONG	0	1	0
LL	17008	1/4-20 x 1 1/4" ONE WAY MACHINE SCREW - SS	0	2	2
MM	17016	1/4-20 NYLOC NUT - SS	0	2	2
NN	17103	1/4" FLAT WASHER - SS	0	4	4
PP	19067	12" WIRE ROPE ASSEMBLY	0	1	1
QQ	17050	5/16" SPLIT LOCK WASHER - SS	4	0	0

### ASSEMBLY TOOLS REQUIRED

- 1 - 3/8" WRENCH
- 1 - FLAT SCREWDRIVER
- 2 - 1/2" WRENCHES
- 1 - 3' OR 6' LEVEL
- 1 - RUBBER Mallet

*finished assembly dimensions:*

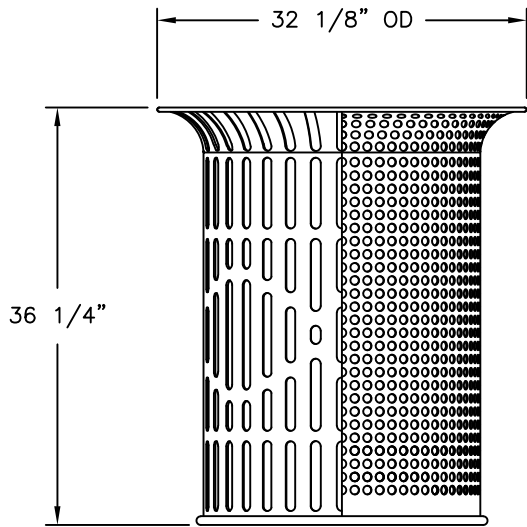

FLARE RECEPTACLE DIMENSIONS

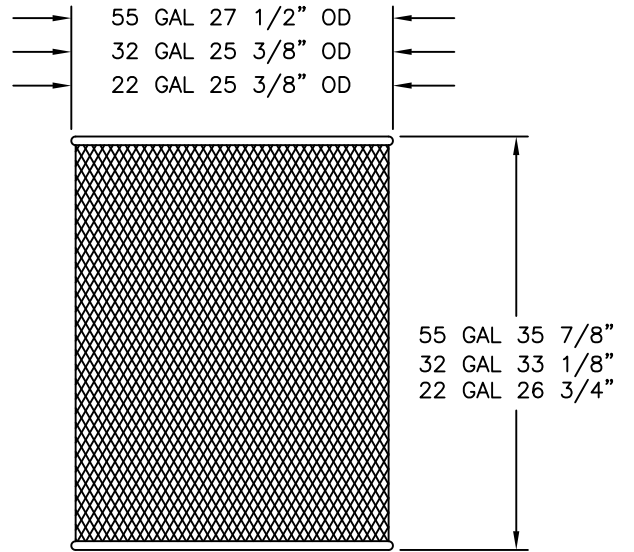

RECEPTACLE DIMENSIONS

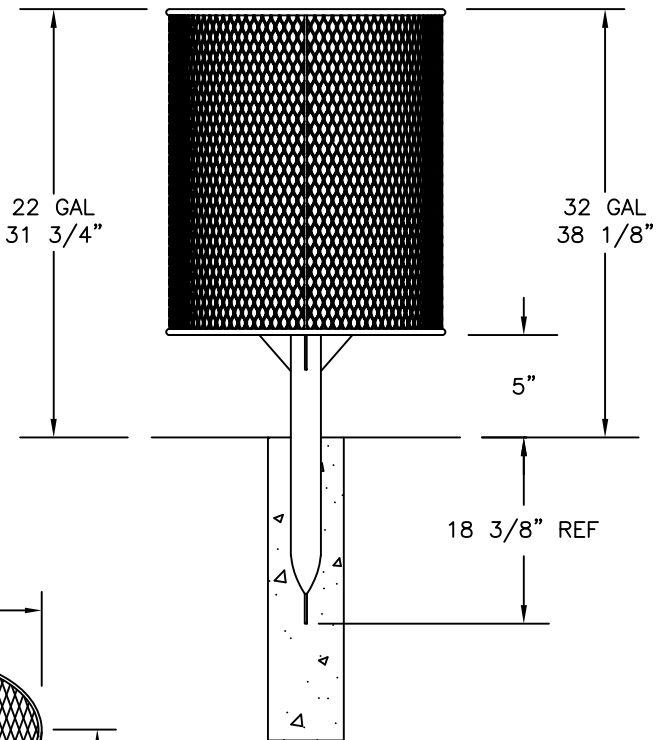
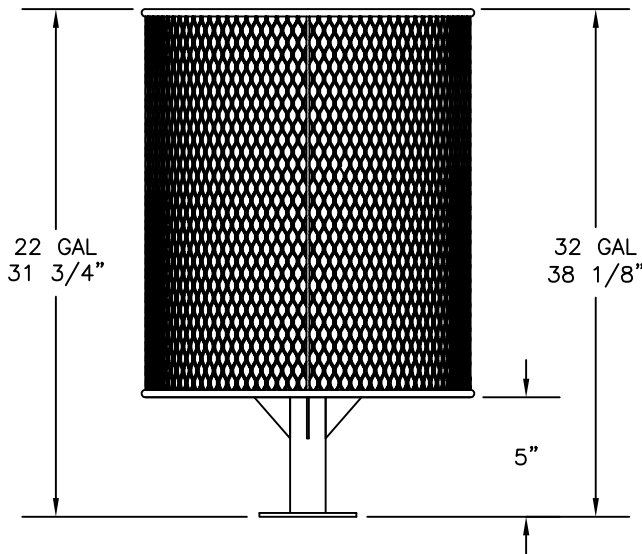

TAPERED RECEPTACLE DIMS

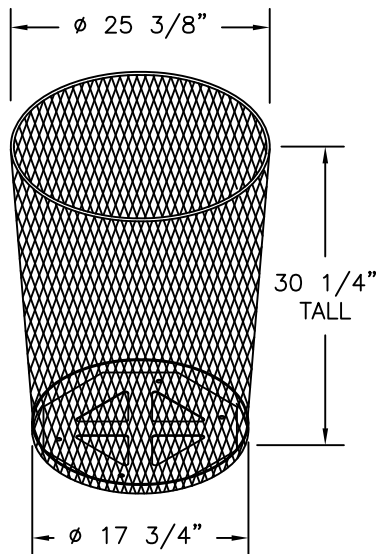

accessories/specifications cont'd:

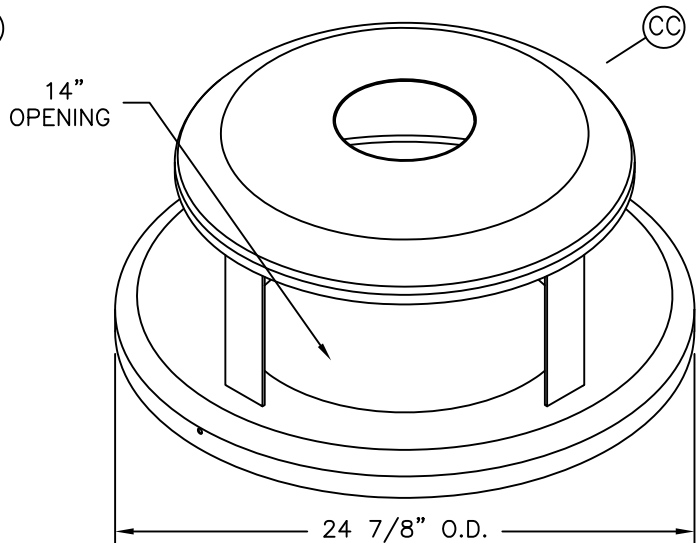
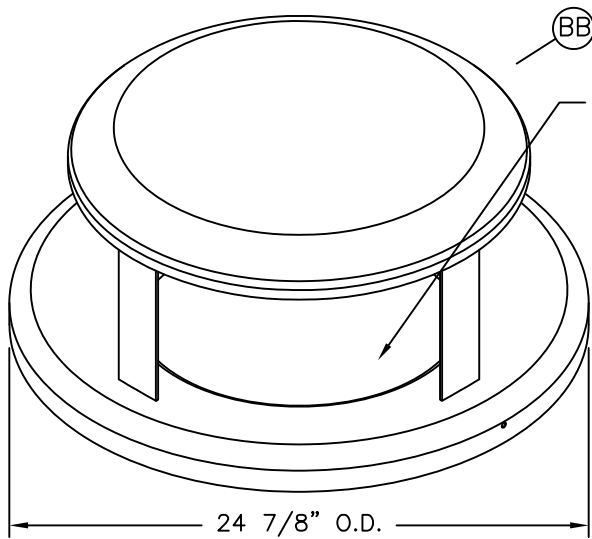

ITEM:	PART#	DESCRIPTION:
BB	FT116N	55 GAL SOLID BONNET WITH DOWNWARD SLANT
CC	FT117N	55 GAL OPEN BONNET WITH DOWNWARD SLANT

(LID SOLD SEPARATELY)

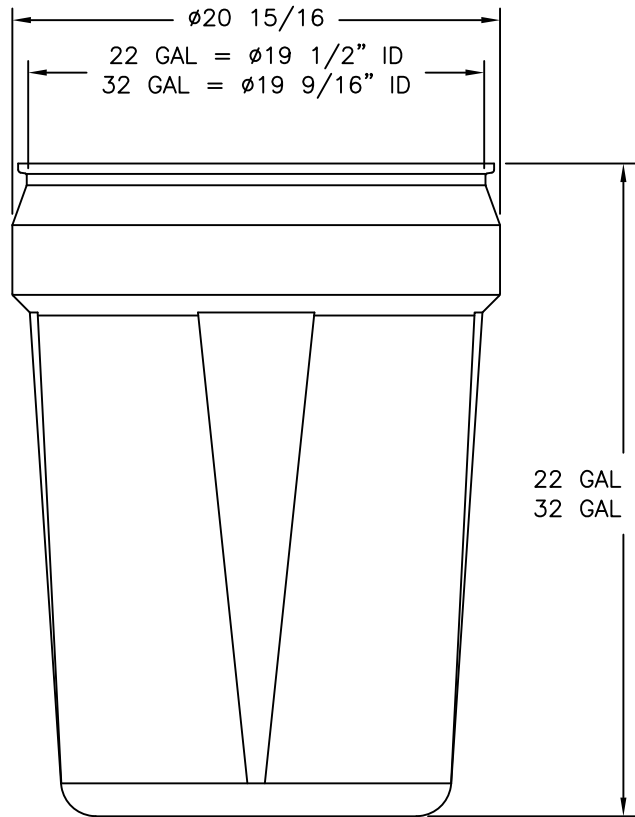
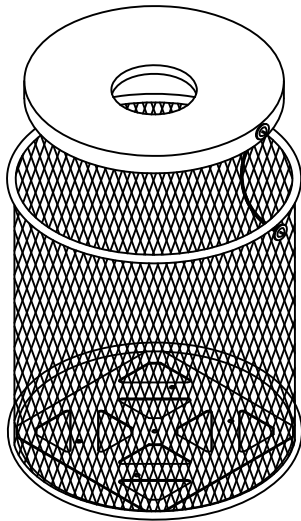

LID ASSEMBLY  
DETAILS

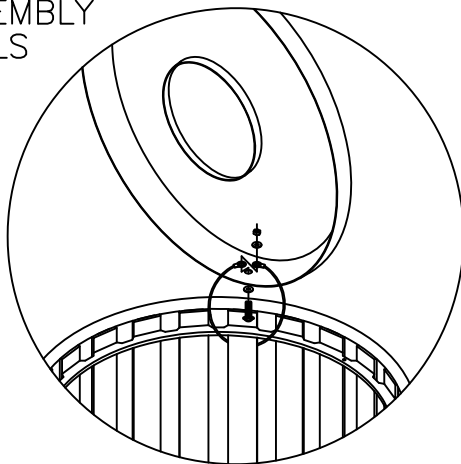

LINER DIMENSIONS



*Designed, engineered, and manufactured with the same attention to detail, quality, and durability that the design community has come to expect from Victor Stanley. The Perenne collection features clean lines, natural proportions, and slim profiles. The Freesia bench (patented) embodies elements in nature and classical settee furniture design while remaining open and functional. It's just one more way Victor Stanley helps you create the perfect setting for timeless moments.*

## FRESIA BENCH

4 or 6 ft (1.2 or 1.8 m) length.

Model FRE-20: with end armrests.\*

Model FRE-20NA: without armrests.\*

### OPTIONS

Horizontal steel slat seating. Wood slat seating. Surface mount.

In-ground mount. Intermediate armrests.

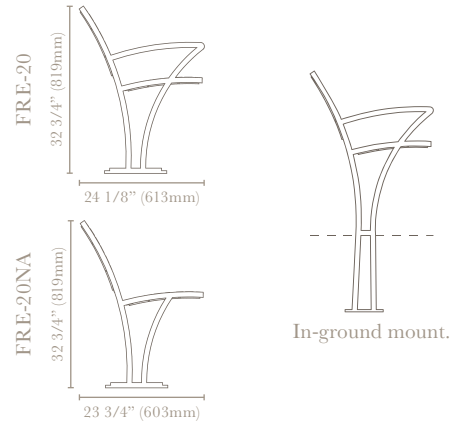

## FRESIA BACKLESS BENCH

4 or 6 ft (1.2 or 1.8 m) length.

Model FRE-23: with end armrests.\*

Model FRE-23NA: without armrests.

### OPTIONS

Horizontal steel slat seating. Wood slat seating. Surface mount.

In-ground mount. Intermediate armrests.

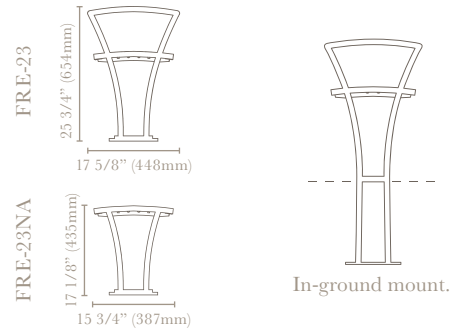

## FRESIA BIKE RACK

Frame constructed of 1 x 1 in (25.4 x 25.4 mm) solid steel.

Capacity: 2 bikes.

Model BFRE-101: single arch.\*

Model BFRE-161: single arch with cross bar.\*

### OPTIONS

Surface mount. In-ground mount.

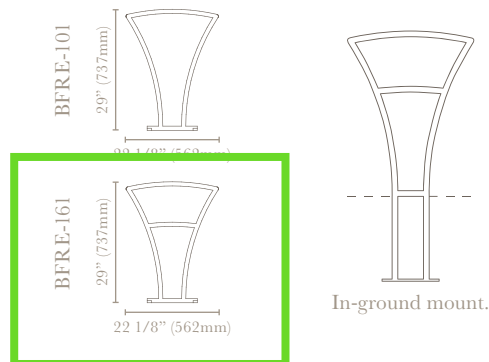

\*Covered by one or more of the following: US Patents D710,624 S; D710,626 S; D711,175 S; D711,176 S; D726,473 S; D726,474 S; D727,669 S; D722,921 S; D735,091 S. Canada Reg. Des. 152499; 153910; 153911.

*See product specifications for further details. Drawings are not to scale. Our TGIC powder-coating averages 8–10 mils (200–250 microns) thick and is applied in-house to ensure the highest level of quality. Offered in 12 standard and metallic colors, plus a full range of RAL colors with available color matching. Additional cost may apply.*



Wood slat seating.  
Patented.\*



Steel slat seating.  
Optional yellow green.  
Patented.\*



Wood slat seating.



In-ground mount.  
Patented.\*



Surface mount.  
Patented.\*



Steel slat seating.  
Patent pending.

# SITE FURNISHINGS

**MODEL #1140-00 - SINGLE GRILL (70 LBS)**

**MODEL #1140-05 - SINGLE GRILL (GALVANIZED) (70 LBS)**

**MODEL #8802-00 - OPTIONAL 7" X 20" SHELF (8 LBS)**

**MODEL #8803-00 - OPTIONAL GRILL COVER (30 LBS)**

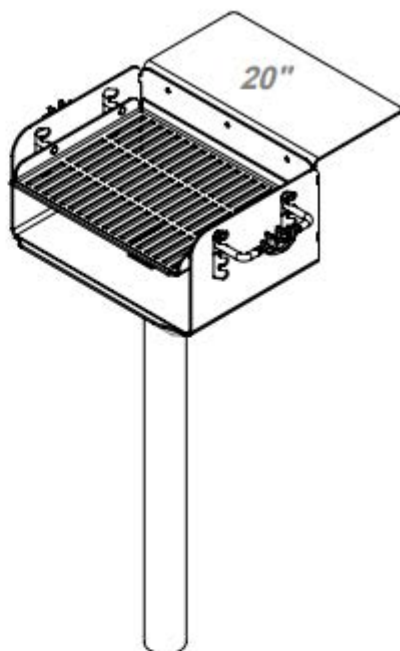
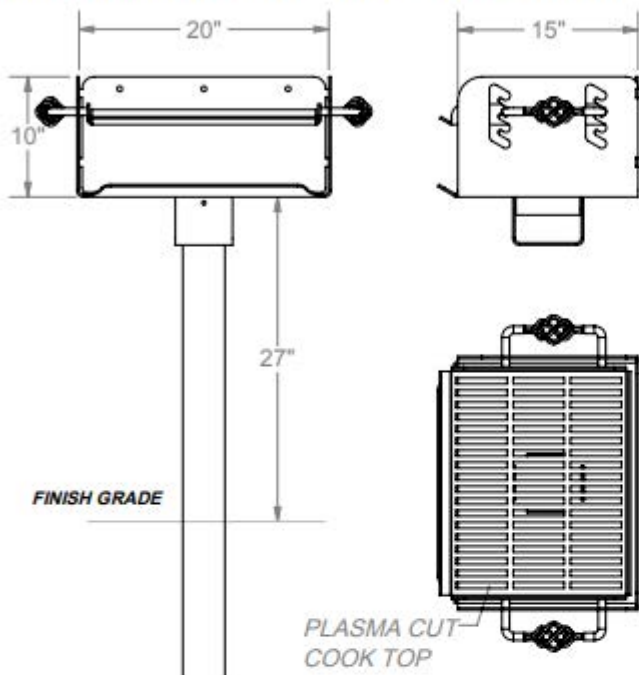

## SPECIFICATIONS:

With cool-grip handles, the grill can be rotated 360 degrees, and the cooking surface providing four different levels ranging from 3-1/2" to 8-3/4" above the fire.

**Firebox:** manufactured of 3/16" plate steel, reinforced with 3/16" back plate. Holes are provided on back of firebox for utility shelf installation. Painted with heat resistant, nontoxic black enamel. The single grill are supported by a 3-1/2" O.D. post.

**Grates:** manufactured 3/16" plasma cut plate in the shape of a cook top with welded 5/8" rod for handles; add a rolled flat bar heat sink handle welded to rods for suitable public use.

**Utility Shelves:** are steel plates that bolt to the side or rear of the grill with 5/16" x 3/4" hex bolts.  
Warranty: 3 years

**Patterson-Williams**

SITE FURNISHINGS

SCALE: N.T.S.	<b>SPECIFICATION / INSTALLATION INSTRUCTIONS</b>
DATE: 3/14/16	1140 SERIES GRILLS
DRAWN: MT	
REV: SS81717	<b>1140</b>
SHEET: 1 of 2	

# SITE FURNISHINGS

## INSTALLATION:

Dig hole per footing detail. Take the end of the post base that has 2 holes in it and place the opposite end into the center of the hole and shim from below. Plumb the post and pour concrete up to within 2" of finish grade for field install or to finish grade. Allow concrete to set for 3 days before removal of bracing and completion of installation. Cover footing with turf.

Install the grill on the post base. Line up the holes in the grill swivel mechanism with the holes in the post base. Insert the locking pin provided through the aligned holes leaving an equal length of pin protruding from each side of the swivel mechanism. Rotate the grill one complete turn the locking pin will be bent and drawn into the swivel mechanism to lock the grill onto the post base.

For single grill shelf, attach to back of the grill with three (3) 3/8" x 3/4" Carriage Bolts with the heads on the inside grill.

COMPONENT DESCRIPTION	QTY
1/8" X 6" LOCKING PIN	1
<b>OPTIONAL SHELF</b>	
7" X 20" SHELF	1
3/8" X 3/4" HEX BOLT	3
3/8" FLAT WASHERS	6
3/8" LOCK WASHERS	3
3/8" NUT	3

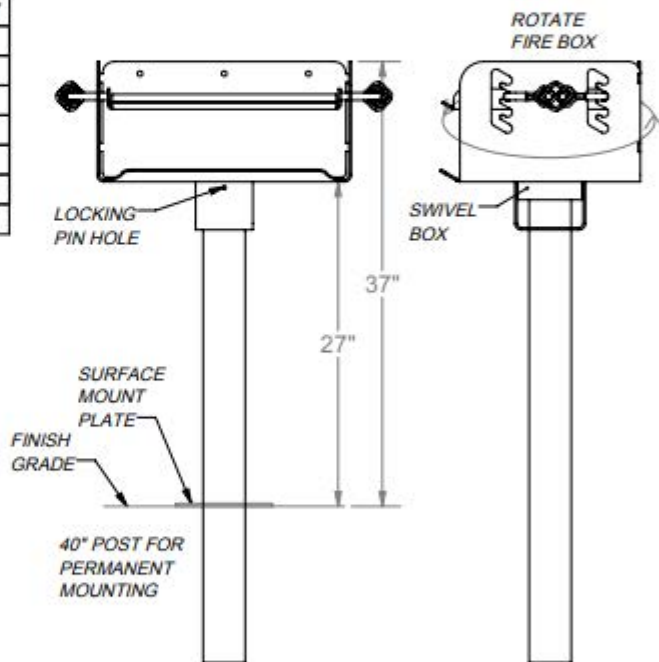
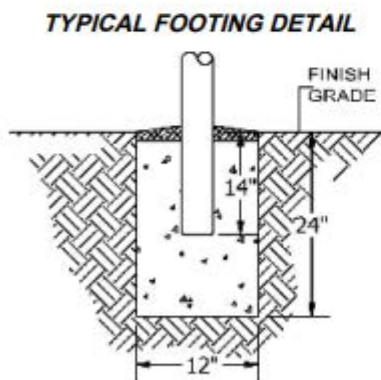

**Patterson-Williams**

SITE FURNISHINGS

SCALE: N.T.S.	<b>SPECIFICATION / INSTALLATION INSTRUCTIONS</b>
DATE: 3/14/16	1140 SERIES GRILLS
DRAWN: MT	
REV: SS81717	<b>1140</b>
SHEET: 2 of 2	

# DGA MACH III™ PERMANENT DISC GOLF BASKET SPECIFICATION SHEET

A True Legend. The Mach III disc golf basket has been played on in more disc golf tournament rounds than any other basket. This speaks to the quality and performance of this battle tested basket.

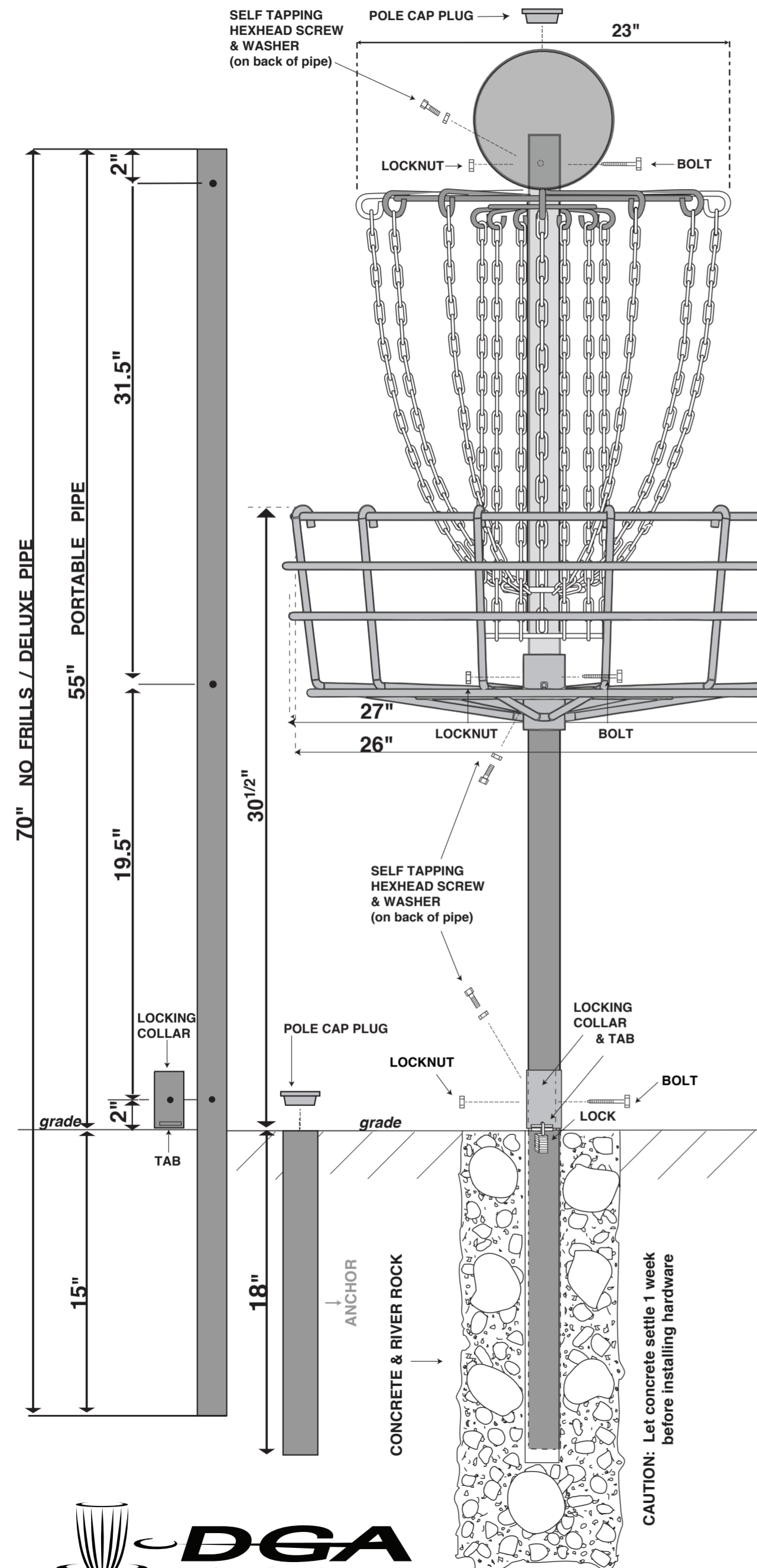

POLE (70 in.) - 1 1/2 in. I.D., 1 15/16 in. O.D. hot-dipped galvanized pipe, drilled.

POLES - The holes closest to one end of the pole are for the Chain Assembly. This end should also have a red Pole Cap Plug. The middle set of holes are for the Basket Assembly. The bottom set of holes are for the Locking Collar for Deluxe Disc Pole Hole.

CHAIN ASSEMBLY - Welded and hot dipped galvanized.

Number Plate - 10 gauge steel, 8 in. diameter. Decal - vinyl numbers and identification cover. Sleeve (6 in.) - 1 15/16 in. O.D. pipe, drilled. Bolt, hex head nut and nylon insert locknut, hex head tec screw, internal tooth star lock washer, (will not vibrate loose like one-way screws). Rod Assembly - 3/8 in. steel rod.

Chain - 12 outer/12 inner chains, 500 lb. test, all hooked to Chain Assembly with heavy duty "S" Hooks to allow freer movement of Chains.

CHAIN ASSEMBLY INSTRUCTIONS - Slide Chain Assembly, (ring first), down pole. Align holes in collar with holes at top of pole. Fasten with bolt, hex head nut and nylon insert locknut, hex head tec screw, internal tooth star lock washer, (will not vibrate loose like one-way screws).

TRAPPER BASKET 2 ASSEMBLY - 3/8 inch steel rod, welded and hot-dipped galvanized. 6" Sleeve - bolt, hex head nut and nylon insert locknut, hex head tec screw, internal tooth star lock washer, (will not vibrate loose like one-way screws).

TRAPPER BASKET 2 ASSEMBLY INSTRUCTIONS - Slide Basket Assembly down pole, (basket facing up), until holes in collar align with holes in middle of pole. Fasten with bolt, hex head nut and nylon insert locknut, hex head tec screw, internal tooth star lock washer, (will not vibrate loose like one-way screws).

\*DELUXE DISC POLE HOLE ONLY

LOCKING COLLAR - Welded and hot-dipped galvanized. 4" Collar- 2 1/8" Tubing. Bolt, hex head nut and nylon insert locknut, hex head tec screw, internal tooth star lock washer, (will not vibrate loose like one-way screws).

LOCKING COLLAR ASSEMBLY INSTRUCTIONS - Slide the locking collar, with the locking tab at the bottom of collar, up pole to bottom set of holes. Align holes in locking collar with holes in pole and fasten with bolt, hex head nut and nylon insert locknut, hex head tec screw, internal tooth star lock washer, (will not vibrate loose like one-way screws). After the locking collar is fastened, the pole can be placed in anchor to complete installation.

**\*Note: The LOCKING TAB should always be pointing at the tee.**

ANCHOR - 18 in. x 2 1/8 in. O.D. pipe, drilled. Install flush to ground with matching Locking Tab aiming at the tee.

CONCRETE & RIVER ROCK (Used to stabilize Anchor until cement sets) - Approximately 1 cubic foot (concrete, river rock and lock not furnished). CAUTION: Let concrete settle 1 week before installing hardware.





# ORIGINAL SERIES DRINKING FOUNTAIN SPECIFICATIONS

## WATER QUALITY (LEAD FREE)

Section 9, California Proposition 6 and the Federal Safe Drinking Water Act. One piece weld construction with MDF standard 3/16" wall thickness.

## ■ STANDARD PEDESTAL

OR

## ■ STAINLESS STEEL PEDESTAL

One piece weld construction with MDF standard 304 schedule 10 stainless steel.

## RECEPTOR BOWL

18 gauge electro-polished stainless steel bowl. Bowl overlaps pedestal, preventing build-up of residue in visual drinking area. Optional stainless steel Bowl Strainer recommended for areas with sand.

## BUBBLER HEAD

Stainless steel anti-squirt head (weighing a pound and a half) mounted with a lock nut and washer to prevent tampering. Lock nut pin holds bubbler in locked position to prevent twisting or turning. The MDF bubbler head has a unique design that features a steady stream trajectory and a built in natural shield from contamination.

## PUSH BAR

304 stainless steel with circumference exceeding 8.6". Mushroom style push bar overlaps and prevents sand and other objects from sticking push bar in the ON position. Stainless steel bubbler housing standard.

## CONTROL VALVE

Self closing valve requires less than 5 lbs to operate. Non-cartridge O-ring valve delivers steady stream of water through an adjustable valve. This valve design is to operate and function at 30 to 80 PSI. Ideal operating pressure is 60 PSI.

## WATER SUPPLY (LEAD FREE)

Maintenance free reinforced nylobraid tubing - **this tubing is not plastic**. It is supplied with a 1/2" MIP threaded inlet with stainless steel strainer. Union fittings at every connection. Supply line stops above grade.

## DRAIN

1 1/2" schedule 40 PVC pipe. Drain line stops above grade.

## FINISH

Oven baked powder coat. Choice of colors are:  green,  blue,  black,  brown,  red,  yellow,  orange, and  white. Textured color choices:  emerald,  sapphire,  pyrite,  text-black,  burgundy,  gold vein,  copper and  sandstone. Stainless steel models are powder coated for added protection. The color  chrome is available for stainless steel models only.

## ACCESS

Working parts accessible through bowl of fountain for easy service. Supply and waste connections are through the above grade access door. All access plates, brackets, vandal resistant bolts and screws are stainless steel.

## INSTALLATION

**Surface Mount** installation, is designed to be anchored on top of an existing surface (concrete, etc.) with anchor bolts through a mounting plate that is welded to the fountain. Surface Mount Fountains provide an access door with vandal resistant stainless steel screws. Surface mount carrier recommended for all surface mount installations. Access door standard on all pedestal fountains.

## WINTERIZATION

Shut off water and drain down.

## WARRANTY

One year warranty, labor not included.

## SHIPPING WEIGHT

Model 400 SM..... 115 lbs	Model 400 SMSS..... 115 lbs	*Meets ADA for High and Low
Model 410 SM..... 110 lbs	Model 410 SMSS..... 110 lbs	
<b>Model 440 SM*..... 130 lbs</b>	Model 440 SMSS*.... 130 lbs	
Model 493 SMSS*.. 170 lbs	Model 493 SMSS*.... 170 lbs	

**MOST DEPENDABLE FOUNTAINS, INC.™**  
 (800) 552-6331 • (901) 867-0039 • Fax (901) 867-4008  
 5705 COMMANDER DR. • ARLINGTON, TN 38002-0587  
 www.mostdependable.com

