

### PROJECT INFORMATION

**1.0 GENERAL INFORMATION**

A. UDFCD DRAINAGEWAY MEP ID # XXXX  
 B. PROPERTY OWNER TOWN OF PARKER  
 303-739-7000  
 C. DESIGN ENGINEER CVL CONSULTANTS  
 720-482-9526

**1.1 GENERAL INFORMATION**

A. ONLINE OR OFFLINE FACILITY OFFLINE  
 B. FLOW RATES

EVENT	INFLOW	OUTFLOW
10 YEAR	143 CFS	43 CFS
100 YEAR	279 CFS	197 CFS

C. POND DESCRIPTION

OUTLET	VOLUME	10 YR WSE	100 YR WSE
POND	11.3 AC-FT	5595.39 FT	5997.19 FT
ORIFICE	6.1 AC-FT	5595.39 FT	
WEIR	11.3 AC-FT	5997.19 FT	

D. OUTLET TYPE  
 REGIONAL POND WITH THREE ORIFICES FOR LOW FLOW AND A SEPARATE OVERFLOW WEIR

**1.2 MISCELLANEOUS INFORMATION**

A. PROJECT SURVEY INFORMATION  
 PLANIMETRIC SURVEY AND TOPOGRAPHY WAS PREPARED BY CVL CONSULTANTS.  
 SURVEY CONTROL POINT: DOUGLAS COUNTY CONTROL POINT KNOWN AS 1.060032, BEING A 3-1/4" ALUMINUM CAP, BEING LOCATED IN THE SOUTHWEST QUARTER OF SECTION 33, TOWNSHIP 6 SOUTH, RANGE 66 WEST OF THE SIXTH PRINCIPAL MERIDIAN, HAVING A PUBLISHED ELEVATION OF 1799.2870 METERS (5903.13 FEET) NAVD '88 DATUM.

B. SEED MIXES

UPLAND SEED			WETLAND SEED		
COMMON NAME, VARIETY	BOTANICAL NAME	% OF TOTAL	COMMON NAME, VARIETY	BOTANICAL NAME	% OF TOTAL
JUNEGRASS	KOELERIA MACHRANTHA	2	HARDSTEM BULRUSH	SCRIPUS ACUTUS	20
LITTLE BLUESTEM, PASTURA	SCHIZACHYRIUM SCOPARIUM	10	PRAIRIE CORDGRASS	SPARTINA PECTINATA	4
BLUE GRAMA, LOVINGTON	BOUTELOUA GRACILLIS	7	BLUE GRAMA, LOVINGTON	BOUTELOUA GRACILLIS	5
SAND DROPSSEED	SPOROBOLUS CRYPTANDRUS	1	SAND DROPSSEED	SPOROBOLUS CRYPTANDRUS	4
SIDE OATS GRAMA	BOUTELOUA CURTIPENDULA	20	BALTIC SPIKERUSH	JUNCUS BALTICUS	4
WESTERN WHEATGRASS, ARRIBA	PASCOPYRUM SMITHII	60	PASCOPYRUM SMITHII	PASCOPYRUM SMITHII	29
			WESTERN WHEATGRASS, ARRIBA	CAREX LANUGINOSA	1
			WOOLY SEDGE	CAREX NEBRASCENSIS	1
			NEBRASKA SEDGE	PANICUM VIRGATUM	26
			SWITCHGRASS	DISTICHIS STRICTA	5
			INDIAN SALTGRASS	ELEOCHARIS PALUSTRIS	1
			CREeping SPIKERUSH		

C. MOW AREA: 3.7 AC  
 THE MOW AREA IS GENERALLY DESCRIBED AS THE INTERIOR SIDES AND BOTTOM OF THE ENTIRE POND UP TO THE ELEVATION OF 5599. GRASSES SHOULD BE MAINTAINED AT THE HEIGHT OF 4 TO 6 INCHES.

# TRAILS AT CROWFOOT REGIONAL DETENTION POND A MAINTENANCE SITE PLAN

APRIL 2018 (PROJECT COMPLETED XXXX)

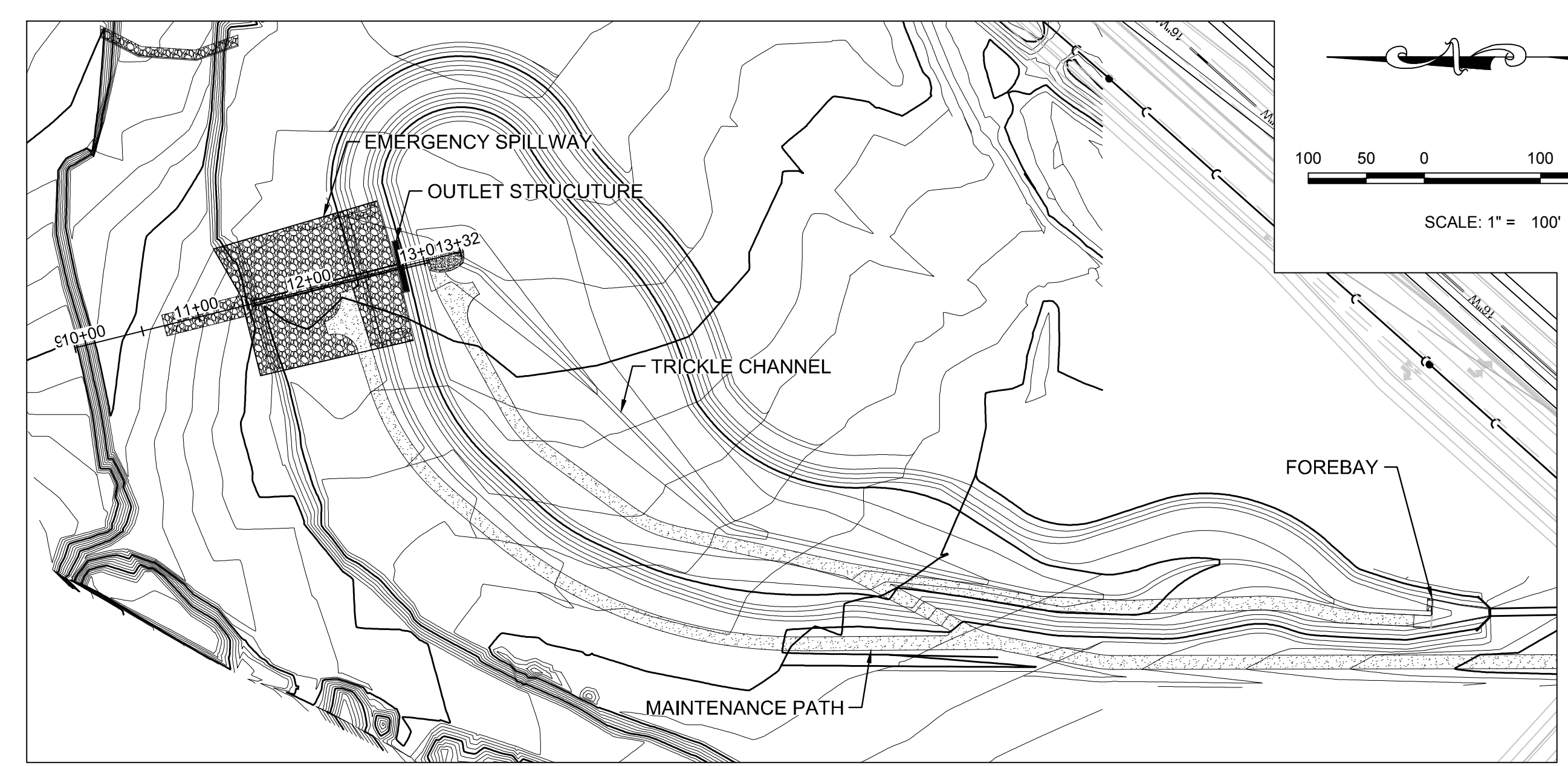

**PLAN VIEW**  
 SCALE: 1" = 100'

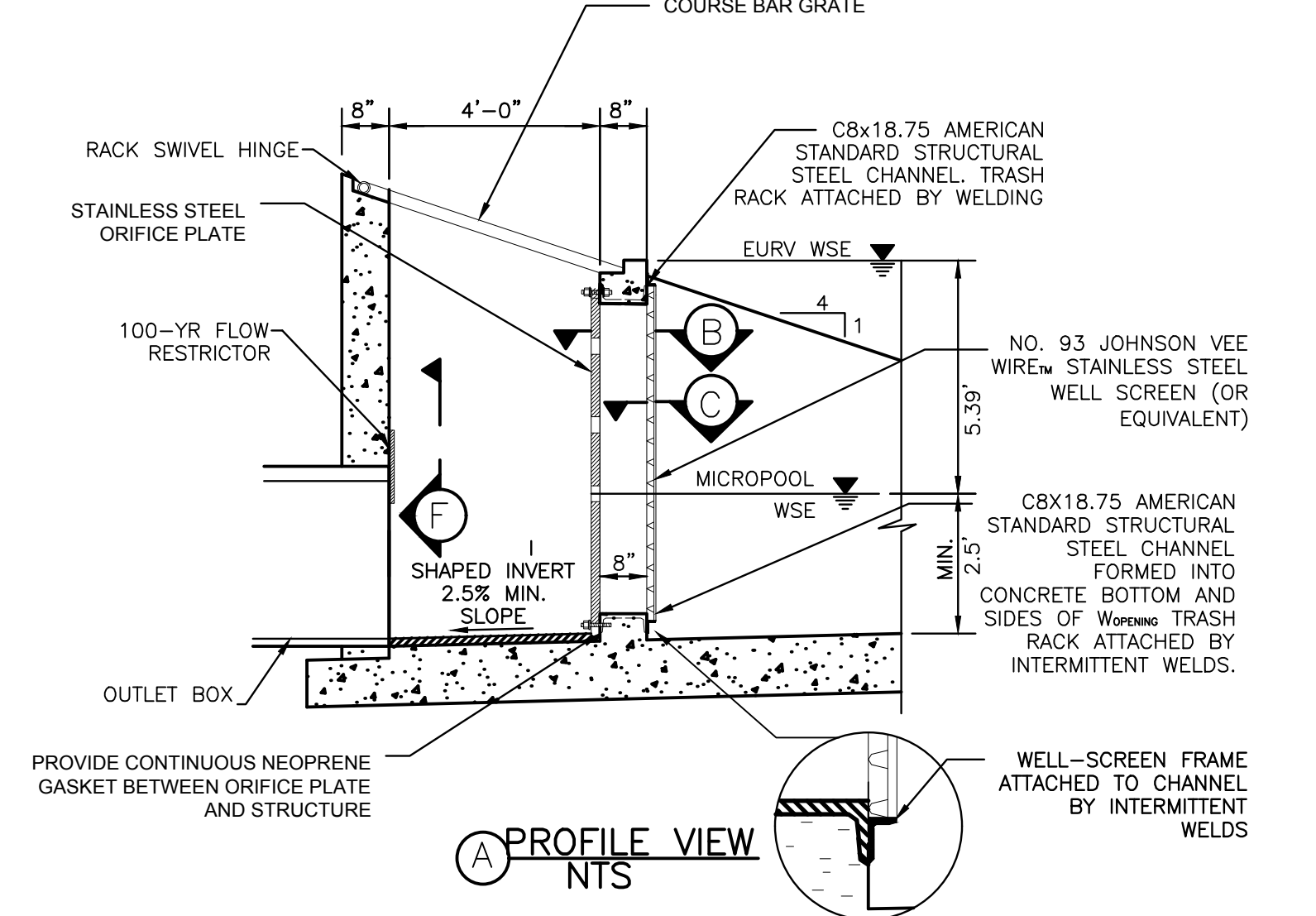
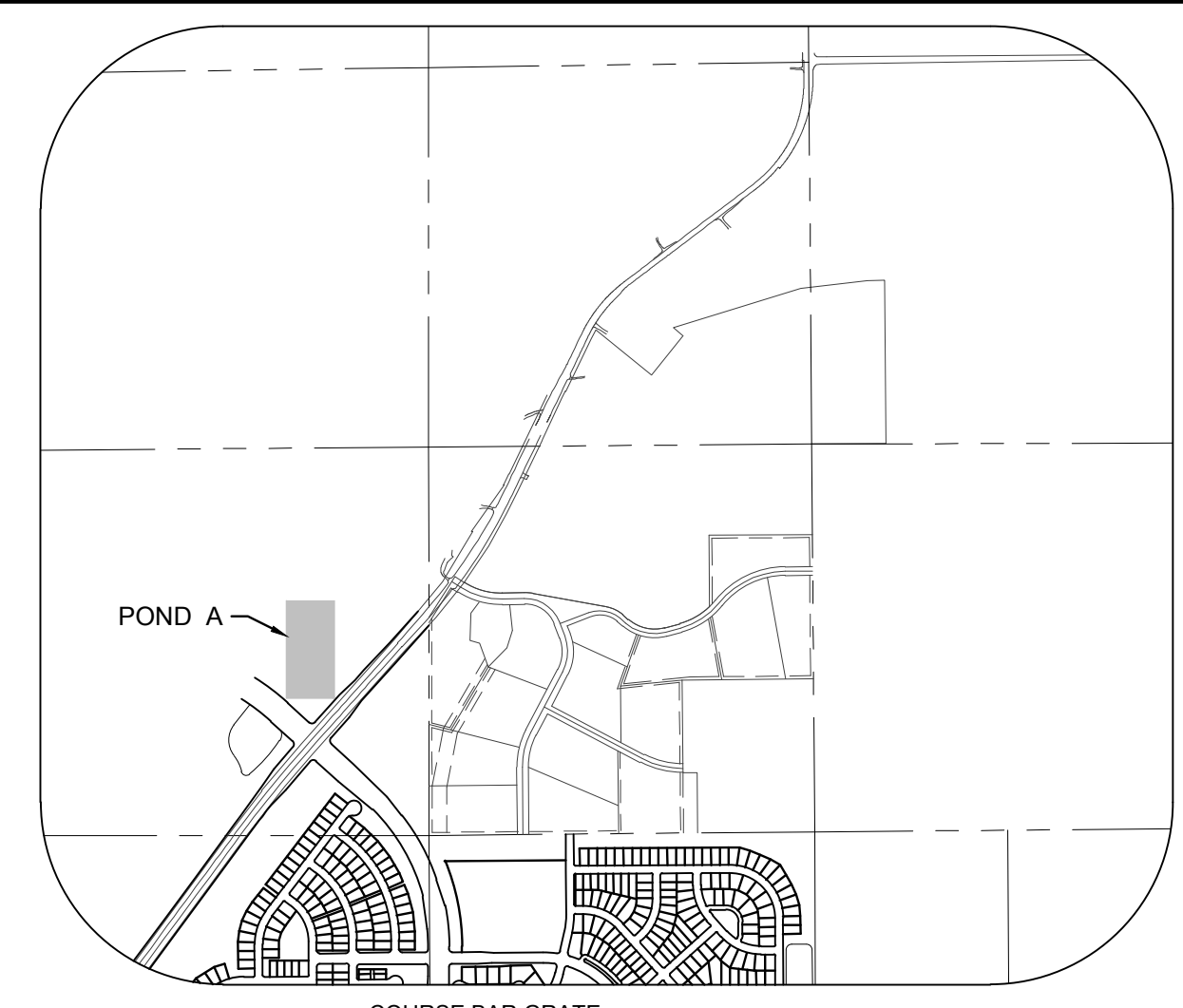

**PROFILE VIEW A-A**  
 NTS

### PROJECT NOTES

**2.0 GENERAL FACILITY DESCRIPTION**

THE FACILITY IS A DETENTION POND BUILT UPSTREAM OF LEMON GULCH. THE WATER ENTERS THE POND VIA A FOREBAY AND DISCHARGES THROUGH OUTLET STRUCTURE. THE POND IS PROVIDED WITH AN ORIFICE FOR LOW AND WEIR IN CASE OF MAJOR EVENTS.

**2.1 MAINTENANCE NOTES**

A. MAINTENANCE FREQUENCY

ROUTINE MAINTENANCE TASKS, INCLUDING MOWING AND DEBRIS REMOVAL SHOULD BE PERFORMED ON AN AS-NEEDED BASIS. DEBRIS REMOVAL AND SWEEPING SHOULD BE DONE PRIOR TO THE SUMMER STORM SEASON AND FOLLOWING SIGNIFICANT RAINFALL EVENTS. IN ADDITION, THE PROPERTY OWNER SHOULD PERFORM A SITE INSPECTION ON AN ANNUAL BASIS TO EVALUATE THE NEED FOR ADDITIONAL MAINTENANCE, INCLUDING SEDIMENT REMOVAL, EROSION CONTROL, REVEGETATION AND STRUCTURAL REPAIRS. IF ADDITIONAL MAINTENANCE IS REQUIRED, THE PROPERTY OWNER MAY REQUEST ASSISTANCE FROM UDFCD.

B. EQUIPMENTS AND SPECIAL TOOLS REQUIRED

SUBMERSIBLE PUMP/ GENERATOR  
 LONG-REACH RAKE OR BROOM  
 SKID STEER  
 LONG-REACH TRACK EXCAVATOR  
 TANDEM DUMP TRUCKS

**2.2 MAINTENANCE PROCEDURE**

A. DEWATERING  
 THIS POND HAS NO NATURAL BASEFLOW BUT WILL RECEIVE STORM AND IRRIGATION RUNOFF ON A FREQUENT BASIS.

B. SEDIMENT REMOVAL  
 SEDIMENT MUST BE REMOVED FROM FOREBAY WHEN THEY HAVE REACHED 3/4 CAPACITY. HAND REMOVAL MAY BE NECESSARY IN POND AND FOREBAY. POND IS ACCESSED FROM A MAINTENANCE PATH. LONG REACH EXCAVATOR AND BACKHOE MAY BE USED FOR CLEANING AS NECESSARY.

C. DEBRIS REMOVAL  
 DEBRIS BUILDUP IS EXPECTED AT THE OUTLET STRUCTURE, THE GRATES OF OUTLET STRUCTURE AND FOREBAY. ALL DEBRIS SHOULD BE COLLECTED AND DISPOSED OFFSITE. A LONG-REACH BROOM OR RAKE WILL BE NECESSARY TO CLEAN THE SCREEN.

D. SITE INSPECTION  
 THE FOLLOWING ITEMS SHOULD BE INSPECTED A MINIMUM OF ONCE PER YEAR AND MAINTAINED AS NECESSARY:

**GENERAL**

- ACCESS DRIVES
- EROSION
- VEGETATION
- NATIVE WETLANDS AND UPLAND GRASSES
- WILLOWS AND OTHER RIPARIAN PLANTS AROUND EDGE OF POND
- COTTONWOOD TREES IN MIDDLE ELEVATIONS
- PONDEROSA IN UPPER AREAS.

**EQUIPMENT AND STRUCTURES**

**CONCRETE FOREBAY**

STAGE (FT)	STORAGE (ACRE-FT)	DISCHARGE (CFS)
0	0.0	0.0
1	0.0	0.3
2	0.5	0.7
3	1.7	1.0
4	3.5	1.3
5	5.6	1.6
6	8.0	38.1
7	10.7	166.6
8	13.8	212.7
9	17.2	583.9

**100-YR OUTLET STRUCTURE**

- CONCRETE ENTRANCE STRUCTURE
- TRASH RACK
- ORIFICE PIPE
- ORIFICE PLATE

**100-YR OUTLET STRUCTURE**

- CONCRETE STRUCTURE
- TRASH RACK
- HAND RAIL
- OVERFLOW CHANNEL

C. POST-MAINTENANCE CONSIDERATIONS  
 FOLLOWING COMPLETION OF MAINTENANCE ACTIVITIES, ALL DEBRIS, TRASH AND EXCAVATED SEDIMENT MUST BE REMOVED OFFSITE. IF NECESSARY, ADJACENT STREETS MUST BE SWEEPED CLEAN.

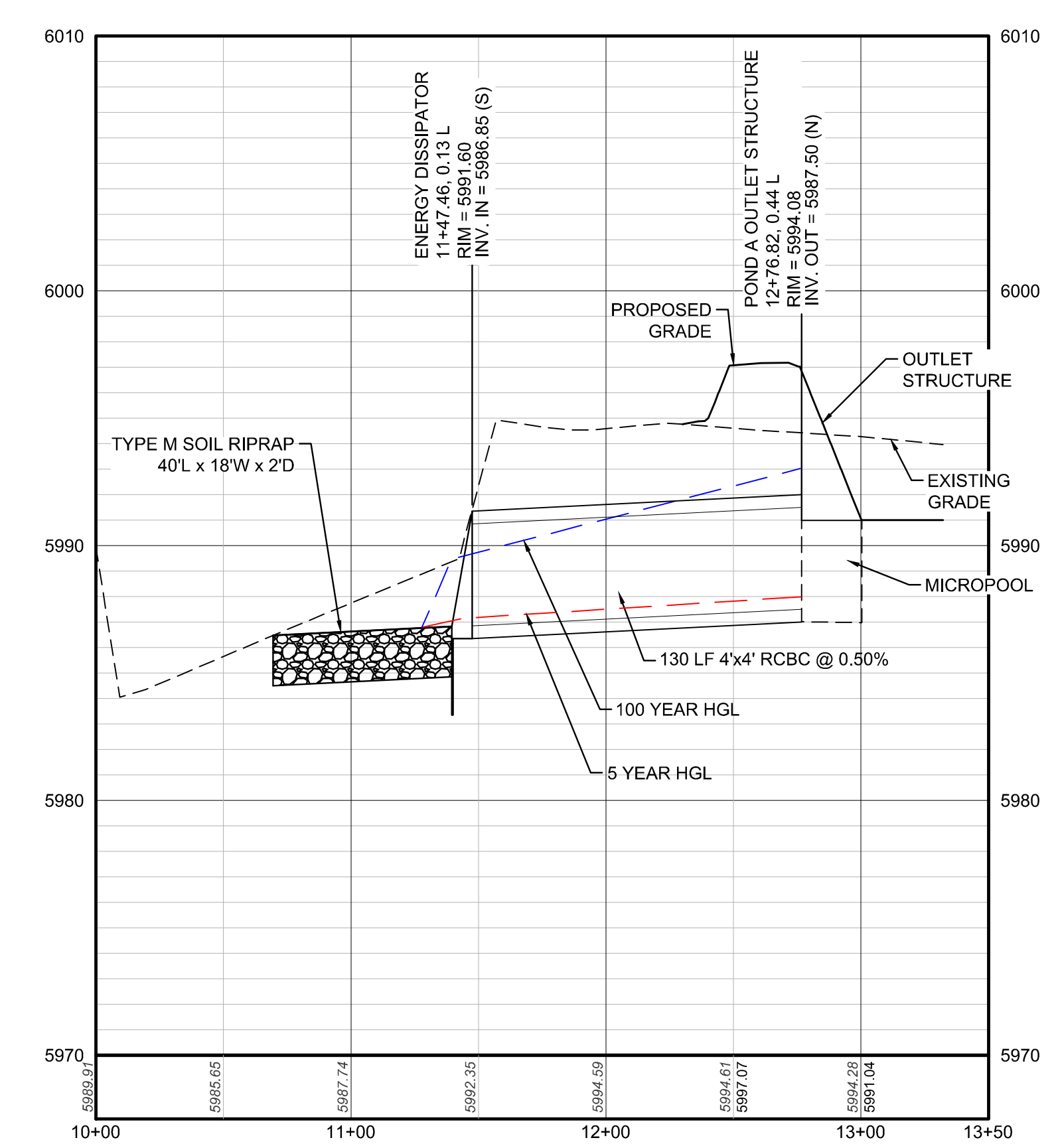

**PROFILE: POND A OUTFALL STA: 10+00.00 TO 13+50.00**  
 HORIZONTAL: 1" = 100'  
 VERTICAL: 1" = 10'

**HYDRAULIC PROFILE**  
 SCALE: 1" = 50'

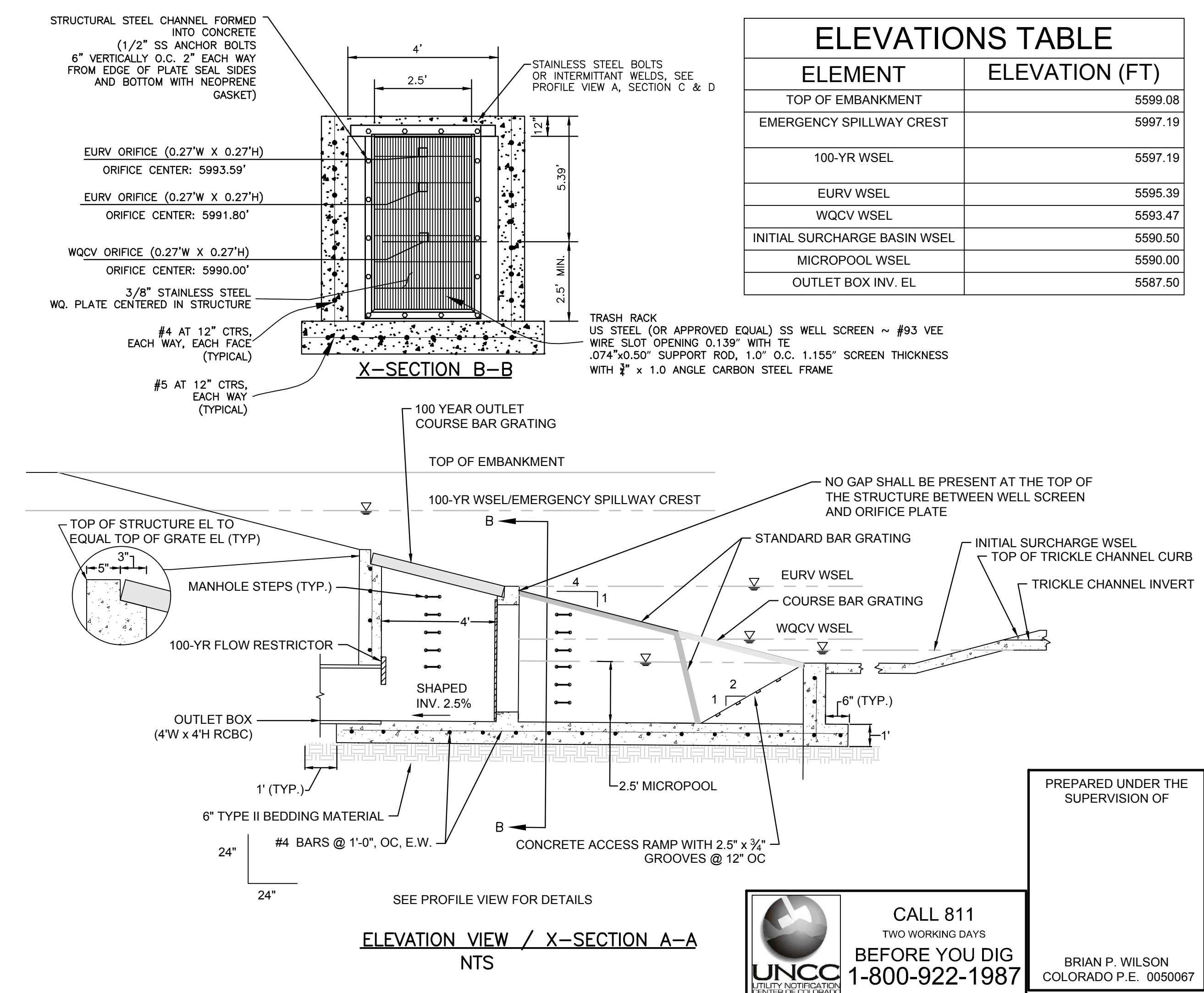

**ELEVATION VIEW / X-SECTION A-A**  
 NTS

### ELEVATIONS TABLE

ELEMENT	ELEVATION (FT)
TOP OF EMBANKMENT	5599.08
EMERGENCY SPILLWAY CREST	5997.19
100-YR WSEL	5597.19
EURV WSEL	5595.39
WQCV WSEL	5593.47
INITIAL SURCHARGE BASIN WSEL	5590.50
MICROPOL WSEL	5590.00
OUTLET BOX INV. EL.	5587.50

No.	Date	Init.	Appr.	Date
Revisions				
<b>HR 935 LLC</b> 7363 South Alton Way CENTENNIAL, CO 80112				
<b>TRAILS AT CROWFOOT</b> <b>FILING # CONSTRUCTION DRAWINGS</b> MAINTENANCE SITE PLAN				
SCALE:	DRAWN BY:	CHECKED BY:	FILE NO.:	DATE:
AS SHOWN	HW	JU	8130283701	MARCH 2018
PREPARED UNDER THE SUPERVISION OF 				
CALL 811 TWO WORKING DAYS <b>BEFORE YOU DIG</b> 1-800-922-1987				
BRIAN P. WILSON COLORADO P.E. 0050067				

N:\PROJECTS\SSR\DRAINAGE\ENGINEERING\DRAINAGE\MAINTENANCE SITE PLAN\MAINTENANCE SITE PLAN ADWG\_KYLEM\_4/20/18.rvt