

N:\PROJECTS\BIRCHWOODS\ENGINEERING\DRAINAGE\STUDIES\DRAINAGE MAPS\OVERALL DRAINAGE STUDIES\DRAINAGE MAP.DWG, ASPUNOK, 11/20/2016 2:38 PM



DESIGN POINT SUMMARY		
Design Point	Q2	Q100
ID	(CFS)	(CFS)
1A	6.07	23.37
1K	12.80	49.37
1B	17.67	65.86
1C	21.14	79.26
1M	8.00	32.24
1G	8.85	60.30
1E	19.87	74.38
1D	22.89	88.93
1H	26.17	100.82
1L	7.54	29.19
1F	11.18	47.67
1N	12.80	52.53
1O	4.95	26.44
1I	4.60	17.31
1J	9.88	44.51

DESIGN POINT SUMMARY		
Design Point	Q2	Q100
ID	(CFS)	(CFS)
2C	6.66	25.30
2D	15.56	50.92
2B	4.40	16.85
2A	13.05	77.52
2E	19.36	100.28
2F	25.39	122.07
2G	6.89	26.54
2I	9.91	38.45
2H	40.10	167.48
2J	39.40	197.69
2K	40.61	200.87

DESIGN POINT SUMMARY		
Design Point	Q2	Q100
ID	(CFS)	(CFS)
3A	7.20	30.57

DESIGN POINT SUMMARY		
Design Point	Q2	Q100
ID	(CFS)	(CFS)
4B	6.52	26.60
4J	12.14	46.67
4G	2.97	12.69
1	14.92	60.55
4A	20.38	85.02
4H	1.22	4.69
4L	2.70	7.58
4F	6.27	22.48
4C	7.12	27.00
4D	9.36	37.09
4E	17.10	63.93
4I	5.03	20.89
2	20.84	79.46
4K	7.86	22.03
3	25.69	92.75

DESIGN POINT SUMMARY		
Design Point	Q2	Q100
ID	(CFS)	(CFS)
5A	14.79	66.03
5C	20.35	80.41
5D	4.32	89.78
5E	27.93	92.35
5B	6.61	38.20
5N	13.66	53.43
5K	2.48	14.96
5L	4.67	28.17
5X	23.28	52.01
5F	29.47	72.77
5H	34.77	87.06
5I	4.59	20.55
5J	1.57	6.14
5W	2.46	9.41
5G	8.37	115.73
5M	2.76	16.67
5Y	5.78	24.89

DESIGN POINT SUMMARY		
Design Point	Q2	Q100
ID	(CFS)	(CFS)
4	39.56	95.77
5	75.24	282.05
6B	7.34	21.27
6A	19.11	50.52
6	36.89	155.71
6D	9.68	36.24
6C	11.00	47.00
6E	46.21	99.97
6I	44.96	94.56
6G	46.00	163.03
6H	9.75	45.56
6F	13.44	62.63

BASIN SUMMARY			
BASIN ID	AREA	Q2	Q100
	(AC)	(CFS)	(CFS)
A1	4.86	6.07	23.37
A2	4.37	6.12	23.00
A3	3.23	3.71	14.72
A4	4.07	3.34	16.42
A5	4.10	5.28	20.28
A6	4.96	4.11	20.28
A7	6.37	8.85	33.35
A8	2.86	4.04	15.17
A9	3.44	4.60	17.31
A10	0.72	1.41	4.68
A11	6.12	7.45	28.79
A12	5.96	7.54	29.19
A13	7.08	8.00	32.24
A14	1.43	2.12	8.02
A15	7.15	4.95	26.44
B1	21.00	9.90	65.44
B2	3.13	4.40	16.85
B3	4.92	6.66	25.30
B4	4.03	10.52	30.33
B5	6.38	8.50	31.58
B6	6.38	8.50	31.58
B7	6.76	6.89	26.54
B8	4.93	6.02	23.77
B9	2.81	3.39	13.38
B10	0.65	1.89	5.29
B11	0.84	2.34	6.55
C1	7.47	7.20	30.57
D1	5.94	5.89	26.25
D2	5.33	6.52	26.60
D3	5.67	7.12	27.00
D4	2.91	2.73	11.96
D5	9.10	12.05	42.92
D6	2.57	2.80	11.66
D7	2.58	2.97	12.69
D8	0.85	1.22	4.69
D9	4.62	5.03	20.89
D10	4.80	6.30	24.78
D11	3.29	7.86	22.03
D12	1.13	2.70	7.58
E1	15.28	15.39	66.03
E2	5.27	5.36	20.26
E3	4.77	6.32	23.90
E4	3.14	4.32	16.38
E5	5.49	6.64	26.15
E6	5.54	7.76	29.46
E7	5.53	7.08	26.75
E8	4.73	6.65	24.86
E9	4.84	4.59	20.55
E10	1.29	1.57	6.14
E11	3.99	2.48	14.96
E12	7.51	4.67	28.17
E13	4.45	2.76	16.67
E14	11.27	13.66	53.43
F1	5.16	12.76	36.88
F2	2.99	7.34	21.27
F3	3.60	1.95	13.13
F4	7.36	9.68	36.24
F5	4.58	5.34	21.28
F6	5.46	4.90	22.67
F7	2.98	2.25	11.77
F8	8.58	6.91	34.42
F9	1.28	2.47	7.48
E15	1.95	2.46	9.41
E16	1.57	4.11	11.53
E17	1.55	4.05	11.37

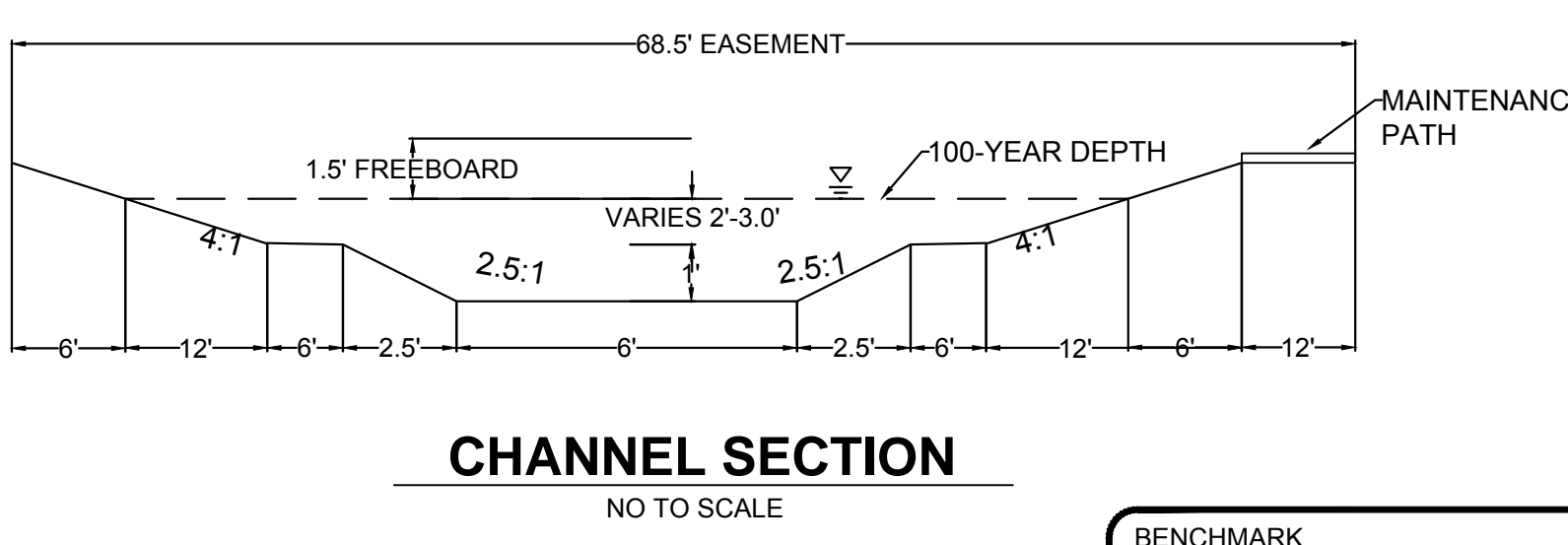
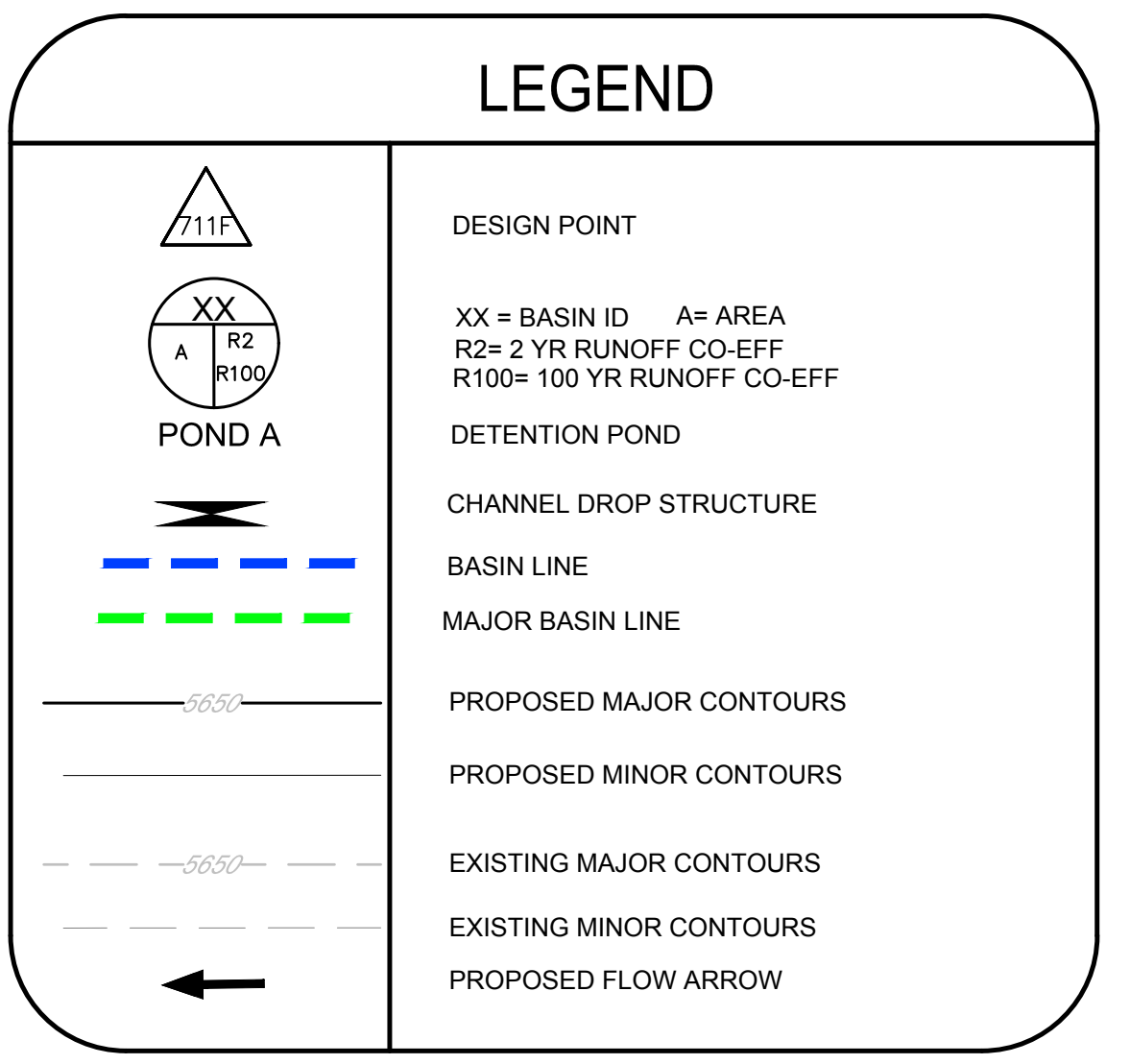
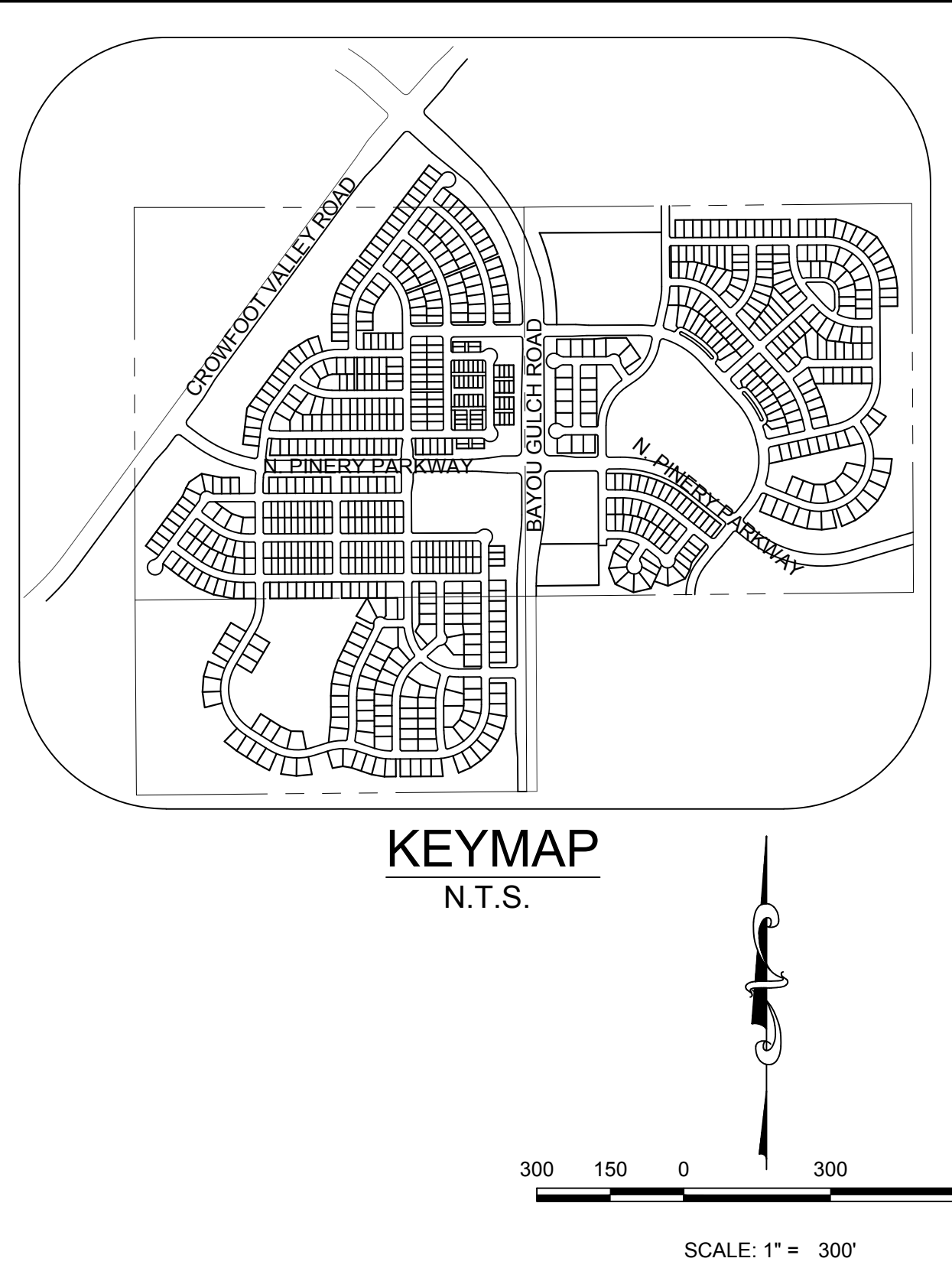

**BENCHMARK**  
THE DOUGLAS COUNTY CONTROL POINT KNOWN AS 1.069032, BEING A 3-1/4" ALUMINUM CAP, BEING LOCATED IN THE SOUTHWEST QUARTER OF SECTION 33, TOWNSHIP 6 SOUTH, RANGE 66 WEST OF THE SIXTH PRINCIPAL MERIDIAN, HAVING A PUBLISHED ELEVATION OF 1799.2870 METERS (5903.13 FEET) NAVD '88 DATUM.

**BASIS OF BEARINGS:**  
THE EAST LINE OF THE NORTHEAST QUARTER OF SAID SECTION 9 BEING MONUMENTED AT THE NORTHEAST CORNER OF SAID SECTION 9 BY A 3-1/4" ALUMINUM CAP STAMPED LS 23053 AND AT THE EAST QUARTER CORNER OF SAID SECTION 9 BY A 2-1/2" ALUMINUM CAP STAMPED LS 6935 BEING CONSIDERED TO BEAR SOUTH 00°15'06" EAST, 2648.70 FEET.

- NOTE:**
- THE TOWN OF PARKER REVIEW CONSTITUTES GENERAL COMPLIANCE WITH THE TOWN'S STANDARDS AND APPROVED VARIANCES, SUBJECT TO THESE PLANS BEING STAMPED, SIGNED, AND DATED BY THE PROFESSIONAL ENGINEER OF RECORD. REVIEW BY THE TOWN DOES NOT CONSTITUTE APPROVAL OF THE PLAN DESIGN OR ACCURACY AND CORRECTNESS OF ENGINEERING CALCULATIONS. ERRORS IN THE DESIGN OR CALCULATIONS REMAIN THE RESPONSIBILITY OF THE REGISTERED PROFESSIONAL ENGINEER WHOSE STAMP AND SIGNATURE ARE AFFIXED TO THIS DOCUMENT.
  - POND A & C ARE MAINTAINED BY METRO DISTRICT AND UDFCD.
  - OUTLET STRUCTURE AND OVERFLOW WEIR DETAILS WILL BE PROVIDED WITH FINAL DRAINAGE REPORT.
  - DROP STRUCTURE DETAILS ARE PROVIDED IN CHANNEL PLAN AND PROFILE SHEET.

THE TOWN OF PARKER REVIEW CONSTITUTES GENERAL COMPLIANCE WITH THE TOWN'S STANDARDS AND APPROVED VARIANCES, SUBJECT TO THESE PLANS BEING STAMPED, SIGNED, AND DATED BY THE PROFESSIONAL ENGINEER OF RECORD. REVIEW BY THE TOWN DOES NOT CONSTITUTE APPROVAL OF THE PLAN DESIGN OR ACCURACY AND CORRECTNESS OF ENGINEERING CALCULATIONS. ERRORS IN THE DESIGN OR CALCULATIONS REMAIN THE RESPONSIBILITY OF THE REGISTERED PROFESSIONAL ENGINEER WHOSE STAMP AND SIGNATURE ARE AFFIXED TO THIS DOCUMENT.

THIS REVIEW DOES NOT CONSTITUTE APPROVAL OF ANY PRIVATE ON-SITE IMPROVEMENTS WHICH MAY BE SHOWN. CONSTRUCTION CANNOT COMMENCE UNTIL ALL REQUIRED DRAINAGE TRAFFIC REPORT(S), FINAL DEVELOPMENT PLAN(S), SPECIAL REVIEW(S), GRADING PERMIT, AND/OR OTHER PERMITS ARE COMPLETE, APPROVED, AND ON FILE WITH THE TOWN OF PARKER.

TOWN OF PARKER, PUBLIC WORKS DIRECTOR \_\_\_\_\_ DATE \_\_\_\_\_  
TOWN OF PARKER, PUBLIC WORKS MANAGER - STORMWATER \_\_\_\_\_ DATE \_\_\_\_\_  
TOWN OF PARKER, PUBLIC WORKS MANAGER - TRANSPORTATION \_\_\_\_\_ DATE \_\_\_\_\_

PREPARED UNDER THE SUPERVISION OF

MARK SCHEURER  
COLORADO P.E. 48988

SHEET NUMBER	DRAWN BY: AYK	CHECKED BY: JJJ	DATE: NOVEMBER 2016	SCALE:	AS SHOWN	FILE NO:	8130283701
				TRAILS AT CROWFOOT	PRELIMINARY CONSTRUCTION DRAWINGS	OVERALL DRAINAGE MAP	
				NO.	REVISIONS	DATE	APPR.
				<b>ESX MANAGEMENT</b> 7353 South Alton Way CENTENNIAL, CO 80112			
				10333 E. Dry Creek Rd. Suite 410 Englewood, CO 80150 Tel: (720) 482-9526 Fax: (720) 482-9548			

N:\PROJECTS\BENCHMANS\ENGINEERING\DRAINAGE\STUDIES\DRAINAGE MAPS\DRAINAGE MAP DWG. AS\UNDK. 11/20/16 2:44 PM

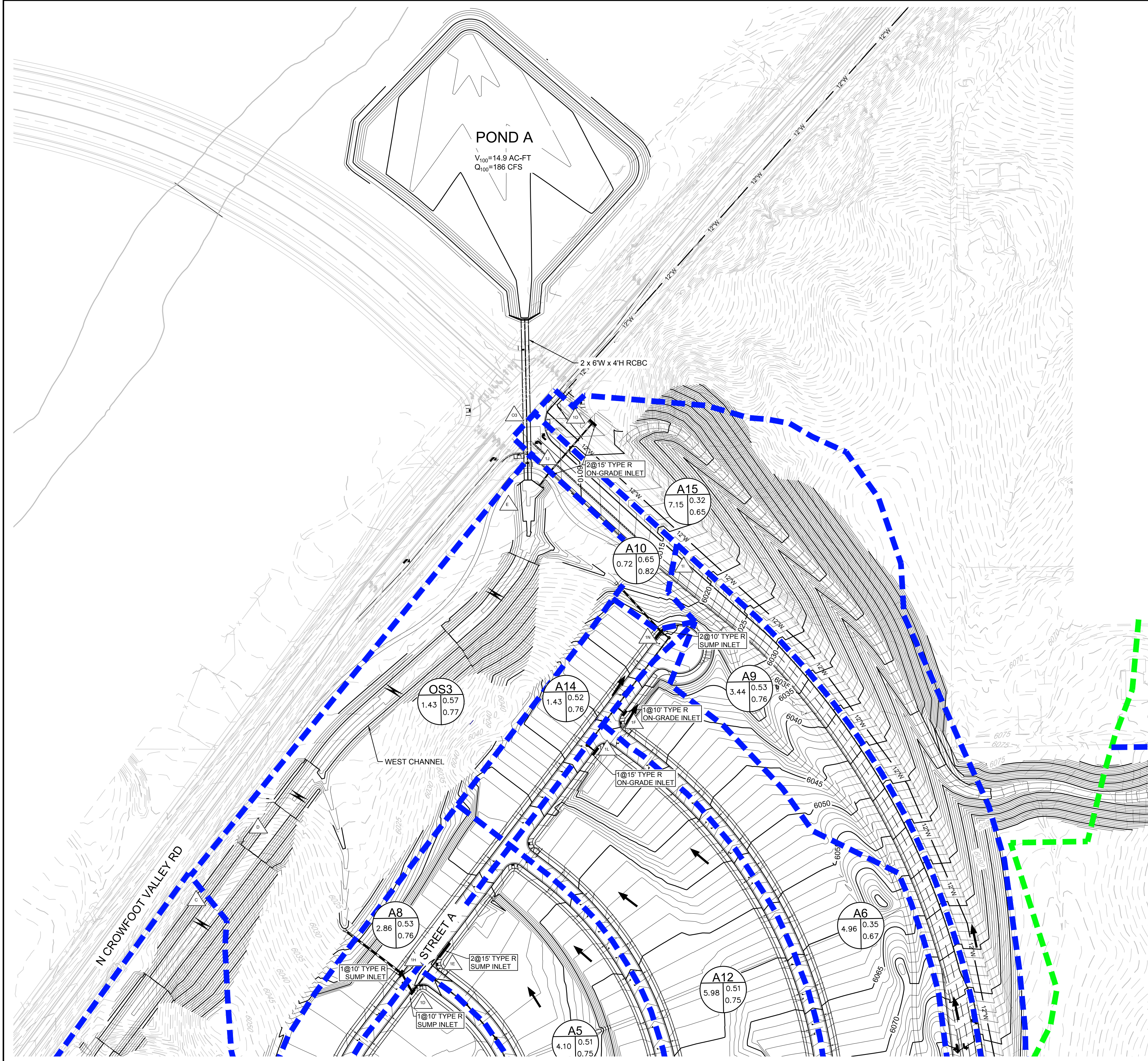

MATCHLINE - SHEET 3

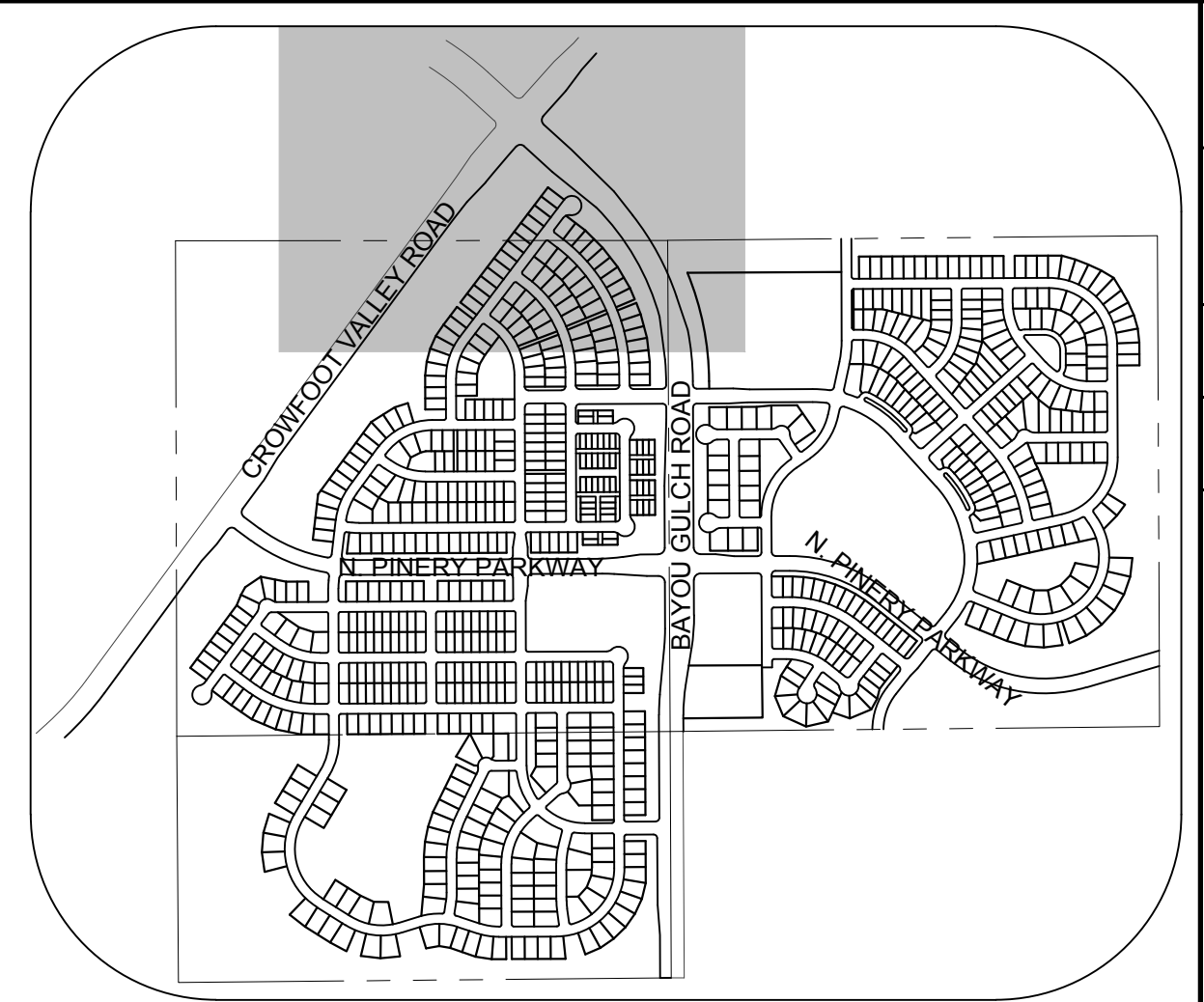
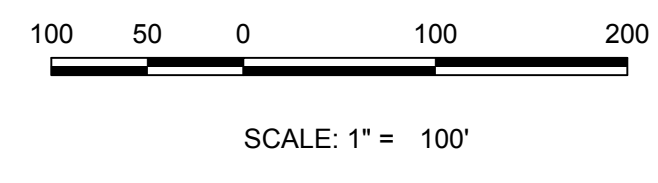

**KEYMAP**  
N.T.S.

DESIGN POINT SUMMARY		
Design Point	Q2 (CFS)	Q100 (CFS)
1A	6.07	23.37
1B	17.67	65.86
1C	21.14	79.26
1M	8.00	32.24
1G	8.85	60.30
1E	19.87	74.38
1D	22.89	88.93
1H	26.17	100.82
1L	7.54	29.19
1F	11.18	47.67
1N	12.80	52.53
1O	4.95	26.44
1I	4.60	17.31
1J	9.88	44.51

BASIN SUMMARY			
BASIN ID	AREA (AC)	Q2 (CFS)	Q100 (CFS)
A1	4.86	6.07	23.37
A2	4.37	6.12	23.00
A3	3.23	3.71	14.72
A4	4.07	3.34	16.42
A5	4.10	5.28	20.28
A6	4.96	4.11	20.28
A7	6.37	8.85	33.35
A8	2.86	4.04	15.17
A9	3.44	4.60	17.31
A10	0.72	1.41	4.68
A11	6.12	7.45	28.79
A12	5.98	7.54	29.19
A13	7.08	8.90	32.24
A14	1.43	2.12	8.02
A15	7.15	4.95	26.44

- NOTE:
1. THE TOWN OF PARKER REVIEW CONSTITUTES GENERAL COMPLIANCE WITH THE TOWN'S STANDARDS AND APPROVED VARIANCES, SUBJECT TO THESE PLANS BEING STAMPED, SIGNED, AND DATED BY THE PROFESSIONAL ENGINEER OF RECORD. REVIEW BY THE TOWN DOES NOT CONSTITUTE APPROVAL OF THE PLAN DESIGN OR ACCURACY AND CORRECTNESS OF ENGINEERING CALCULATIONS. ERRORS IN THE DESIGN OR CALCULATIONS REMAIN THE RESPONSIBILITY OF THE REGISTERED PROFESSIONAL ENGINEER WHOSE STAMP AND SIGNATURE ARE AFFIXED TO THIS DOCUMENT.
  2. POND A & C ARE MAINTAINED BY METRO DISTRICT AND UDFCD.
  3. OUTLET STRUCTURE AND OVERFLOW WEIR DETAILS WILL BE PROVIDED WITH FINAL DRAINAGE REPORT.
  4. DROP STRUCTURE DETAILS ARE PROVIDED IN CHANNEL PLAN AND PROFILE SHEET.

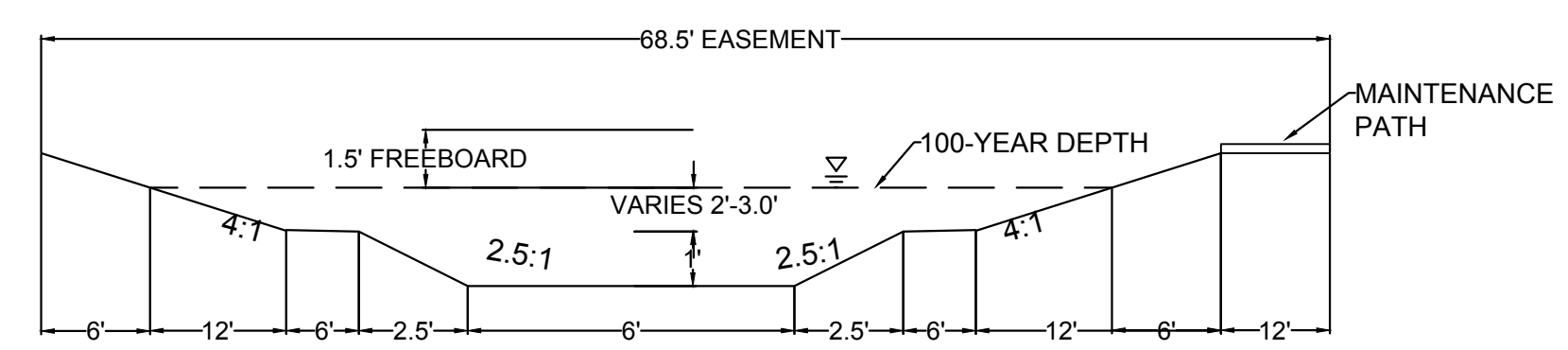
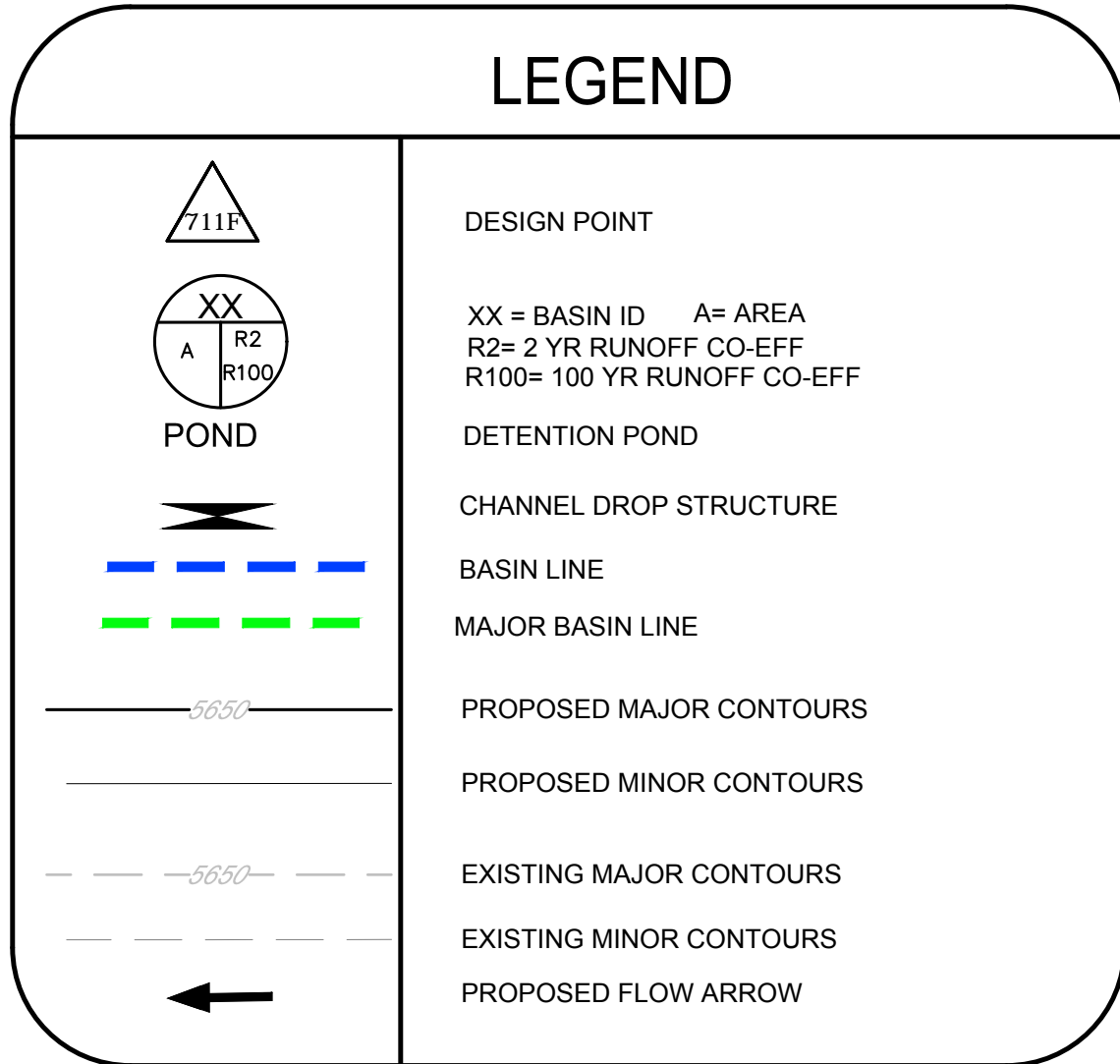

**CHANNEL SECTION**  
NO TO SCALE

**BENCHMARK**  
DOUGLAS COUNTY CONTROL POINT KNOWN AS 1.069032, BEING A 3-1/4" ALUMINUM CAP, BEING LOCATED IN THE SOUTHWEST QUARTER OF SECTION 33, TOWNSHIP 6 SOUTH, RANGE 66 WEST OF THE SIXTH PRINCIPAL MERIDIAN, HAVING A PUBLISHED ELEVATION OF 1799.2870 METERS (5903.13 FEET) NAVD '88 DATUM.

**BASIS OF BEARINGS:**  
THE EAST LINE OF THE NORTHEAST QUARTER OF SAID SECTION 9 BEING MONUMENTED AT THE NORTHEAST CORNER OF SAID SECTION 9 BY A 3-1/4" ALUMINUM CAP STAMPED LS 23053 AND AT THE EAST QUARTER CORNER OF SAID SECTION 9 BY A 2-1/2" ALUMINUM CAP STAMPED LS 6935 BEING CONSIDERED TO BEAR SOUTH 00°15'06" EAST, 2648.70 FEET.

PREPARED UNDER THE SUPERVISION OF

MARK SCHEURER  
COLORADO P.E. 48988

SHEET NUMBER	DRAWN BY: AYK	CHECKED BY: JU	DATE: NOVEMBER, 2016	SCALE:	AS SHOWN	FILE NO:	8130283701
				TRAILS AT CROWFOOT PRELIMINARY CONSTRUCTION DRAWINGS DRAINAGE MAP	ESX MANAGEMENT 7353 South Alton Way CENTENNIAL, CO 80112	Revisions	No.

10333 E. Dry Creek Rd.  
Suite 410  
Englewood, Colorado 80152  
Tel: (720) 482-9526  
Fax: (720) 482-9548

2



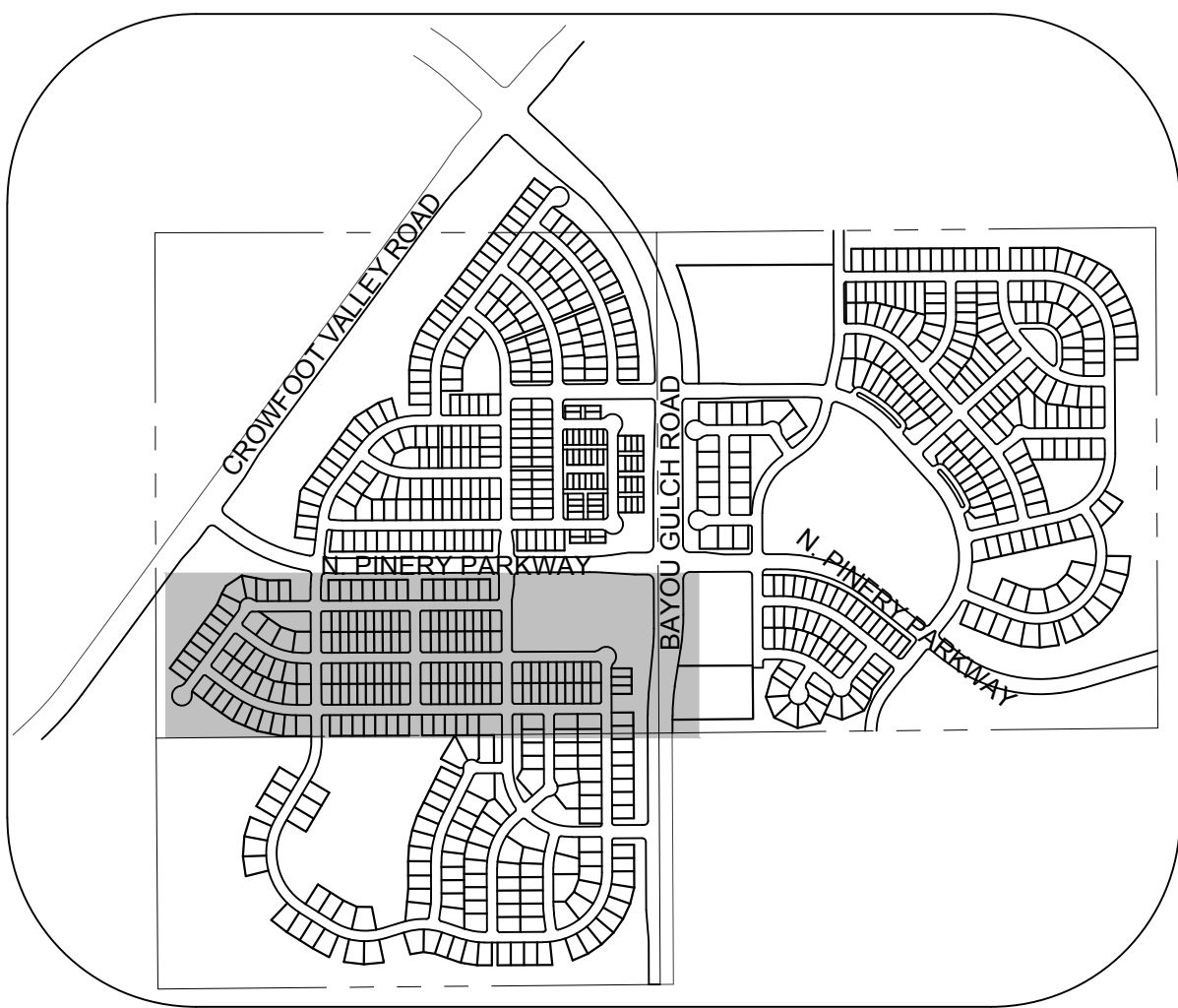

### LEGEND

	DESIGN POINT
	XX = BASIN ID A= AREA R2= 2 YR RUNOFF CO-EFF R100= 100 YR RUNOFF CO-EFF
	POND
	CHANNEL DROP STRUCTURE
	BASIN LINE
	MAJOR BASIN LINE
	PROPOSED MAJOR CONTOURS
	PROPOSED MINOR CONTOURS
	EXISTING MAJOR CONTOURS
	EXISTING MINOR CONTOURS
	PROPOSED FLOW ARROW

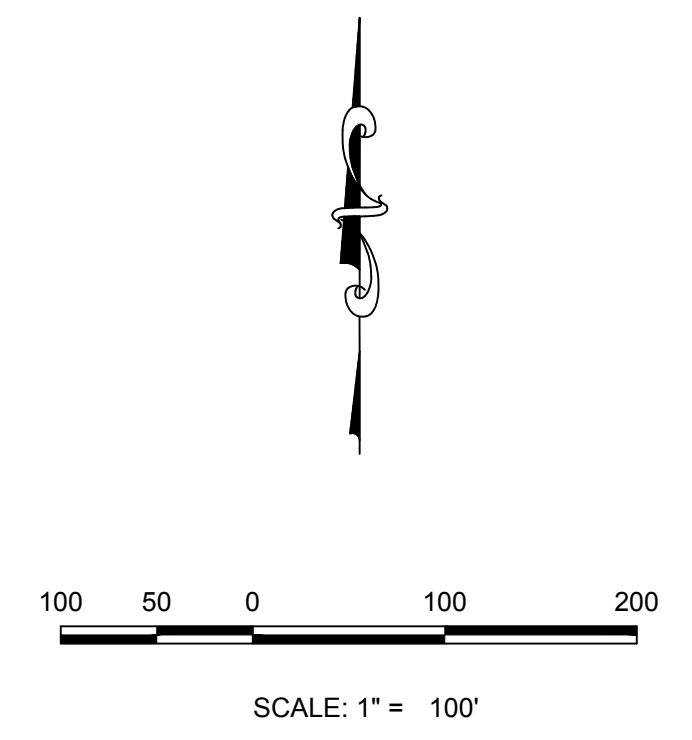
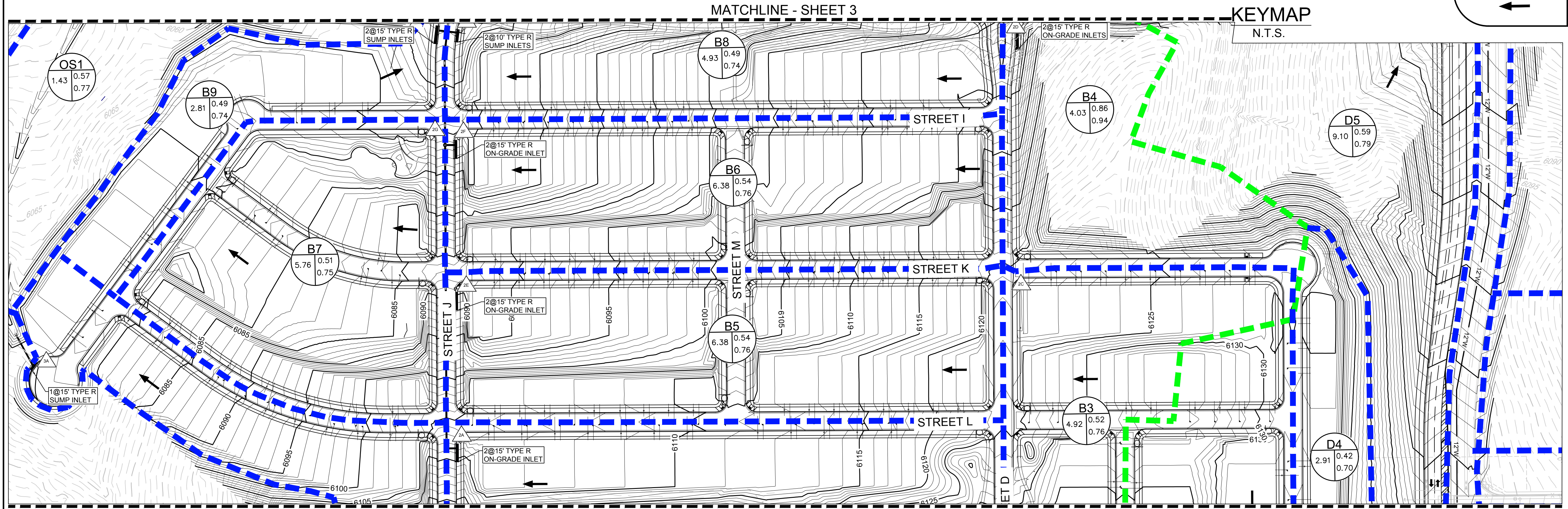

MATCHLINE - SHEET 3

KEYMAP  
N.T.S.

MATCHLINE - SHEET 5

BASIN SUMMARY			
BASIN ID	AREA (AC)	Q2 (CFS)	Q100 (CFS)
B1	21.00	9.90	65.44
B2	3.13	4.40	16.85
B3	4.92	6.66	25.30
B4	4.03	10.52	30.33
B5	6.38	8.50	31.58
B6	6.38	8.50	31.58
B7	5.76	6.89	26.54
B8	4.93	6.02	23.77
B9	2.81	3.39	13.38
B10	0.65	1.89	5.29
B11	0.84	2.34	6.55

DESIGN POINT SUMMARY			
Design Point ID	Q2 (CFS)	Q100 (CFS)	
2C	6.66	25.30	
2D	15.56	50.92	
2B	4.40	16.85	
2A	13.05	77.52	
2E	19.36	100.28	
2F	25.39	122.07	
2G	6.89	26.54	
2I	9.91	38.45	
2H	40.10	167.48	
2J	39.40	197.69	
2K	40.61	200.87	

BASIN SUMMARY			
BASIN ID	AREA (AC)	Q2 (CFS)	Q100 (CFS)
C1	7.47	7.20	30.57
D1	5.94	5.89	26.25
D2	5.33	6.52	26.60
D3	5.67	7.12	27.00
D4	2.91	2.73	11.96
D5	9.10	12.05	42.92
D6	2.57	2.80	11.66
D7	2.58	2.97	12.69
D8	0.85	1.22	4.69
D9	4.62	5.03	20.89
D10	4.80	6.30	24.78
D11	3.29	7.86	22.03
D12	1.13	2.70	7.58

DESIGN POINT SUMMARY			
Design Point ID	Q2 (CFS)	Q100 (CFS)	
3A	7.20	30.57	

DESIGN POINT SUMMARY			
Design Point ID	Q2 (CFS)	Q100 (CFS)	
4B	6.52	26.60	
4J	12.14	48.67	
4G	2.97	12.69	
1	14.92	60.55	
4A	20.38	85.02	
4H	1.22	4.69	
4L	2.70	7.58	
4F	6.27	22.48	
4C	7.12	27.00	
4D	9.36	37.09	
4E	17.10	63.93	
4I	5.03	20.89	
2	20.84	79.46	
4K	7.86	22.03	
3	25.69	92.75	

- NOTE:
1. THE TOWN OF PARKER REVIEW CONSTITUTES GENERAL COMPLIANCE WITH THE TOWN'S STANDARDS AND APPROVED VARIANCES, SUBJECT TO THESE PLANS BEING STAMPED, SIGNED, AND DATED BY THE PROFESSIONAL ENGINEER OF RECORD. REVIEW BY THE TOWN DOES NOT CONSTITUTE APPROVAL OF THE PLAN DESIGN OR ACCURACY AND CORRECTNESS OF ENGINEERING CALCULATIONS. ERRORS IN THE DESIGN OR CALCULATIONS REMAIN THE RESPONSIBILITY OF THE REGISTERED PROFESSIONAL ENGINEER WHOSE STAMP AND SIGNATURE ARE AFFIXED TO THIS DOCUMENT.
  2. POND A & C ARE MAINTAINED BY METRO DISTRICT AND UDFCD.
  3. OUTLET STRUCTURE AND OVERFLOW WEIR DETAILS WILL BE PROVIDED WITH FINAL DRAINAGE REPORT.
  4. DROP STRUCTURE DETAILS ARE PROVIDED IN CHANNEL PLAN AND PROFILE SHEET.

**BENCHMARK**  
THE DOUGLAS COUNTY CONTROL POINT KNOWN AS 1.060032, BEING A 3-1/4" ALUMINUM CAP, BEING LOCATED IN THE SOUTHWEST QUARTER OF SECTION 33, TOWNSHIP 6 SOUTH, RANGE 66 WEST OF THE SIXTH PRINCIPAL MERIDIAN, HAVING A PUBLISHED ELEVATION OF 1799.2870 METERS (5903.13 FEET) NAVD '88 DATUM.

**BASIS OF BEARINGS:**  
THE EAST LINE OF THE NORTHEAST QUARTER OF SAID SECTION 9 BEING MONUMENTED AT THE NORTHEAST CORNER OF SAID SECTION 9 BY A 3-1/4" ALUMINUM CAP STAMPED LS 23053 AND AT THE EAST QUARTER CORNER OF SAID SECTION 9 BY A 1-1/2" ALUMINUM CAP STAMPED LS 6935 BEING CONSIDERED TO BEAR SOUTH 00°15'06" EAST, 2648.70 FEET.

PREPARED UNDER THE SUPERVISION OF

MARK SCHEURER  
COLORADO P.E. 48988

SHEET NUMBER	DRAWN BY: AYK	CHECKED BY: JJ	DATE: NOVEMBER, 2016	SCALE:	AS SHOWN	FILE NO:	8130283701
				4			
TRAILS AT CROWFOOT PRELIMINARY CONSTRUCTION DRAWINGS DRAINAGE MAP				ESX MANAGEMENT 7353 South Alton Way CENTENNIAL, CO 80112			
NO PROJECTS/ISSUES RANCHED/ENGINEERING/DRAINAGE PRELIMINARY DRAINAGE STUDIES/DRAINAGE MAPS/DWG. AS/UNDK. 11/20/16 2:42 PM							
				10333 E. Dry Creek Rd. Suite 410 Englewood, CO 80110 Tel: (720) 482-9526 Fax: (720) 482-9546			
				Revisions: No. Date Init. Appr. Date			

MATCHLINE - SHEET 4

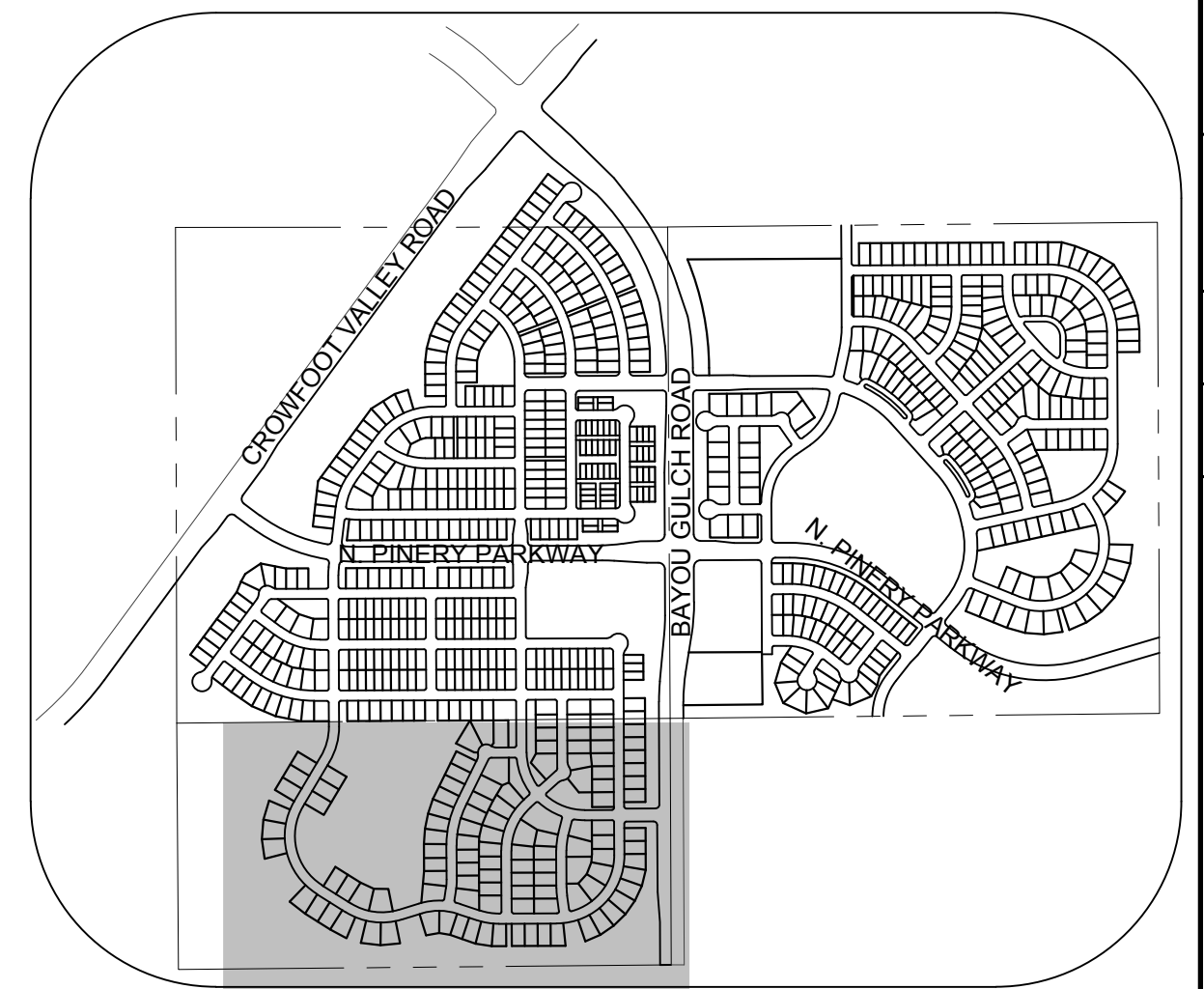
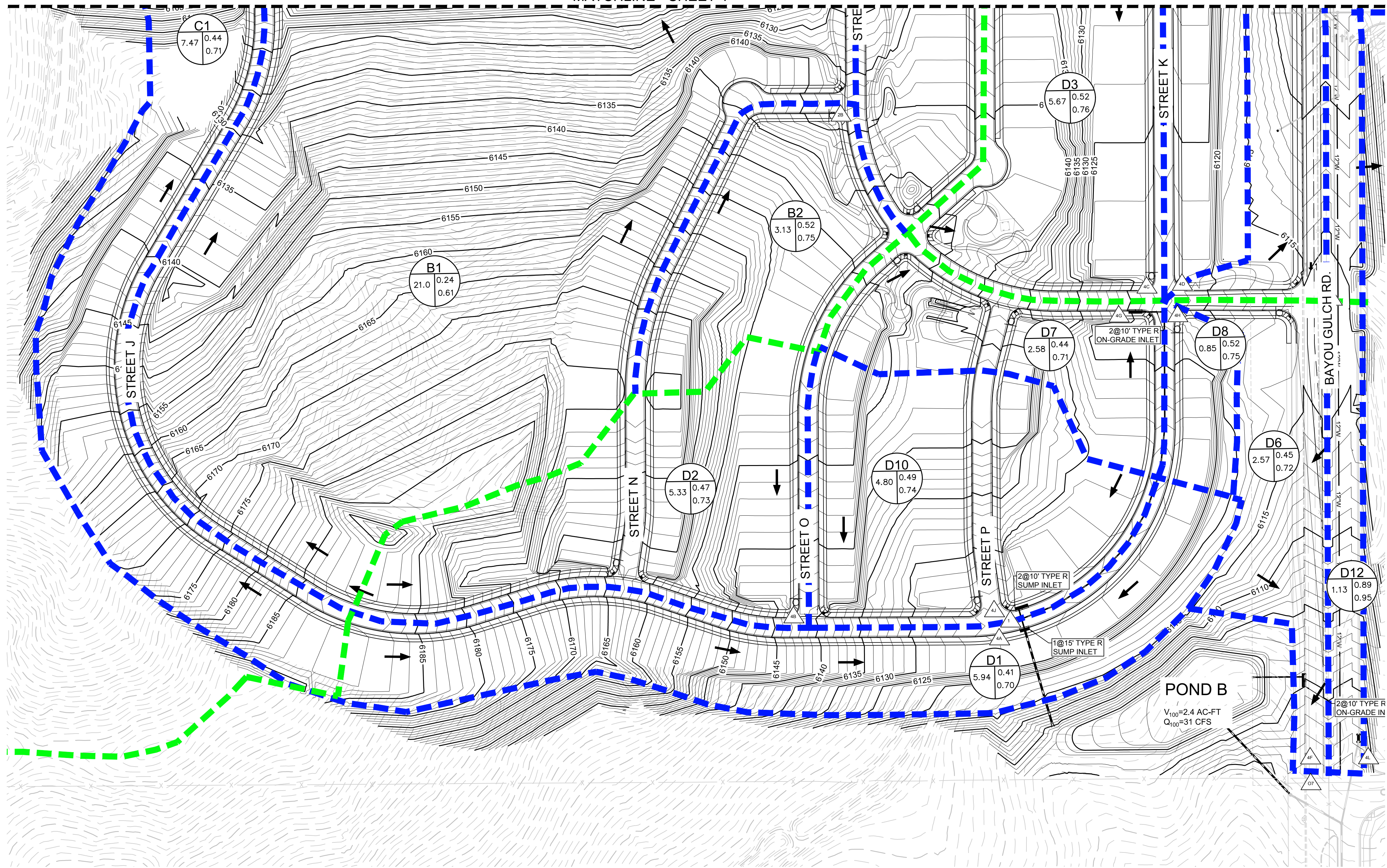

KEYMAP  
N.T.S.

- NOTE:
1. THE TOWN OF PARKER REVIEW CONSTITUTES GENERAL COMPLIANCE WITH THE TOWN'S STANDARDS AND APPROVED VARIANCES, SUBJECT TO THESE PLANS BEING STAMPED, SIGNED, AND DATED BY THE PROFESSIONAL ENGINEER OF RECORD. REVIEW BY THE TOWN DOES NOT CONSTITUTE APPROVAL OF THE PLAN DESIGN OR ACCURACY AND CORRECTNESS OF ENGINEERING CALCULATIONS. ERRORS IN THE DESIGN OR CALCULATIONS REMAIN THE RESPONSIBILITY OF THE REGISTERED PROFESSIONAL ENGINEER WHOSE STAMP AND SIGNATURE ARE AFFIXED TO THIS DOCUMENT.
  2. POND A & C ARE MAINTAINED BY METRO DISTRICT AND UDFCD.
  3. OUTLET STRUCTURE AND OVERFLOW WEIR DETAILS WILL BE PROVIDED WITH FINAL DRAINAGE REPORT.
  4. DROP STRUCTURE DETAILS ARE PROVIDED IN CHANNEL PLAN AND PROFILE SHEET.

### LEGEND

	DESIGN POINT
	XX = BASIN ID    A= AREA R2= 2 YR RUNOFF CO-EFF R100= 100 YR RUNOFF CO-EFF
	DETENTION POND
	CHANNEL DROP STRUCTURE
	BASIN LINE
	MAJOR BASIN LINE
	PROPOSED MAJOR CONTOURS
	PROPOSED MINOR CONTOURS
	EXISTING MAJOR CONTOURS
	EXISTING MINOR CONTOURS
	PROPOSED FLOW ARROW

BASIN SUMMARY			
BASIN ID	AREA (AC)	Q2 (CFS)	Q100 (CFS)
B1	21.00	9.90	65.44
B2	3.13	4.40	16.85
B3	4.92	6.66	25.30
B4	4.03	10.52	30.33
B5	6.38	8.50	31.58
B6	6.38	8.50	31.58
B7	5.76	6.89	26.54
B8	4.93	6.02	23.77
B9	2.81	3.39	13.38
B10	0.65	1.89	5.29
B11	0.84	2.34	6.55

DESIGN POINT SUMMARY			
Design Point ID	Q2 (CFS)	Q100 (CFS)	
2C	6.66	25.30	
2D	15.56	50.92	
2B	4.40	16.85	
2A	13.05	77.52	
2E	19.36	100.28	
2F	25.39	122.07	
2G	6.89	26.54	
2I	9.91	38.45	
2H	40.10	167.48	
2J	39.40	197.69	
2K	40.61	200.87	

DESIGN POINT SUMMARY			
Design Point ID	Q2 (CFS)	Q100 (CFS)	
4B	6.52	26.60	
4J	12.14	48.67	
4G	2.97	12.69	
1	14.92	60.55	
4A	20.38	85.02	
4H	1.22	4.69	
4L	2.70	7.58	
4F	6.27	22.48	
4C	7.12	27.00	
4D	9.36	37.09	
4E	17.10	63.93	
4I	5.03	20.89	
2	20.84	79.46	
4K	7.86	22.03	
3	25.69	92.75	

BASIN SUMMARY			
BASIN ID	AREA (AC)	Q2 (CFS)	Q100 (CFS)
C1	7.47	7.20	30.57
D1	5.94	5.89	26.25
D2	5.33	6.52	26.60
D3	5.67	7.12	27.00
D4	2.91	2.73	11.96
D5	9.10	12.05	42.92
D6	2.57	2.80	11.66
D7	2.58	2.97	12.69
D8	0.85	1.22	4.69
D9	4.62	5.03	20.89
D10	4.80	6.30	24.78
D11	3.29	7.86	22.03
D12	1.13	2.70	7.58

DESIGN POINT SUMMARY			
Design Point ID	Q2 (CFS)	Q100 (CFS)	
3A	7.20	30.57	

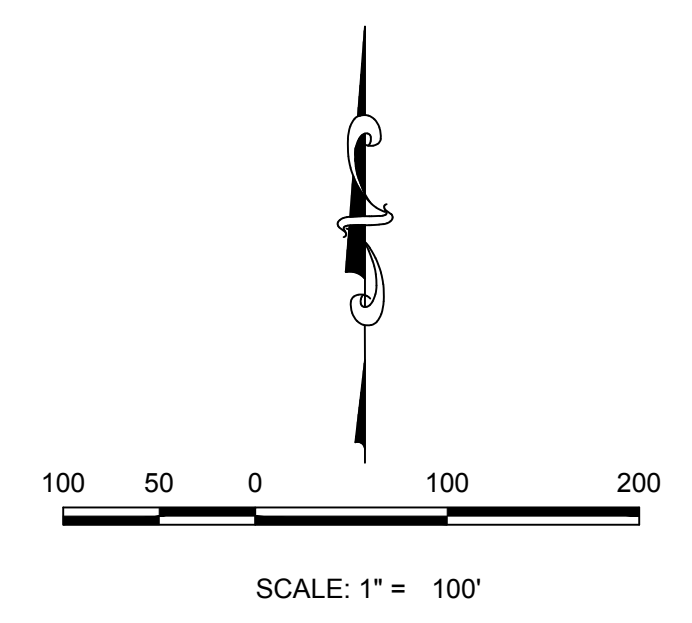

**BENCHMARK**  
THE DOUGLAS COUNTY CONTROL POINT KNOWN AS 1.060032, BEING A 3-1/4" ALUMINUM CAP, BEING LOCATED IN THE SOUTHWEST QUARTER OF SECTION 33, TOWNSHIP 6 SOUTH, RANGE 66 WEST OF THE SIXTH PRINCIPAL MERIDIAN, HAVING A PUBLISHED ELEVATION OF 1799.2870 METERS (5903.13 FEET) NAVD '88 DATUM.

**BASIS OF BEARINGS:**  
THE EAST LINE OF THE NORTHEAST QUARTER OF SAID SECTION 9 BEING MONUMENTED AT THE NORTHEAST CORNER OF SAID SECTION 9 BY A 3-1/4" ALUMINUM CAP STAMPED LS 23053 AND AT THE EAST QUARTER CORNER OF SAID SECTION 9 BY A 2-1/2" ALUMINUM CAP STAMPED LS 6935 BEING CONSIDERED TO BEAR SOUTH 00°15'06" EAST, 2648.70 FEET.

PREPARED UNDER THE SUPERVISION OF

MARK SCHEURER  
COLORADO P.E. 48988

N:\PROJECTS\BENCH\ENGINEERING\DRAINAGE\BENCH\DWG\AS\DWG\_11/20/16 2:42 PM

SHEET NUMBER <b>5</b>	SCALE: AS SHOWN	FILE NO: 8130283701	DATE: NOVEMBER 2016
	DRAWN BY: AYK	CHECKED BY: JU	
TRAILS AT CROWFOOT PRELIMINARY CONSTRUCTION DRAWINGS DRAINAGE MAP		ESX MANAGEMENT 7353 South Alton Way CENTENNIAL, CO 80112	
NO. REVISIONS		DATE INIT. APPR. DATE	
10333 E. Dry Creek Rd. Suite 410 Englewood, CO 80150 Tel: (720) 482-9526 Fax: (720) 482-9548			

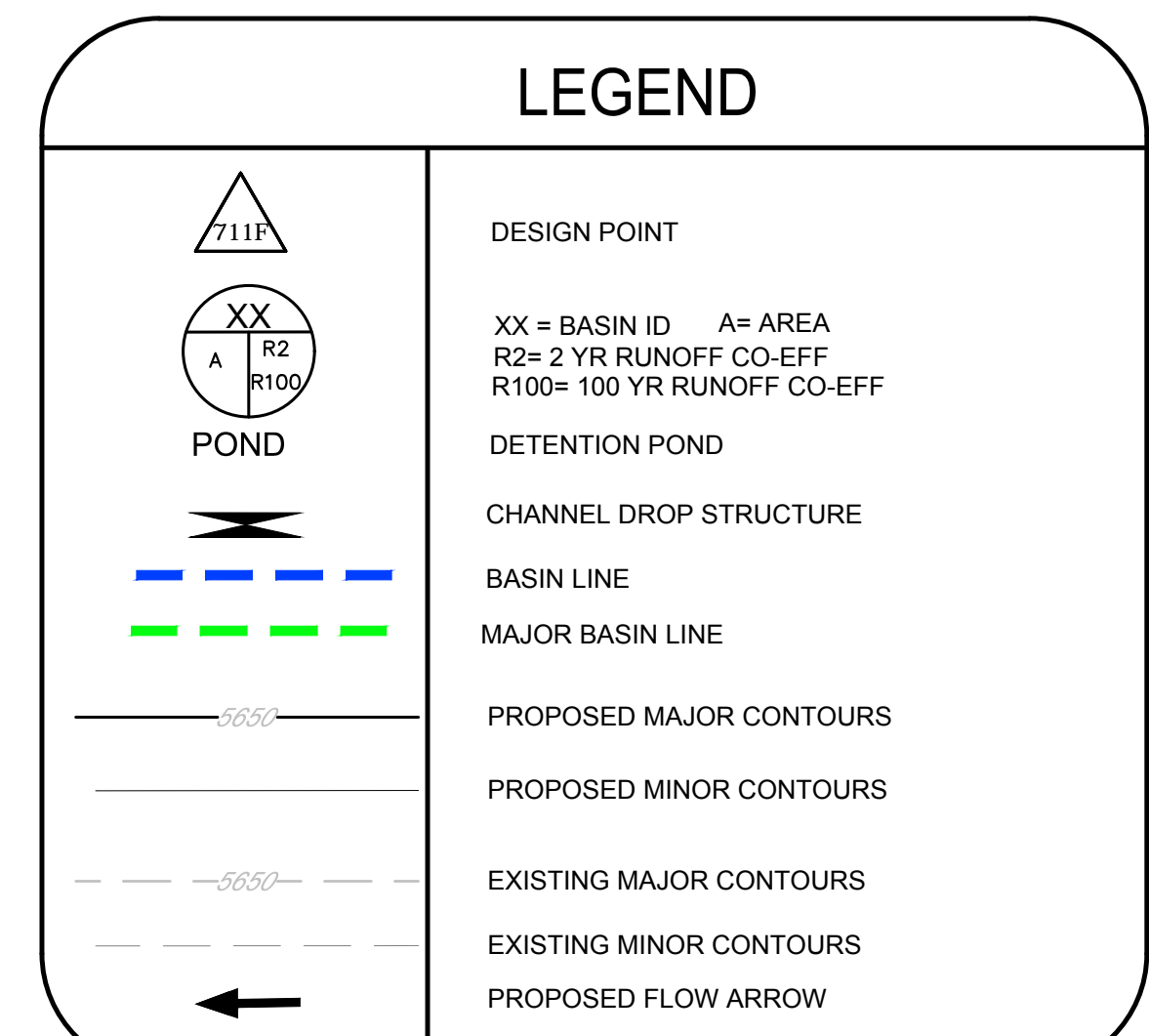
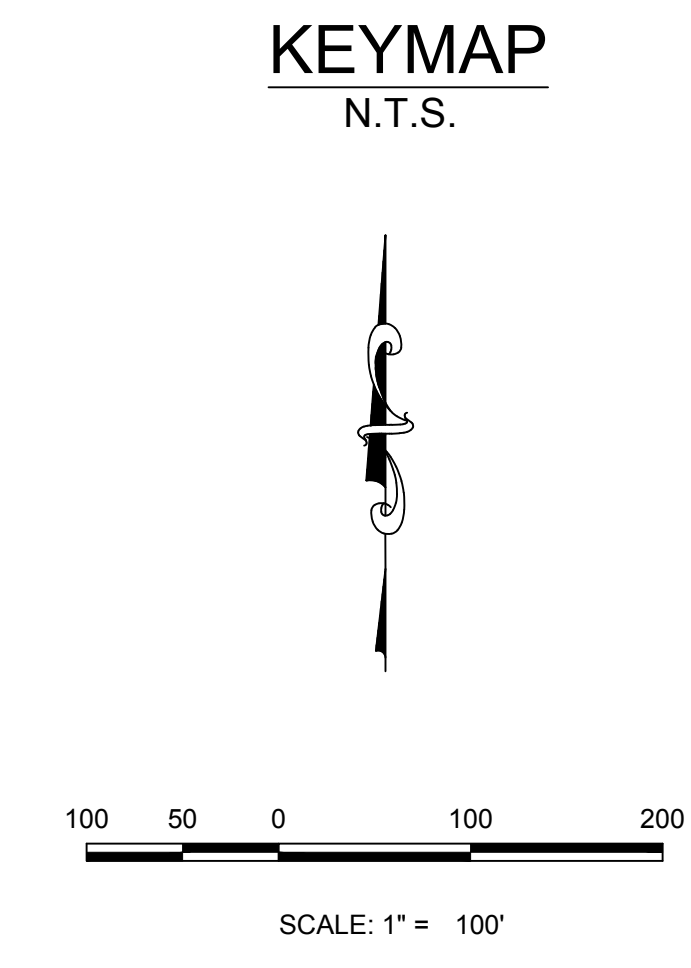
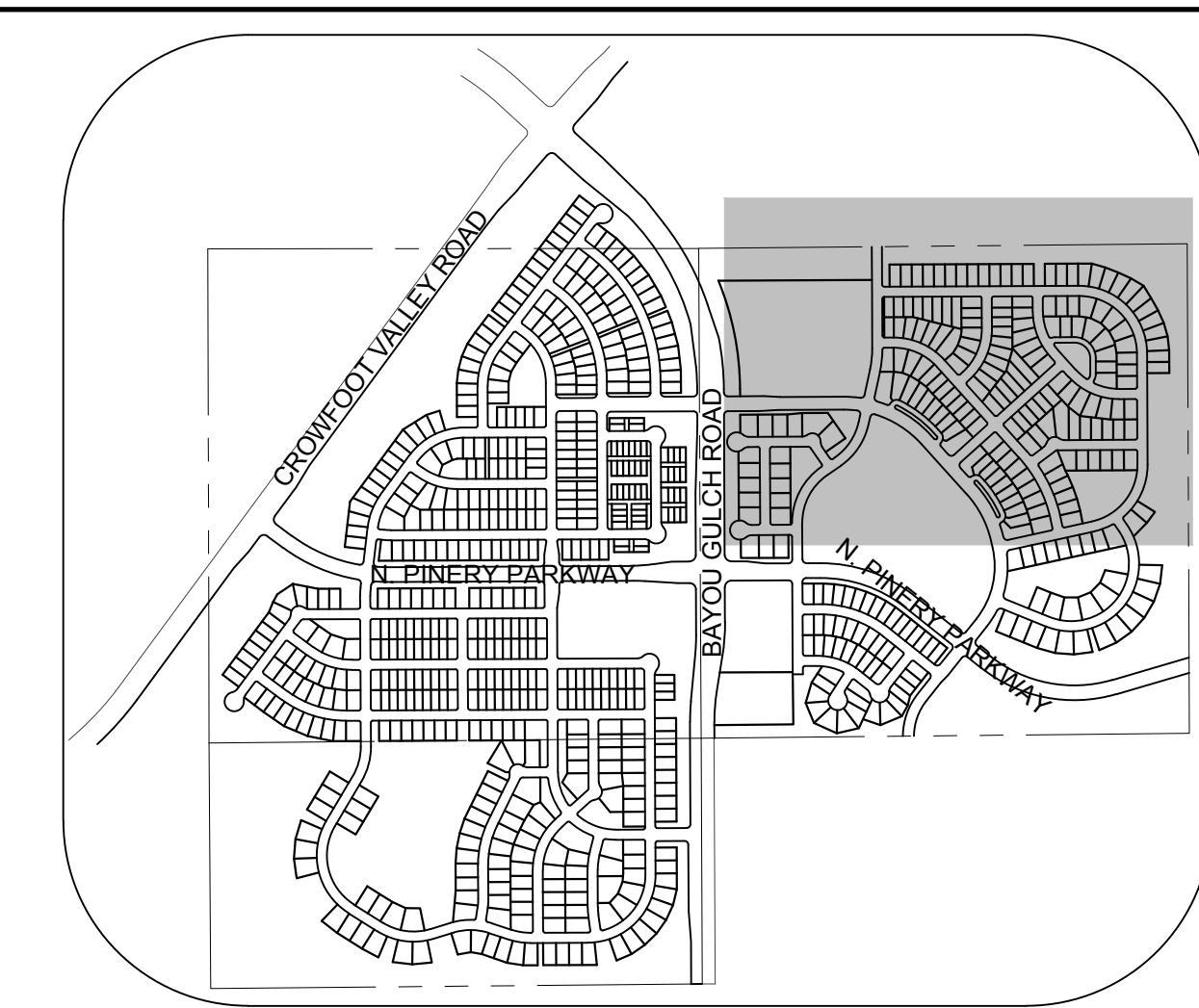
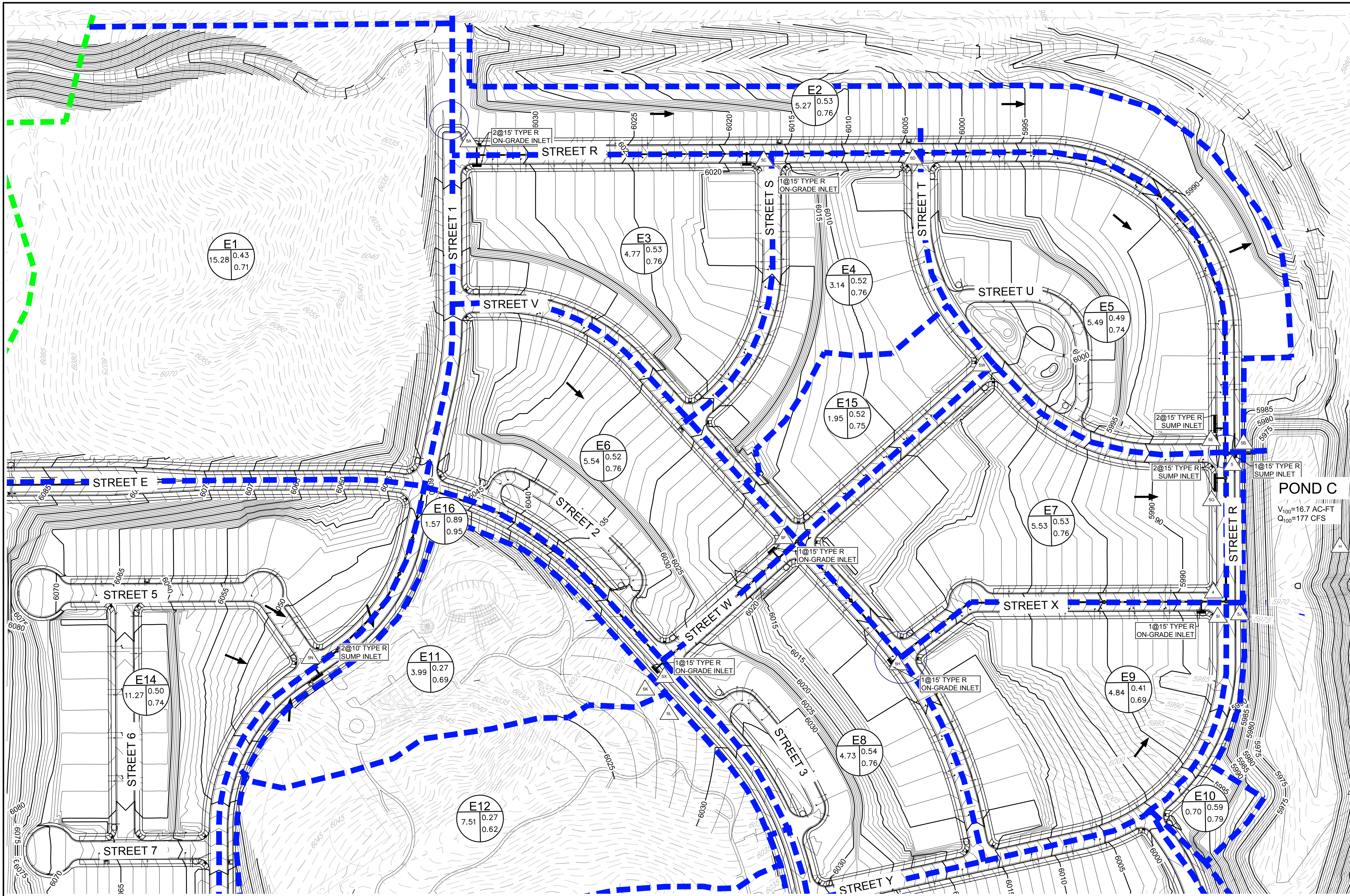

BASIN SUMMARY			
BASIN ID	AREA (AC)	Q2 (CFS)	Q100 (CFS)
E1	15.28	15.39	66.03
E2	5.27	5.36	20.26
E3	4.77	6.32	23.90
E4	3.14	4.32	16.38
E5	5.49	6.64	26.15
E6	5.54	7.76	29.46
E7	5.53	7.08	26.75
E8	4.73	6.65	24.86
E9	4.84	4.59	20.55
E10	1.29	1.57	6.14
E11	3.99	2.48	14.96
E12	7.51	4.67	28.17
E13	4.45	2.76	16.67
E14	11.27	13.66	53.43

DESIGN POINT SUMMARY		
Design Point	Q2 (CFS)	Q100 (CFS)
SA	14.79	66.03
SC	20.35	80.41
SD	4.32	89.78
SE	27.93	92.35
SB	6.61	38.20
SN	13.66	53.43
SK	2.48	14.96
SL	4.67	28.17
SX	23.28	52.01
SF	29.47	72.77
SH	34.77	87.06
SI	4.59	20.55
SJ	1.57	6.14
SW	2.46	9.41
SG	8.37	115.73
SM	2.76	16.67
SY	5.78	24.89

MATCHLINE - SHEET 7

- NOTE:
- THE TOWN OF PARKER REVIEW CONSTITUTES GENERAL COMPLIANCE WITH THE TOWN'S STANDARDS AND APPROVED VARIANCES, SUBJECT TO THESE PLANS BEING STAMPED, SIGNED, AND DATED BY THE PROFESSIONAL ENGINEER OF RECORD. REVIEW BY THE TOWN DOES NOT CONSTITUTE APPROVAL OF THE PLAN DESIGN OR ACCURACY AND CORRECTNESS OF ENGINEERING CALCULATIONS. ERRORS IN THE DESIGN OR CALCULATIONS REMAIN THE RESPONSIBILITY OF THE REGISTERED PROFESSIONAL ENGINEER WHOSE STAMP AND SIGNATURE ARE AFFIXED TO THIS DOCUMENT.
  - POND A & C ARE MAINTAINED BY METRO DISTRICT AND UDFCD.
  - OUTLET STRUCTURE AND OVERFLOW WEIR DETAILS WILL BE PROVIDED WITH FINAL DRAINAGE REPORT.
  - DROP STRUCTURE DETAILS ARE PROVIDED IN CHANNEL PLAN AND PROFILE SHEET.

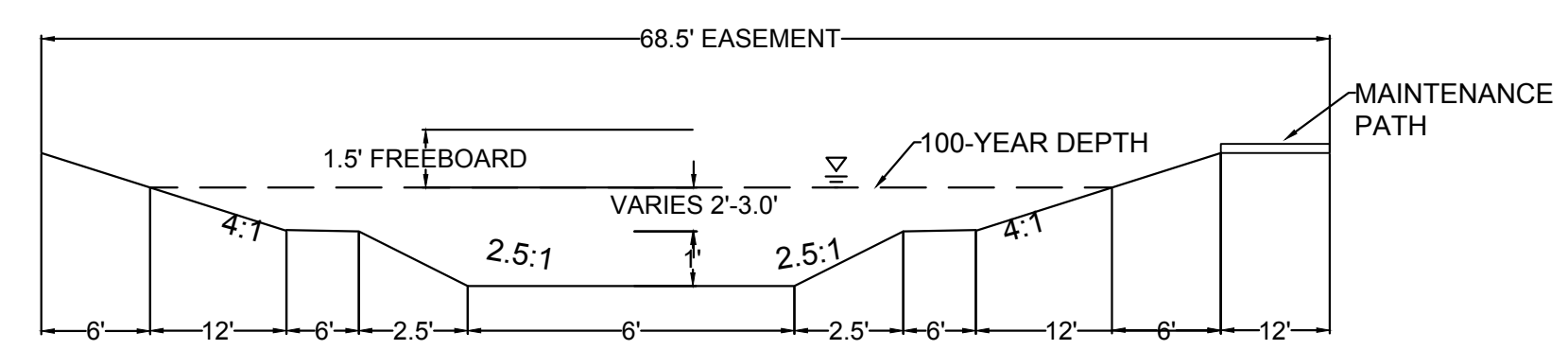

CHANNEL SECTION  
NO TO SCALE

**BENCHMARK**  
DOUGLAS COUNTY CONTROL POINT KNOWN AS 1.069032, BEING A 3-1/4" ALUMINUM CAP, BEING LOCATED IN THE SOUTHWEST QUARTER OF SECTION 33, TOWNSHIP 6 SOUTH, RANGE 66 WEST OF THE SIXTH PRINCIPAL MERIDIAN, HAVING A PUBLISHED ELEVATION OF 1799.2870 METERS (5903.13 FEET) NAVD '88 DATUM.

**BASIS OF BEARINGS:**  
THE EAST LINE OF THE NORTHEAST QUARTER OF SAID SECTION 9 BEING MONUMENTED AT THE NORTHEAST CORNER OF SAID SECTION 9 BY A 3-1/4" ALUMINUM CAP STAMPED LS 23053 AND AT THE EAST QUARTER CORNER OF SAID SECTION 9 BY A 2-1/2" ALUMINUM CAP STAMPED LS 6935 BEING CONSIDERED TO BEAR SOUTH 00°15'06" EAST, 2648.70 FEET.

PREPARED UNDER THE SUPERVISION OF

MARK SCHEURER  
COLORADO P.E. 48988

SHEET NUMBER	DRAWN BY: AYK	CHECKED BY: JJ	DATE: NOVEMBER 2016	SCALE: AS SHOWN	FILE NO: 8130283701	TRAILS AT CROWFOOT PRELIMINARY CONSTRUCTION DRAWINGS DRAINAGE MAP	ESX MANAGEMENT 7353 South Alton Way CENTENNIAL, CO 80112		10333 E. Dry Creek Rd. Suite 410 Englewood, Colorado 80150 Tel: (720) 482-9526 Fax: (720) 482-9548	No.	Revisions	Date	Init.	Appr.	Date
									6						

N:\PROJECTS\BIRCHWOODS\ENGINEERING\PRELIMINARY DRAINAGE STUDIES\DRAINAGE MAPS\DWG\_ASPUNCK\_11/20/16 2:40 PM

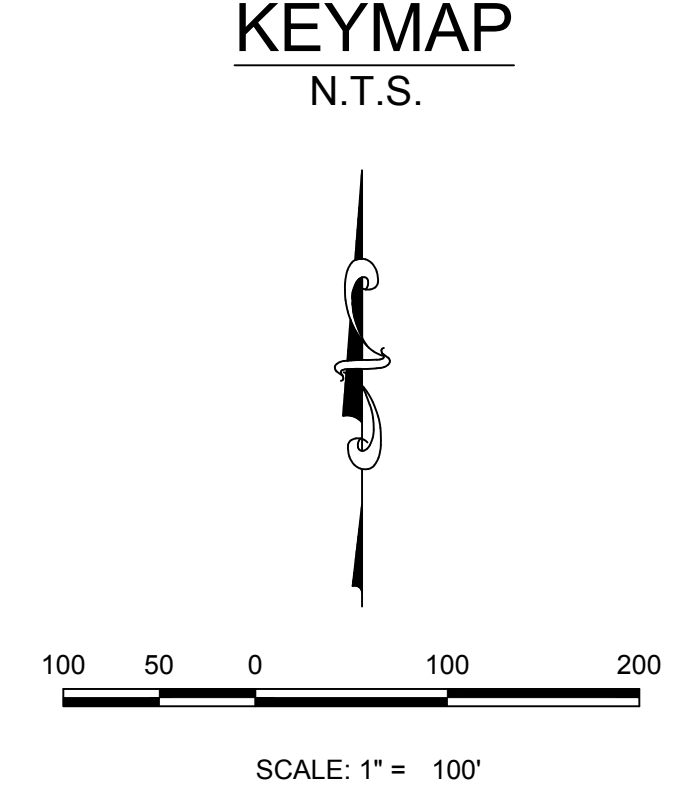
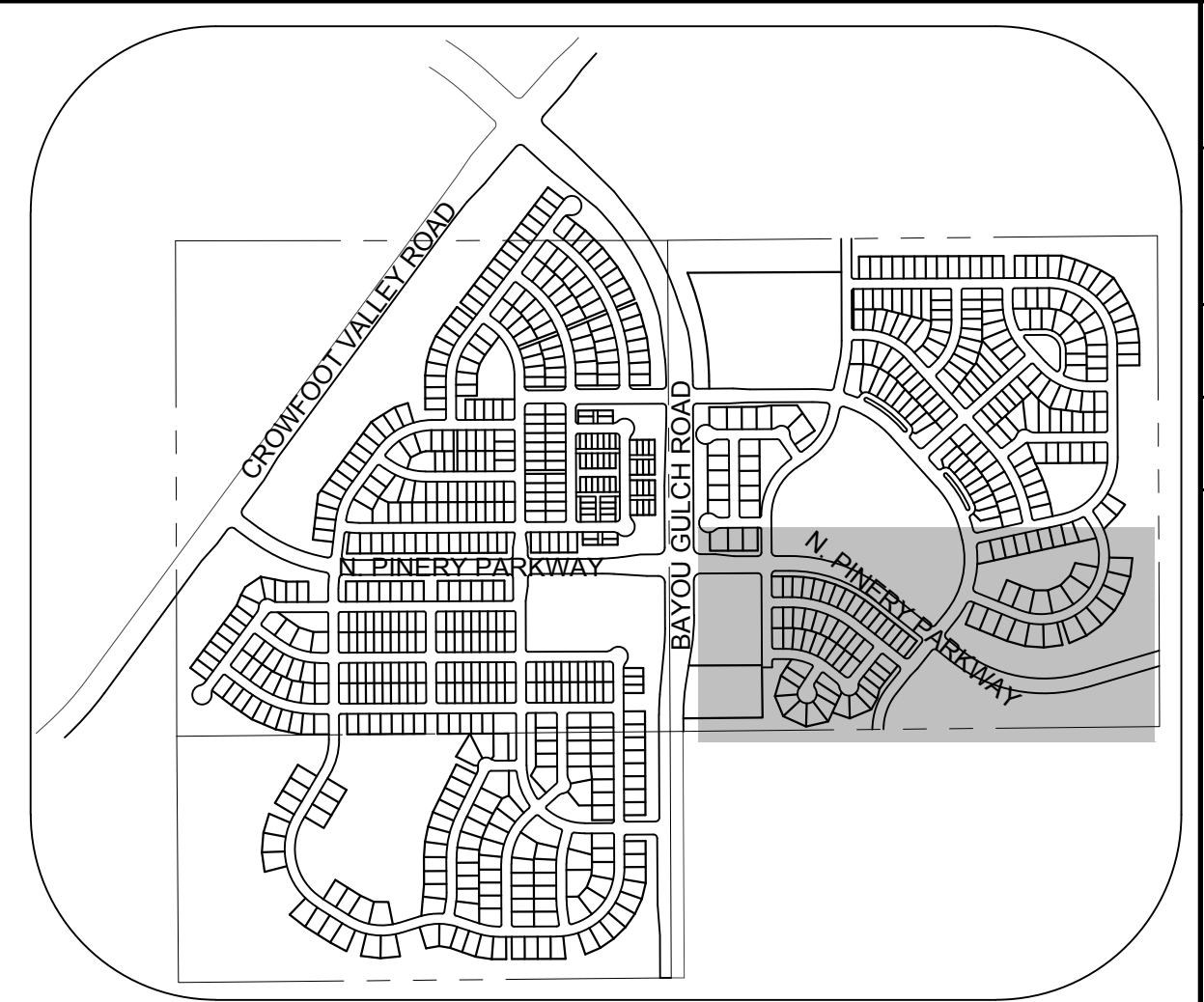
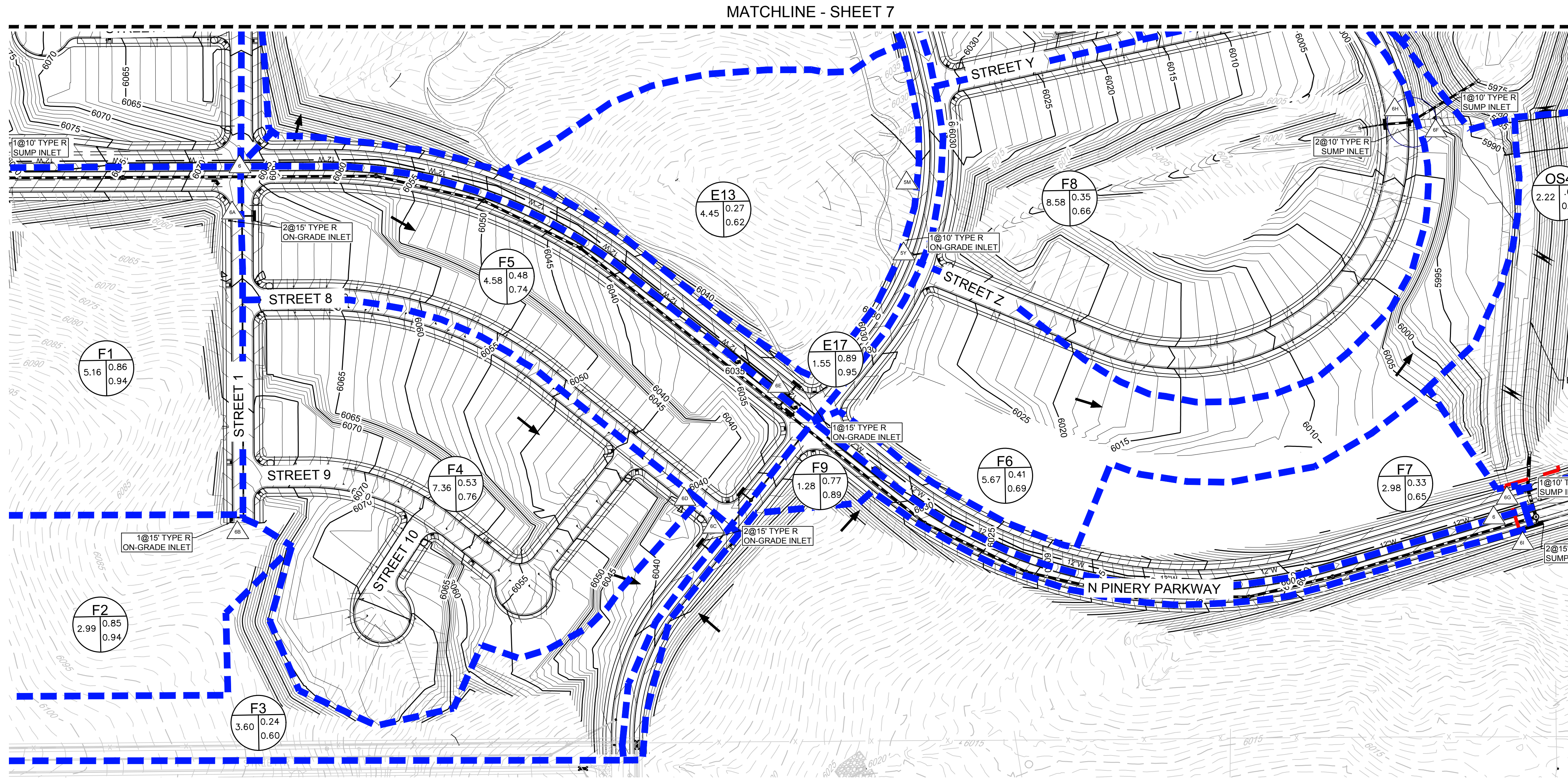

### LEGEND

	DESIGN POINT
	XX = BASIN ID    A = AREA R2 = 2 YR RUNOFF CO-EFF R100 = 100 YR RUNOFF CO-EFF
	DETENTION POND
	CHANNEL DROP STRUCTURE
	BASIN LINE
	MAJOR BASIN LINE
	PROPOSED MAJOR CONTOURS
	PROPOSED MINOR CONTOURS
	EXISTING MAJOR CONTOURS
	EXISTING MINOR CONTOURS
	PROPOSED FLOW ARROW

BASIN SUMMARY			
BASIN ID	AREA (AC)	Q <sup>2</sup> (CFS)	Q <sup>100</sup> (CFS)
F1	5.16	12.76	36.88
F2	2.99	7.34	21.27
F3	3.60	1.95	13.13
F4	7.36	9.68	36.24
F5	4.58	5.34	21.28
F6	5.46	4.90	22.67
F7	2.98	2.25	11.77
F8	8.58	6.91	34.42
F9	1.28	2.47	7.48
E15	1.95	2.46	9.41
E16	1.57	4.11	11.53
E17	1.55	4.05	11.37

DESIGN POINT SUMMARY		
Design Point ID	Q <sup>2</sup> (CFS)	Q <sup>100</sup> (CFS)
4	39.56	96.77
5	75.24	282.05
6B	7.34	21.27
6A	19.11	50.52
6	36.89	155.71
6D	9.68	36.24
6C	11.00	47.00
6E	46.21	99.97
6I	44.96	94.56
6G	46.00	163.03
6H	9.75	45.56
6F	13.44	62.63

- NOTE:
- THE TOWN OF PARKER REVIEW CONSTITUTES GENERAL COMPLIANCE WITH THE TOWN'S STANDARDS AND APPROVED VARIANCES, SUBJECT TO THESE PLANS BEING STAMPED, SIGNED, AND DATED BY THE PROFESSIONAL ENGINEER OF RECORD. REVIEW BY THE TOWN DOES NOT CONSTITUTE APPROVAL OF THE PLAN DESIGN OR ACCURACY AND CORRECTNESS OF ENGINEERING CALCULATIONS. ERRORS IN THE DESIGN OR CALCULATIONS REMAIN THE RESPONSIBILITY OF THE REGISTERED PROFESSIONAL ENGINEER WHOSE STAMP AND SIGNATURE ARE AFFIXED TO THIS DOCUMENT.
  - POND A & C ARE MAINTAINED BY METRO DISTRICT AND UDFCD.
  - OUTLET STRUCTURE AND OVERFLOW WEIR DETAILS WILL BE PROVIDED WITH FINAL DRAINAGE REPORT.
  - DROP STRUCTURE DETAILS ARE PROVIDED IN CHANNEL PLAN AND PROFILE SHEET.

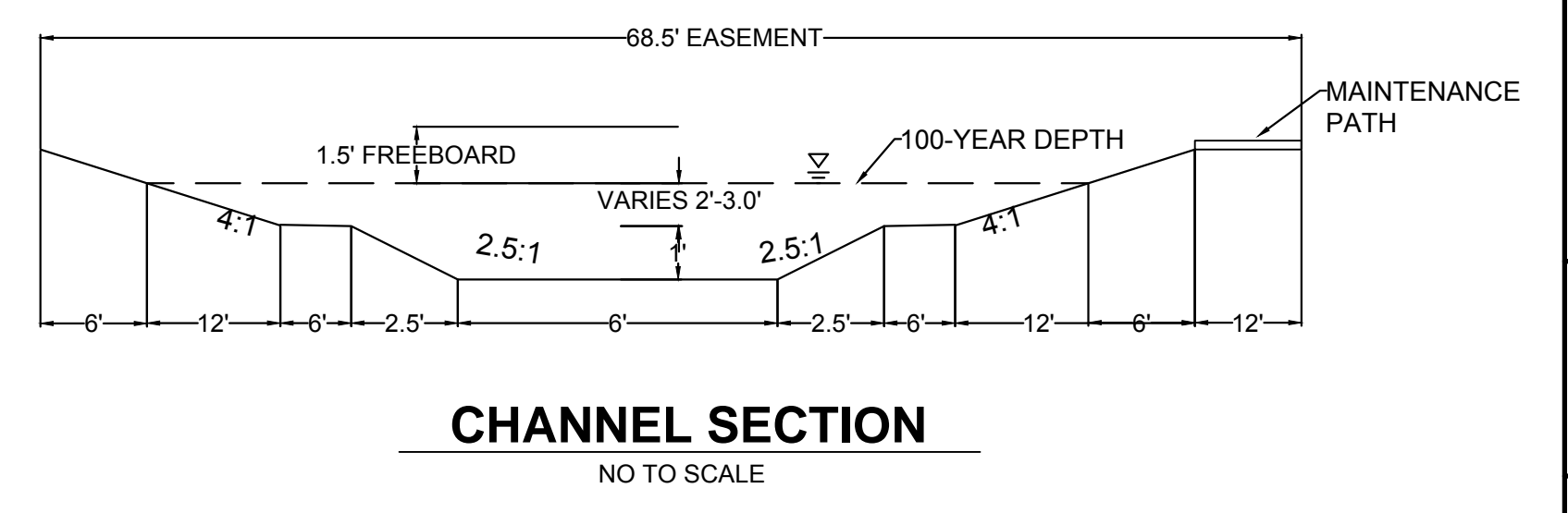

**BENCHMARK**  
DOUGLAS COUNTY CONTROL POINT KNOWN AS 1.069032, BEING A 3-1/4" ALUMINUM CAP, BEING LOCATED IN THE SOUTHWEST QUARTER OF SECTION 33, TOWNSHIP 6 SOUTH, RANGE 66 WEST OF THE SIXTH PRINCIPAL MERIDIAN, HAVING A PUBLISHED ELEVATION OF 1799.2870 METERS (5903.13 FEET) NAVD '88 DATUM.

**BASIS OF BEARINGS:**  
THE EAST LINE OF THE NORTHEAST QUARTER OF SAID SECTION 9 BEING MONUMENTED AT THE NORTHEAST CORNER OF SAID SECTION 9 BY A 3-1/4" ALUMINUM CAP STAMPED LS 23053 AND AT THE EAST QUARTER CORNER OF SAID SECTION 9 BY A 2-1/2" ALUMINUM CAP STAMPED LS 6935 BEING CONSIDERED TO BEAR SOUTH 00°15'06" EAST, 2648.70 FEET.

PREPARED UNDER THE SUPERVISION OF  
  
MARK SCHEURER  
COLORADO P.E. 48988

<b>7</b>	DRAWN BY: AYK	CHECKED BY: JJ	DATE: NOVEMBER, 2016	SCALE: AS SHOWN	FILE NO: 8130283701	DATE	DATE
	SHEET NUMBER	TRAILS AT CROWFOOT PRELIMINARY CONSTRUCTION DRAWINGS DRAINAGE MAP	ESX MANAGEMENT 7353 South Alton Way CENTENNIAL, CO 80112	CVL CONSULTANTS	10333 E. Dry Creek Rd. Suite 410 Englewood, CO 80150 Tel: (720) 482-9526 Fax: (720) 482-9548	Revisions	Date