

THE USE OF THESE EXISTING DATA AND INFORMATION IS AN INSTRUMENT OF SERVICE PROVIDED BY MERRICK AND COMPANY, INC. A FEE-BASED PROFESSIONAL SERVICE. IT IS NOT INTENDED OR REPRESENTED TO BE SUITABLE FOR USE IN WHOLE OR IN PART OR IN EXTENSION OF THE PROJECT OR ON ANY OTHER PROJECT. REUSE OR MODIFICATION OF ANY INFORMATION NOT A PHYSICAL INSTRUMENT WITHOUT THE WRITTEN CONSENT OF MERRICK AND COMPANY SHALL BE AT THE USER'S RISK FOR THE USER'S USE AND WITHOUT LIABILITY TO MERRICK AND COMPANY.

File Location: D:\DEN\Projects\0950-C00 Compark_South\CAD\CDS\SF-CPCP\0950-GRADING PLAN-SF.dwg Plot Date: 10/8/2021 11:39 AM Last Saved By: KBLACK

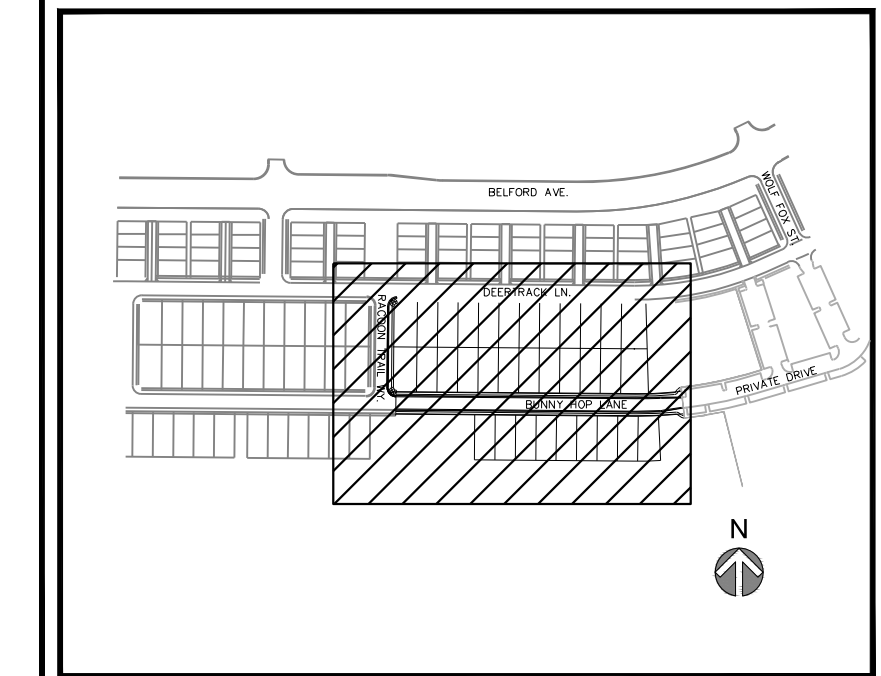

- NOTES:**
- SEE SHEET CV01 FOR LEGEND AND ABBREVIATIONS.
 - SEE SHEET GN01 FOR GENERAL NOTES.
 - ALL ELEVATIONS ARE TO FLOW LINE UNLESS OTHERWISE NOTED
 - SEE ROADWAY PLAN AND PROFILE SHEET FOR STORM INLET FL ELEVATIONS.
 - MAINTAIN A MAXIMUM 0.50% SLOPE AND MINIMUM 0.20% SLOPE ALONG THE CENTERLINE OF ALL BACK LOT SWALES.
 - EXISTING FEATURES ARE BASED ON INFORMATION PROVIDED BY MANHARD CONSULTING, LLC. SITE IS ACTIVELY UNDER CONSTRUCTION DURING TIME OF DESIGN. CONTRACTOR TO FIELD VERIFY FEATURES DEPICTED PRIOR TO COMMENCING CONSTRUCTION. CONTRACTOR TO NOTIFY ENGINEER OF RECORD IMMEDIATELY UPON DISCOVERY OF ANY DISCREPANCIES FOUND IN THE FIELD.
 - CONTRACTOR TO CONTACT 811 PRIOR TO ANY WORK PERFORMED TO LOCATED UTILITIES AND SHALL CONTACT THE OWNER IF UTILITIES APPEAR TO BE IN CONFLICT WITH PROPOSED IMPROVEMENTS.
 - SEE SHEETS C1.0 & C1.1 FOR LEGEND AND CONSTRUCTION NOTES.

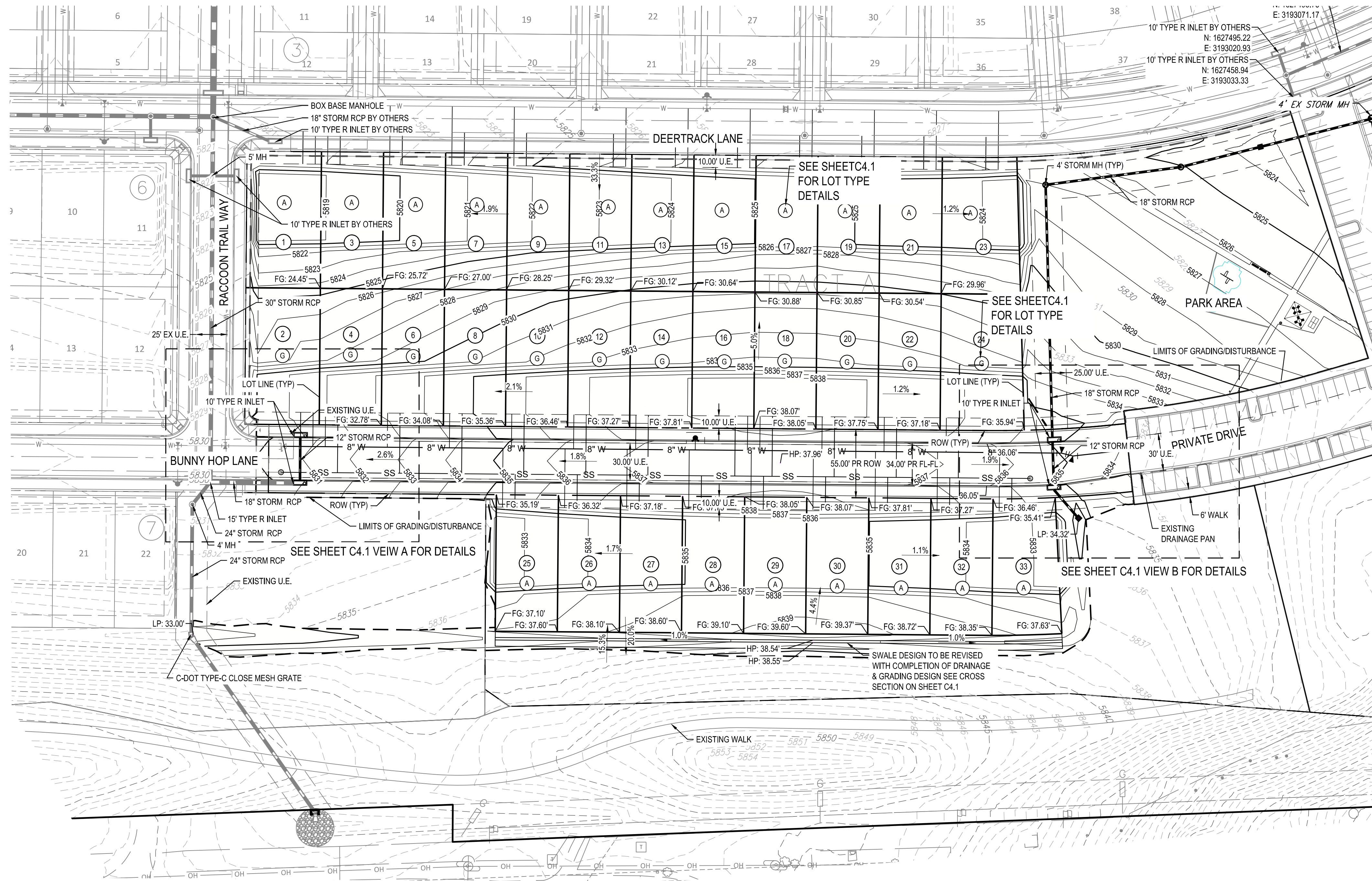
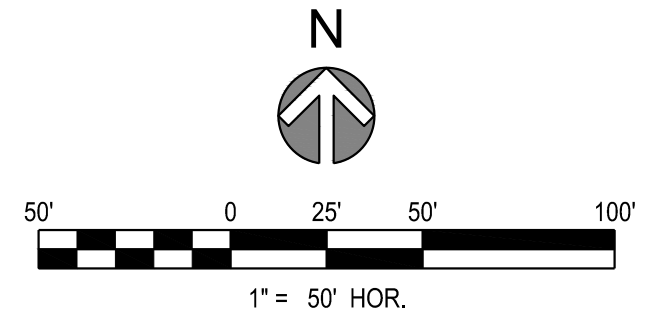

Compark Earthwork		Vol (CY)	
Cut		13006.67	unadjusted, excluded clearing and grubbing
Fill		4955.02	unadjusted, excluded clearing and grubbing

THE TOWN OF PARKER REVIEW CONSTITUTES GENERAL COMPLIANCE WITH THE TOWN'S STANDARDS AND APPROVED VARIANCES. SUBJECT TO THESE PLANS BEING STAMPED, SIGNED, AND DATED BY THE PROFESSIONAL ENGINEER OF RECORD. REVIEW BY THE TOWN DOES NOT CONSTITUTE APPROVAL OF THE PLAN DESIGN OR ACCURACY AND CORRECTNESS OF ENGINEERING CALCULATIONS. ERRORS IN THE DESIGN OR CALCULATIONS REMAIN THE RESPONSIBILITY OF THE REGISTERED PROFESSIONAL ENGINEER WHOSE STAMP AND SIGNATURE ARE AFFIXED TO THIS DOCUMENT.

THIS REVIEW DOES NOT CONSTITUTE APPROVAL OF ANY PRIVATE ON-SITE IMPROVEMENTS WHICH MAY BE SHOWN. CONSTRUCTION CANNOT COMMENCE UNTIL ALL REQUIRED DRAINAGE/TRAFFIC REPORT(S), FINAL DEVELOPMENT PLAN(S), SPECIAL REVIEW(S), GRADING PERMIT, AND/OR OTHER PERMITS ARE COMPLETE, APPROVED AND ON FILE WITH THE TOWN OF PARKER.

TOWN OF PARKER, PUBLIC WORKS DIRECTOR	DATE
TOWN OF PARKER, PUBLIC WORKS MANAGER - STORMWATER	DATE
TOWN OF PARKER, PUBLIC WORKS MANAGER - TRANSPORTATION	DATE



REV	REVISION DESCRIPTION	DATE	CHKD	APPR

COMPARK VILLAGE SOUTH
PRIVATE IMPROVEMENT
CONSTRUCTION PLANS
OVERLOT GRADING PLAN

TITLE	
JOB NUMBER	65120950
DATE	9/10/2021
SHEET	C4-0
	05



ISSUED FOR REVIEW
FOR AND ON BEHALF OF MERRICK & COMPANY