

COMPARK VILLAGE SOUTH FILING NO. 1, AMENDMENT 3

ADDRESS PLAT
 ALL OF TRACT A, COMPARK VILLAGE SOUTH FILING NO. 1, AMENDMENT 1
 LOCATED IN THE SOUTH HALF OF SECTION 6,
 TOWNSHIP 6 SOUTH, RANGE 66 WEST OF THE SIXTH PRINCIPAL MERIDIAN,
 TOWN OF PARKER, COUNTY OF DOUGLAS, STATE OF COLORADO
 33 LOTS AND 5 TRACTS - 7.686 ACRES

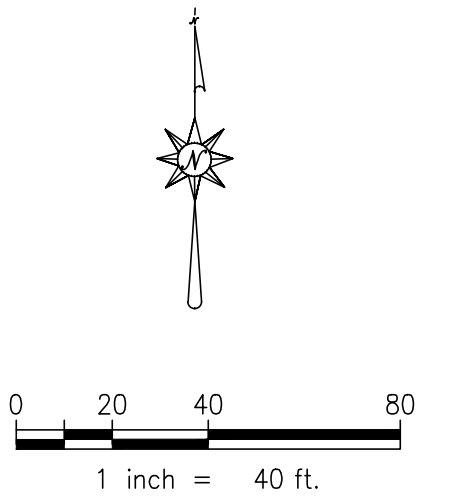

COMPARK VILLAGE SOUTH
 FILING NO. 2, AMENDMENT 1
 (NOT INCLUDED IN THIS PLAT)

DEERTRACK LANE

DEERTRACK LANE
 (RESIDENTIAL LOCAL)

COMPARK VILLAGE SOUTH
 FILING NO. 2, AMENDMENT 1
 (NOT INCLUDED IN THIS PLAT)

RACON TRAIL WAY
 (RESIDENTIAL LOCAL)

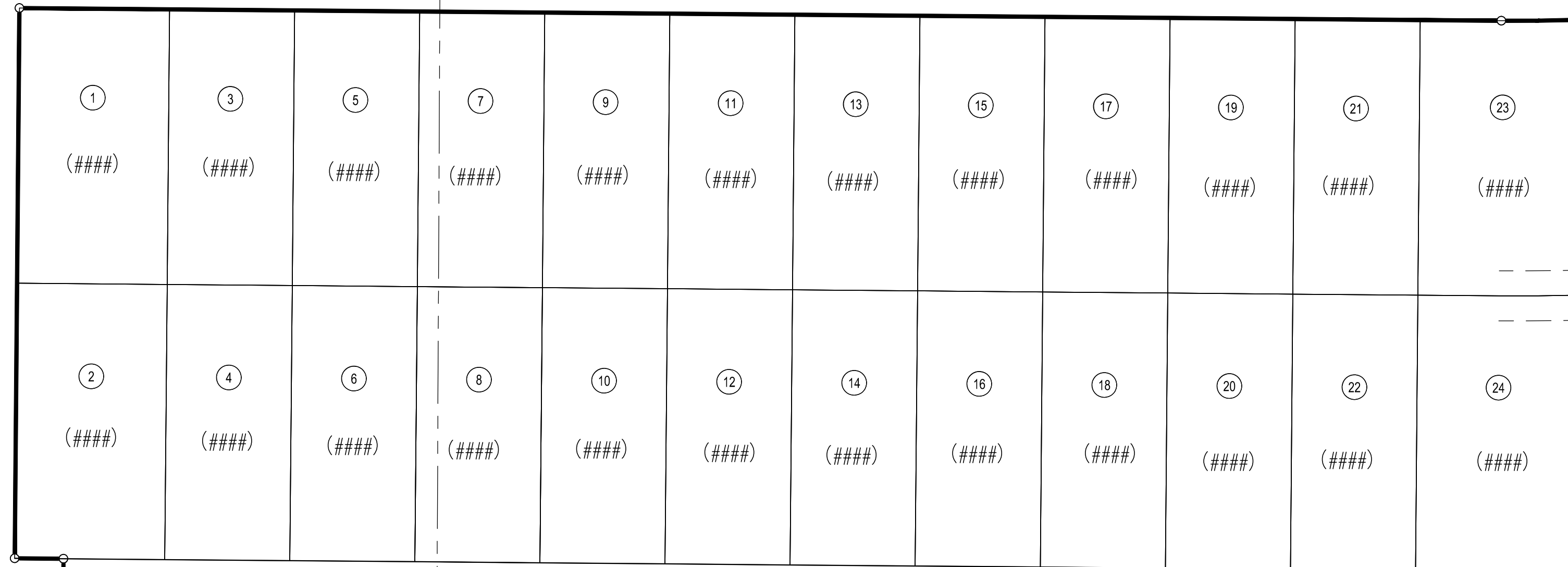

TRACT A1
 28,348 SQFT
 0.65 AC
 (####)

TRACT A2
 25,569 SQFT
 0.59 AC
 (####)

BUNNY HOP LANE
 (RESIDENTIAL LOCAL)

TRACT A3
 2,819 SQFT
 0.06 AC
 (####)

COMPARK VILLAGE SOUTH
 FILING NO. 1, AMENDMENT 1
 (NOT INCLUDED IN THIS PLAT)

LEGEND

- SECTION LINE
- BOUNDARY LINE
- LOT LINE
- ROW LINE
- ① LOT NUMBER
- (####) LOT ADDRESS

TRACT A
 COMPARK VILLAGE SOUTH
 FILING NO. 2, AMENDMENT 1
 (NOT INCLUDED IN THIS PLAT)

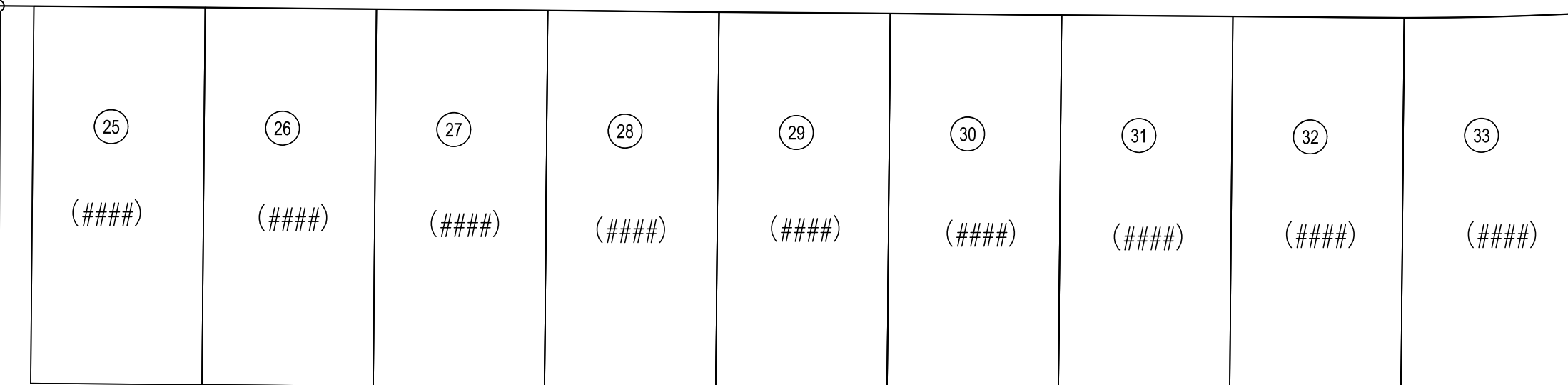

TRACT A4
 25,533 SQFT
 0.59 AC
 (####)

TRACT A5
 30,134 SQFT
 0.69 AC
 (####)

TRACT M
 COMPARK VILLAGE SOUTH
 FILING NO. 1

SCALE 1"=40'
 DRAWN KGO
 CHECKED JAW
 APPROVED KGO

